

Colfax

9707 NE Colfax Street
Portland, OR 97220

WAREHOUSE SPACE
\$6,072 + NNN
7,143 SQFT



Property Features

- Airport Way Area
- Close to PDX Airport
- Easy I-205 Freeway Access
- One Grade Level Garage Door
- 3- Phase Electrical Available
- 20' Ceiling Height
- 18' Clear Height
- 24/7 Access
- Ample Parking

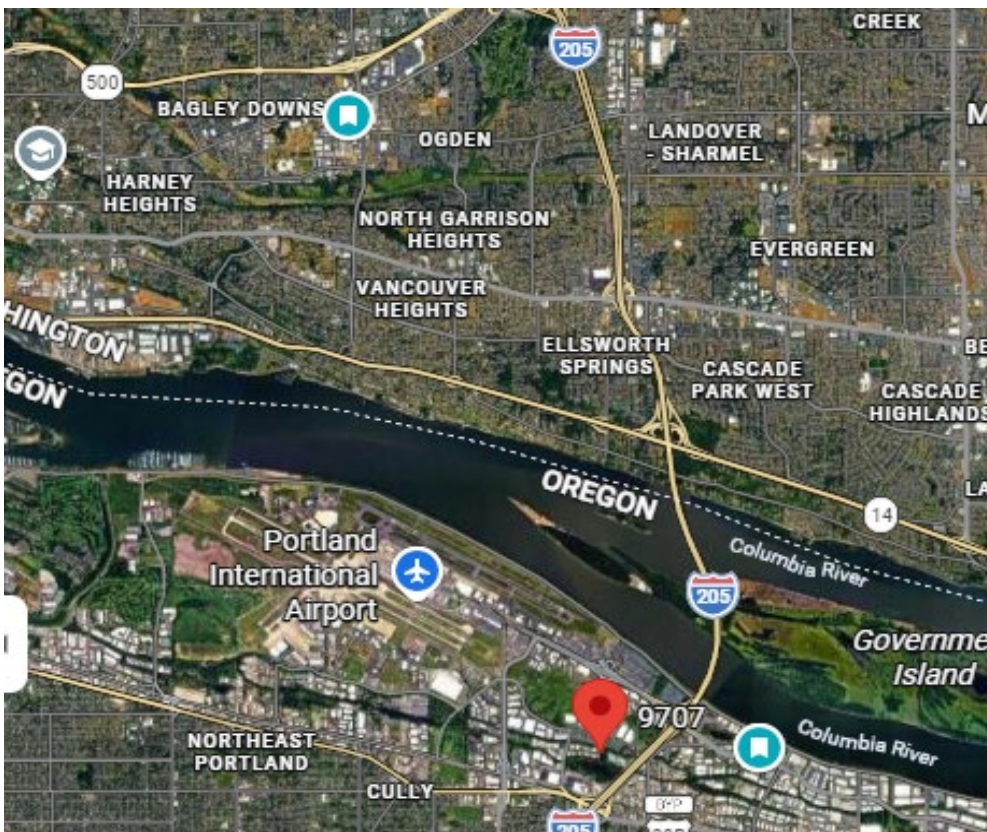

Contact: Chris Dechert
360-737-1900
chris@monolithdevelopment.com

MONOLITH
development

Colfax

9707 NE Colfax Street
Portland, OR 97220

WAREHOUSE SPACE
\$6,072 + NNN
7,143 SQFT



Property Features

- Airport Way Area
- Close to PDX Airport
- Easy I-205 Freeway Access
- One Grade Level Garage Door
- 3- Phase Electrical Available
- 20' Ceiling Height
- 18' Clear Height
- 24/7 Access
- Ample Parking

9705-9707 NE Colfax St.
Portland, OR 97220
13756 SQFT

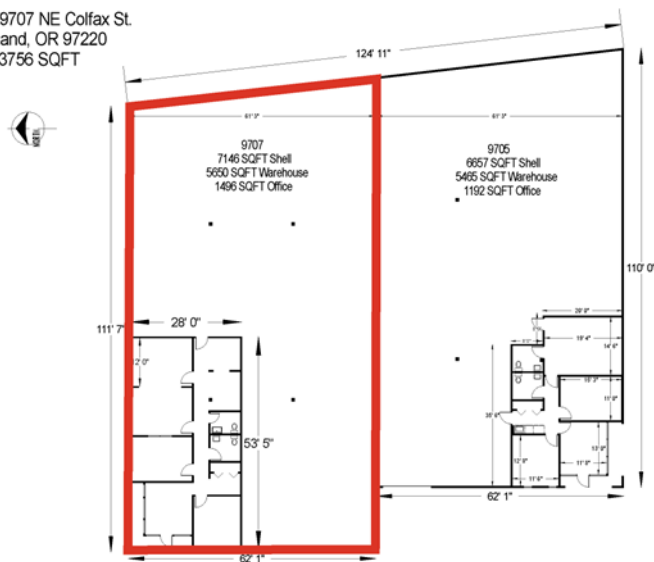

The information contained herein was obtained either from the Owner or other parties we consider reliable. We have no reason to doubt its accuracy, however we do not guarantee it.

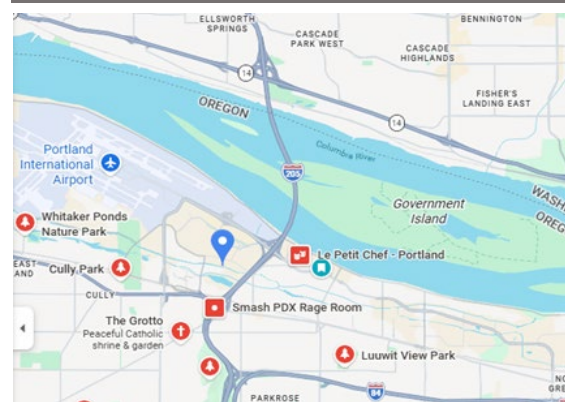

Contact: Chris Dechert
360-737-1900
chris@monolithdevelopment.com

MONOLITH
development