

# ±4,787 SF INDUSTRIAL BUILDING WITH FENCED YARD FOR LEASE CREEKSIDE BUSINESS PARK 26540 ADAMS AVE | MURRIETA, CA



## MAJOR REFURBISHMENTS COMPLETED

- New Paint in the Office Area
- New Flooring in the Office Area

## PROPERTY HIGHLIGHTS:

- Zoned: Business Park (BP) Per the City of Murrieta [Click here to learn more](#)
- Improved with 3 offices, Reception Area, 2 Restrooms, and kitchenette
- 400 Amps of Power (Verify)
- One (1) Ground Level Roll Up Door (12'x12')
- 13 Parking Stalls
- 17-18' Clearance
- 4 Skylights
- Fully Sprinklered throughout
- Gas service stubbed to the building
- Fenced and Secured Yard Area with Rolling Gate
- Electricity Distributed throughout warehouse area
- Professionally Managed Owner's Association
- Available Immediately
- Call Agents to Show Space



### Michael W. Strode, MBA, CCIM, SIOR

951.445.4508  
mstrode@leetemecula.com  
DRE #00798900

### Charley Black

951.445.4507  
cblack@leetemecula.com  
DRE #01000597

### Connor Strode

951.445.4529  
cstrode@leetemecula.com  
DRE #02170137

No warranty or representation has been made to the accuracy of the foregoing information. Terms of sale or lease and availability are subject to change or withdrawal without notice. Lee & Associates Commercial Real Estate Services, Inc. - Temecula. 25240 Hancock Avenue, Suite 100 - Murrieta, CA 92562 | Corporate ID# 01048055

**±4,787 SF INDUSTRIAL BUILDING  
WITH FENCED YARD FOR LEASE  
CREEKSIDE BUSINESS PARK  
26540 ADAMS AVE | MURRIETA, CA**



**±4,787 SF INDUSTRIAL BUILDING  
WITH FENCED YARD FOR LEASE  
CREEKSIDE BUSINESS PARK  
26540 ADAMS AVE | MURRIETA, CA**



**±4,787 SF INDUSTRIAL BUILDING  
WITH FENCED YARD FOR LEASE  
CREEKSIDE BUSINESS PARK  
26540 ADAMS AVE | MURRIETA, CA**

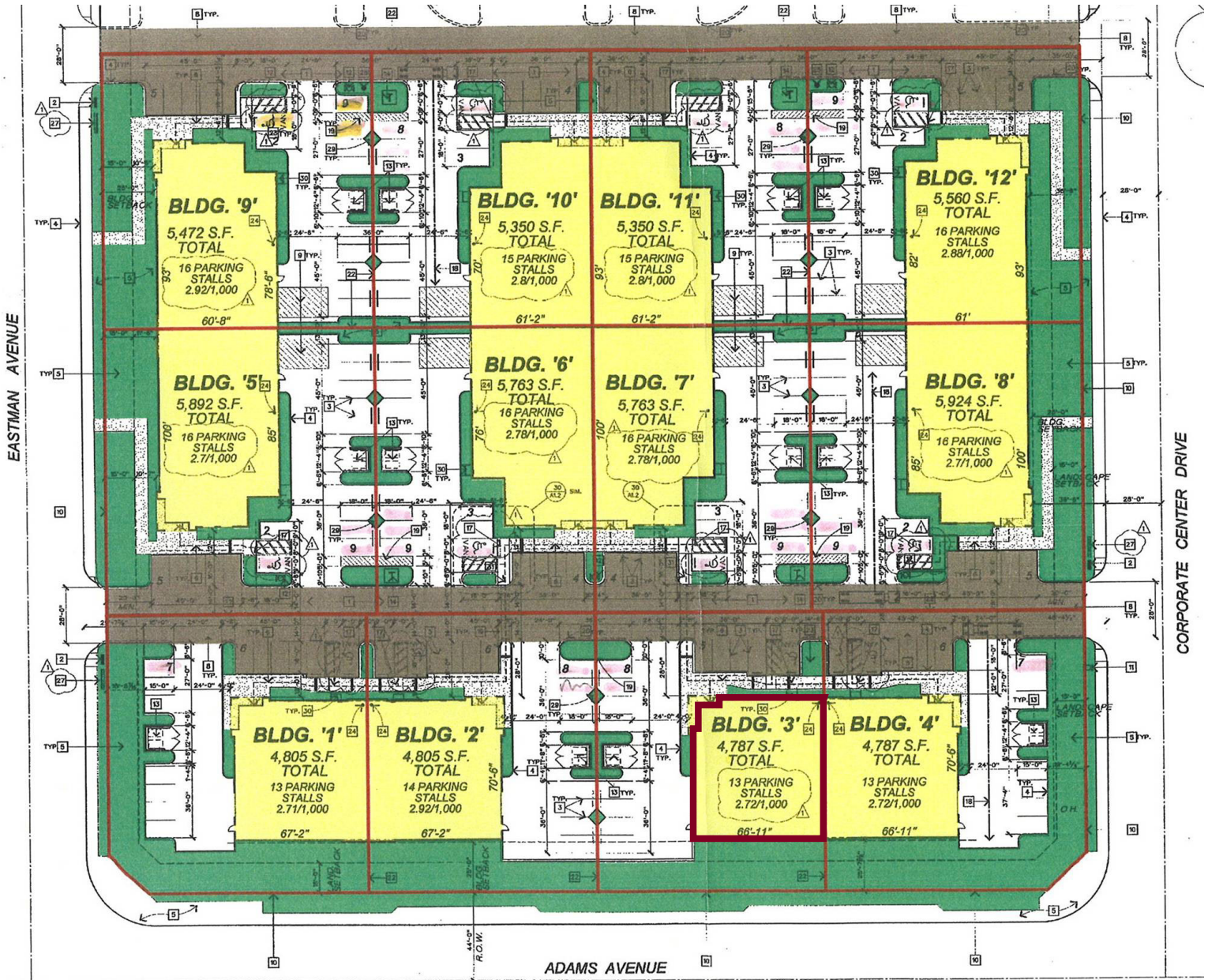

**Michael W. Strode, MBA, CCIM, SIOR**  
951.445.4508  
mstrode@leetemecula.com  
DRE #00798900

**Charley Black**  
951.445.4507  
cblack@leetemecula.com  
DRE #01000597

**Connor Strode**  
951.445.4529  
cstrode@leetemecula.com  
DRE #02170137

No warranty or representation has been made to the accuracy of the foregoing information. Terms of sale or lease and availability are subject to change or withdrawal without notice. Lee & Associates Commercial Real Estate Services, Inc. - Temecula. 25240 Hancock Avenue, Suite 100 - Murrieta, CA 92562 | Corporate ID# 01048055