

# 46,563 SF

**700 Rohlwing Road  
Itasca, Illinois 60143**

Prologis Itasca

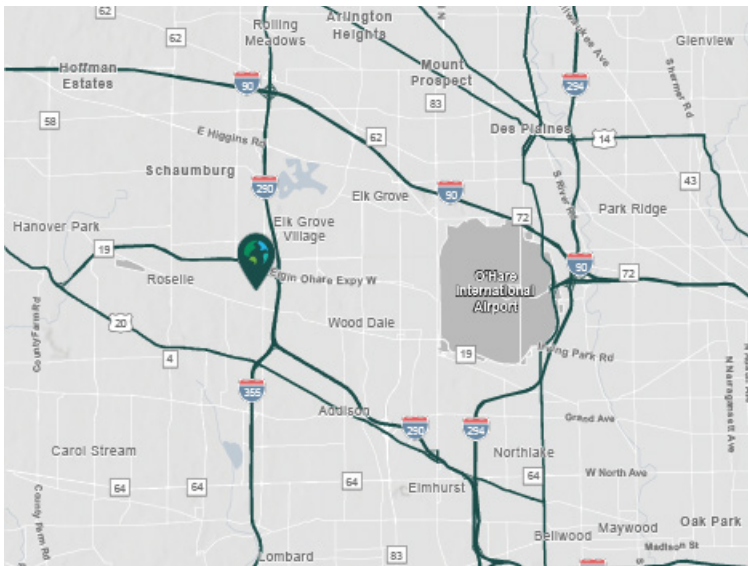

- 6.5 miles to O'Hare South Air Cargo Entrance
- Easy access to I-290, I-355 and I-390
- Low DuPage County taxes

## Property Features

Available Space	46,563 SF
Main Office	4,385 SF
Warehouse Office	308 SF
Clear Height	18'
Column Spacing	30' x 29'
Interior Dock Doors	3 (2 with levelers)
Drive-in Doors	2
Exterior Van Doors	10
Trailer Parking Spaces	Up to 30 spaces
Car Parking Spaces	60 (entire building)



Unlock the full potential of your warehouse with one strategic, single-source partner.



## Trailer Parking Plan

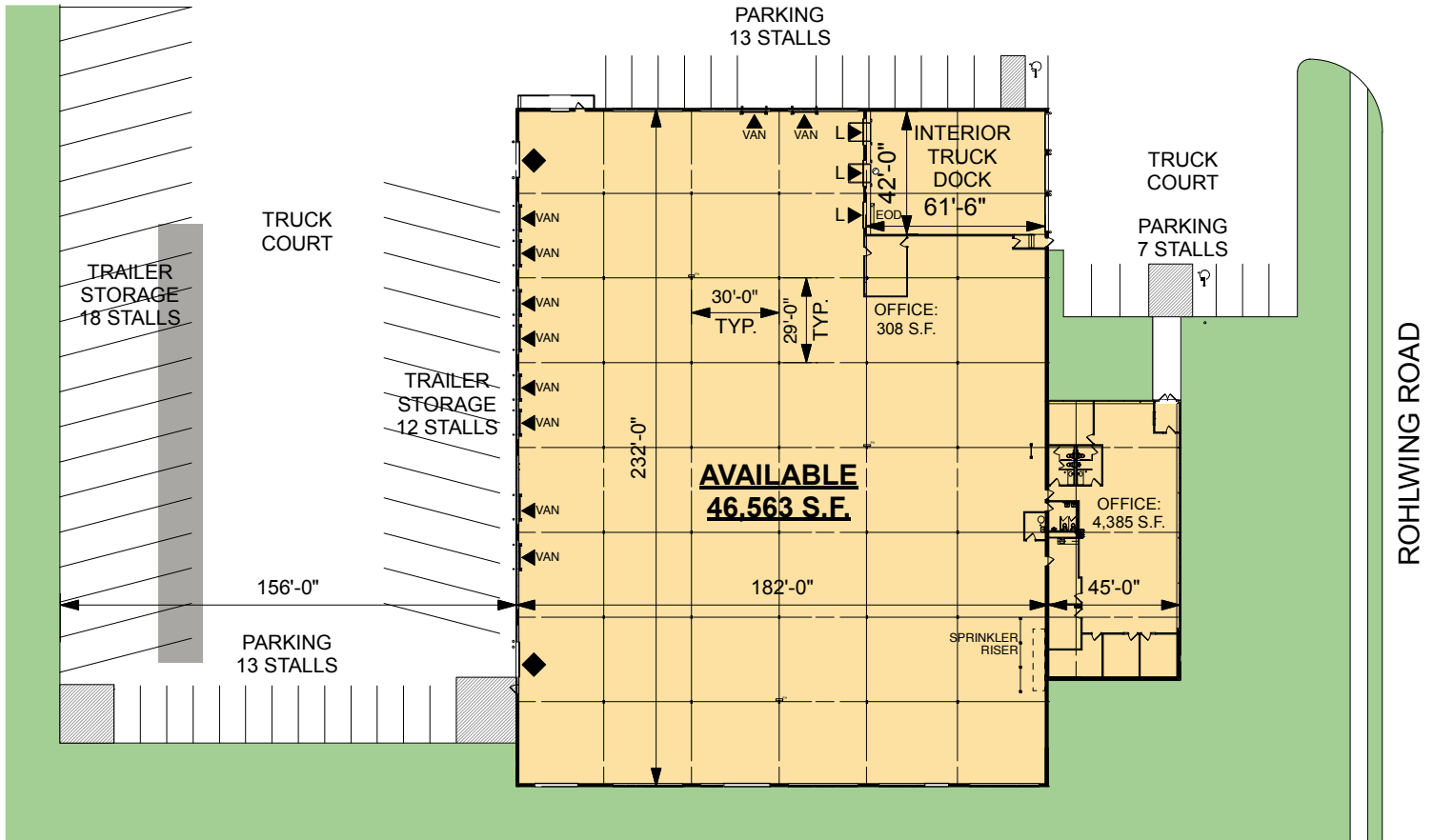

## AVISON YOUNG

**Avison Young**  
**Brian Colson**  
 9550 W Higgins Rd, Ste 900  
 Rosemont, IL 60018  
 brian.colson@avisonyoung.com  
 ph +1 312 259 1577

**Avison Young**  
**Brian Pomorski**  
 9550 W Higgins Rd, Ste 900  
 Rosemont, IL 60018  
 brian.pomorski@avisonyoung.com  
 ph +1 708 912 2807

**Avison Young**  
**Andrew Fischer**  
 9550 W Higgins Rd, Ste 900  
 Rosemont, IL 60018  
 andrew.fischer@avisonyoung.com  
 ph +1 224 542 0717

**Prologis**  
**Sam Evans**  
 6250 N River Rd, Ste 1100  
 Rosemont, IL 60018  
 sevans@prologis.com  
 ph +1 847 644 9412



Unlock the full potential of your warehouse with one strategic, single-source partner.



## Car Parking Plan

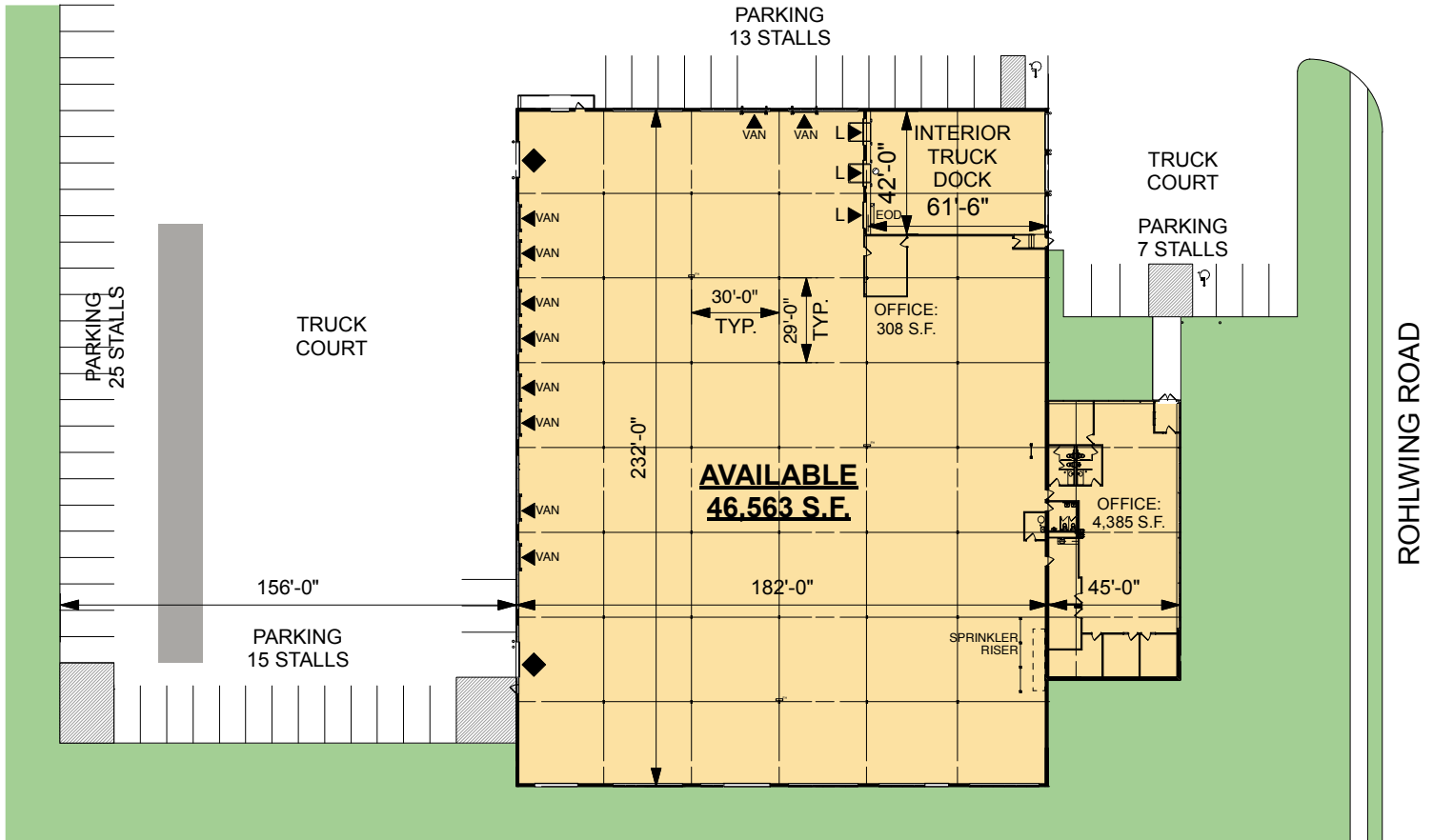

## AVISON YOUNG

**Avison Young**  
**Brian Colson**  
 9550 W Higgins Rd, Ste 900  
 Rosemont, IL 60018  
 brian.colson@avisonyoung.com  
 ph +1 312 259 1577

**Avison Young**  
**Brian Pomorski**  
 9550 W Higgins Rd, Ste 900  
 Rosemont, IL 60018  
 brian.pomorski@avisonyoung.com  
 ph +1 708 912 2807

**Avison Young**  
**Andrew Fischer**  
 9550 W Higgins Rd, Ste 900  
 Rosemont, IL 60018  
 andrew.fischer@avisonyoung.com  
 ph +1 224 542 0717

**Prologis**  
**Sam Evans**  
 6250 N River Rd, Ste 1100  
 Rosemont, IL 60018  
 sevans@prologis.com  
 ph +1 847 644 9412