

**540 W. JACKSON ST.  
MEXICO, MO**



FOR MORE INFORMATION PLEASE CONTACT

**Jack L. Maher, III**

**Broker-Officer**

Mobile (573) 489-6860

Work (573) 228-6321

FAX (815) 550-1506

Buttonwood Business Center

3610 Buttonwood Dr., Suite 200

Columbia, MO 65201

Email at [maher3@jlmproperties.com](mailto:maher3@jlmproperties.com)



**MAHER**

COMMERCIAL REAL ESTATE

The information contained herein is for illustration only - dimensions are approximate only.  
This information is not to be reproduced or used for construction or permitting. The information contained within this brochure is believed to be accurate as of the date of input, however, JLM Properties, Inc., assumes no responsibility for the accuracy of the information provided.

[WWW.MAHERCRE.COM](http://WWW.MAHERCRE.COM)

# 540 W. JACKSON ST. MEXICO, MO

For Lease: Call For Pricing.

## Space Overview:

- 4,500 S.F. inline retail space available immediately
- Space configuration: open retail area roughly 43' x 87', a break room and 2 restrooms.
- Buildout allowance available subject to terms and credit of tenant.
- Formerly operated by Shoe Sensation, well suited for general retail use.
- West Plaza Center features several national tenants including Ace Hardware, Dollar General, Carquest, and Walgreens.
- Hard corner intersection sees 9,600 vehicles per day.
- The lease is on a NNN basis, NNN's \$2 S.F. (2025).

FOR MORE INFORMATION PLEASE CONTACT

**Jack L. Maher, III**

**Broker-Officer**

Mobile (573) 489-6860

Work (573) 228-6321

FAX (815) 550-1506

Buttonwood Business Center

3610 Buttonwood Dr., Suite 200

Columbia, MO 65201

Email at [maher3@jlmproperties.com](mailto:maher3@jlmproperties.com)



**MAHER**

COMMERCIAL REAL ESTATE

The information contained herein is for illustration only - dimensions are approximate only.  
This information is not to be reproduced or used for construction or permitting. The information contained within this brochure is believed to be accurate as of the date of input, however, JLM Properties, Inc., assumes no responsibility for the accuracy of the information provided.

[WWW.MAHERCRE.COM](http://WWW.MAHERCRE.COM)

**540 W. JACKSON ST.  
MEXICO, MO**



FOR MORE INFORMATION PLEASE CONTACT

**Jack L. Maher, III**

**Broker-Officer**

Mobile (573) 489-6860

Work (573) 228-6321

FAX (815) 550-1506

Buttonwood Business Center

3610 Buttonwood Dr., Suite 200

Columbia, MO 65201

Email at [maher3@jlmproperties.com](mailto:maher3@jlmproperties.com)



**MAHER**

COMMERCIAL REAL ESTATE

The information contained herein is for illustration only - dimensions are approximate only.  
This information is not to be reproduced or used for construction or permitting. The information contained within this brochure is believed to be accurate as of the date of input, however, JLM Properties, Inc., assumes no responsibility for the accuracy of the information provided.

[WWW.MAHERCRE.COM](http://WWW.MAHERCRE.COM)

# 540 W. JACKSON ST. MEXICO, MO

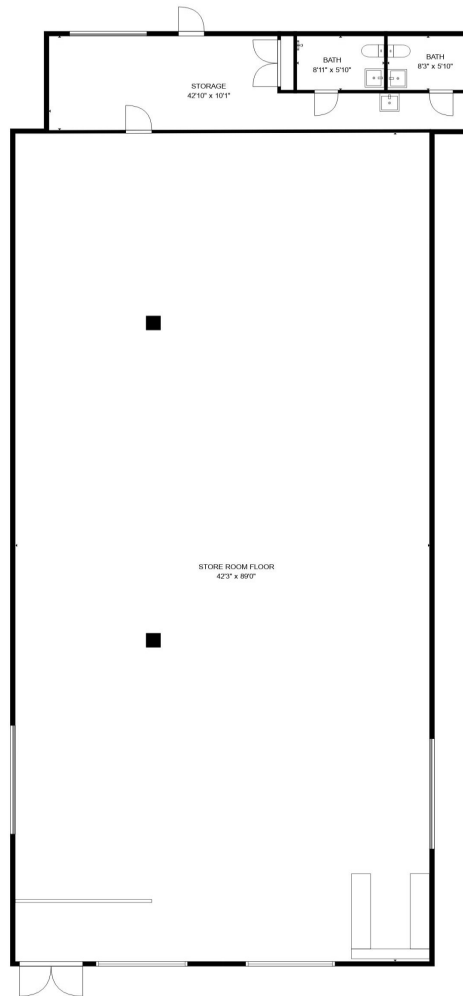

SIZES AND DIMENSIONS ARE APPROXIMATE, ACTUAL MAY VARY.

FOR MORE INFORMATION PLEASE CONTACT

**Jack L. Maher, III**

**Broker-Officer**

Mobile (573) 489-6860

Work (573) 228-6321

FAX (815) 550-1506

Buttonwood Business Center

3610 Buttonwood Dr., Suite 200

Columbia, MO 65201

Email at [maher3@jlmproperties.com](mailto:maher3@jlmproperties.com)



**MAHER**

COMMERCIAL REAL ESTATE

The information contained herein is for illustration only - dimensions are approximate only.  
This information is not to be reproduced or used for construction or permitting. The information contained within this brochure is believed to be accurate as of the date of input, however, JLM Properties, Inc., assumes no responsibility for the accuracy of the information provided.

[WWW.MAHERCRE.COM](http://WWW.MAHERCRE.COM)

# 540 W. JACKSON ST. MEXICO, MO



FOR MORE INFORMATION PLEASE CONTACT

**Jack L. Maher, III**

**Broker-Officer**

Mobile (573) 489-6860

Work (573) 228-6321

FAX (815) 550-1506

Buttonwood Business Center

3610 Buttonwood Dr., Suite 200

Columbia, MO 65201

Email at [maher3@jlmproperties.com](mailto:maher3@jlmproperties.com)



## MAHER

COMMERCIAL REAL ESTATE

The information contained herein is for illustration only - dimensions are approximate only.  
This information is not to be reproduced or used for construction or permitting. The information contained within this brochure is believed to be accurate as of the date of input, however, JLM Properties, Inc., assumes no responsibility for the accuracy of the information provided.

[WWW.MAHERCRE.COM](http://WWW.MAHERCRE.COM)

# 540 W. JACKSON ST. MEXICO, MO



FOR MORE INFORMATION PLEASE CONTACT

**Jack L. Maher, III**

**Broker-Officer**

Mobile (573) 489-6860

Work (573) 228-6321

FAX (815) 550-1506

Buttonwood Business Center

3610 Buttonwood Dr., Suite 200

Columbia, MO 65201

Email at [maher3@jlmproperties.com](mailto:maher3@jlmproperties.com)



# MAHER

COMMERCIAL REAL ESTATE

The information contained herein is for illustration only - dimensions are approximate only.  
This information is not to be reproduced or used for construction or permitting. The information contained within this brochure is believed to be accurate as of the date of input, however, JLM Properties, Inc., assumes no responsibility for the accuracy of the information provided.

[WWW.MAHERCRE.COM](http://WWW.MAHERCRE.COM)

# 540 W. JACKSON ST. MEXICO, MO



FOR MORE INFORMATION PLEASE CONTACT

**Jack L. Maher, III**

**Broker-Officer**

Mobile (573) 489-6860

Work (573) 228-6321

FAX (815) 550-1506

Buttonwood Business Center

3610 Buttonwood Dr., Suite 200

Columbia, MO 65201

Email at [maher3@jlmproperties.com](mailto:maher3@jlmproperties.com)



## MAHER

COMMERCIAL REAL ESTATE

The information contained herein is for illustration only - dimensions are approximate only.  
This information is not to be reproduced or used for construction or permitting. The information contained within this brochure is believed to be accurate as of the date of input, however, JLM Properties, Inc., assumes no responsibility for the accuracy of the information provided.

[WWW.MAHERCRE.COM](http://WWW.MAHERCRE.COM)