

FOR SALE | EXECUTIVE SUMMARY

11700 MONARCH | 107,000 SF | GARDEN GROVE, CA

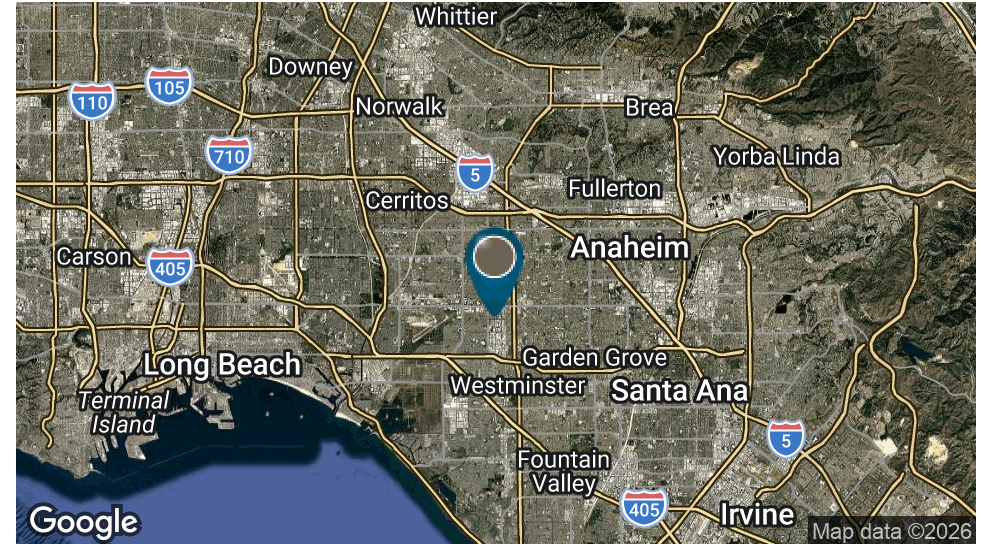

OFFERING SUMMARY

Sale Price:	\$31,565,000
Building Size:	107,000 SF
Office:	Approx. 18,000 SF of 2 story Office
Lot Size:	4.53 Acres
Price / SF:	\$295
Year Built:	1978
Renovated:	2014
Zoning:	PUD-103-76

PROPERTY OVERVIEW

High image 107,000 SF industrial building on 4.53 acres. The property has heavy power for manufacturing, high clearance at 24 ft, 5 exterior dock doors, 2 Drive in Bays and 2 large parking lots and a secure fenced yard with a mature landscaping.

PROPERTY HIGHLIGHTS

- HIGH IMAGE CORPORATE HEADQUARTERS
- HEAVY POWER 4,000 AMPS/480V 3 PHASE
- 24 FT CLEAR HEIGHT
- 5 DOCK HIGH POSITIONS, 3 DRIVE IN DOORS
- 40 X 44 FT COLUMN SPACING
- LARGE FENCED YARD (102 FT WIDE TRUCK COURT)
- 102 PARKING SPACES

ADDITIONAL PHOTOS

11700 MONARCH | 107,000 SF | GARDEN GROVE, CA



ADDITIONAL PHOTOS

11700 MONARCH | 107,000 SF | GARDEN GROVE, CA



MONARCH STREET

DOIG AVENUE

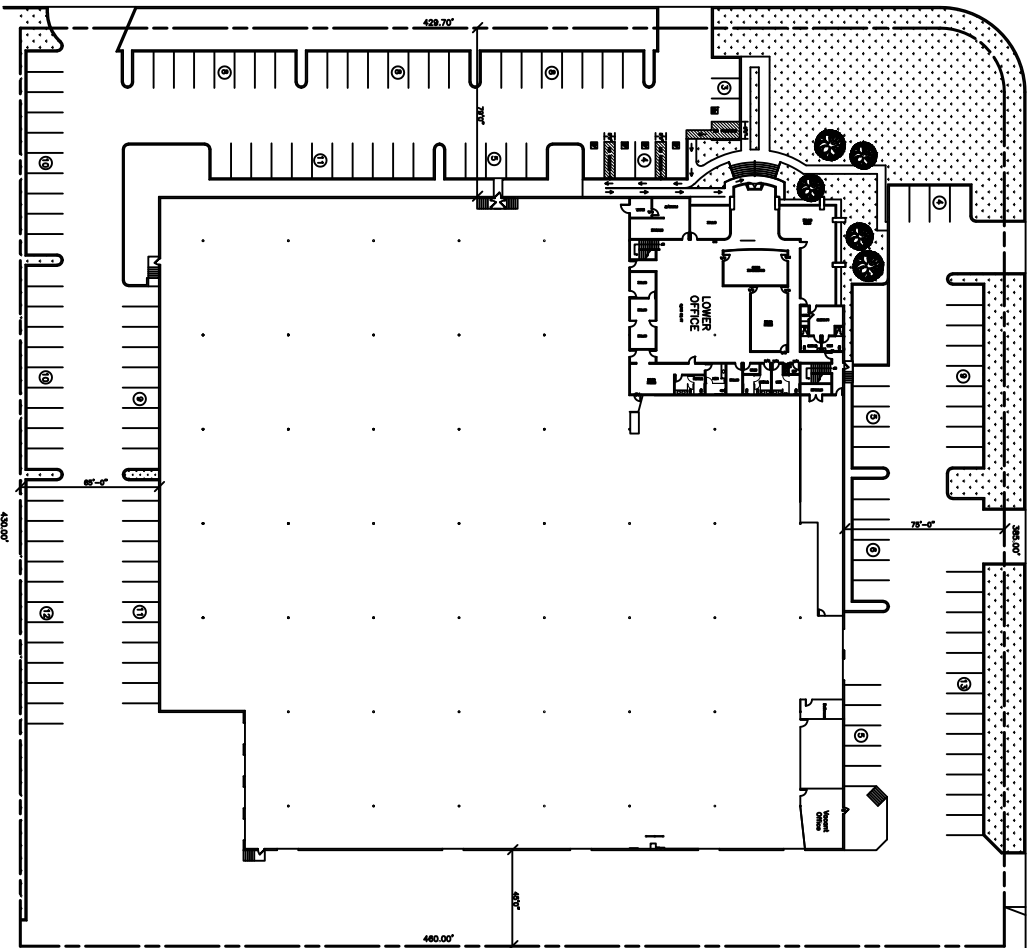

SITE PLAN

11700 MONARCH ST.
GARDEN GROVE, CA. 92841

VICINITY MAP

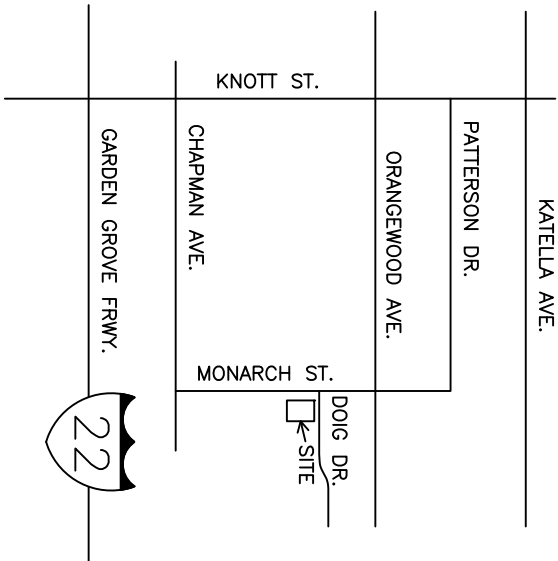

ITEM	QUANTITY	DESCRIPTION
<p>CATALINA CYLINDERS DIVISION OF ALUMINUM PRECISION PRODUCTS INC. GARDEN GROVE, CA TEL (714) 890-0999 FAX (714) 890-1744 WWW.CATALINACYLINDERS.COM</p>		
<p>SCALE: 1/8" = 1'-0"</p>		
<p>DESIGNED BY: [Signature]</p>		
<p>CHECKED BY: [Signature]</p>		
<p>DATE: 7/14/2000</p>		
<p>APPROVED BY: [Signature]</p>		
<p>PROJECT: 11700 MONARCH ST. GARDEN GROVE, CA</p>		
<p>DATE: 7/14/2000</p>		
<p>REVISION: [Blank]</p>		

THIS DOCUMENT CONTAINS INFORMATION THAT IS CONFIDENTIAL AND PROPRIETARY TO CATALINA CYLINDERS, AND MUST NOT BE COPIED OR DISCLOSED TO OTHERS WITHOUT THE WRITTEN PERMISSION OF CATALINA CYLINDERS. THIS DOCUMENT IS FOR ANY PURPOSE OTHER THAN DOING BUSINESS WITH CATALINA CYLINDERS.

LOCATION MAP

11700 MONARCH | 107,000 SF | GARDEN GROVE, CA

