

810 Richards Street

Honolulu, HI 96813

AVAILABLE FOR LEASE - SUITE 755

Suite Highlights



- Rental Rate Negotiable
- 901 Square Feet
- Three Interior Office Spaces
- Reception Area

Suite 755 is flexible - use as a two-office suite w/ conference room or three private offices. Large reception area and mail slot round out this upgraded unit. Contiguous to Suites 700 & 710 for an additional 2,910 or 397 SQ FT.



Photos



Floor Plan

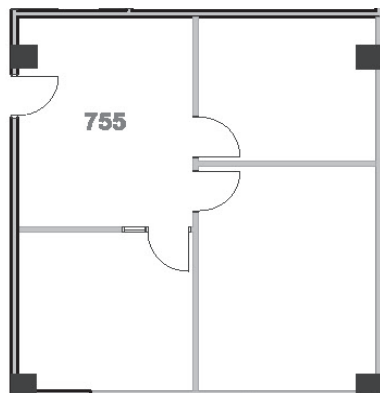

All information contained herein is for advertising and promotional purposes. Data gathered was obtained from sources our brokerage believes to be reliable. Anna International Realty does not guarantee, warrant or represent information is 100% accurate. Interested parties should conduct an independent investigation as to the data provided within this property overview. Facts may be subject to errors, omissions, price changes or other extemporaneous conditions without public notice.



Anna International Realty
Anna Achauer, Principal Broker
+ 1 808 386 7556
info@810Richards.com
www.810Richards.com