



CHANDLER MEDICAL PAVILION II

AT ALMA | 202

FIRST FLOOR

17,000 SF, Divisible to 2,500 SF

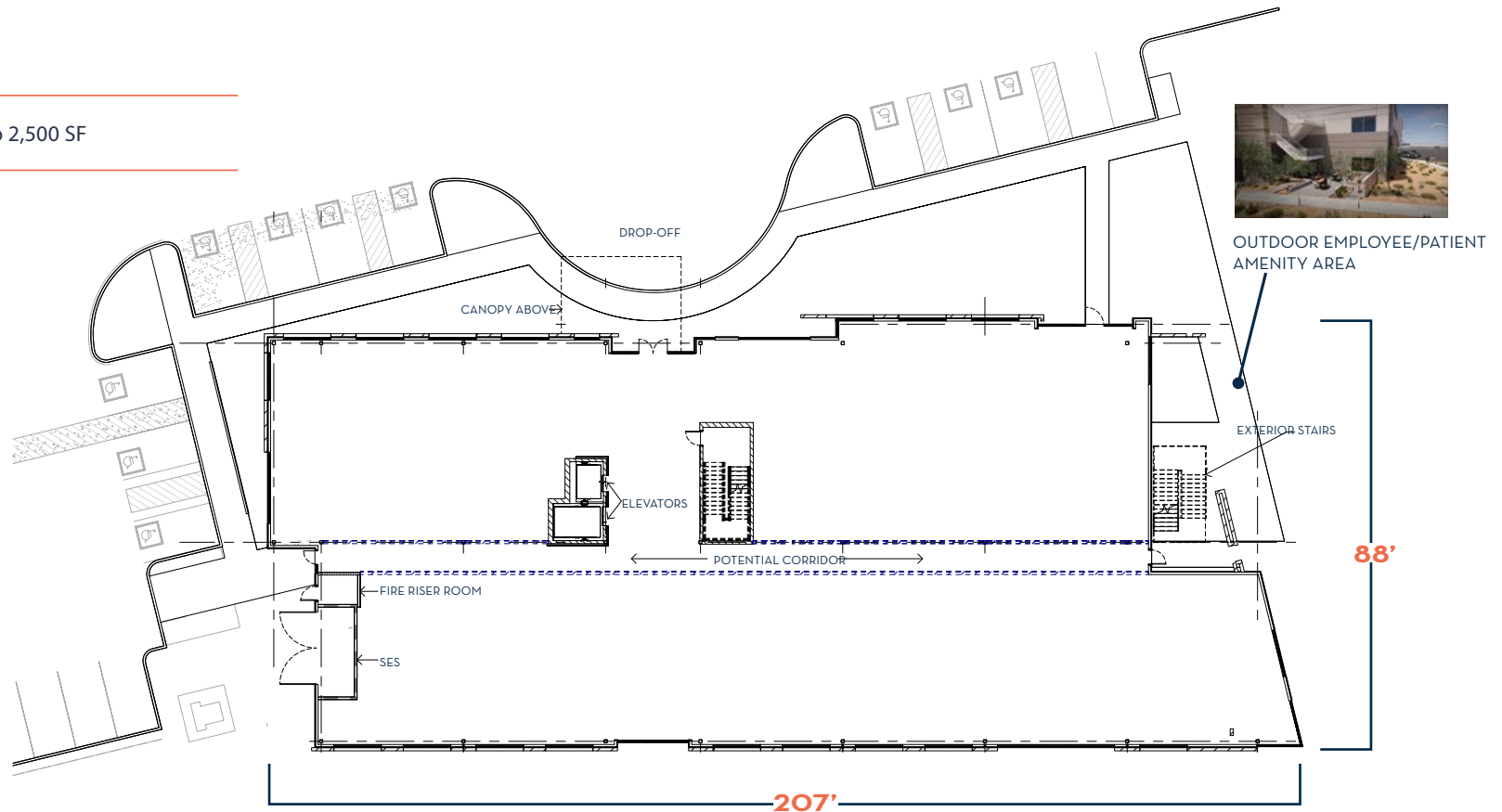

FOR LEASING INFORMATION CONTACT

RACHAEL THOMPSON

602.513.5122 | rachael.thompson@kidder.com

PERRY GABUZZI, CCIM

602.513.5116 | perry.gabuzzi@kidder.com

KIDDER.COM

This information supplied herein is from sources we deem reliable. It is provided without any representation, warranty or guarantee, expressed or implied as to its accuracy. Prospective Buyer or Tenant should conduct an independent investigation and verification of all matters deemed to be material, including, but not limited to, statements of income and expenses. Consult your attorney, accountant, or other professional advisor.

unbound
DEVELOPMENT

WEBB
Investments

km Kidder
Mathews



CHANDLER MEDICAL PAVILION II

AT ALMA | 202

SECOND FLOOR

17,000 SF, Divisible to 2,500 SF

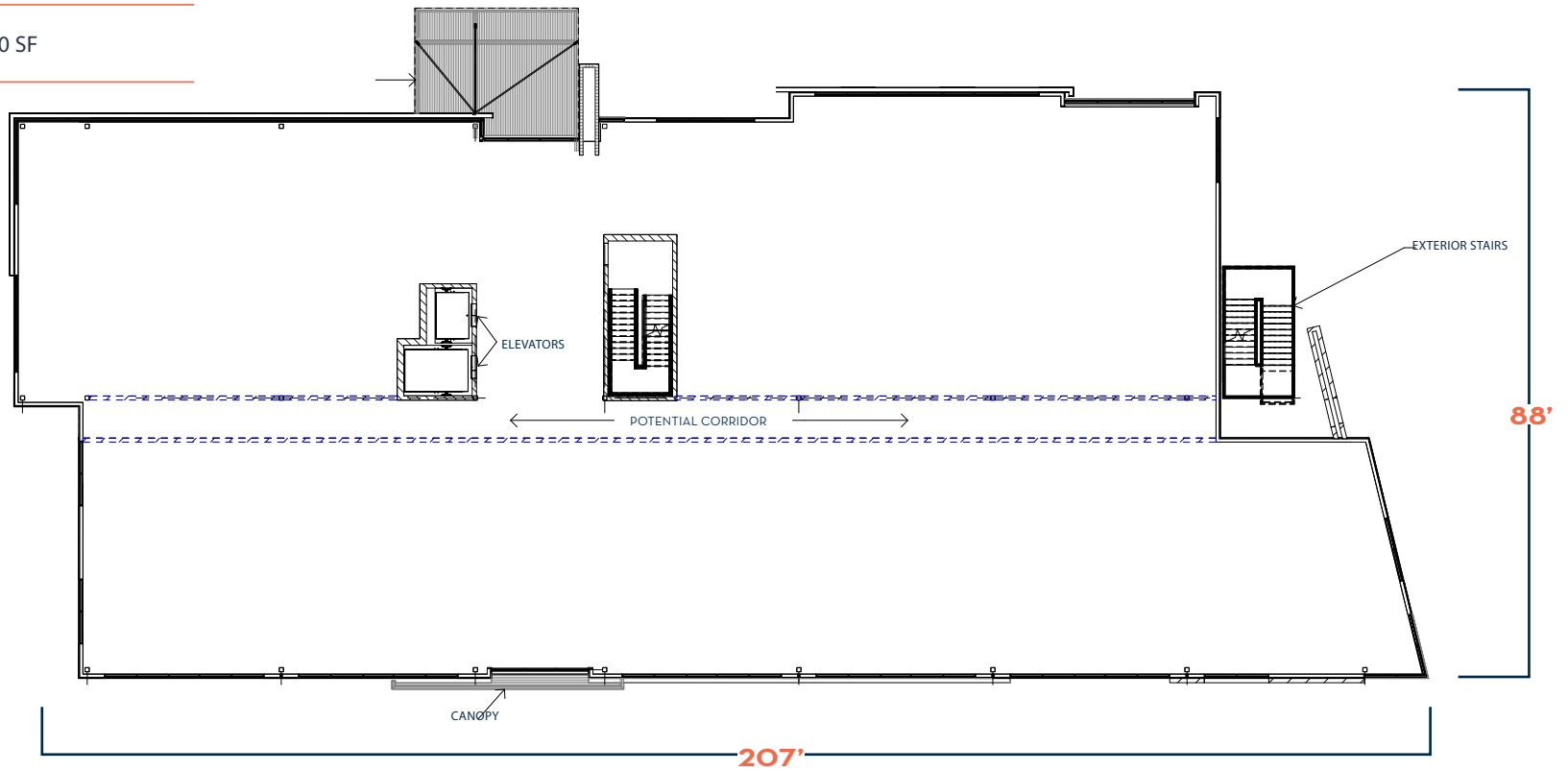

FOR LEASING INFORMATION CONTACT

RACHAEL THOMPSON

602.513.5122 | rachael.thompson@kidder.com

PERRY GABUZZI, CCIM

602.513.5116 | perry.gabuzzi@kidder.com

KIDDER.COM

This information supplied herein is from sources we deem reliable. It is provided without any representation, warranty or guarantee, expressed or implied as to its accuracy. Prospective Buyer or Tenant should conduct an independent investigation and verification of all matters deemed to be material, including, but not limited to, statements of income and expenses. Consult your attorney, accountant, or other professional advisor.

unbound
DEVELOPMENT

WEBB
Investments

km Kidder
Mathews



CHANDLER MEDICAL PAVILION II

AT ALMA | 202

THIRD FLOOR

17,000 SF, Divisible to 2,500 SF

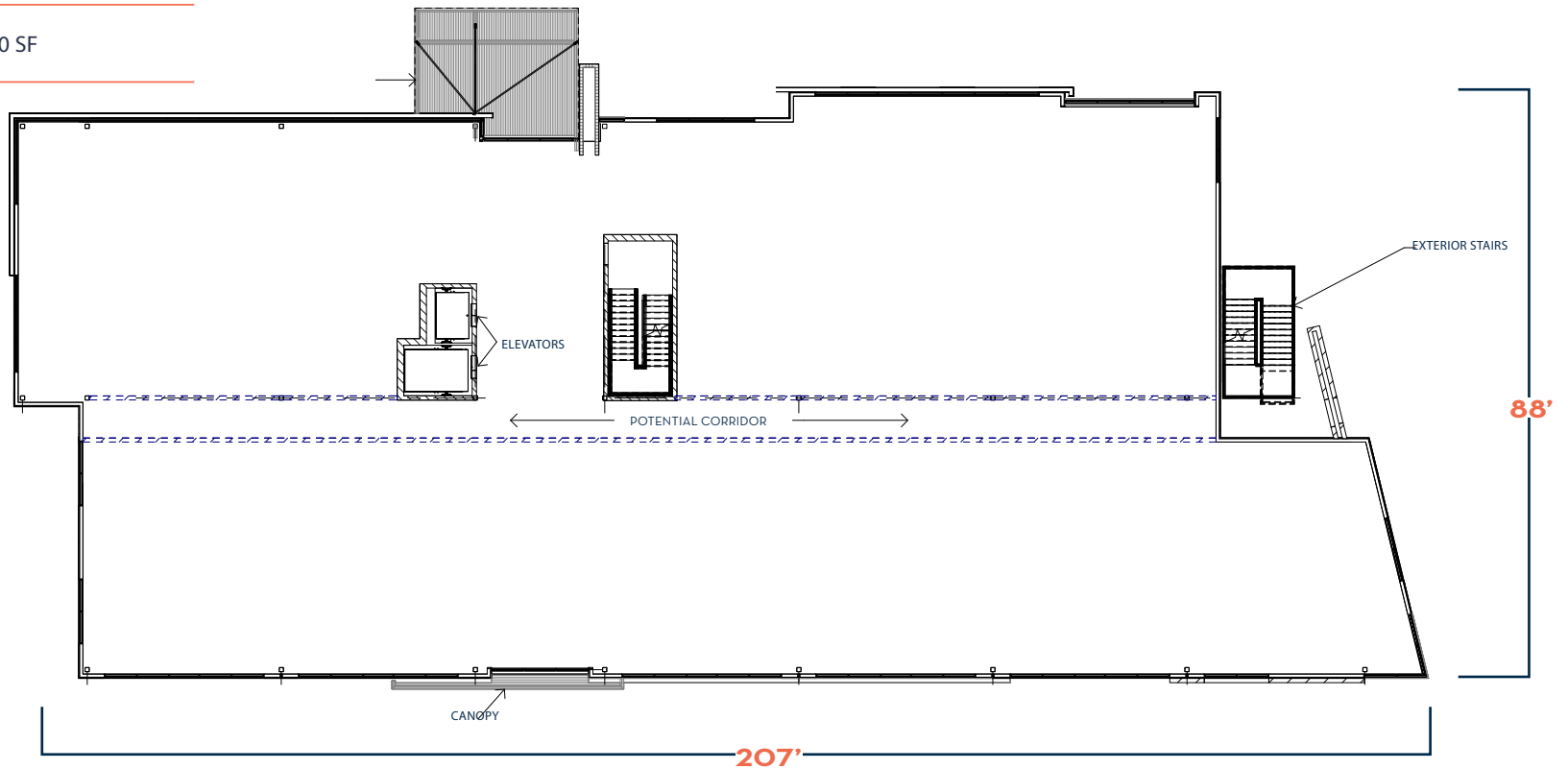

FOR LEASING INFORMATION CONTACT

RACHAEL THOMPSON

602.513.5122 | rachael.thompson@kidder.com

PERRY GABUZZI, CCIM

602.513.5116 | perry.gabuzzi@kidder.com

KIDDER.COM

This information supplied herein is from sources we deem reliable. It is provided without any representation, warranty or guarantee, expressed or implied as to its accuracy. Prospective Buyer or Tenant should conduct an independent investigation and verification of all matters deemed to be material, including, but not limited to, statements of income and expenses. Consult your attorney, accountant, or other professional advisor.

unbound
DEVELOPMENT

WEBB
Investments

km Kidder
Mathews