

DESERT CANYON CENTER

Scottsdale, AZ



10401 E. McDowell Mountain Ranch Rd.
SCOTTSDALE, AZ 85255

NATALIA BABITS
NC@AZPRE.COM | 602.488.7178

BEN EPSTEIN
BE@AZPRE.COM | 602.397.0886

LOCATION



Desert Canyon Center 10401 E. McDowell Mountain Ranch Rd. | Scottsdale, AZ 85255

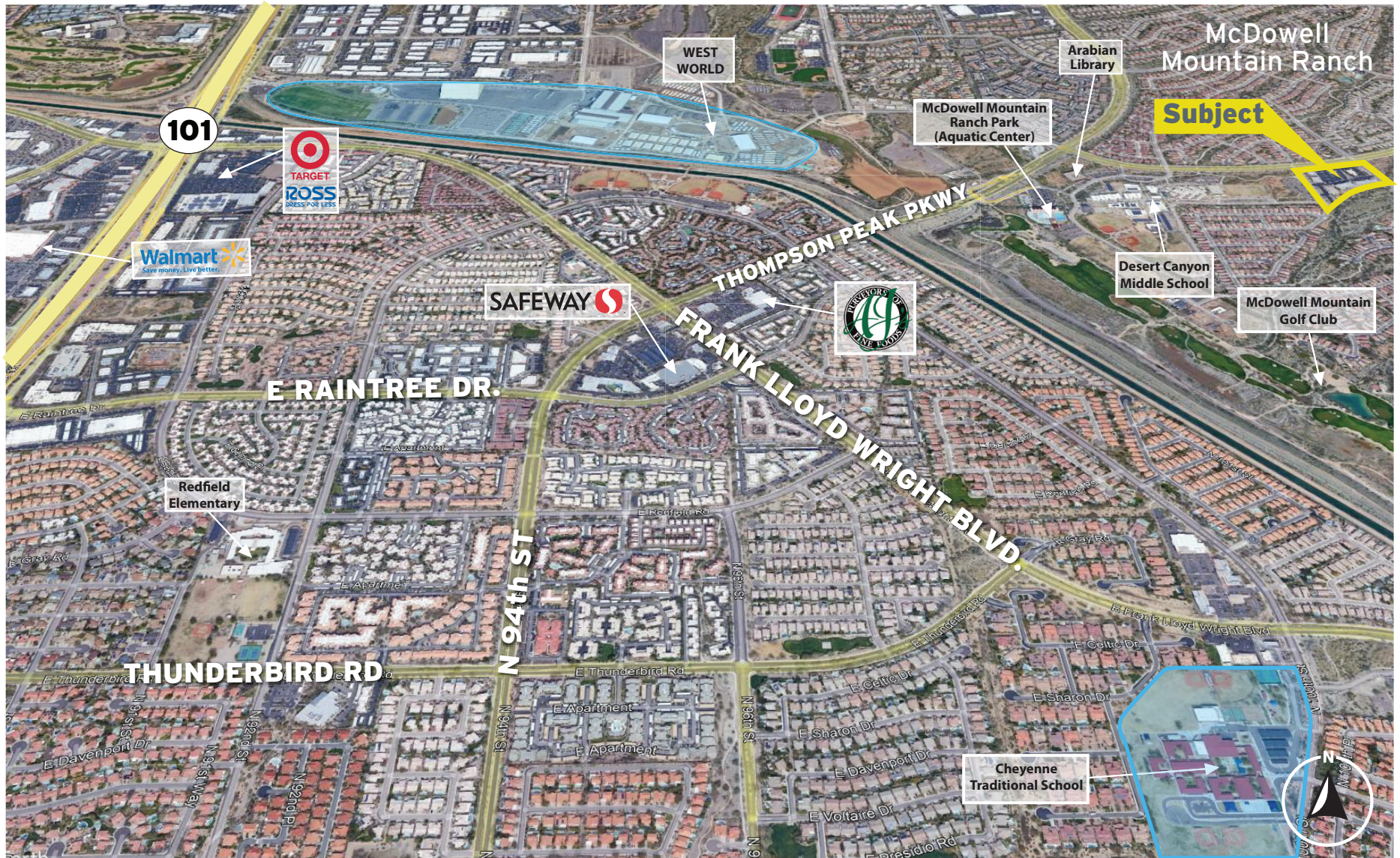

AREA



Desert Canyon Center



Total Population

1 mile: 6,184
3 miles: 52,119
5 miles: 101,422



Average HH Income

1 mile: \$116,751
3 miles: \$115,469
5 miles: \$125,308



Daytime Employment

Businesses

2 mile: 1,528
5 miles: 13,088
10 miles: 28,406



Daytime Employment

Employees

2 mile: 10,434
5 miles: 128,084
10 miles: 266,814

SITE PLAN



Desert Canyon Center

E McDowell Mountain RD.

Available Suites

1,800 SF - 2,100 SF Retail

Anchors

- * Classic Cooking Academy
- * Thompson 105 Restaurant
- * Honor Health
- * Casey Preschool
- * Smile Dentistry

Area Information

- * Approximately 4,000 students are in the surrounding area
- * 34% of the surrounding community is classified as Professional Pride which has an average household size of 3.13 people, median age of 41 and a median household income

105 TH STREET

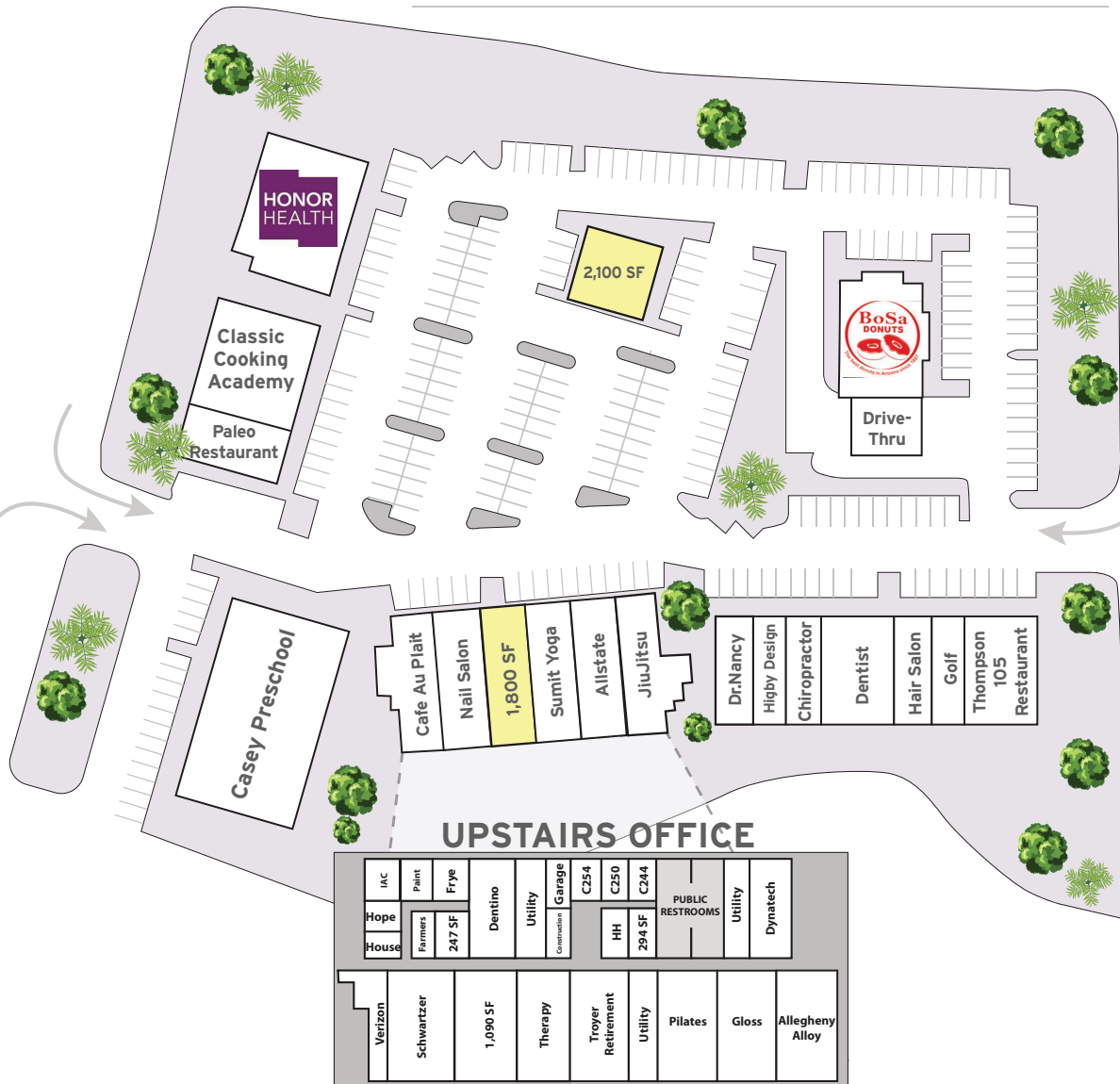

CONTACT



AVAILABLE 3,500 SF

For leasing information:

NATALIA BABITS

NC@AZPRE.COM | 602.488.7178

BEN EPSTEIN

BE@AZPRE.COM | 602.397.0886

A Z P R E . C O M | Arizona Partners | Mercado Del Lago

8300 N. Hayden Rd. Ste. A 200 | Scottsdale, AZ 85258 | p 480.368.0111 | f 480.368.0444

