



BAY ROBERTS MALL

153-159 Conception Bay Highway
Bay Roberts (NL) A0A 1G0

±38.5k Trade area population

80,000 sq. ft.

12 stores

450 parking spaces

Bay Roberts is the largest town on the Bay de Verde Peninsula, providing easy access to local businesses for over half of the province's population. The mall is located at the corner of Coley's Point North Road, Exit 70 off Highway 1.

NEWFOUNDLAND

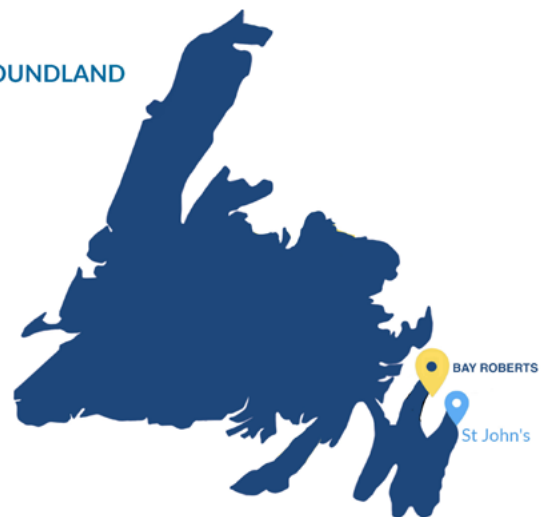

BAY ROBERTS MALL

	STORE LIST	SQ. FT.
1	JUST COZY	4,433
2	AVAILABLE	1,595
3	AVAILABLE	4,664
5	AVAILABLE	811
6	AVAILABLE	2,583
9	PET VALU	3,919
12	JEWELLERY PLUS	882
14	AVAILABLE	623
15	ECLIPSE	1,442
16	BANK OF MONTREAL	4,664
100	DOLLARAMA	13,361
110	ROSSY	26,620
K1	ATLANTIC LOTTERY	
	GROSS LEASABLE AREA	65,597
F1	KFC	2,641
F2	CIRCLE K / IRVING	10,000

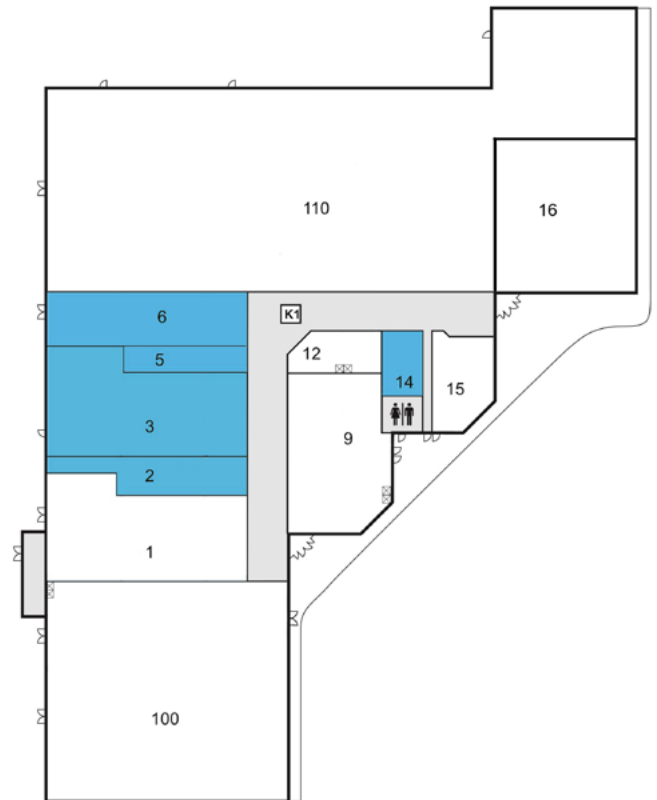

Howard Wiseman
President and COO
(514) 516-1345
howard@emrealestate.ca

Kyle Wiseman
Leasing Specialist
(514) 566-3879
kyle@emrealestate.ca

Wanda Pittman
Director of Real Estate – Atlantic Canada
(709) 571-3276
wanda@emrealestate.ca