



SHELBURNE MALL

115 King Street
Shelburne (NS) B0T 1W0

± 18k Trade area population

89,000 sq. ft.

11 stores

275 parking spaces

The town of Shelburne is a center for fishing and shipbuilding, the two primary industries driving its economy. Other key sectors include lumbering and the manufacturing of institutional furniture, granite monuments, and marine supplies. The mall is located at the corner of Elliot Street, near Exits 25 and 26 off Highway 103. With ample parking and strong anchors such as Sobeys, The Bargain! Shop, and Lawtons Drug Store, residents can meet their everyday shopping needs at this one-stop destination.

NOVA SCOTIA



SHELBURNE MALL

STORE LIST

3	LAWTON'S DRUGS	10,000
5	SOBEYS (STORAGE)	1,622
6	GREAT CANADIAN DOLLAR STORE	6,504
10	PET VALU	3,711
16	CM OPTICAL	1,141
17	AVAILABLE	2,113
18	AVAILABLE	700
100	THE BARGAIN! SHOP	20,706
101	SOBEYS & NSLC	42,500
GROSS LEASABLE AREA		88,997
ABM BANK OF NOVA SCOTIA		

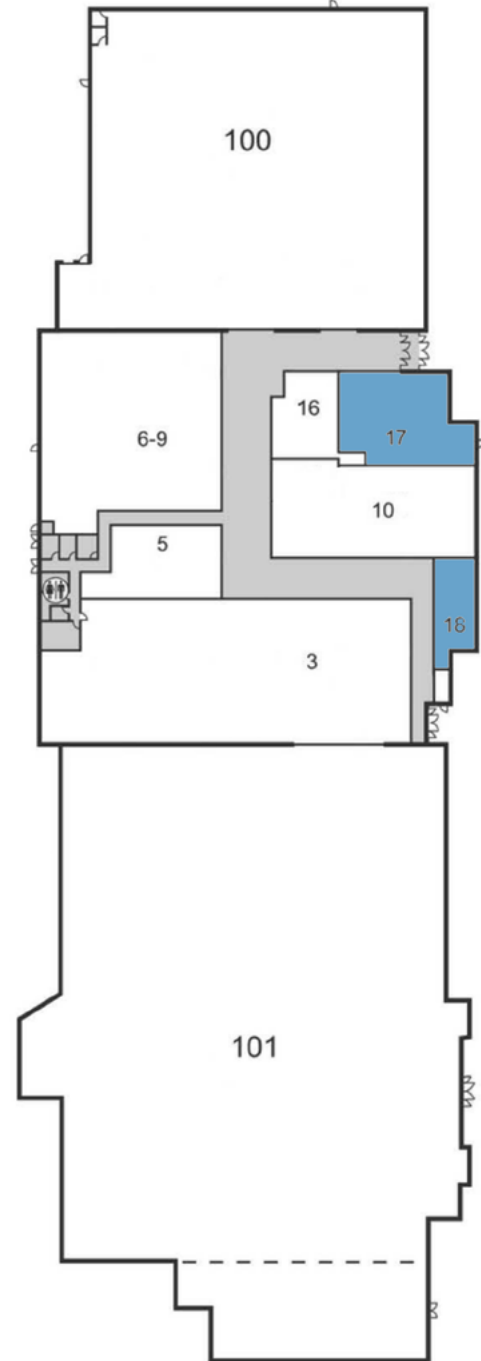

Howard Wiseman
President and COO
(514) 516-1345
howard@emrealestate.ca

Kyle Wiseman
Leasing Specialist
(514) 566-3879
kyle@emrealestate.ca

Wanda Pittman
Director of Real Estate – Atlantic Canada
(709) 571-3276
wanda@emrealestate.ca