

LOCATION

220-224 Boardman Canfield Rd, Boardman, OH 44512

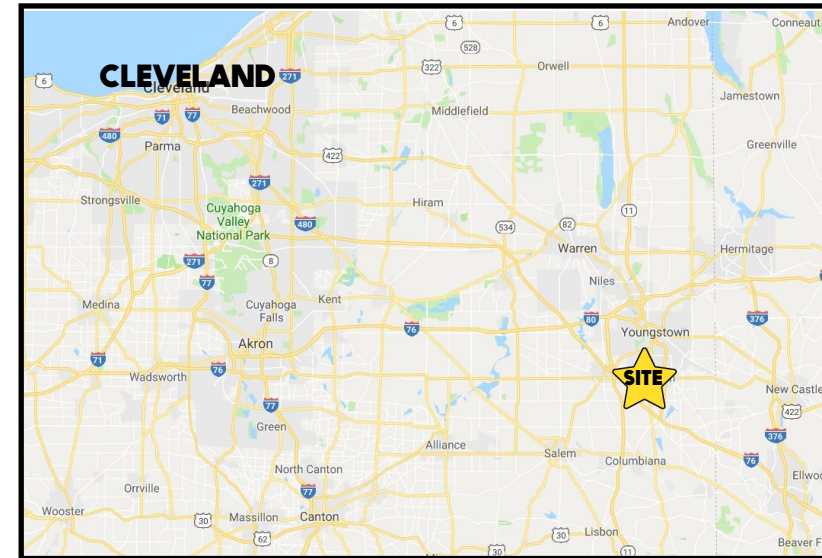

TRAFFIC

Boardman Canfield Rd = 29,300 VPD

3D TOUR Coming Soon

HIGHLIGHTS

- Endcap retail space (Former With Needle In Hand)
- Located in a high traffic count area - close to residential, retail, and professional offices
- Front door parking
- Great building and street signage

CONTACT

BILL KUTLICK

330.565.5701

bkutlick@platzrealtygroup.com

Office: 330.757.4889 | Fax: 330.294.5622 | 3830 Starr Centre Dr, Suite 2, Canfield, OH 44406

www.PLATZREALTYGROUP.com



Office: 330.757.4889 | Fax: 330.294.5622 | 3830 Starr Centre Dr, Suite 2, Canfield, OH 44406

www.PLATZREALTYGROUP.com



Office: 330.757.4889 | Fax: 330.294.5622 | 3830 Starr Centre Dr, Suite 2, Canfield, OH 44406

www.PLATZREALTYGROUP.com

The information presented was obtained from sources believed to be true and reliable. The Platz Realty Group makes no warranties or guarantees to the accuracy of the information.

[3D Tour](#)

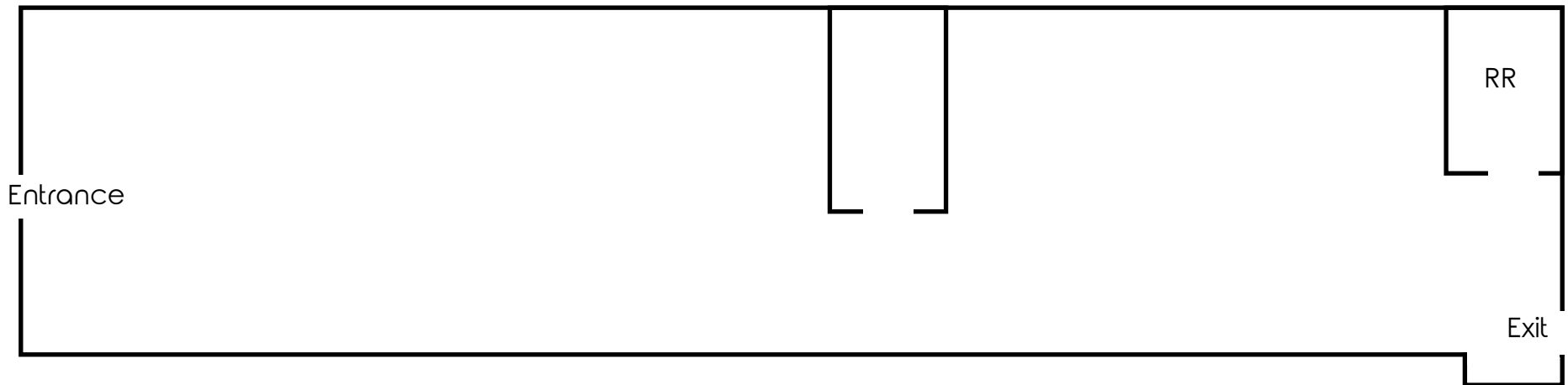

Office: 330.757.4889 | Fax: 330.294.5622 | 3830 Starr Centre Dr, Suite 2, Canfield, OH 44406

www.PLATZREALTYGROUP.com

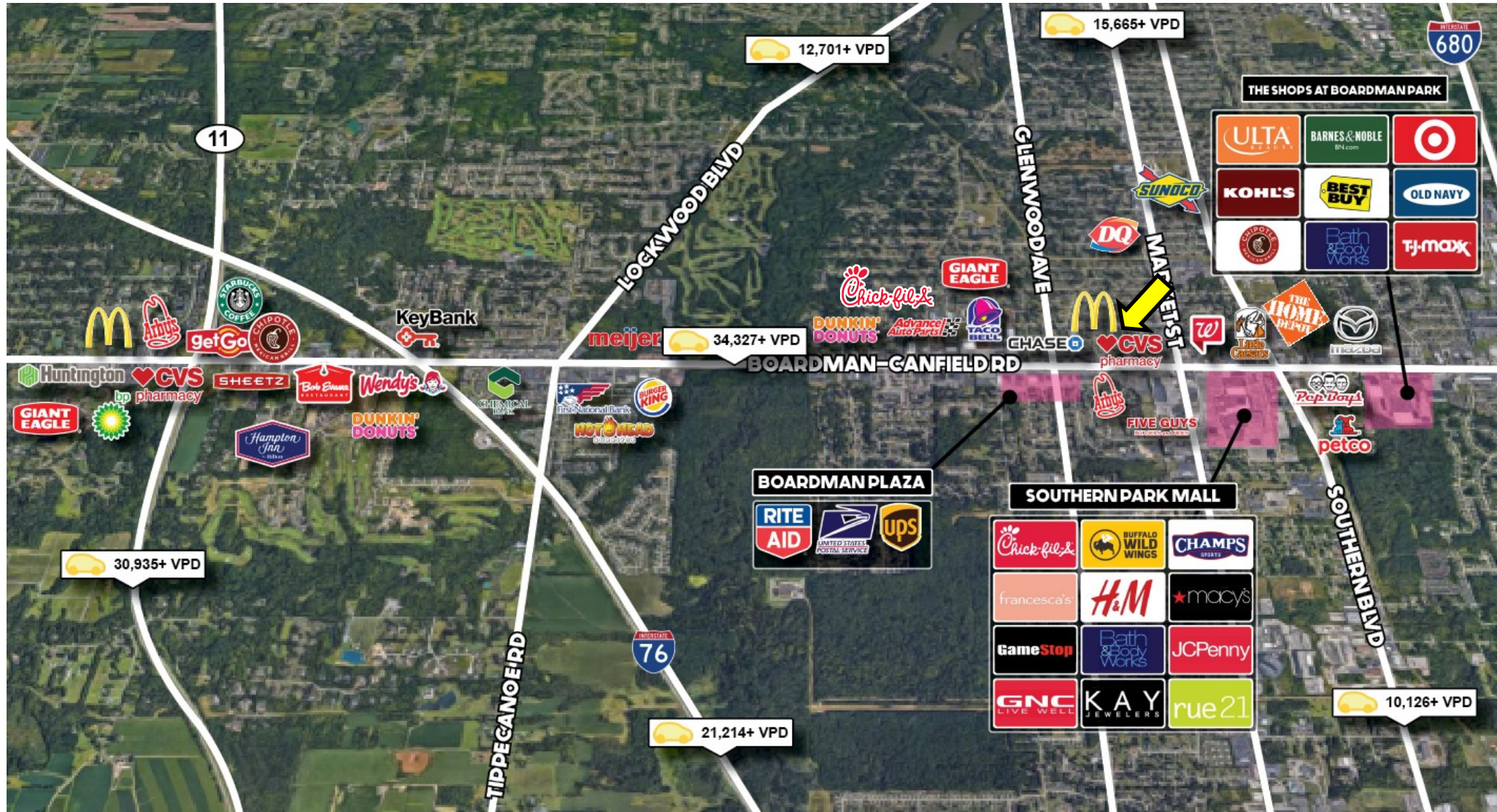

Office: 330.757.4889 | Fax: 330.294.5622 | 3830 Starr Centre Dr, Suite 2, Canfield, OH 44406

www.PLATZREALTYGROUP.com

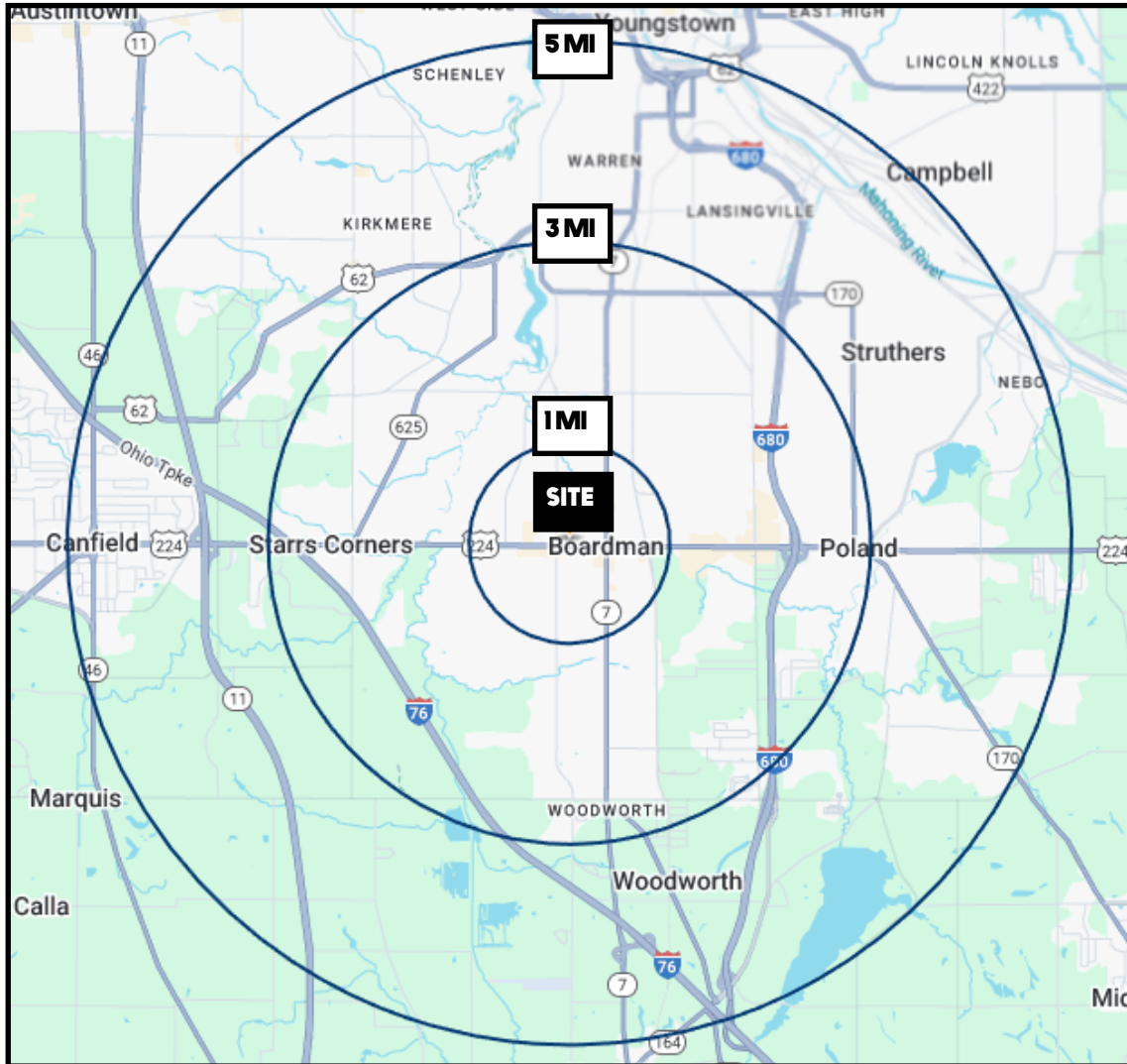

DEMOGRAPHICS	1 MI	3 MI	5 MI
POPULATION	7,621	50,040	114,018
HOUSEHOLDS	3,480	22,274	49,952
MEDIAN AGE	44	44	44
AVERAGE HH INCOME	\$74,132	\$77,297	\$72,223

SITE INFORMATION

LOCATION	Boardman Township Mahoning County
PROPERTY TYPE	Retail
SIZE	Needle: 1,470 SF Coming Soon: 1,600 SF +/-
SIGNAGE	Building and street
UTILITIES	Separately metered
RENT	\$10.00-\$11.00/SF NNN
NNN CHARGES	Estimated at \$3.27/SF

Office: 330.757.4889 | Fax: 330.294.5622 | 3830 Starr Centre Dr, Suite 2, Canfield, OH 44406