

BURNT POPLAR BUSINESS PARK

GREENSBORO

6348 Burnt Poplar Road
Greensboro, NC 27409



FOR LEASE

±31,000 SF



LEASED BY



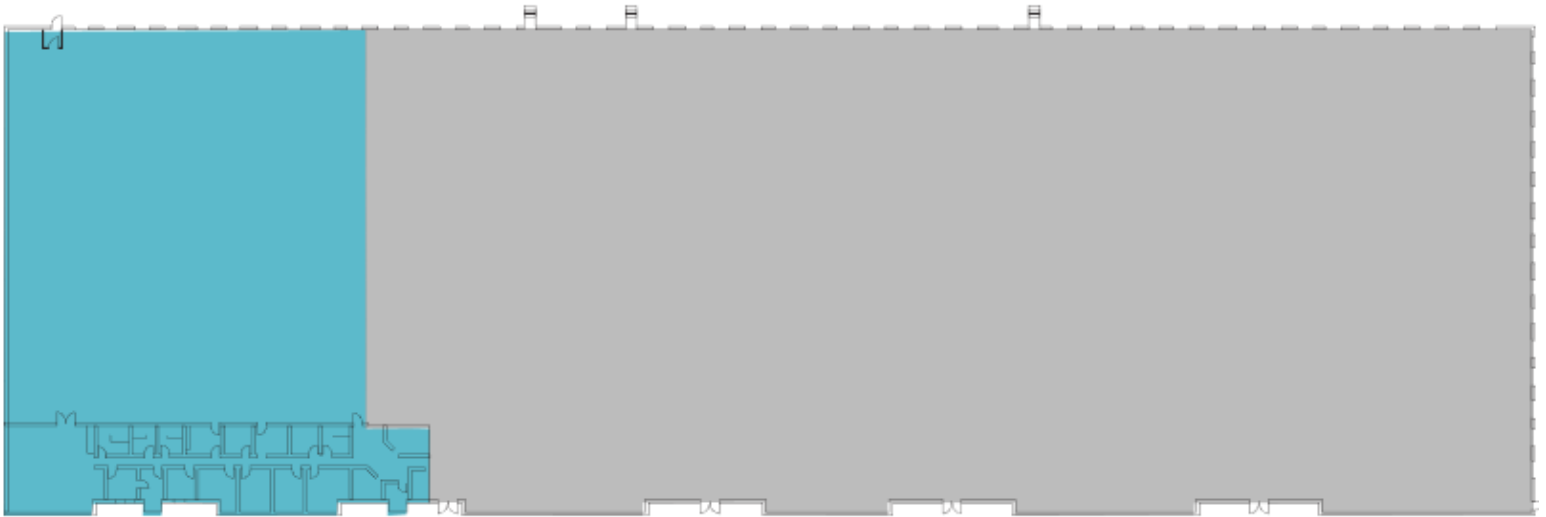

6348 BURNT POPLAR ROAD - SUITE C

Available SF: 31,000 SF

Lighting: Motion sensor LED

Office SF: 6,554 SF

Sprinkler: Wet System

Clear Height: 20' from first column line

Dock Doors: 10 (8' x 9' W/Bumpers, seals and edge of dock levelers)

Column Spacing: 25' x 67'

Drive-In Door: 1 (14' x 12')

Power: Panel shows 1200 amp 208Y/120

Zoning: HI (Heavy Industrial)



CONTACT INFORMATION

6348 BURNT POPLAR RD,
GREENSBORO NC 27409

Ryan Conboy, SIOR

ryan.conboy@cushwake.com
(336) 821-3832

Bobby Finch

bobby.finch@cushwake.com
(336) 812-3303

This document is for informational purposes only and does not constitute an offer or acceptance of a lease. Any lease agreement must be in writing and signed by the landlord. No representations or warranties are made except as expressly stated in a signed lease. Information is provided "as is" and may be subject to errors or change without notice.



LEASED BY

