

FREESTANDING INDUSTRIAL FOR LEASE ±7,100 SF

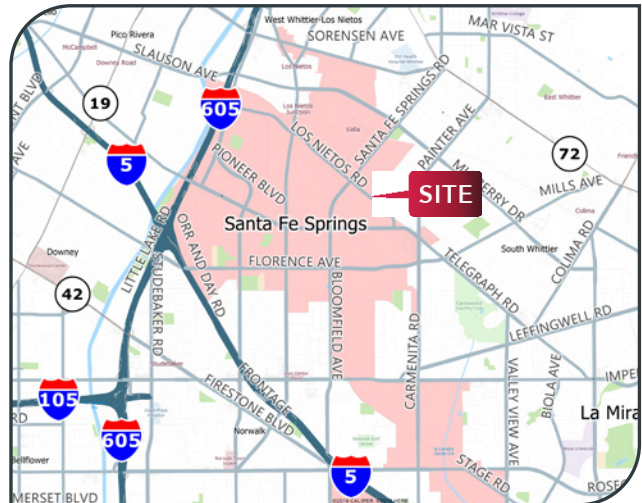

PROPERTY HIGHLIGHTS

- 7,100 SF Freestanding Industrial Building
- High Image Industrial Park Environment
- 1,023 SF Office (2 Private + Reception)
- 16' Minimum Clear Height
- 400 AMP Electrical Service 120/208V
- Fire Sprinklers .20 GPM/1,500 SF
- 2 Ground Level Doors
- 18 Parking Spaces
- 2006 Construction
- \$1.45 PSF Gross, No CAM,



ALL INFORMATION CONTAINED HEREIN HAS BEEN PROVIDED BY SELLER, LANDLORD, AND/OR THIRD PARTIES, BUT HAS NOT BEEN INDEPENDENTLY VERIFIED BY LEE & ASSOCIATES OR ITS AGENT(S). BUYER, TENANT AND/OR INTERESTED PARTIES SHOULD INDEPENDENTLY VERIFY ALL INFORMATION COMMUNICATED BY THESE SOURCES.



Phillip DeRousse

Principal | Lee & Associates
D: 714.564.7141
pderousse@lee-associates.com
DRE# 01933061

Joel Hutak

Principal | Lee & Associates
D: 714.564.7169
jhutak@lee-associates.com
DRE# 01411356

Bart McNulty

Agent | Lee & Associates
D: 714.564.7121
bmcnulty@lee-associates.com
DRE# 02153750

FREESTANDING INDUSTRIAL FOR LEASE ±7,100 SF

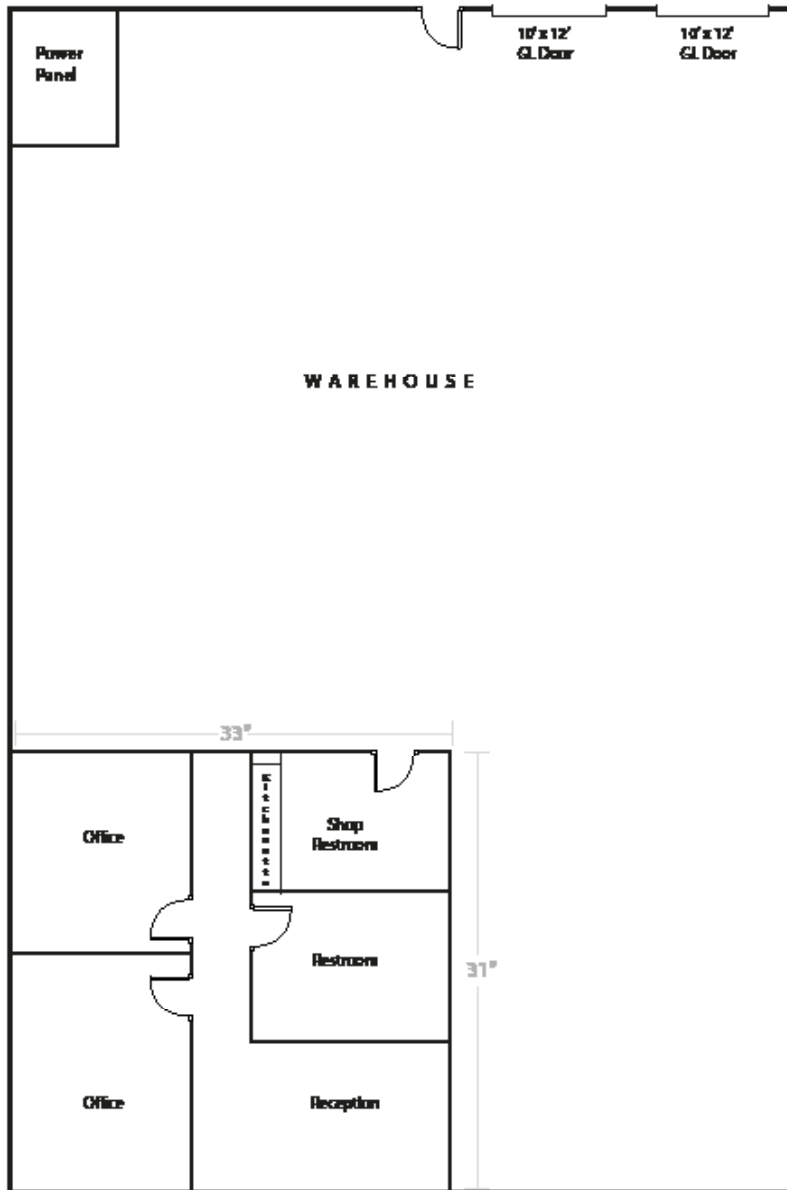

ALL INFORMATION CONTAINED HEREIN HAS BEEN PROVIDED BY SELLER, LANDLORD, AND/OR THIRD PARTIES, BUT HAS NOT BEEN INDEPENDENTLY VERIFIED BY LEE & ASSOCIATES OR ITS AGENT(S). BUYER, TENANT AND/OR INTERESTED PARTIES SHOULD INDEPENDENTLY VERIFY ALL INFORMATION COMMUNICATED BY THESE SOURCES.



Phillip DeRousse

Principal | Lee & Associates
D: 714.564.7141
pderousse@lee-associates.com
DRE# 01933061

Joel Hutak

Principal | Lee & Associates
D: 714.564.7169
jhutak@lee-associates.com
DRE# 01411356

Bart McNulty

Agent | Lee & Associates
D: 714.564.7121
bmcnulty@lee-associates.com
DRE# 02153750