

For Sale

CBRE

2108 Bering Dr Unit D

San Jose, CA
www.cbre.com/siliconvalley





Property Highlights

- + Constructed in 1977
- + Two Concrete Tilt, R&D/
Industrial Condos
- + Shared Yard
- + Proximity to 101/880 Freeways

Unit D Highlights

- + ±3,190 SF
- + Office
- + Lab
- + APN: 237-11-063
- + Warehouse Area
- + Grade Level Loading
- + Power: 125 amps, 120/240V,
3 Phase
- + 0.08 Acres

Parcel Map

2108 Bering Drive
San Jose, CA

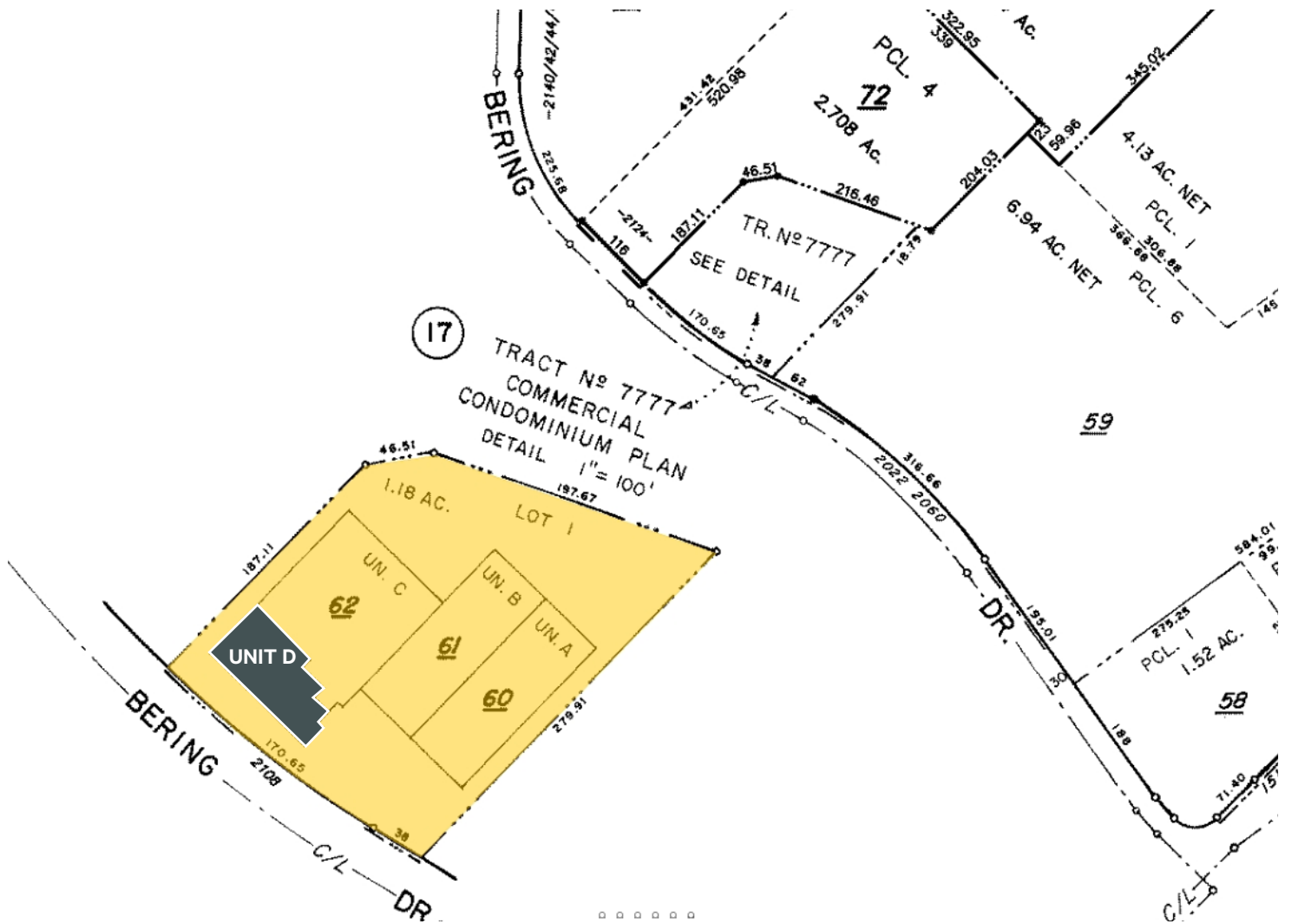

Unit D

2108 Bering Drive
San Jose, CA



Unit D Exterior

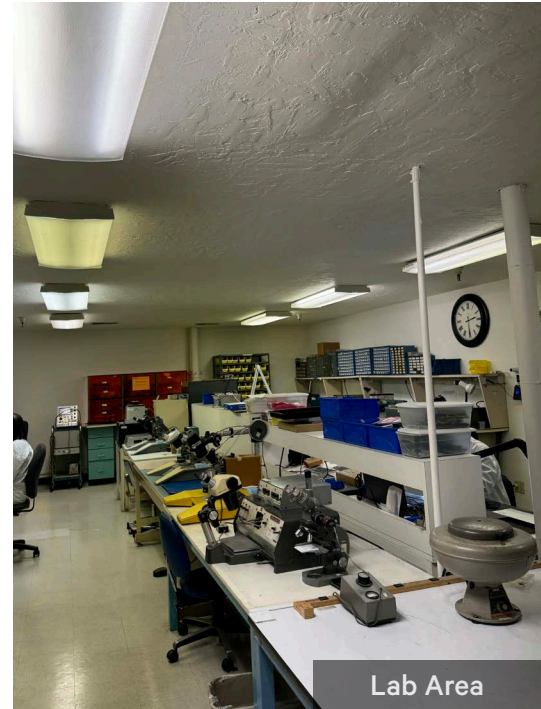

Lab Area



Grade Level

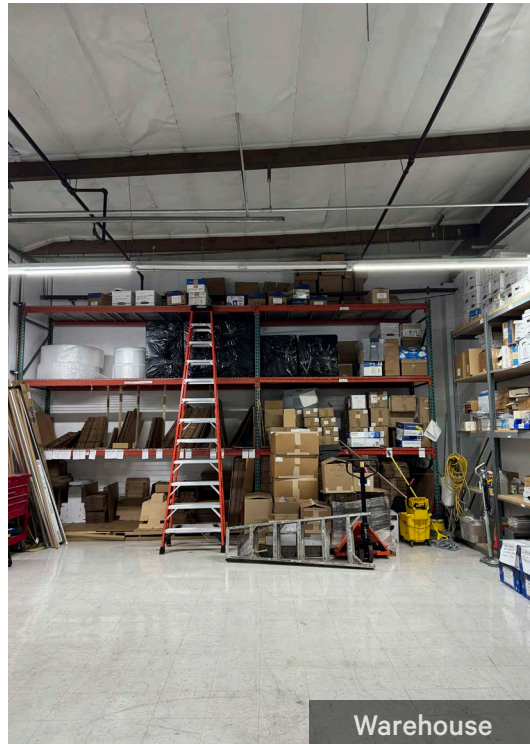

Warehouse



Lab

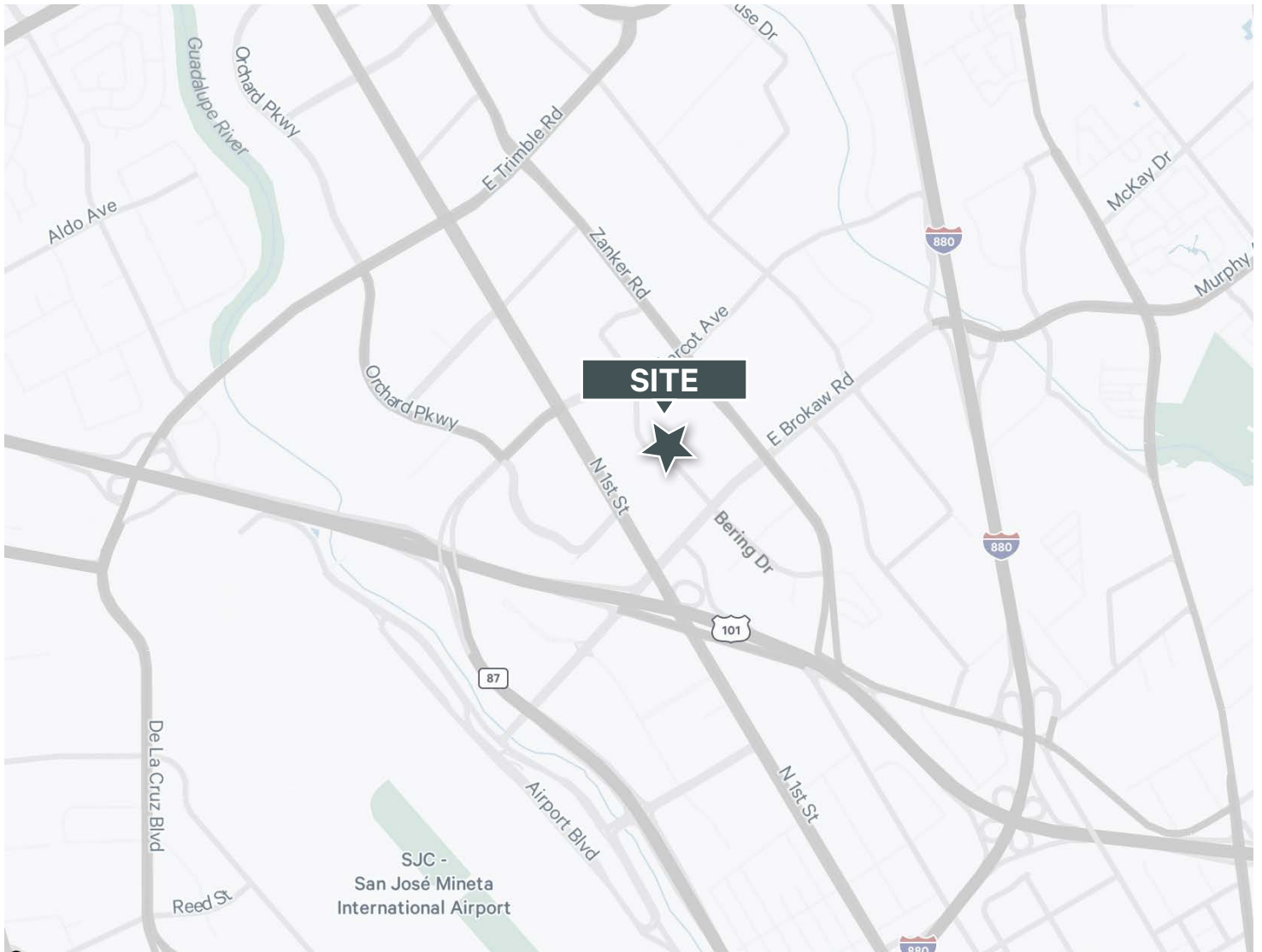

Contact Us

Mark Christerson

Executive Vice President
+1 408 453 7452
mark.christerson@cbre.com
Lic. 01296954

Hai T. Dang

Senior Vice President
+1 408 790 5433
hai.dang@cbre.com
Lic. 01404853

© 2025 CBRE, Inc. All rights reserved. This information has been obtained from sources believed reliable but has not been verified for accuracy or completeness. CBRE, Inc. makes no guarantee, representation or warranty and accepts no responsibility or liability as to the accuracy, completeness, or reliability of the information contained herein. You should conduct a careful, independent investigation of the property and verify all information. Any reliance on this information is solely at your own risk. CBRE and the CBRE logo are service marks of CBRE, Inc. All other marks displayed on this document are the property of their respective owners, and the use of such marks does not imply any affiliation with or endorsement of CBRE. Photos herein are the property of their respective owners. Use of these images without the express written consent of the owner is prohibited.