

FOR LEASE

Owned and Operated by



Hayward Business Park

1495 Zephyr Avenue, Hayward, CA

±23,424 SF



**LEASING INFO
& CONTACT**

Garrett Dunn
Chris Stauber
John Lagomarsino

(925) 297 9449 / garrett.dunn@colliers.com
(925) 964 3277 / chris.stauber@colliers.com
(925) 885 9320 / john.lago@colliers.com



This is not an offer or acceptance of an offer to lease space. A lease will only be offered or made in a written agreement signed by landlord. No representation or warranty of any kind is made by landlord unless set forth in a written definitive lease executed by the landlord.

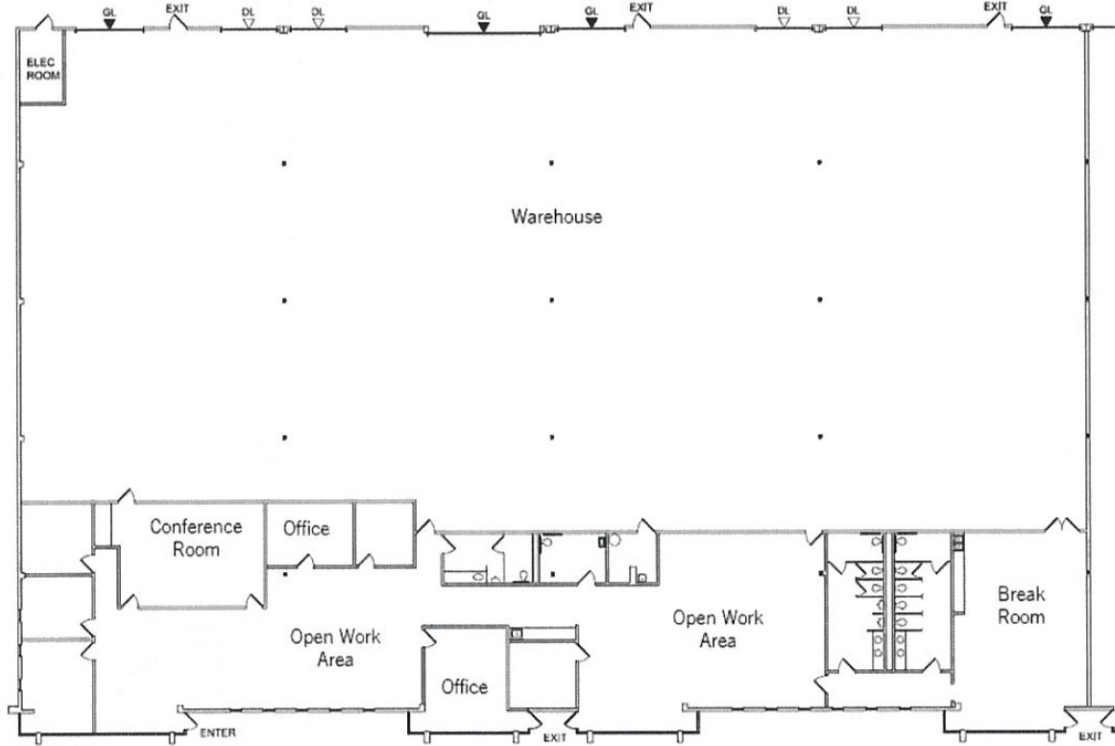

Property Specifications:

- Corner unit
- ±30% office, balance warehouse space
- Three (3) dock-high doors
- Three (3) grade level doors
- ±18' clear height
- ±1,200 amps @ 120/208V (Tenant to confirm)
- Fully sprinklered
- Easy access to Hwy I-880

Lease Rate: \$1.40/SF/Month, NNN
(\$0.31/SF/Month, OPEX)

Available Now.
Call Brokers for Touring Instructions.



Site Plan

