

# 1400 E Olympic Blvd

Suite B | Los Angeles, CA. 90021

# FOR LEASE

## ±40,500 SF Food Distribution Facility with Cold Storage & Cross-Dock Capabilities



## Highlights

- Cross-Dock Loading with 30 DH Positions & 1 GL Ramp
- ±11,180 SF of Existing Cooler Space (32°F–38°F)
- 5 Cooler Boxes, Including 3 Newly Renovated
- Prime Location Adjacent to Produce Mart
- Immediate Freeway Access



## Specifications

	<b>Available SF:</b>	±40,500 SF
	<b>Land Size:</b>	POL
	<b>Year Built:</b>	1984
	<b>Clear Height:</b>	23'
	<b>Loading:</b>	30 DH / 1 GL
	<b>Existing Coolers:</b>	±11,180 SF
	<b>Sprinkler:</b>	YES



900 Wilshire Boulevard, Suite 2400  
Los Angeles, CA 90017  
cushmanwakefield.com  
Lic #01880493

For more information, please contact:

**BRANDON GILL**  
Executive Director  
**+1 213 629 6528**  
brandon.gill@cushwake.com  
Lic #01262330

**BRANDON BURNS**  
Executive Director  
**+1 213 629 6541**  
brandon.burns@cushwake.com  
Lic #01194796

**JAE YOO**  
Executive Director  
**+1 213 629 6551**  
jae.yoo@cushwake.com  
Lic #01503567

**DILLON KNEAFSEY**  
Associate  
**+1 213 629 6519**  
dillon.kneafsey@cushwake.com  
Lic #02439066

# Site Plan

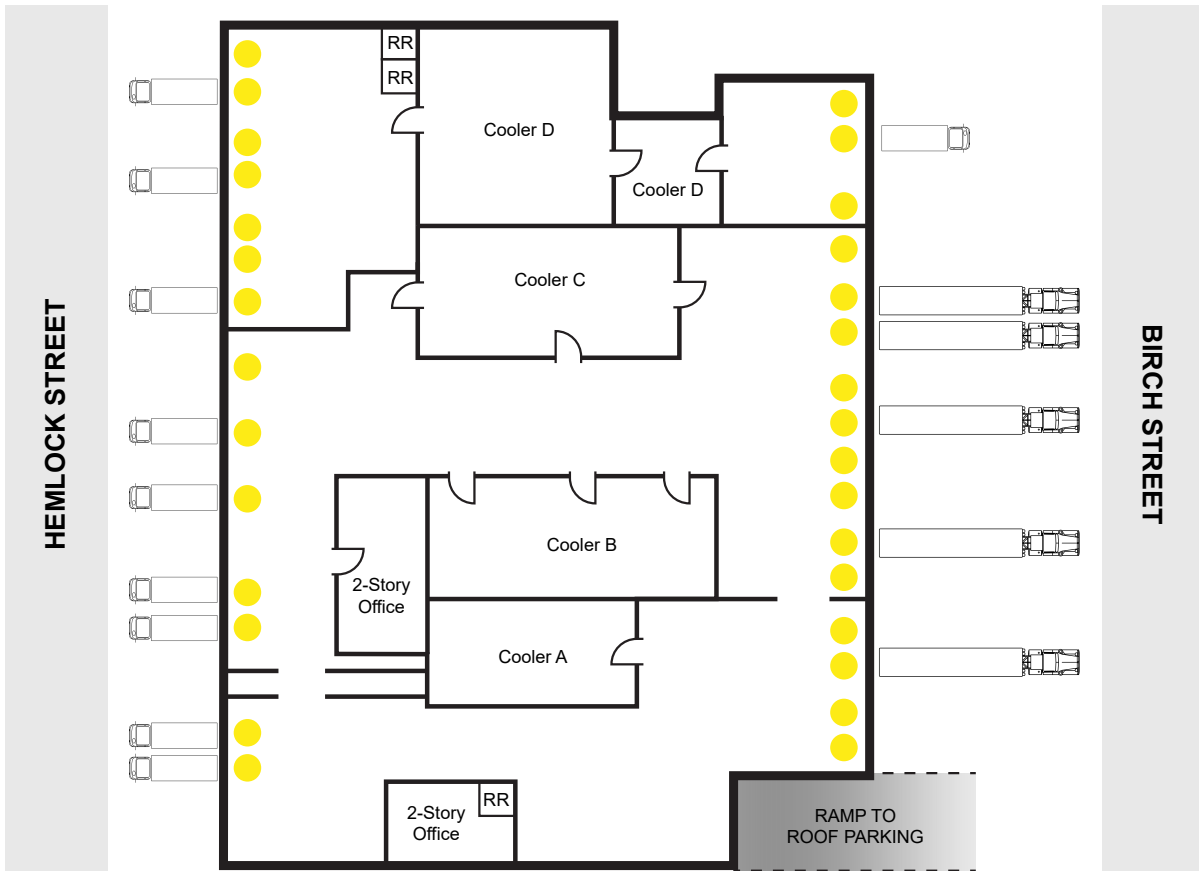

 DOCK HIGH LOADING

For discussion purposes only and not to scale - Tenant to verify.



900 Wilshire Boulevard, Suite 2400  
 Los Angeles, CA 90017  
 cushmanwakefield.com  
 Lic #01880493

For more information, please contact:

**BRANDON GILL**  
 Executive Director  
 +1 213 629 6528  
 brandon.gill@cushwake.com  
 Lic #01262330

**BRANDON BURNS**  
 Executive Director  
 +1 213 629 6541  
 brandon.burns@cushwake.com  
 Lic #01194796

**JAE YOO**  
 Executive Director  
 +1 213 629 6551  
 jae.yoo@cushwake.com  
 Lic #01503567

**DILLON KNEAFSEY**  
 Associate  
 +1 213 629 6519  
 dillon.kneafsey@cushwake.com  
 Lic #02439066