

2 RIVERWAY

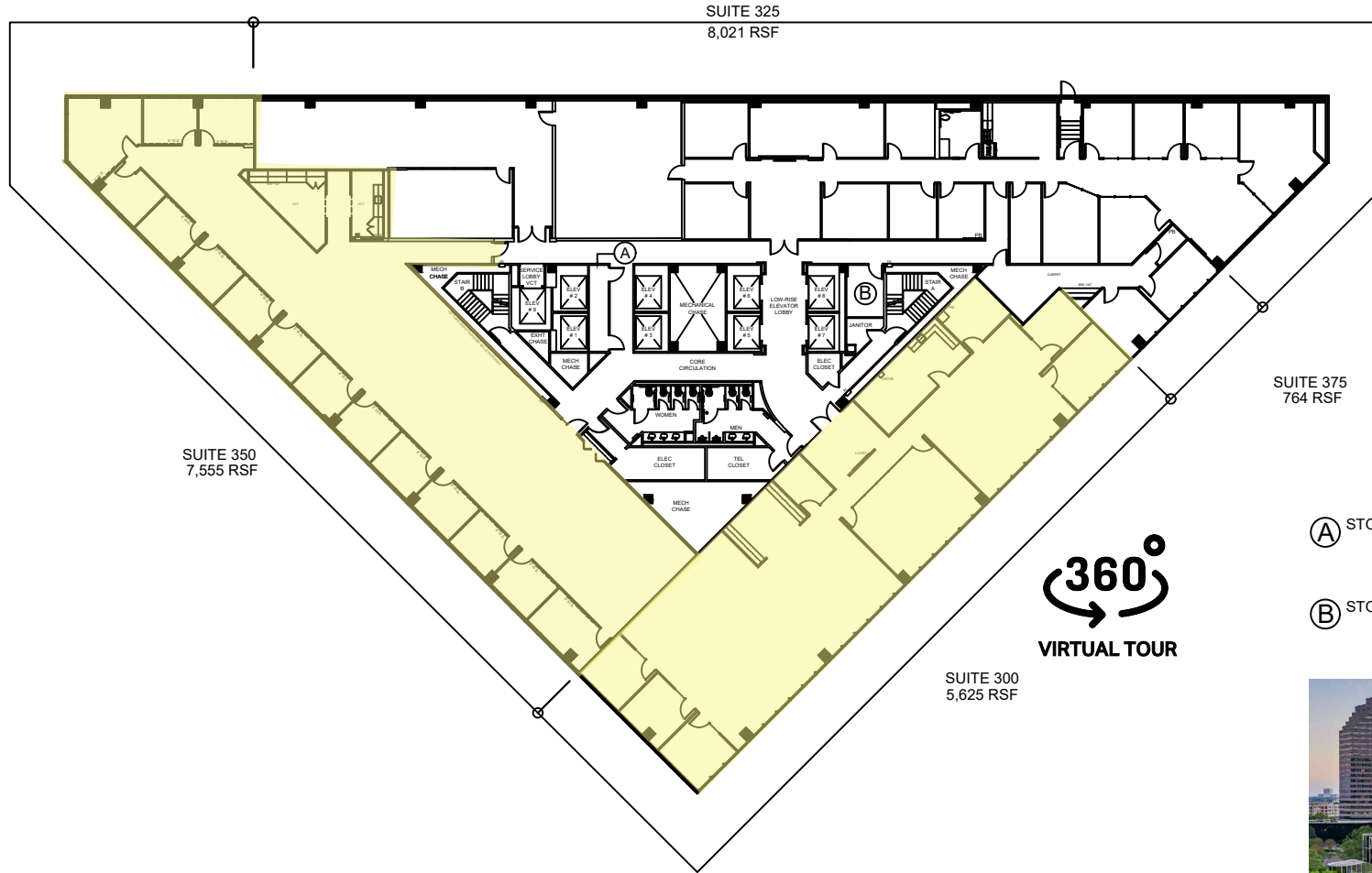

360°
VIRTUAL TOUR

- (A)** STORAGE SPACE
97 RSF
- (B)** STORAGE SPACE
111 RSF



Floor plans are for conceptual purposes only; they are not to scale and may not reflect existing conditions. As-builts must be verified. Not for regulatory approval, permitting, or construction.

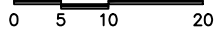

LEASING CONTACT

LOUANN PEREIRA
(713) 272-1267
LOUANN.PEREIRA@TRANSWESTERN.COM

JACK SCHARNBERG
(713) 407-8717
JACK.SCHARNBERG@TRANSWESTERN.COM

LEVEL 03

CB22305.01-DC

SEPTEMBER 5, 2023



MANAGEMENT CONTACT

KATHRYN MARTIN
(713) 626-7100
KATHRYN.MARTIN@STREAMREALTY.COM



ARCHITECT CONTACT

5065 WESTHEIMER RD., STE #1100,
HOUSTON, TX 77056
PHONE: (713) 783.5900 | FAX: (713) 783.6066
WWW.CDI-DOUGLASS-PYE.COM