



5255 BROOK HOLLOW PKY

Norcross, GA
30071



OVERVIEW:

- » ±23,780 SF / 1.63 AC
 - » ±18,780 SF Warehouse
 - » ±5,000 SF Office
- » Zoned M1 - City of Norcross
- » 24' - 28' clear height
- » 2 dock-highs / 2 drive-ins
- » 600 AMP electrical
- » 34 parking spaces total / fenced outside storage

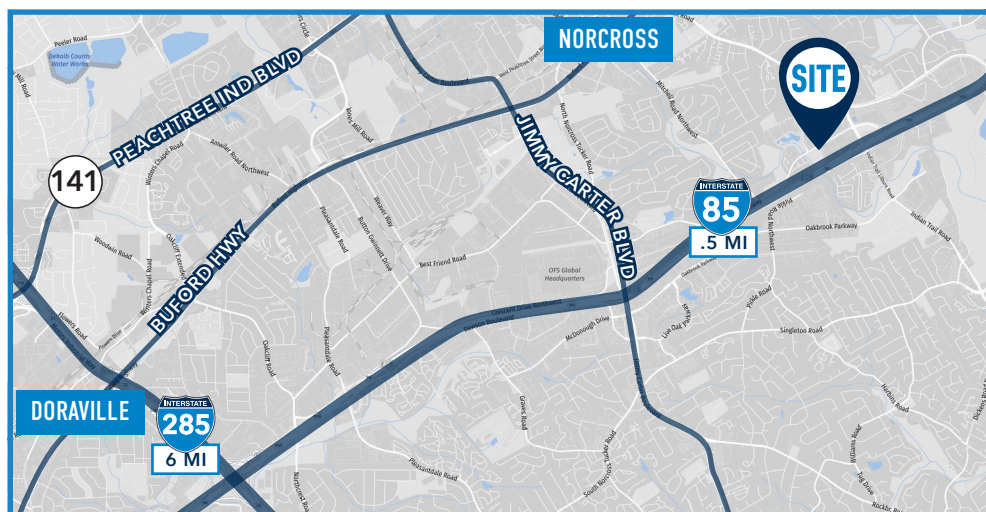

Jeb Gordon
404.456.6368
jgordon@skcr.com

Land Wright
404.668.8211
lwright@scotlandwright.com



SCOTLAND
WRIGHT
ASSOCIATES



5255 BROOK HOLLOW PKY

FLOOR PLAN
23,780 SF

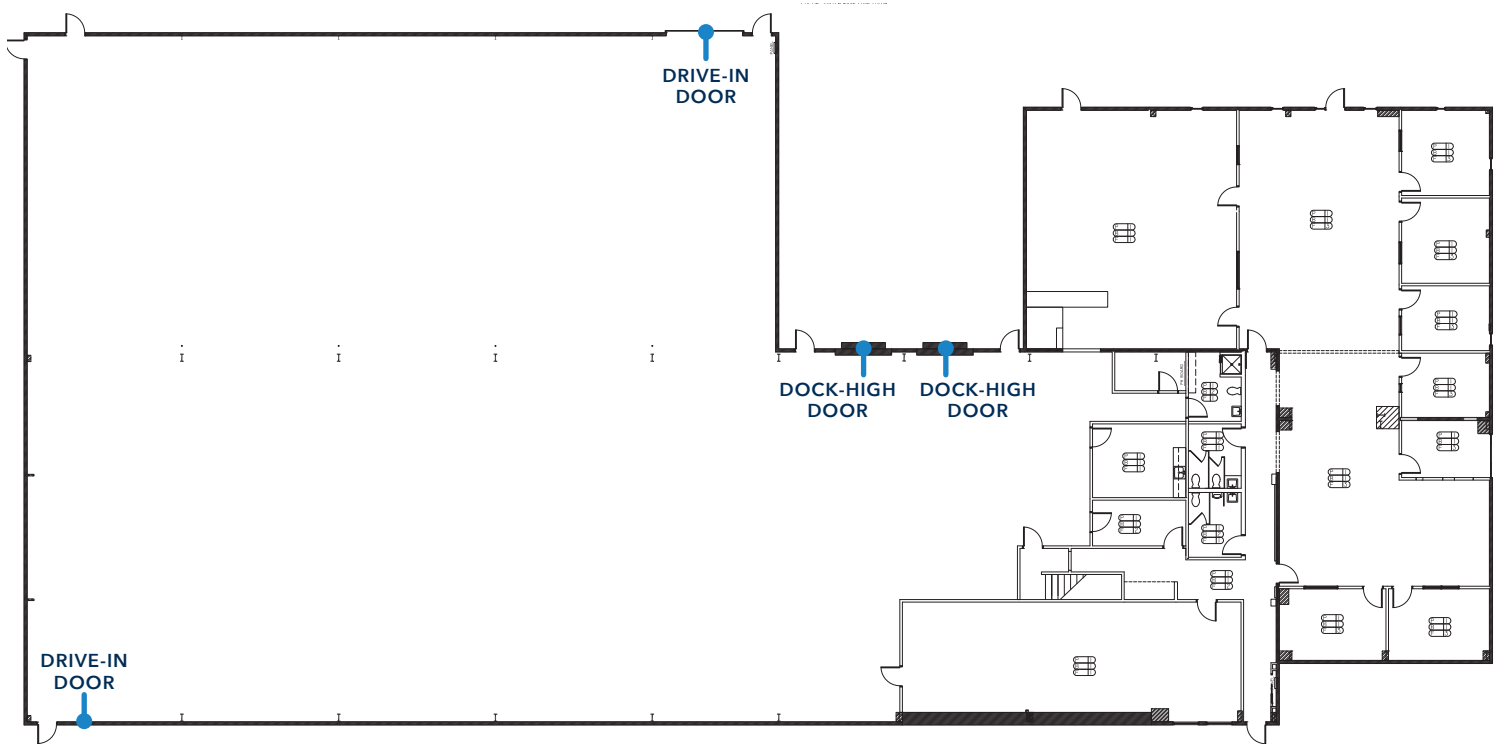

Jeb Gordon
404.456.6368
jgordon@skcr.com

Land Wright
404.668.8211
lwright@scotlandwright.com



SCOTLAND
WRIGHT
ASSOCIATES

