

OWNER:
TORVO PROPERTIES
 5311 KIRBY DRIVE
 HOUSTON, TX 77005

CLIENT:
TORVO PROPERTIES
 5311 KIRBY DRIVE
 HOUSTON, TX 77005



ACS Studio Architecture, LLC
 1322 Space Park Dr
 Suite B-122
 Houston, TX 77058
 tel: (713) 485-9140
 Based in Houston, TX
 Providing services across the USA

This is an unpublished survey document offered by ACS Studio Architecture, LLC. It is submitted for your personal use in connection with the contracted project performed by ACS Studio Architecture, LLC. It is not to be used, shown, reproduced, copied, downloaded or exhibited in any fashion whatsoever without the written permission of ACS Studio Architecture, LLC. All or any Part of this Survey document (Excepting Registered Trademarks) remains the property of ACS Studio Architecture, LLC.

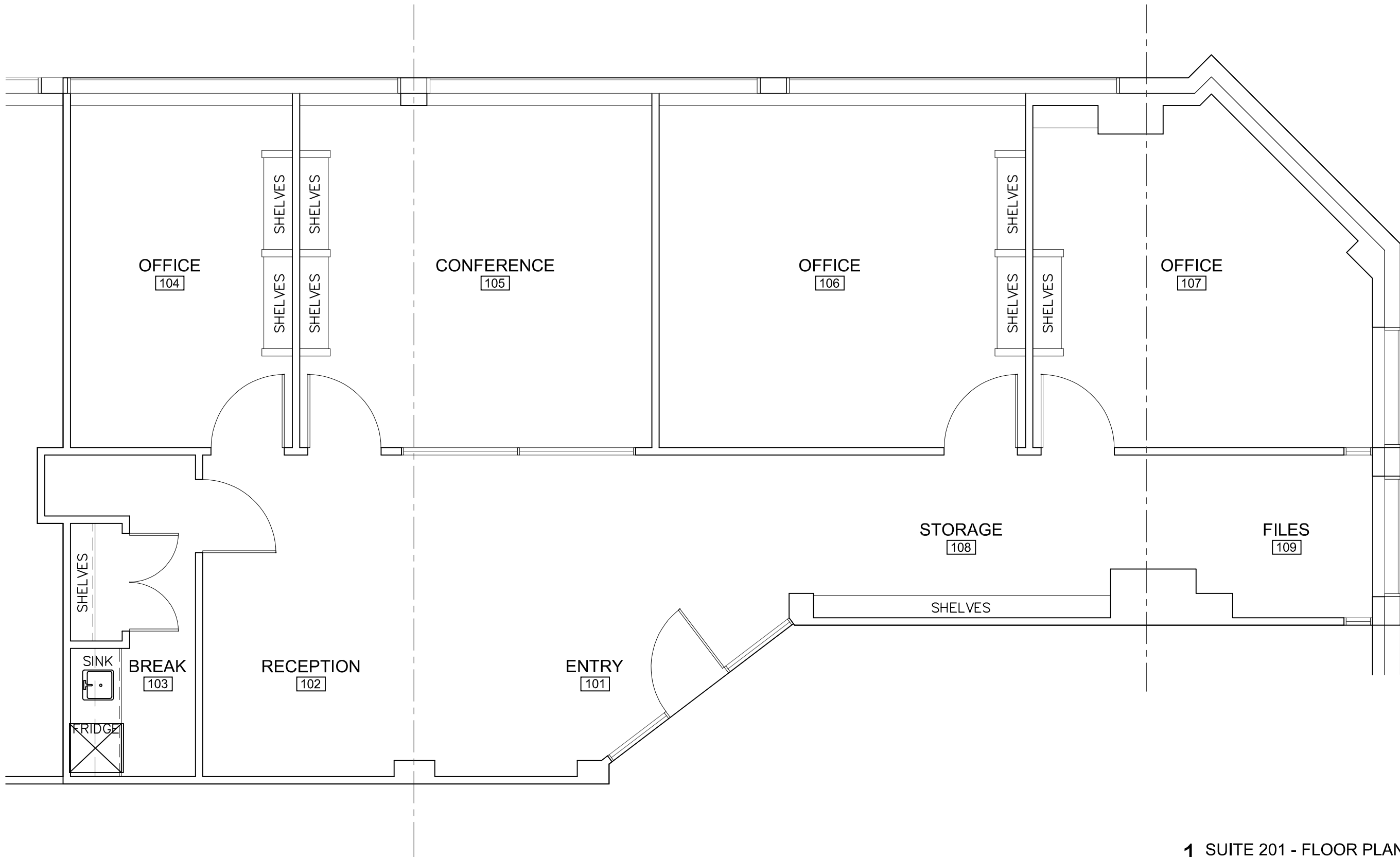

PROJECT NAME:	Suite 201
SQUARE FOOTAGE:	1,374 SF
PROJECT ADDRESS:	5311 Kirby Drive Houston, TX 77005

FIELD SURVEYOR:	C. Smith
PROJECT DIRECTOR:	C. Smith
CHECKED BY:	C. Smith
DATE COMPLETED:	01-01-2018

PROJECT NUMBER:	20180102
SHEET:	A2.01
DRAWING NUMBER:	01
OF:	01

DRAWING NAME:
ASBUILT FLOOR PLAN

1 SUITE 201 - FLOOR PLAN
 SCALE: 1/4" = 1'-0"

- CARPET FLOORING
- CERAMIC TILE FLOORING
- CONCRETE FLOORING
- QUARRY TILE FLOORING
- METAL FLOOR
- HARDWOOD FLOORING
- LINOLEUM TILE FLOORING

- SINK
- SINK2
- OVAL SINK
- URINAL
- TOILET
- DRINKING FOUNTAIN

- FL QUAD
- FL DUAL
- QUAD
- DUAL
- TEL/DATA

- FL TELPH
- FL DATA
- FL TEL/DATA
- DATA
- 360 VANTAGE POINT

- MAIN ENTRANCE
- ALARMED EXIT DOOR
- WINDOW
- DOOR

- COMPRESSOR
- WATER HEATER
- HEAT PUMP
- THERMOSTAT
- ELECT PANEL RECESSED

- GAS METER
- ELECT METER
- ELEC PANEL SURFACE MOUNT
- PLBC CLEAN OUT
- WATER METER

- CEILING HT. HEIGHT FROM FLOOR TO CEILING
- WALL / BUILDING SECTION SYMBOL

- EXTERIOR ELEVATOR SYMBOL
- SECTION KEY
- SHEET NUMBER
- COLUMN GRID SYMBOL

