

531

Atkinson Avenue

Retail for Lease in Thornhill | ON





531 Atkinson Avenue

Retail for Lease in Thornhill | ON

PROPERTY HIGHLIGHTS

Address	531 Atkinson Avenue, Thornhill		
Unit #	Unit 4	Unit 5 UNIT 5 LEASED	Unit 8 & 9
Total Unit Size	1,004 sq ft	1,004 sq ft	1,509 sq ft
Net Rent	\$45.00 Per Sq. Ft.		
TMI(2025)	\$17.50 Per Sq. Ft.		
Possession	Immediate		

Location Highlights:

- Excellent visibility at the busy intersection of Bathurst St and Atkinson Ave
- Ample surface parking on site with dual access points
- Minutes away from Highway 407
- Minutes from major landmarks like Promenade Shopping Centre, Westmount Collegiate Institute, and Uplands Golf & Ski Club.
- Strong co-tenancy with national and local retailers including Dairy Queen, Domino's Pizza, and Atkinson Medical Centre
- Situated within one of the area's most active retail corridors.

Unit 4&5:

- Former hair salon unit
- No food users permitted
- Suitable for wide variety of uses including learning centre, specialty medical, office, service retail, fashion and more

Unit 8&9:

- Former bakery space

Site Plan



Floor Plan - UNIT 4 & 5

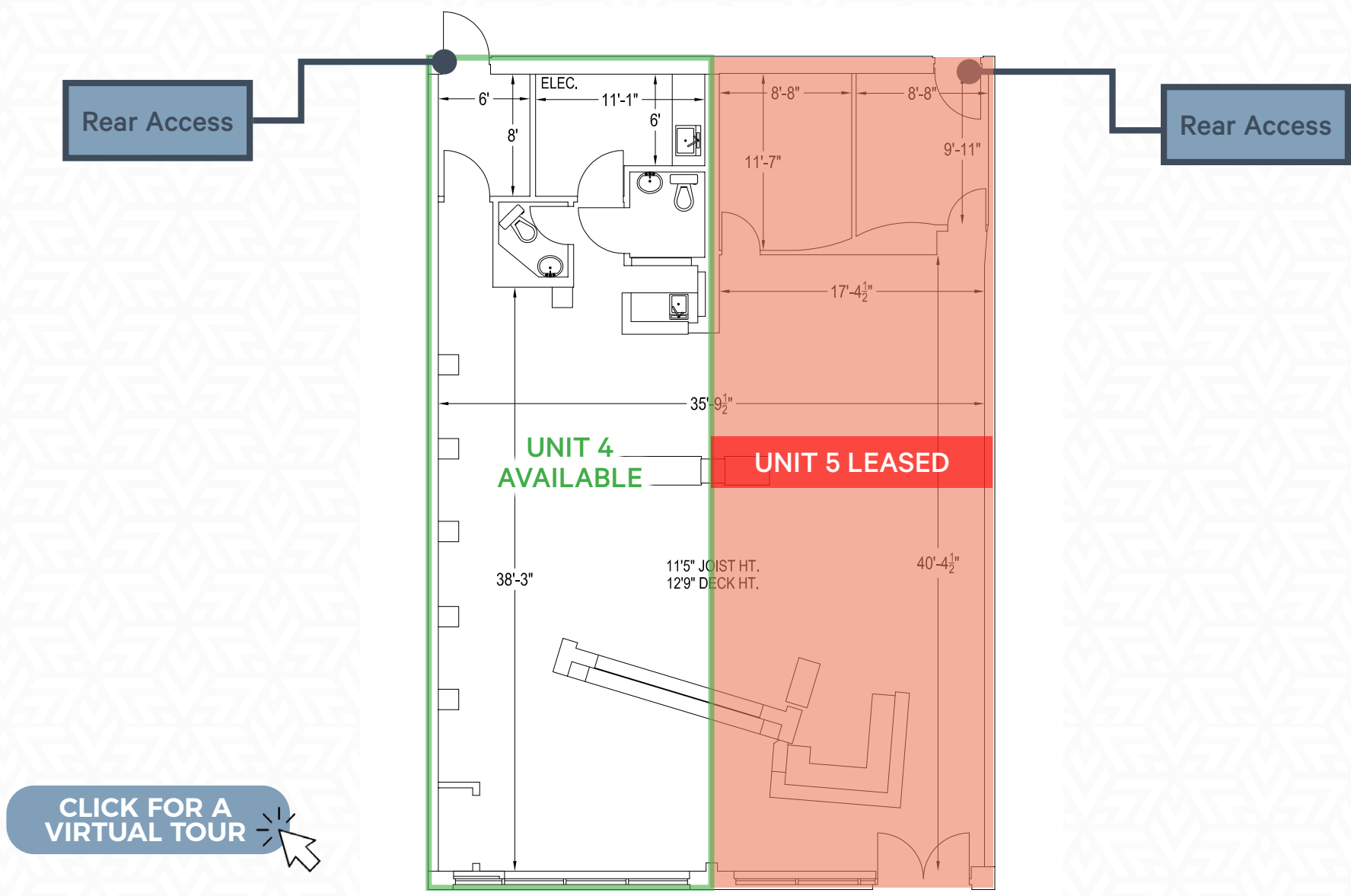

UNIT 4 & 5 - EXTERIOR



Floor Plan - UNIT 8 & 9

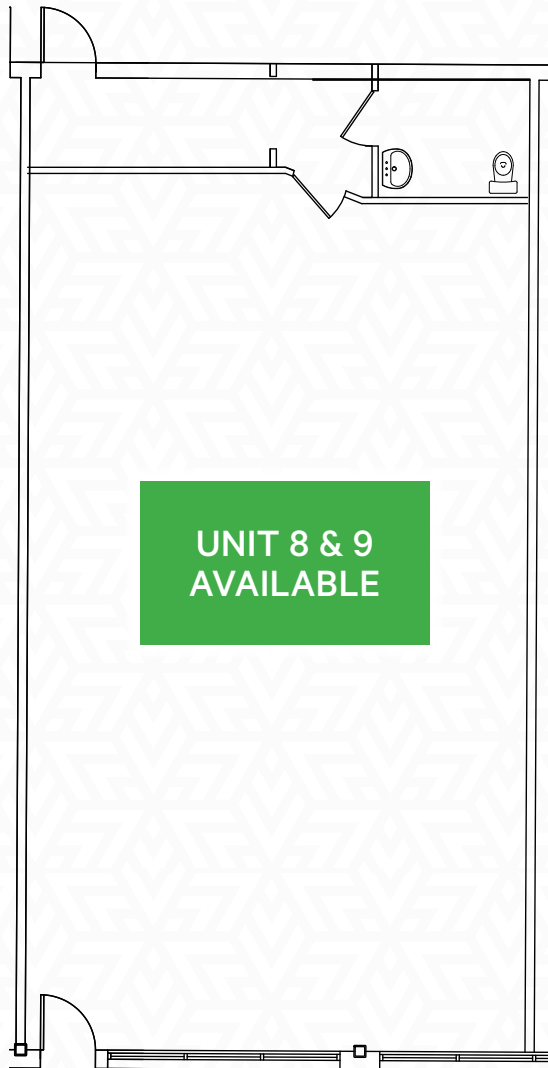

UNIT 8 & 9
AVAILABLE



Site Photos



AMENITIES & LOCATION



TRAFFIC COUNT

41,898





Cars Per Day
Bathurst St

THORNHILL TRANSIT ROUTE:

- 003 - NEW WESTMINSTER DR
- 105 - DUFFERIN ST / RACCO PKWY
- 105 - DUFFERIN ST / CARAWAY DR
- 023 - MAPLE SUGAR LANE



Demographics

	1 KM	3 KM	5 KM
 Total Population 2025	13,951	94,538	247,909
 Daytime Population 2025	10,106	81,173	261,874
 Population Growth 2025 - 2030	2.9%	5.9%	4.0%
 Household Income 2025	\$169,639	\$179,033	\$153,352

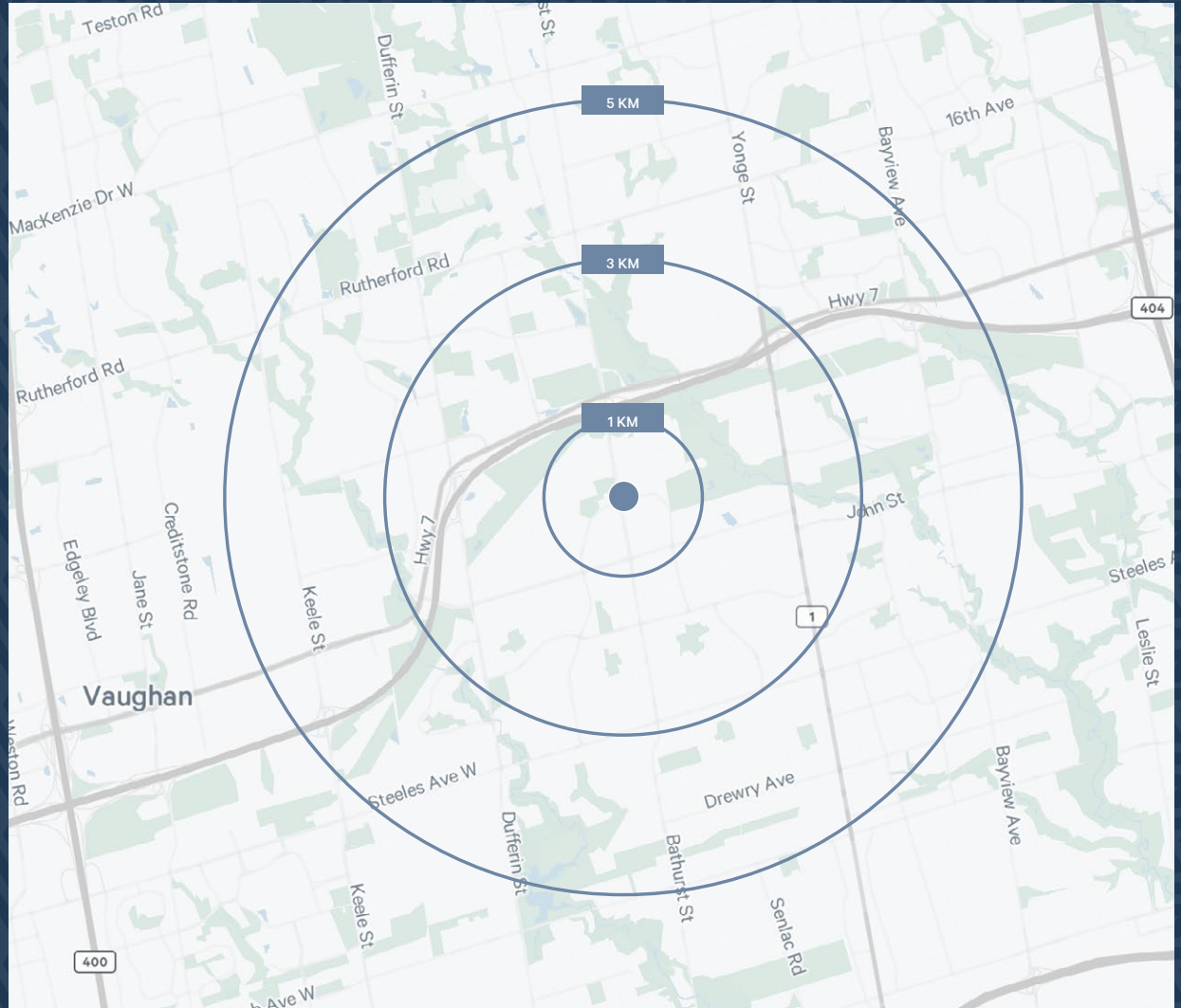

Zoning and Permitted Uses



CITY OF VAUGHAN | ZONING BY-LAW (C3 COMMERCIAL ZONE)

PERMITTED USES INCLUDING BUT NOT LIMITED TO:

- Bank or Financial Institution
- Brewers Retail Outlet
- Business or Professional Office
- Club or Health Centre
- Eating Establishment
- Eating Establishment, Convenience
- Eating Establishment, Take-Out
- L.C.B.O. Outlet
- Personal Service Shop
- Pet Grooming Establishment
- Pharmacy
- PhotographyStudio
- Place of Entertainment
- Retail Store
- Service or Repair Shop
- Supermarket
- Veterinary Clinic
- Video Store

[CLICK TO VIEW
C3 LOCAL COMMERCIAL
ZONING BY LAW](#)

[CLICK TO VIEW
VAUGHAN
ZONING DEFINITIONS](#)

*BUYERS/TENANTS ARE RESPONSIBLE FOR CONFIRMING ZONING AND PERMITTED USES.

FOR MORE INFORMATION, PLEASE CONTACT:**Karlyn Knafo***

Associate Vice President
905 234 0381
karlyn.knafo@cbre.com

Matthew Pieszchala*

Vice President
905 234 0376
matthew.pieszchala@cbre.com

Adam Occhipinti*

Vice President
416 798 6265
adam.occhipinti@cbre.com

Nicholas Regan*

Senior Sales Associate
416 801 1658
nicholas.regan@cbre.com

CBRE Limited, Real Estate Brokerage | 5935 Airport Road | Suite 700 | Mississauga, ON | L4V 1W5 *Sales Representative

This disclaimer shall apply to CBRE Limited, Real Estate Brokerage, and to all other divisions of the Corporation ("CBRE"). The information set out herein, including, without limitation, any projections, images, opinions, assumptions and estimates obtained from third parties (the "Information") has not been verified by CBRE, and CBRE does not represent, warrant or guarantee the accuracy, correctness and completeness of the Information. CBRE does not accept or assume any responsibility or liability, direct or consequential, for the Information or the recipient's reliance upon the Information. The recipient of the Information should take such steps as the recipient may deem necessary to verify the Information prior to placing any reliance upon the Information. The Information may change and any property described in the Information may be withdrawn from the market at any time without notice or obligation to the recipient from CBRE. CBRE and the CBRE logo are the service marks of CBRE Limited and/or its affiliated or related companies in other countries. All other marks displayed on this document are the property of their respective owners. All Rights Reserved. Mapping Sources: Canadian Mapping Services canadamapping@cbre.com; DMTI Spatial, Environics Analytics, Microsoft Bing, Google Earth