

# 13.91 Acres Industrial Land

# FOR SALE

## \$15,148,000 (\$25/PSF)

### SW QUADRANT (SWQ) OF HARVILL AVENUE / ORANGE AVENUE, PERRIS, CA 92571



## PROPERTY FEATURES

- Zoned IP - Industrial Park
- CUP in Final Review; 11,630sf Industrial Maintenance & Service Building (4 Pass-thru Bays, 6 Offices, Conf Rm, Lobby, Board Room, 4 Restrooms)
- Approx 300+/- IOS Truck/Trailer Parking.
- On Approved Riverside County Truck Route
- Immediate Access to I-215 Fwy via Harvill Ave/Nuevo Ave
- Underground Water, Sewer, Utility lines at Property Boundaries



**Liz Roubidoux**  
SENIOR VICE PRESIDENT  
909.440.0967  
liz.roubidoux@sperrycga.com  
CalDRE #01276381

**Jon Sorokowski**  
SENIOR VICE PRESIDENT  
951.742.8600  
jon.sorokowski@sperrycga.com  
CalDRE #01079670

Each office independently owned and operated.

We obtained the information above from sources we believe to be reliable. However, we have not verified its accuracy and make no guarantee, warranty or representation about it. It is submitted subject to the possibility of errors, omissions, change of price, rental or other conditions, prior sale, lease or financing, or withdrawal without notice. We include projections, opinions, assumptions or estimates for example only, and they may not represent current or future performance of the property. You and your tax and legal advisors should conduct your own investigation of the property and transaction.

# 13.91 Acres Industrial Land **FOR SALE**

SW QUADRANT (SWQ) OF HARVILL AVENUE / ORANGE AVENUE, PERRIS, CA 92570 and

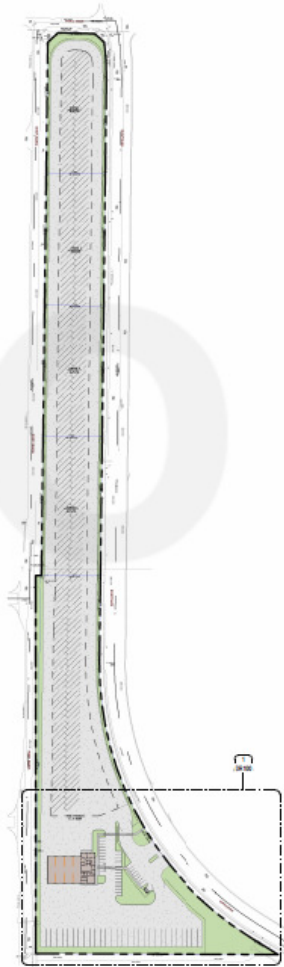

**2 Site Plan**  
1" = 160'-0"

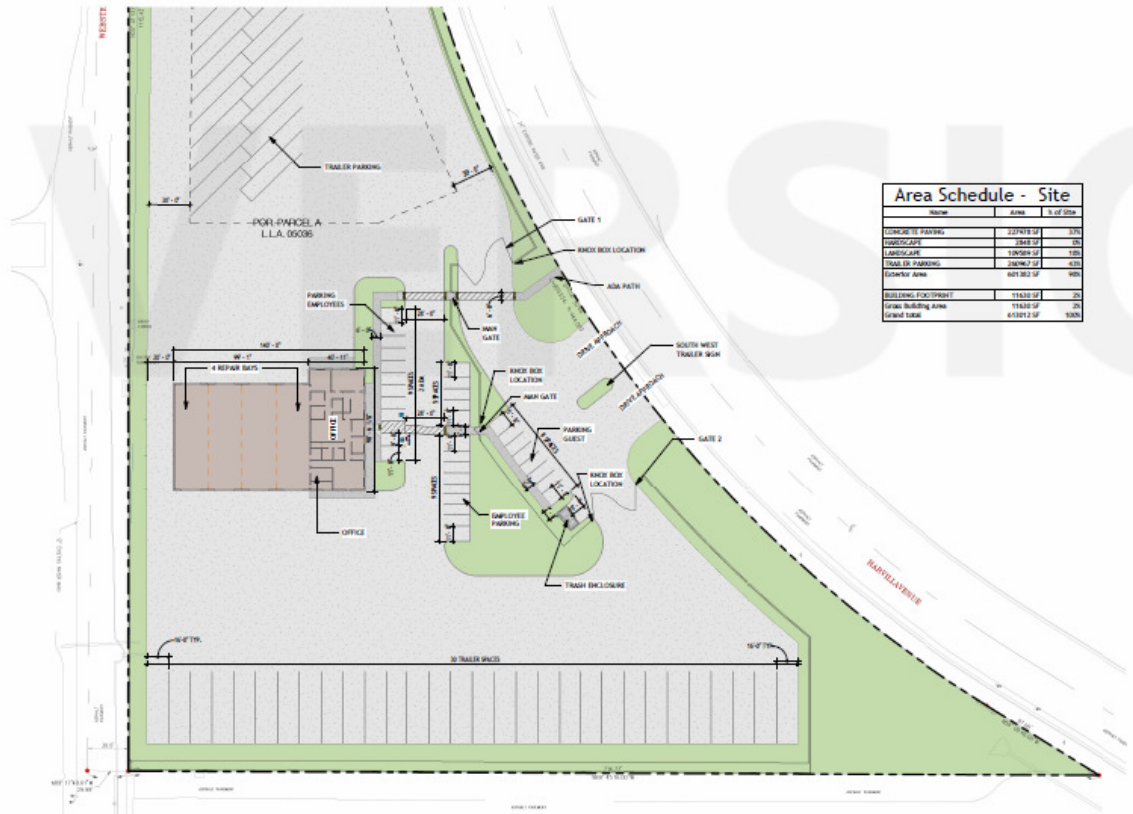

**1 Site Plan**  
1" = 40'-0"

Area Schedule - Site		
Name	Area	% of Site
CONCRETE PAVING	220,716 SF	2.7%
ASPHALT	2,842 SF	0.0%
LANDSCAPE	100,000 SF	1.3%
ROAD IN PAVING	150,000 SF	1.9%
EXTERIOR AREA	801,382 SF	10.0%
BUILDING FOOTPRINT	11,630 SF	0.1%
Grass Building Area	11,630 SF	0.1%
Grass Total	610,812 SF	7.7%



**Liz Roubidoux**  
SENIOR VICE PRESIDENT  
909.440.0967  
liz.roubidoux@sperrycga.com  
CalDRE #01276381

**Jon Sorokowski**  
SENIOR VICE PRESIDENT  
951.742.8600  
jon.sorokowski@sperrycga.com  
CalDRE #01079670

Each office independently owned and operated.

We obtained the information above from sources we believe to be reliable. However, we have not verified its accuracy and make no guarantee, warranty or representation about it. It is submitted subject to the possibility of errors, omissions, change of price, rental or other conditions, prior sale, lease or financing, or withdrawal without notice. We include projections, opinions, assumptions or estimates for example only, and they may not represent current or future performance of the property. You and your tax and legal advisors should conduct your own investigation of the property and transaction.

# 13.91 Acres Industrial Land **FOR SALE**

SW QUADRANT (SWQ) OF HARVILL AVENUE / ORANGE AVENUE, PERRIS, CA 92570 and

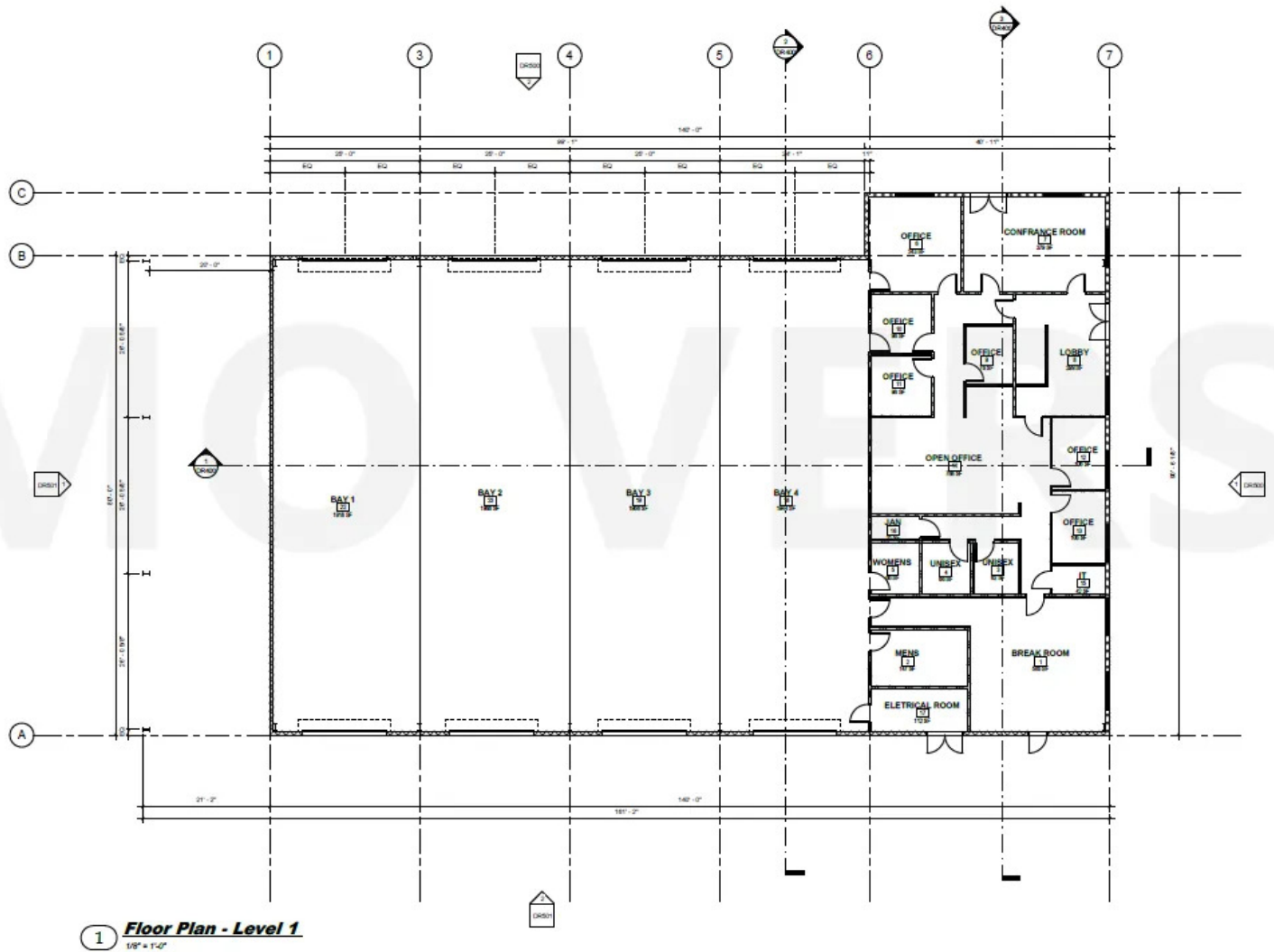

**Liz Roubidoux**  
SENIOR VICE PRESIDENT  
909.440.0967  
liz.roubidoux@sperrycga.com  
CalDRE #01276381

**Jon Sorokowski**  
SENIOR VICE PRESIDENT  
951.742.8600  
jon.sorokowski@sperrycga.com  
CalDRE #01079670

Each office independently owned and operated.

We obtained the information above from sources we believe to be reliable. However, we have not verified its accuracy and make no guarantee, warranty or representation about it. It is submitted subject to the possibility of errors, omissions, change of price, rental or other conditions, prior sale, lease or financing, or withdrawal without notice. We include projections, opinions, assumptions or estimates for example only, and they may not represent current or future performance of the property. You and your tax and legal advisors should conduct your own investigation of the property and transaction.

# 13.91 Acres Industrial Land **FOR SALE**

SW QUADRANT (SWQ) OF HARVILL AVENUE / ORANGE AVENUE, PERRIS, CA 92570 and



[www.SperryCGA.com](http://www.SperryCGA.com)

**Liz Roubidoux**  
SENIOR VICE PRESIDENT  
909.440.0967  
[liz.roubidoux@sperrycga.com](mailto:liz.roubidoux@sperrycga.com)  
CalDRE #01276381

**Jon Sorokowski**  
SENIOR VICE PRESIDENT  
951.742.8600  
[jon.sorokowski@sperrycga.com](mailto:jon.sorokowski@sperrycga.com)  
CalDRE #01079670

Each office independently owned and operated.

We obtained the information above from sources we believe to be reliable. However, we have not verified its accuracy and make no guarantee, warranty or representation about it. It is submitted subject to the possibility of errors, omissions, change of price, rental or other conditions, prior sale, lease or financing, or withdrawal without notice. We include projections, opinions, assumptions or estimates for example only, and they may not represent current or future performance of the property. You and your tax and legal advisors should conduct your own investigation of the property and transaction.

# 13.91 Acres Industrial Land **FOR SALE**

SW QUADRANT (SWQ) OF HARVILL AVENUE / ORANGE AVENUE, PERRIS, CA 92570 and



**Liz Roubidoux**  
SENIOR VICE PRESIDENT  
909.440.0967  
liz.roubidoux@sperrycga.com  
CalDRE #01276381

**Jon Sorokowski**  
SENIOR VICE PRESIDENT  
951.742.8600  
jon.sorokowski@sperrycga.com  
CalDRE #01079670

Each office independently owned and operated.

We obtained the information above from sources we believe to be reliable. However, we have not verified its accuracy and make no guarantee, warranty or representation about it. It is submitted subject to the possibility of errors, omissions, change of price, rental or other conditions, prior sale, lease or financing, or withdrawal without notice. We include projections, opinions, assumptions or estimates for example only, and they may not represent current or future performance of the property. You and your tax and legal advisors should conduct your own investigation of the property and transaction.

[www.SperryCGA.com](http://www.SperryCGA.com)

# 13.91 Acres Industrial Land **FOR SALE**

SW QUADRANT (SWQ) OF HARVILL AVENUE / ORANGE AVENUE, PERRIS, CA 92570 and



**Subject Property**

Placentia Ave

Orange Ave

INTERSTATE  
215

129,448 CPD

Harvell Ave 8,923 CPD

Nuevo Road



**Liz Roubidoux**  
SENIOR VICE PRESIDENT  
909.440.0967  
liz.roubidoux@sperrycga.com  
CalDRE #01276381

**Jon Sorokowski**  
SENIOR VICE PRESIDENT  
951.742.8600  
jon.sorokowski@sperrycga.com  
CalDRE #01079670

Each office independently owned and operated.

We obtained the information above from sources we believe to be reliable. However, we have not verified its accuracy and make no guarantee, warranty or representation about it. It is submitted subject to the possibility of errors, omissions, change of price, rental or other conditions, prior sale, lease or financing, or withdrawal without notice. We include projections, opinions, assumptions or estimates for example only, and they may not represent current or future performance of the property. You and your tax and legal advisors should conduct your own investigation of the property and transaction.

[www.SperryCGA.com](http://www.SperryCGA.com)

