

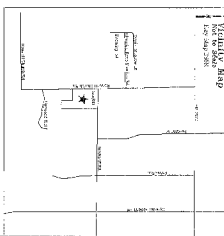

LINE	BEARING	DISTANCE
1	N 88°59'44" E	343.07'
2	S 02°46'26" E	254.86'
3	S 87°50'42" W	341.59'
4	N 03°04'17" W	261.77'
5	S 87°50'42" W	195.84'
6	N 02°31'31" E	145.92'
7	S 07°36'31" W	145.92'

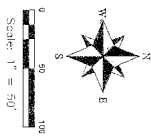

JANICE DAVIS
 NANCY C. DAVIS
 OF AND BY
 JEFFREY L.

JAMES G. GIBSON
 DEBANY GIBSON
 CALLED 2984 ACRES
 E. B. H. D. C. T.

RICHIE L. W. DAVIS
 OF AND BY
 R. D. DAVIS

ROSE HILL, INC. (L. 1955), SUCCESSORS
 OF ROSE HILL, INC. (L. 1955)
 OF AND BY
 D. L. GIBSON

JEFFREY L. DAVIS, NANCY C. DAVIS
 OF AND BY
 JEFFREY L.

BURKHARDT ROAD
 60' ROW, 10' BUFFER, 45' PAVED SB D. H. C. T.

UNRESTRICTED RESERVE "A"
 2,029 ACRES
 58,900 Square Feet

UNRESTRICTED RESERVE "B"
 1,983 ACRES
 66,370 Square Feet

BLOCK 1

JOHN E. & CYNTHIA KAY
 OF AND BY
 R. W. RICE
 JEFFREY L. DAVIS
 JEFFREY L. DAVIS

DOTTIE A. GIBSON
 OF AND BY
 R. D. DAVIS

TERRY K. HENNINGSON
 CALLED 1922 ACRES
 E. B. H. D. C. T.

ROSEHILL ESTATES
 A Subdivision of 4,012 acres of land situated
 in the C. D. Crawford Survey, Abstract Number 209, of Harris
 County, Texas.
2 UNRESTRICTED RESERVES | BLOCK

COUNTY OF HARRIS, TEXAS
 COUNTY CLERK'S OFFICE
 1100 NORTH LOOP WEST, SUITE 1000
 HOUSTON, TEXAS 77002
 PHONE: 713-222-2222
 FAX: 713-222-2222

C & C SURVEYING, INC.
 2300 SOUTH LOOP WEST, SUITE 1000
 HOUSTON, TEXAS 77002
 PHONE: 713-222-2222
 FAX: 713-222-2222
 WWW.CANDCSURVEYING.COM