



The
COLLECTIVE

EAST



DEVELOPED BY
SPARK ROOT



THE COLLECTIVE // EAST



ECR



VENTURE TOGETHER

The Collective East is the ultimate hub for visionaries, crafters, and entrepreneurs - spaces truly made for making & doing. Located within the vibrant, next wave of East Austin, this mixed-use community delivers the perfect blend of convenience, accessibility, and opportunity.

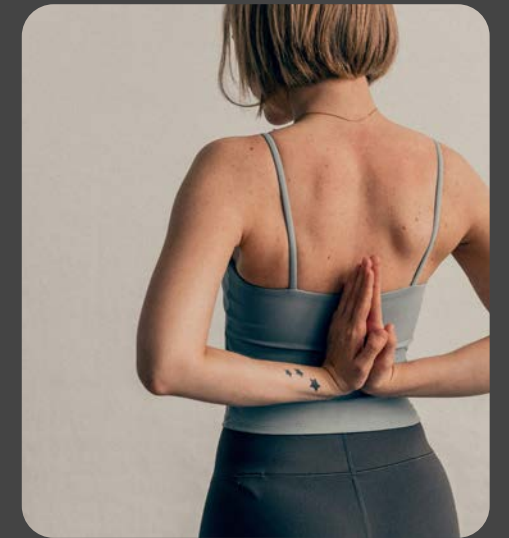



THE COLLECTIVE // EAST



ECR



LOCATION

Sitting at the center of convenience, The Collective East is neighbored by the new sustainable Colony Park community, the Walnut Creek Hike & Bike Trail, and the Travis County Exposition Center. Enjoy effortless access to Downtown Austin and quick connections to major corridors, including I-35 and Highway 130.



208
ACRES

COLONY PARK COMMUNITY



20+
MILES

WALNUT CREEK TRAIL



7000 JOHNNY MORRIS RD
AUSTIN, TX 78724



DESIGN FEATURES

Adaptable spaces in a wide variety of suite sizes to perfectly match your business needs. Each suite features ample natural light and robust electrical service.

With Commercial Services (CS) zoning, The Collective East offers ultimate flexibility - ideal for a mix of uses including warehouse, workshop, office, and retail.

OPEN-PLAN LAYOUTS

UP TO 20' CEILINGS

GARAGE DOORS *

MEZZANINE LEVELS *

** Select Suites*



SITE PLAN

The Collective East offers a dynamic environment across 7 buildings on 9 acres. Enjoy easy community access with two dedicated entries and abundant parking. Tucked inside the campus is a communal courtyard, perfect for breaks and casual meetings.

152,000

TOTAL SF

100+

FLEX SUITES

387

PARKING SPACES

THE COLLECTIVE // EAST

WALNUT CREEK
HIKE & BIKE TRAIL

FUTURE
MULTI-FAMILY

COURTYARD

PATIO

P.

PATIO

FULLY
CUSTOMIZABLE



JOHNNY MORRIS ROAD



ECR



BUILDING 1

SUITE OPTIONS (SF):

1,299 - 14,436

SUITE DEPTH:

55' - 57'

SUITE HEIGHT:

14' - 20' (MEZZANINE: 12' AFF)

THE COLLECTIVE // EAST

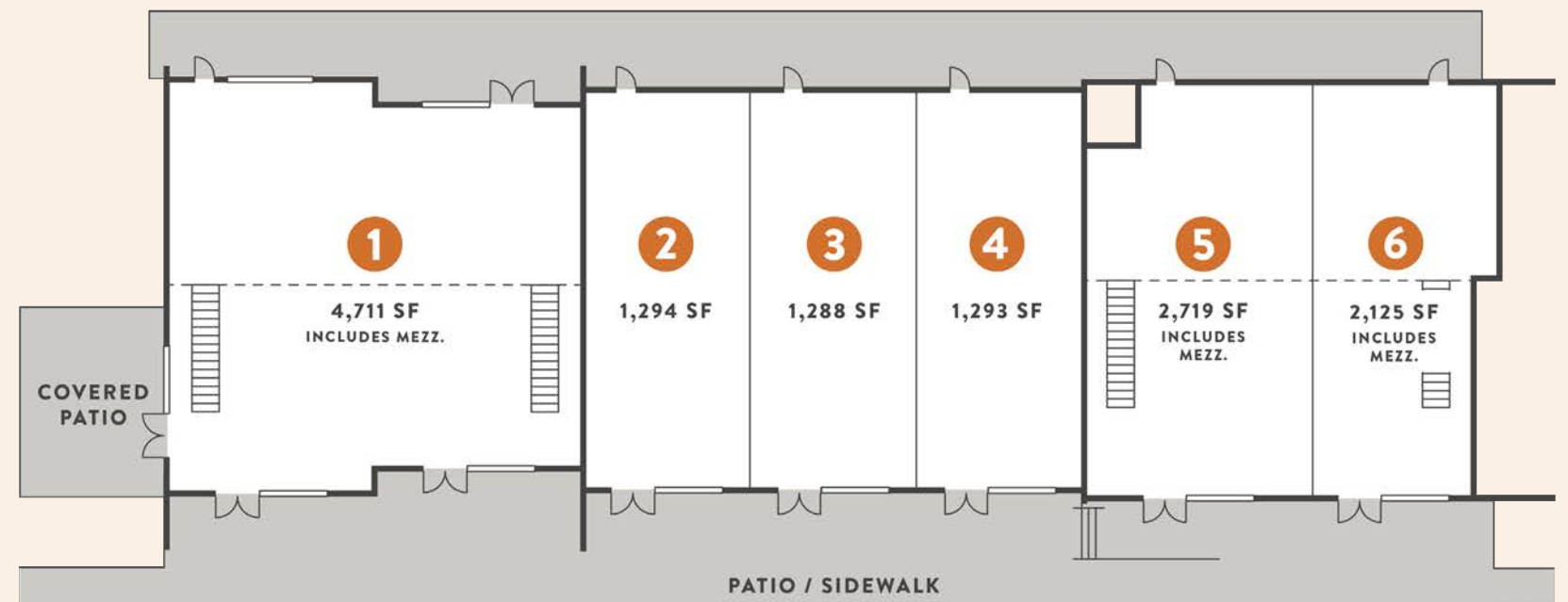
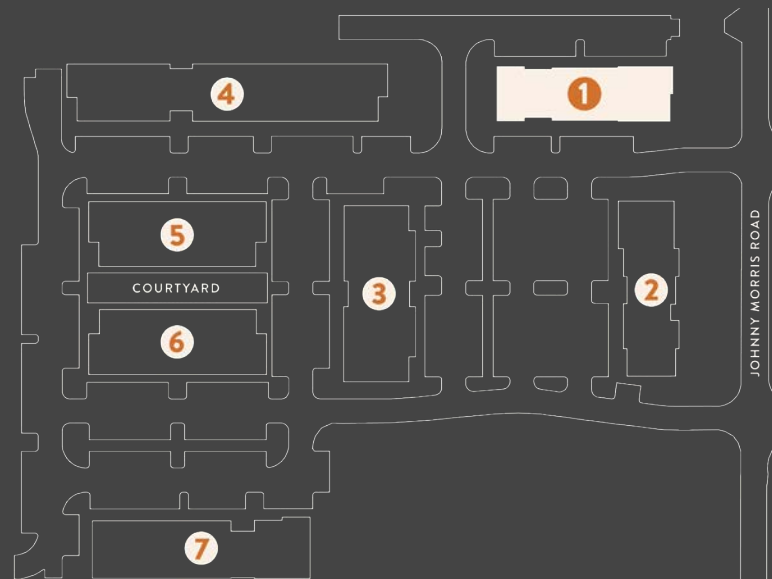

FOR MORE INFORMATION

RYAN WILSON
 rwilson@ecrtx.com
 512.505.0006

HANNAH HUSKEY
 hhuskey@ecrtx.com
 512.635.7760

CORY CAMP
 ccamp@ecrtx.com
 512.505.2761



ECR



BUILDING 2

SUITE OPTIONS (SF):

862 - 12,046

SUITE DEPTH:

58'

SUITE HEIGHT:

16' - 20' (MEZZANINE: 12' AFF)

THE COLLECTIVE // EAST

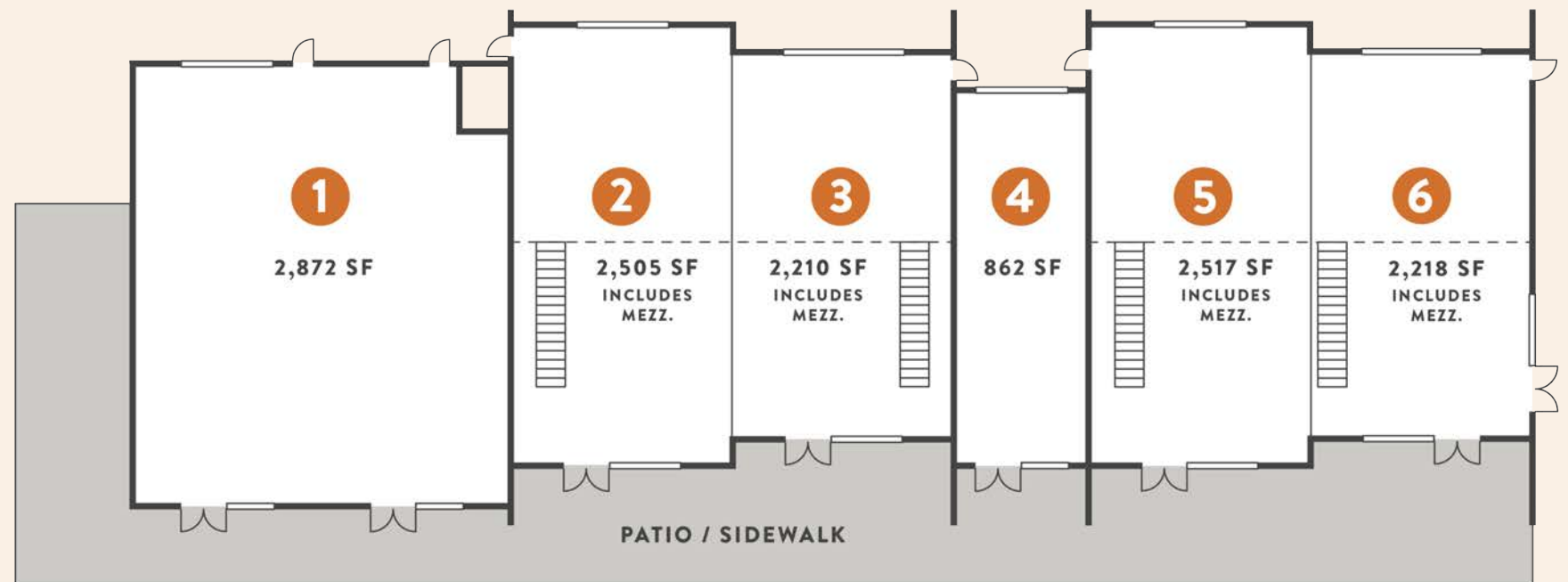
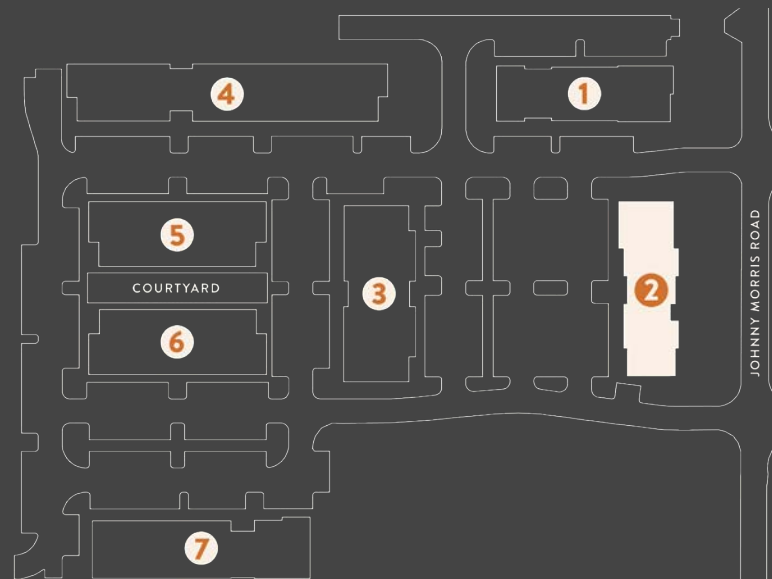

FOR MORE INFORMATION

RYAN WILSON
 rwilson@ecrtx.com
 512.505.0006

HANNAH HUSKEY
 hhuskey@ecrtx.com
 512.635.7760

CORY CAMP
 ccamp@ecrtx.com
 512.505.2761



ECR



BUILDING 3

SUITE OPTIONS (SF):

1,739 - 16,997

SUITE DEPTH:

75'

SUITE HEIGHT:

16' - 20' (MEZZANINE: 12' AFF)

THE COLLECTIVE // EAST

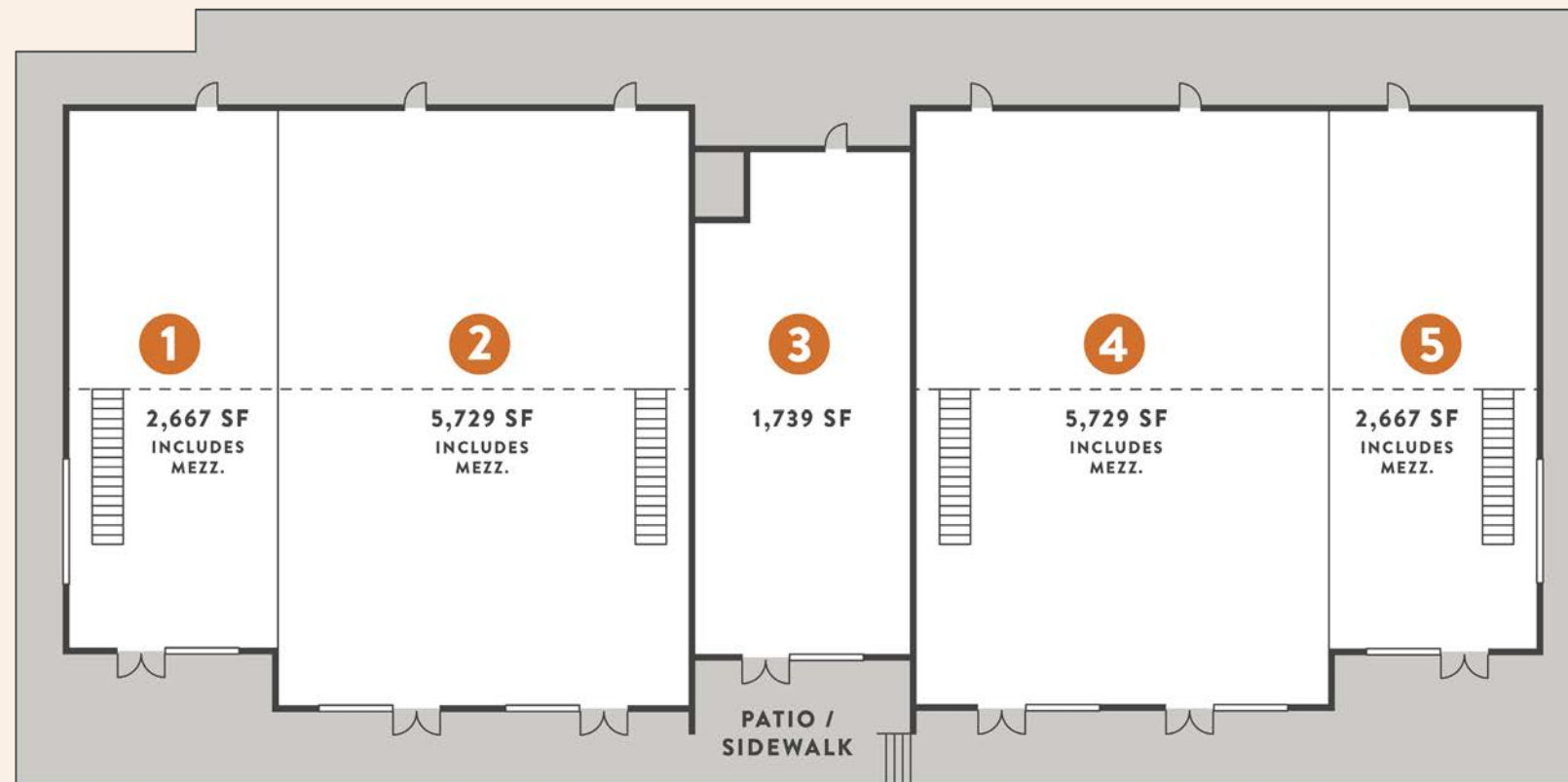
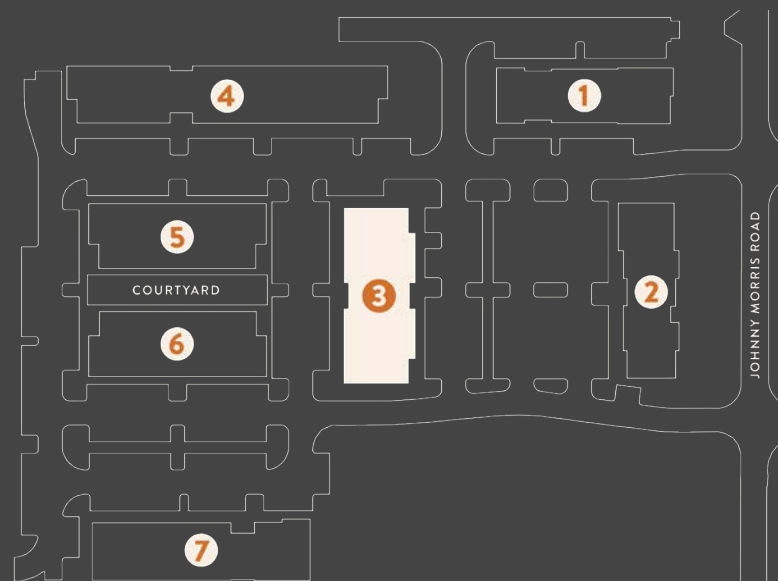

FOR MORE INFORMATION

RYAN WILSON
 rwilson@ecrtx.com
 512.505.0006

HANNAH HUSKEY
 hhuskey@ecrtx.com
 512.635.7760

CORY CAMP
 ccamp@ecrtx.com
 512.505.2761



ECR



BUILDING 4 LEVEL 1

SUITE OPTIONS (SF):

1,440 - 19,031

SUITE DEPTH:

58'

SUITE HEIGHT:

15' +

THE COLLECTIVE // EAST

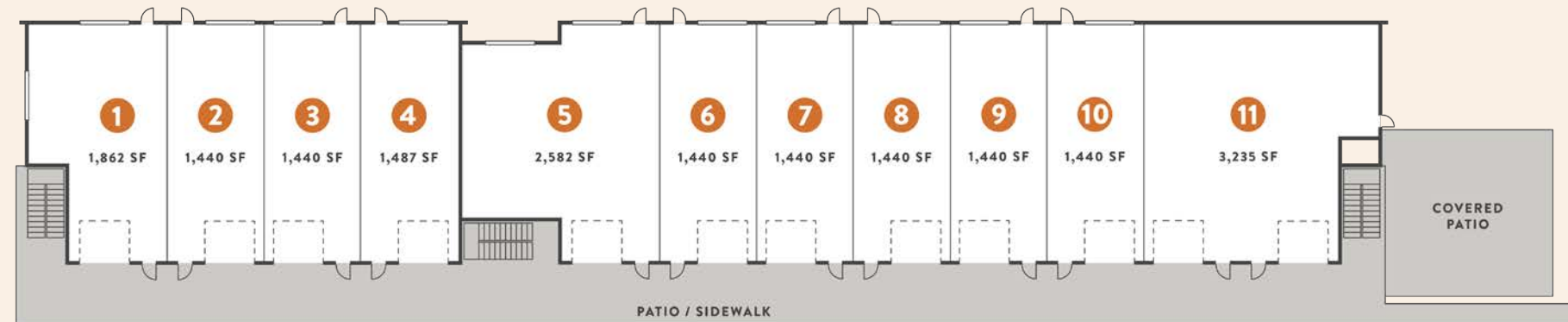
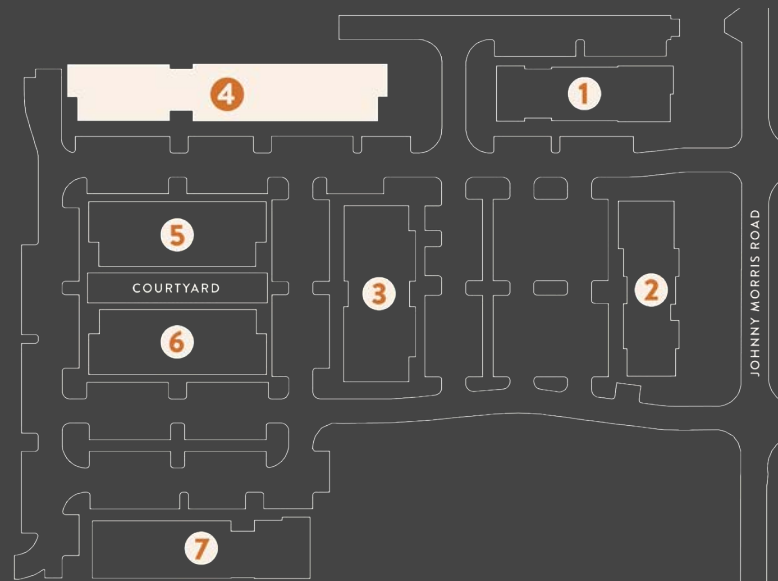

FOR MORE INFORMATION

RYAN WILSON
rwilson@ecrtx.com
512.505.0006

HANNAH HUSKEY
hhuskey@ecrtx.com
512.635.7760

CORY CAMP
ccamp@ecrtx.com
512.505.2761



ECR



BUILDING 4 LEVEL 2

SUITE OPTIONS (SF):

1,440 - 19,031

SUITE DEPTH:

58'

SUITE HEIGHT:

10' +

THE COLLECTIVE // EAST

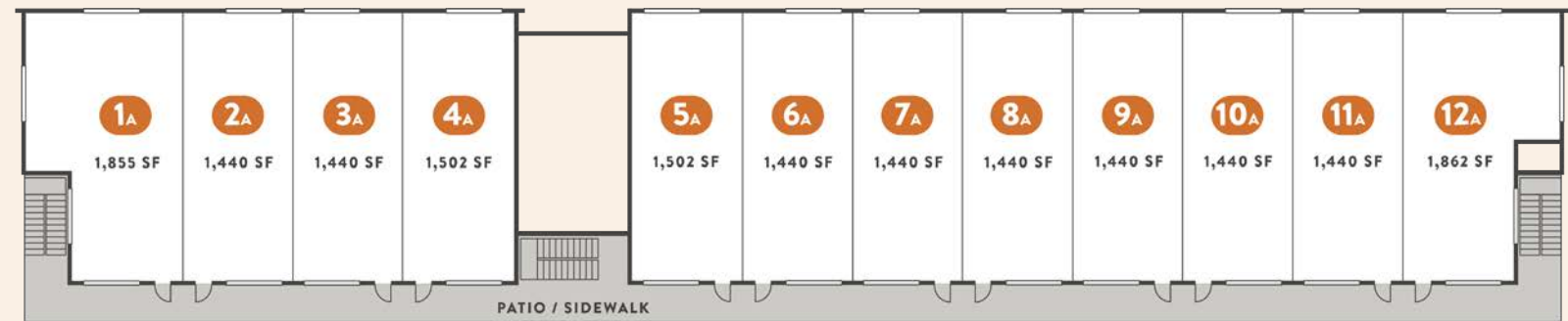
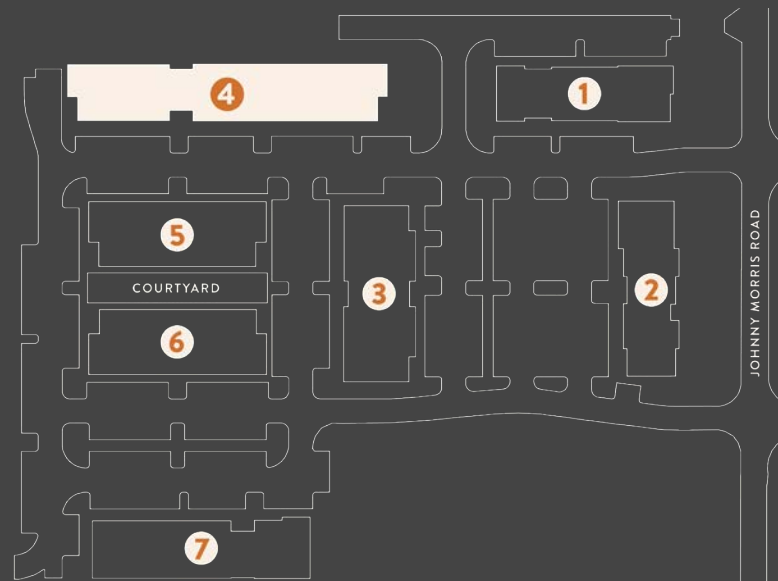

FOR MORE INFORMATION

RYAN WILSON
 rwilson@ecrtx.com
 512.505.0006

HANNAH HUSKEY
 hhuskey@ecrtx.com
 512.635.7760

CORY CAMP
 ccamp@ecrtx.com
 512.505.2761



ECR



BUILDING 5 LEVEL 1

SUITE OPTIONS (SF):

1,632 - 10,725

SUITE DEPTH:

68'

SUITE HEIGHT:

15' +

THE COLLECTIVE // EAST

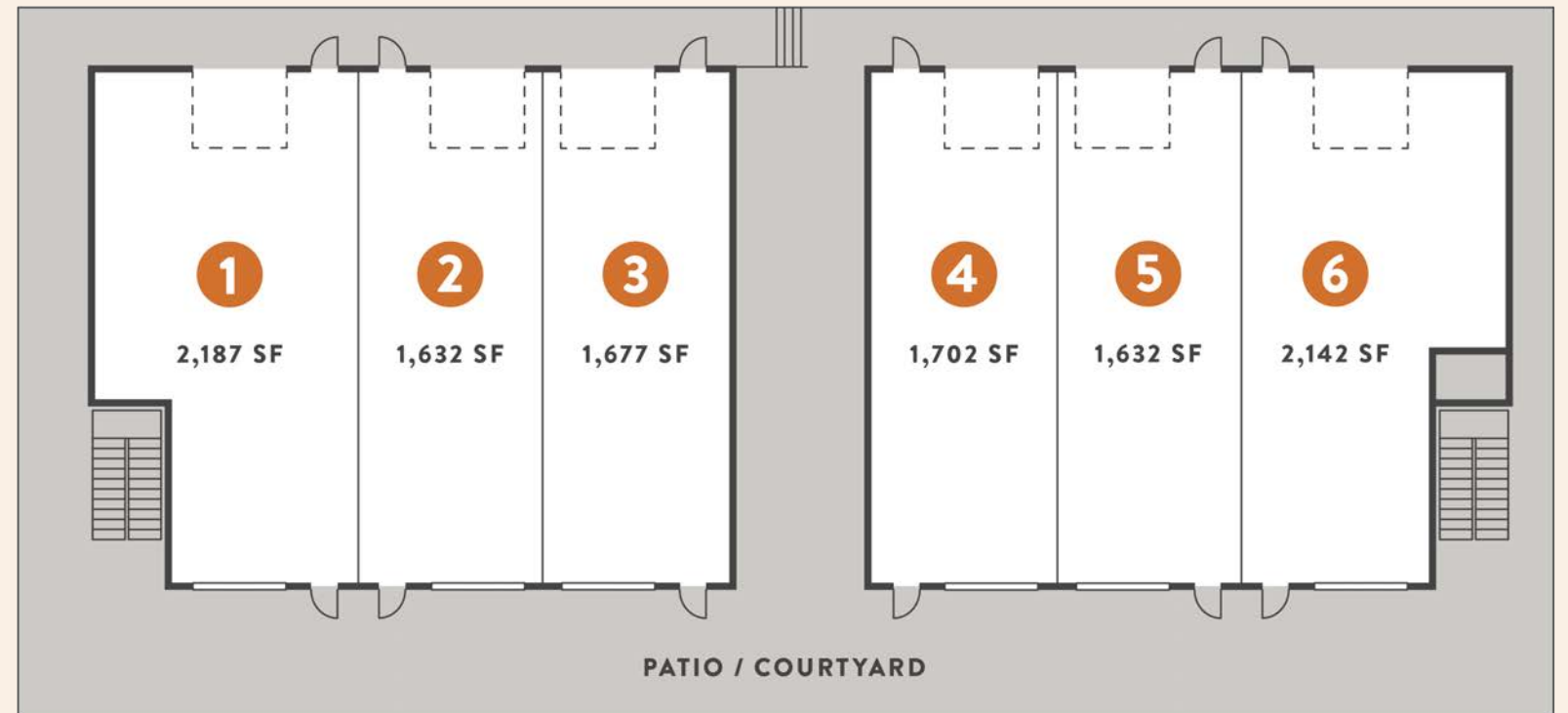
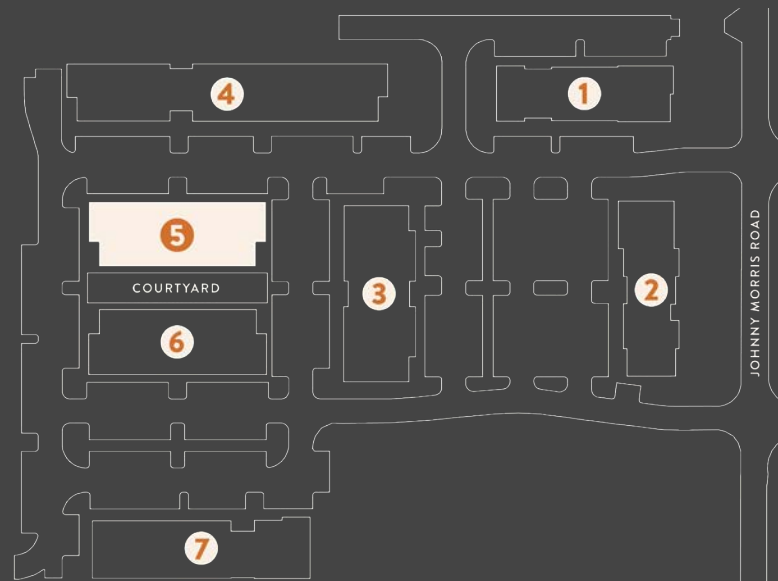

FOR MORE INFORMATION

RYAN WILSON
rwilson@ecrtx.com
512.505.0006

HANNAH HUSKEY
hhuskey@ecrtx.com
512.635.7760

CORY CAMP
ccamp@ecrtx.com
512.505.2761





BUILDING 5 LEVEL 2

SUITE OPTIONS (SF):

1,632 - 10,725

SUITE DEPTH:

68'

SUITE HEIGHT:

10' +

THE COLLECTIVE // EAST

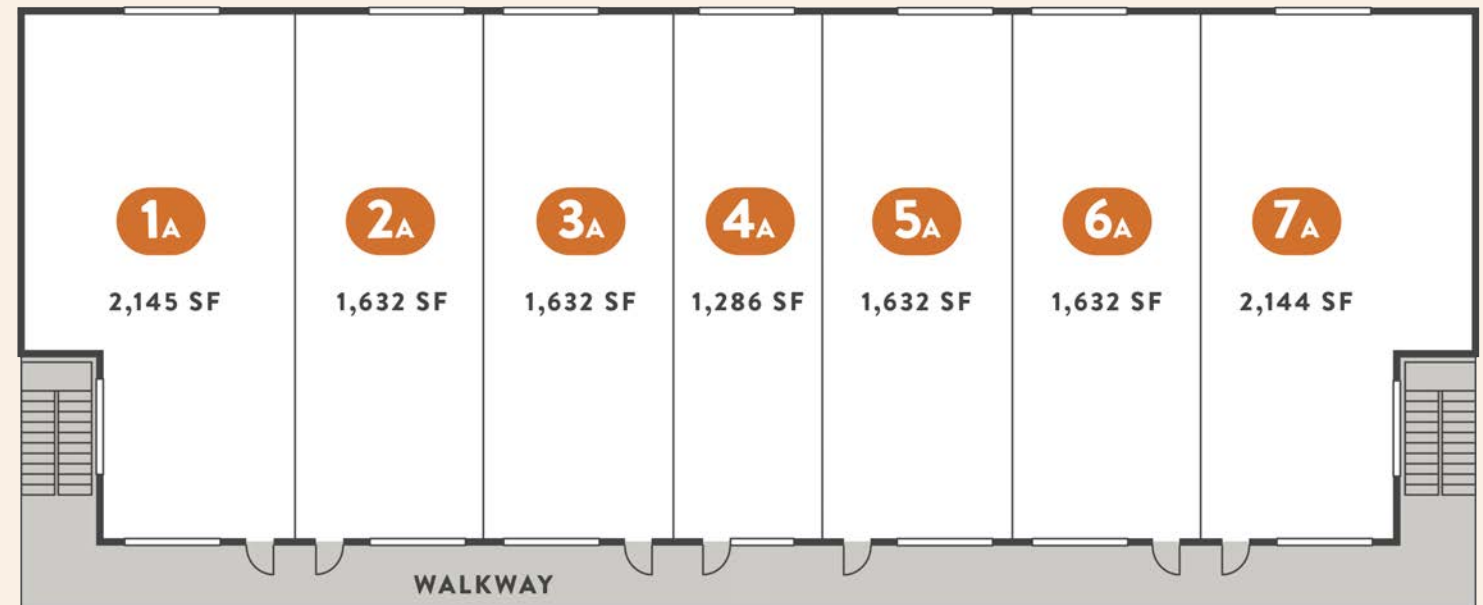
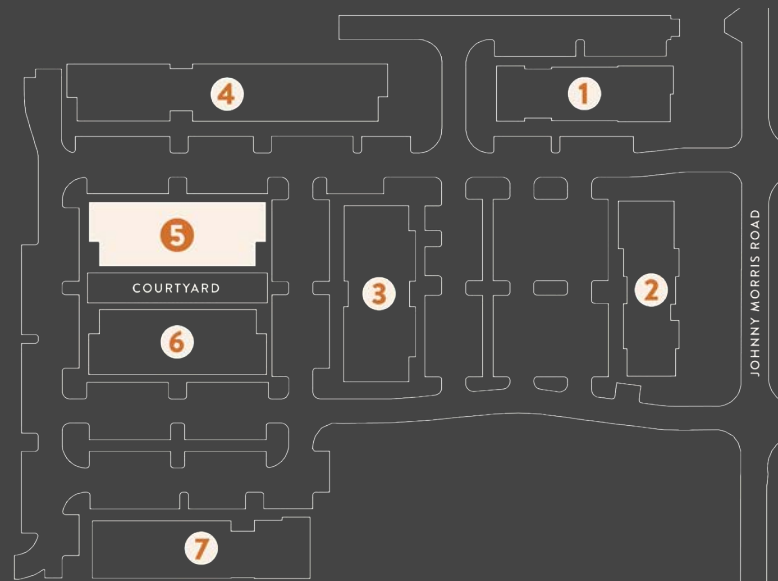

FOR MORE INFORMATION

RYAN WILSON
rwilson@ecrtx.com
512.505.0006

HANNAH HUSKEY
hhuskey@ecrtx.com
512.635.7760

CORY CAMP
ccamp@ecrtx.com
512.505.2761



ECR



BUILDING 6 LEVEL 1

SUITE OPTIONS (SF):

1,632 - 10,725

SUITE DEPTH:

68'

SUITE HEIGHT:

15' +

THE COLLECTIVE // EAST

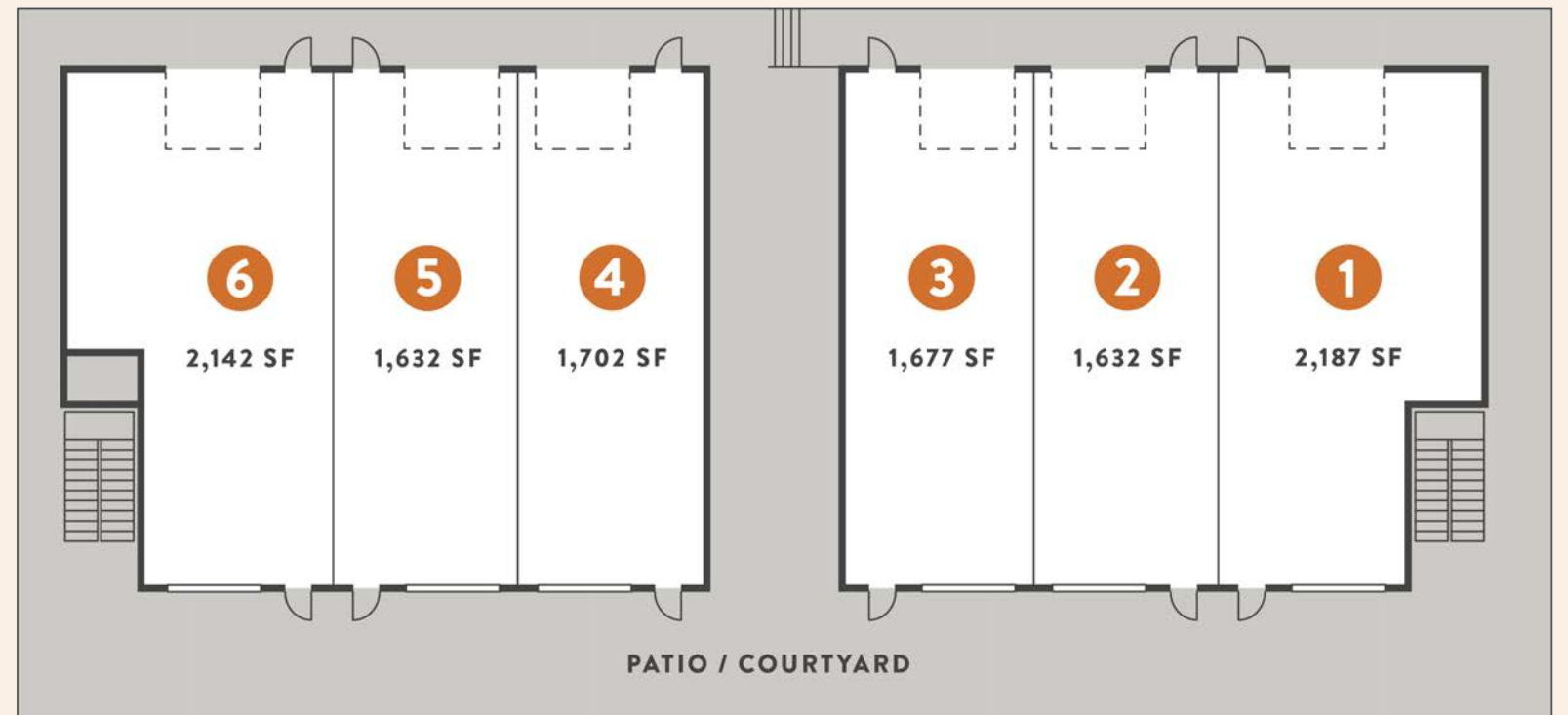
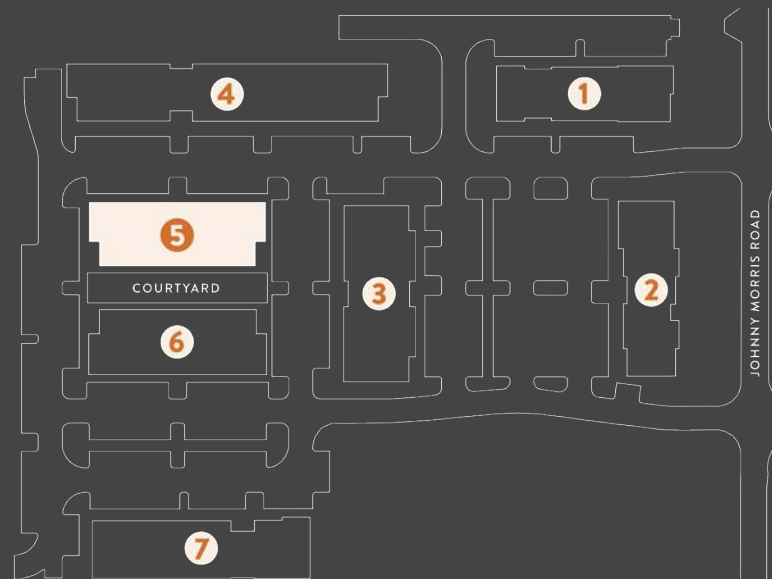

FOR MORE INFORMATION

RYAN WILSON
 rwilson@ecrtx.com
 512.505.0006

HANNAH HUSKEY
 hhuskey@ecrtx.com
 512.635.7760

CORY CAMP
 ccamp@ecrtx.com
 512.505.2761



ECR



BUILDING 6 LEVEL 2

SUITE OPTIONS (SF):

1,632 - 10,725

SUITE DEPTH:

68'

SUITE HEIGHT:

10' +

THE COLLECTIVE // EAST

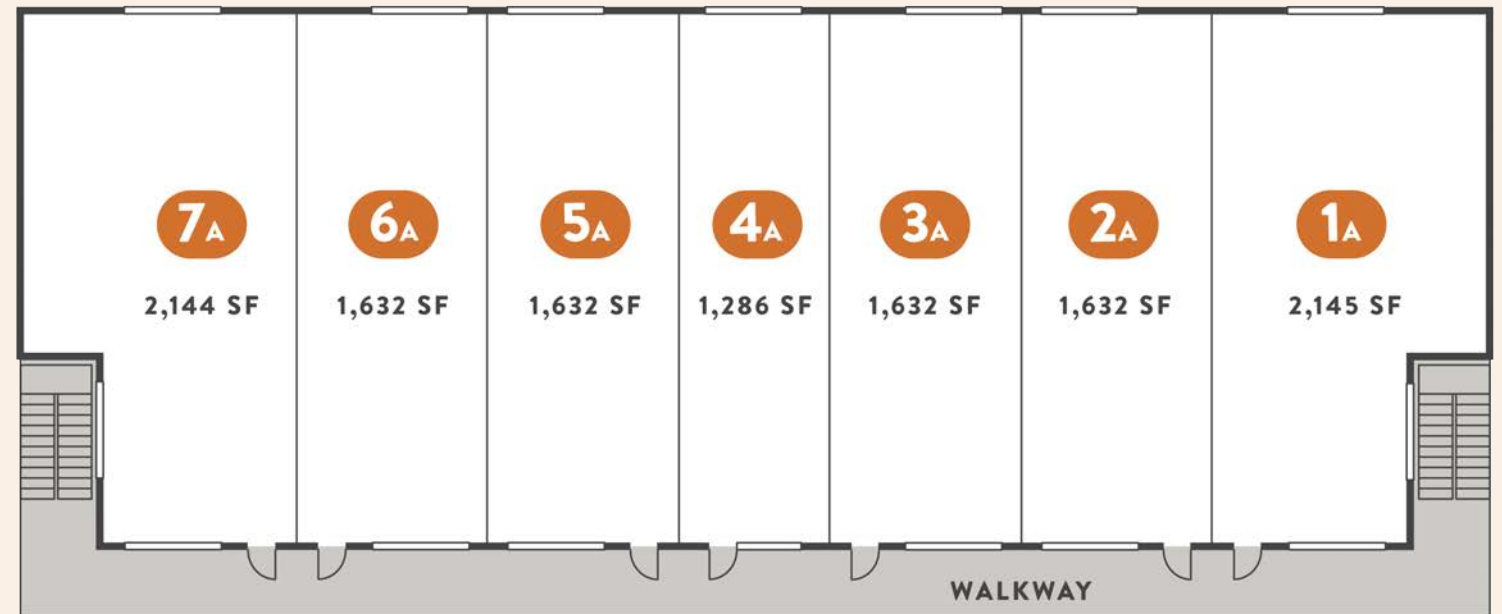
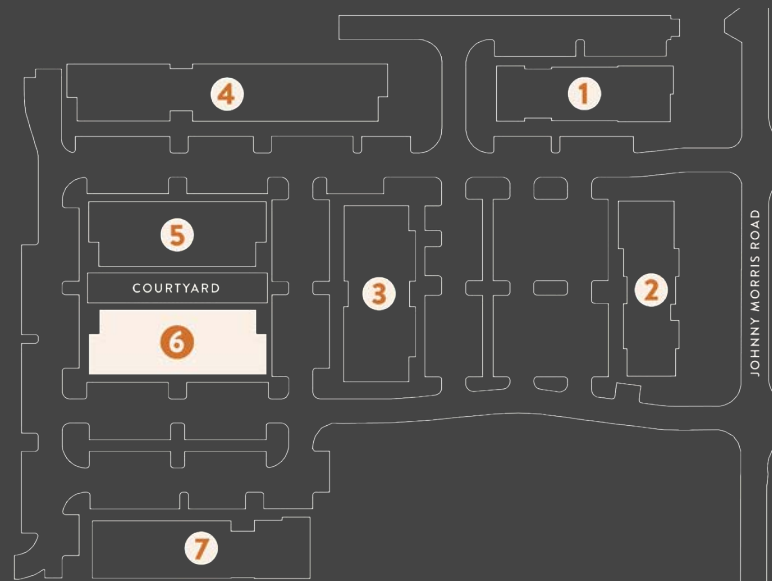

FOR MORE INFORMATION

RYAN WILSON
 rwilson@ecrtx.com
 512.505.0006

HANNAH HUSKEY
 hhuskey@ecrtx.com
 512.635.7760

CORY CAMP
 ccamp@ecrtx.com
 512.505.2761



ECR



BUILDING 7 LEVEL 1

SUITE OPTIONS (SF):

1,440 - 13,509

SUITE DEPTH:

60'

SUITE HEIGHT:

12' (MEZZANINE: 12' AFF)

THE COLLECTIVE // EAST

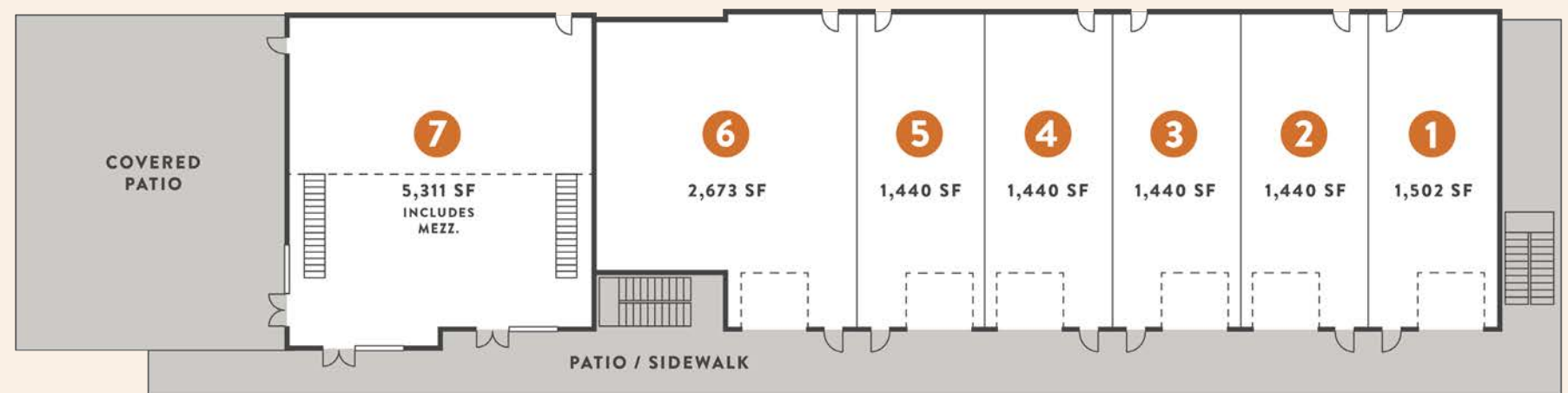
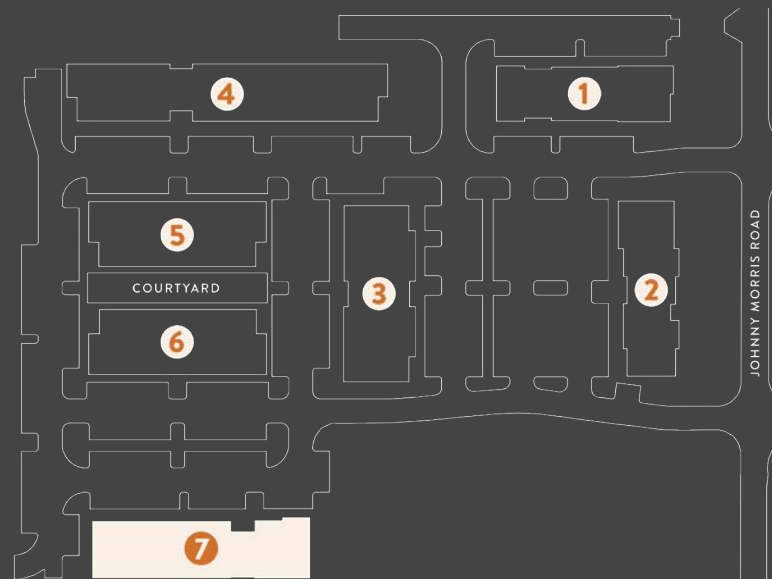

FOR MORE INFORMATION

RYAN WILSON
 rwilson@ecrtx.com
 512.505.0006

HANNAH HUSKEY
 hhuskey@ecrtx.com
 512.635.7760

CORY CAMP
 ccamp@ecrtx.com
 512.505.2761



ECR



BUILDING 7 LEVEL 2

SUITE OPTIONS (SF):

1,440 - 13,509

SUITE DEPTH:

60'

SUITE HEIGHT:

10' (MEZZANINE: 12' AFF)

THE COLLECTIVE // EAST

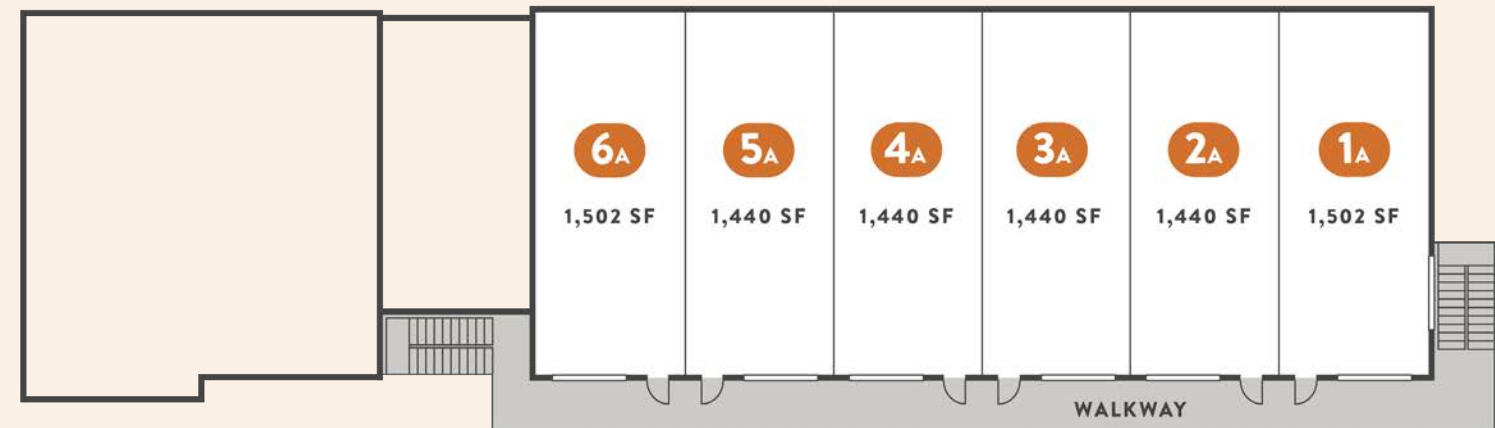
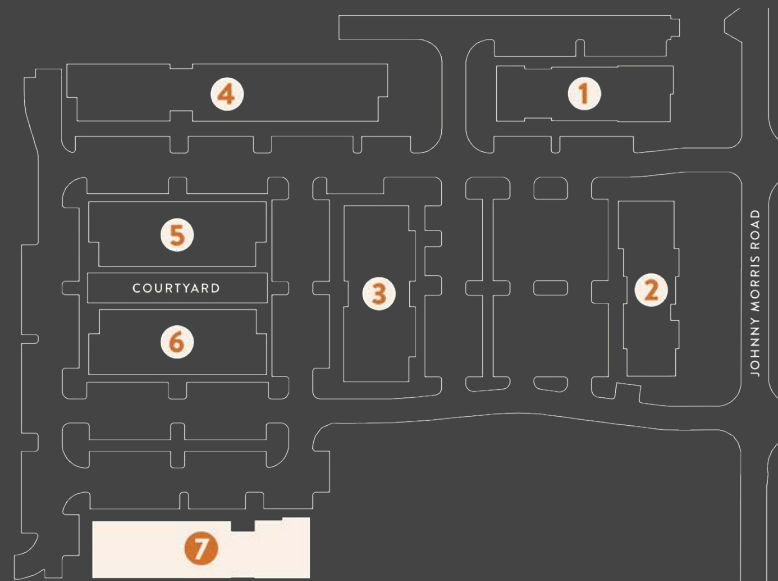

FOR MORE INFORMATION

RYAN WILSON
 rwilson@ecrtx.com
 512.505.0006

HANNAH HUSKEY
 hhuskey@ecrtx.com
 512.635.7760

CORY CAMP
 ccamp@ecrtx.com
 512.505.2761



ECR



THE COLLECTIVE // EAST



ECR



DEVELOPED BY



SPARK ROOT

Spark Root continues to create premier commercial spaces across Austin, driven by a deep commitment to thoughtful design that encourage both self-exploration and business success.



CIVIL ENGINEER
THROWER DESIGNS



ARCHITECT
DICK CLARK + ASSOCIATES



MEP ENGINEER
BACORN BROS.



STRUCTURAL ENGINEER
DCI



LET'S CONNECT

Don't miss the chance to be among the select few to secure your spot at The Collective East.

Take the first step to claim your place in this dynamic new community by contacting the sales team below.

RYAN WILSON
rwilson@ecrtx.com
512.505.0006

HANNAH HUSKEY
hhuskey@ecrtx.com
512.635.7760

CORY CAMP
ccamp@ecrtx.com
512.505.2761

THECOLLECTIVEEAST.COM