

Katy: 20,040 SF Crane Served Warehouse

23563 Clay Road (Lot 7) • Katy, TX 77493

Available
11/1/2026



For Lease Only: \$25,050/mo (\$1.25/SF), NNN

Location:

- ½ mile west of Grand Parkway West
- 2½ mi. No. of I-10 • 11 mi So. of US 290
- Key Map 445K

Features:

- 20,040 SF Office Warehouse with 1,883SF of office
- Tiltwall construction (120' X 180' X 30')
- One 20-ton crane with 20' hook height
- 400 Amps of 480V, 3-Phase power
- Can be sprinklered
- 4 roll up doors up to 20' X 20'
- 3 grade level doors & 1 truckwell
- 2.53 ac site, fenced w/ one ac stabilized
- Low tax rate of \$.01846
- Deed restricted industrial park
- **OUTSIDE CITY LIMITS !!!**

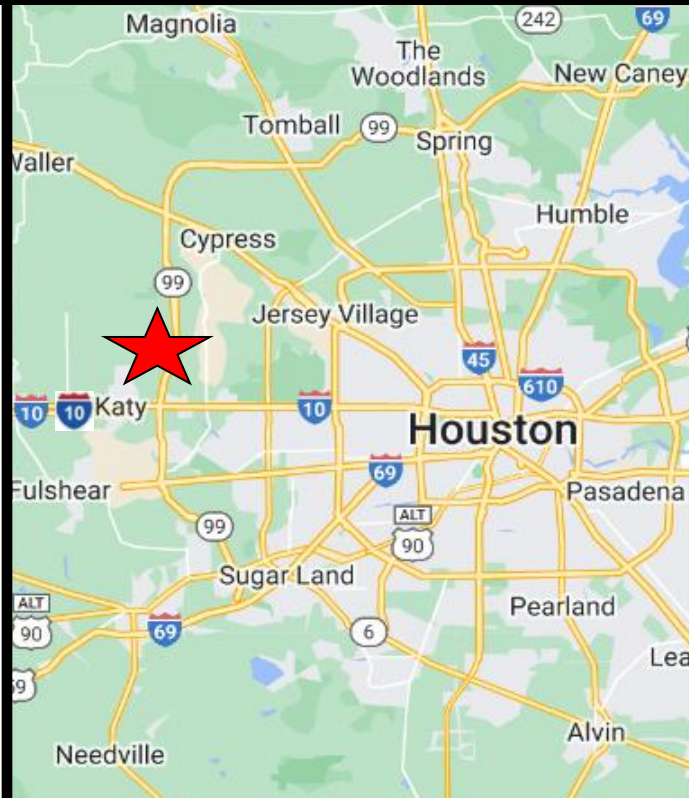

Capital Real Estate Commercial, Inc.

www.cretx.com

7720 Westview Drive • Houston, TX 77055

Phone (713) 681-1100 • Fax (713) 681-1114

Hart (713) 907-3570

hart@cretx.com

Richard (281) 932-9414

rrolland@credtexas.com



CAPITAL REAL ESTATE

COMMERCIAL

713.681.1100 www.cretx.com
7720 Westview Dr. Houston, TX 77055-5029

GRAND PARKWAY INDUSTRIAL PARK
LOT 7 - 2.53 AC
23563 CLAY RD. KATY, TX 77493

BUILDING FOOTPRINT: 20,040 SF
6" CONCRETE: 10,705 SF
5" CONCRETE: 8,685 SF
STABILIZED YARD: 43,412 SF

PARKING SPACES: 12

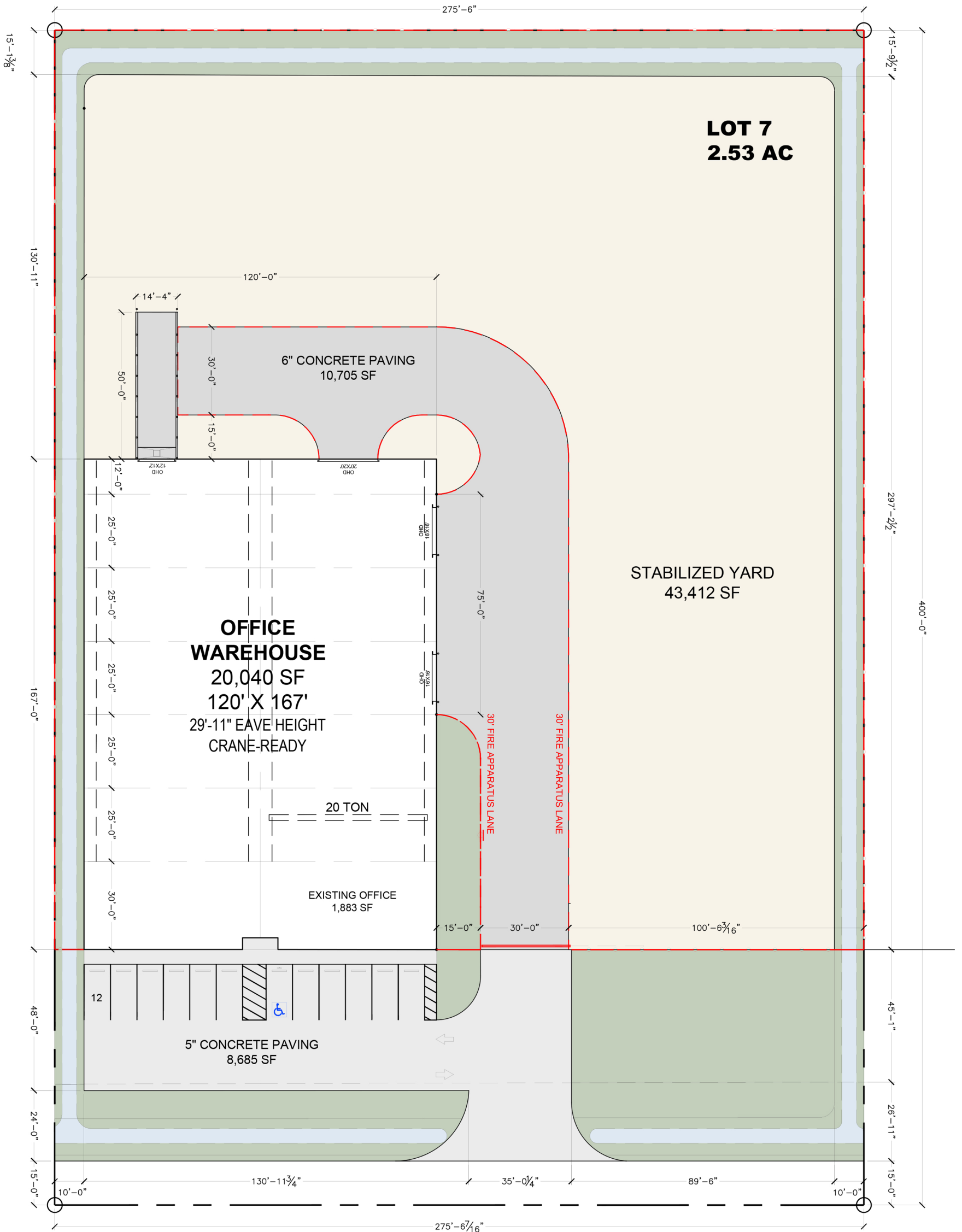



20-ton crane with 20' hook height

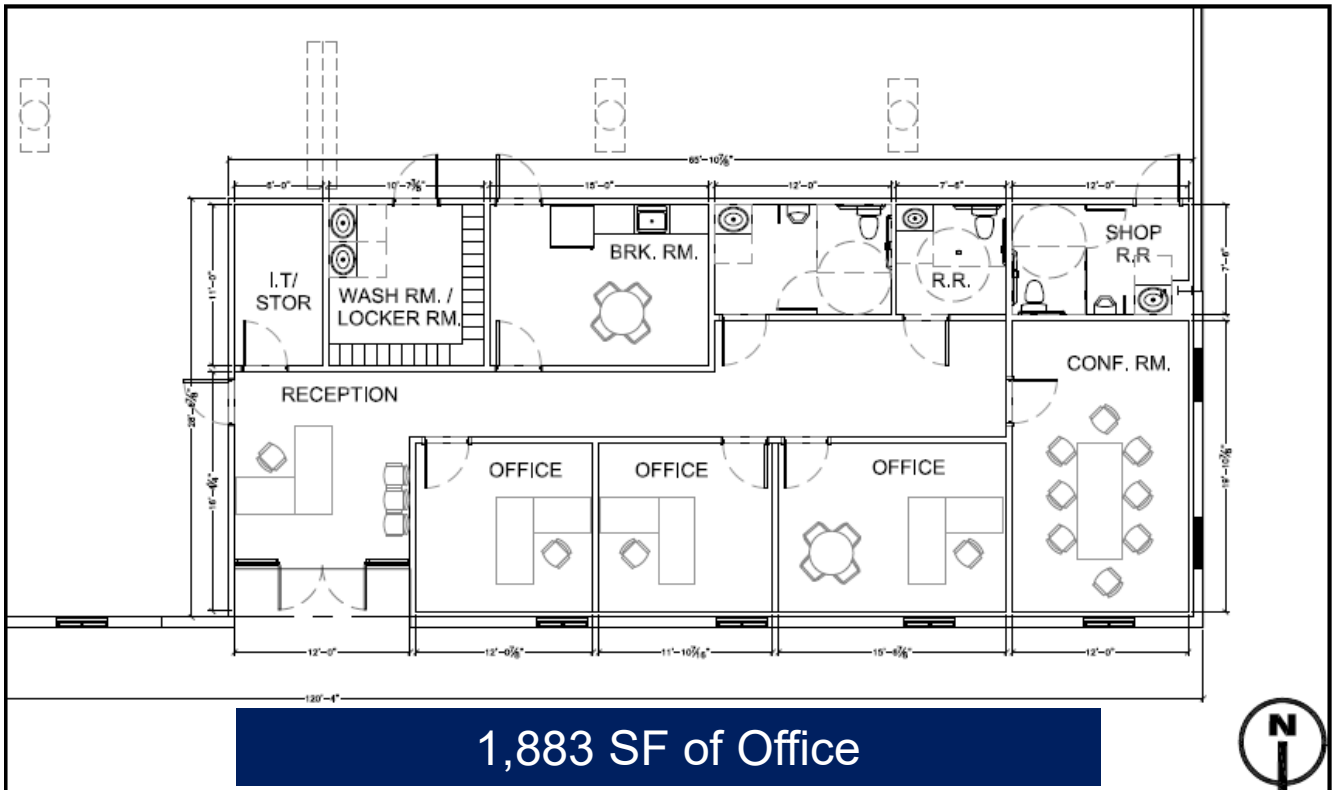

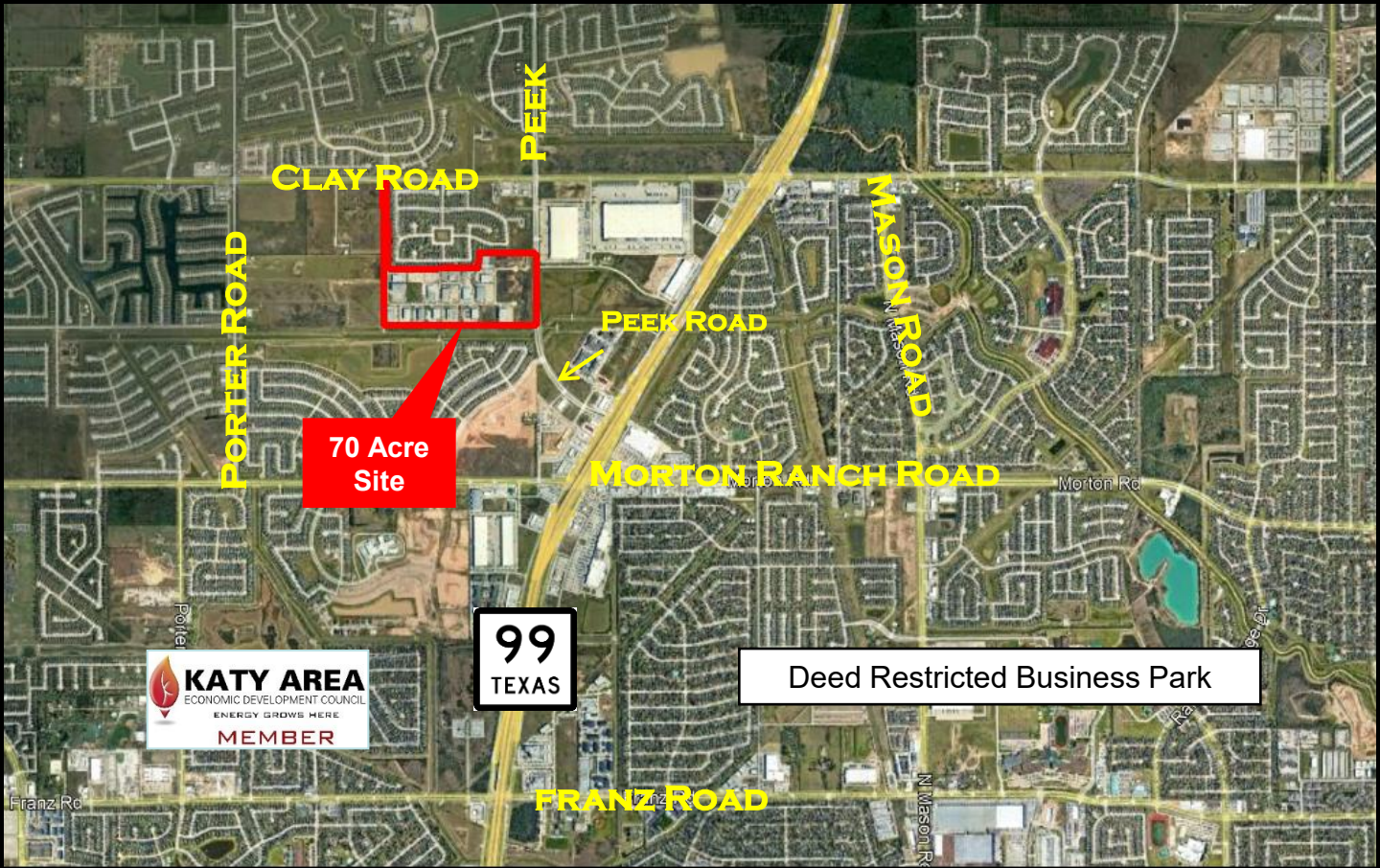

Clay Road

