

FOR LEASE

Eastport Industrial Park
8979-8985 MARKET STREET, BLDG 1
Houston, Texas 77029

Owned and Operated by



22,040 SF + 28,500 SF = 50,540 SF



SPACE SPECIFICATIONS

Address:	8979 Market Street Houston, TX 77079	8985 Market Street Houston, TX 77029
Suite Size:	± 22,040 SF	± 28,500 SF
Office:	± 2,753 SF	± 1,730 SF
Warehouse:	± 19,287 SF	± 26,770 SF
Truck Loading:	(2) Dock High Doors (1) Drive-In Ramps	(3) Dock High Doors (3) Drive-In Ramps
Clear Height:	24'	24'
Sprinklers:	Wet	Wet
Lighting:	LED	LED
Columns:	30' x 31'	30' x 31'

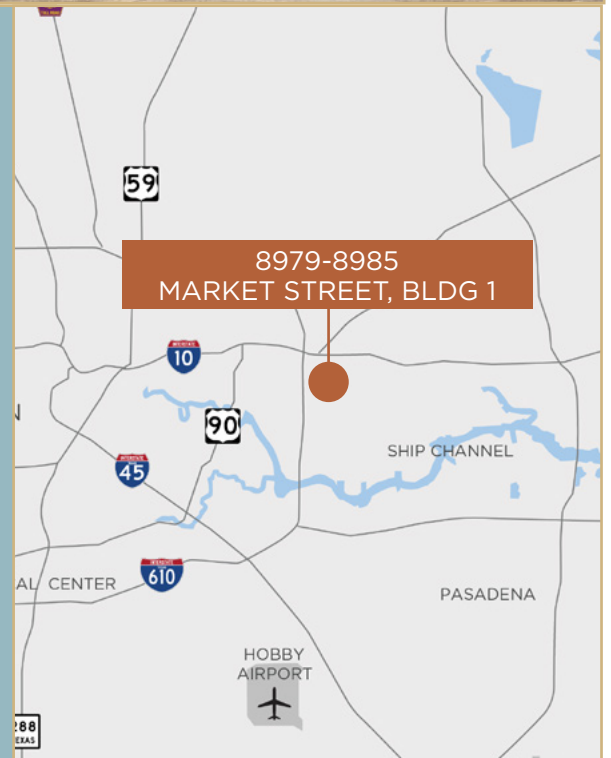

CONTACT INFO

JOHN KRUSE | Managing Director | +1 713 304 4919 | john.kruse@cushwake.com

KELLY A. LANDWERMEYER | Managing Director | +1 713 249 4295 | kelly.landwermeier@cushwake.com

1330 Post Oak Boulevard | Suite 2700 | Houston, TX 77056 | PH: +1 713 877 1700 | cushmanwakefield.com



FOR LEASE

Eastport Industrial Park
 8979-8985 MARKET STREET, BLDG 1
 Houston, Texas 77029

Owned and Operated by



Floor Plan

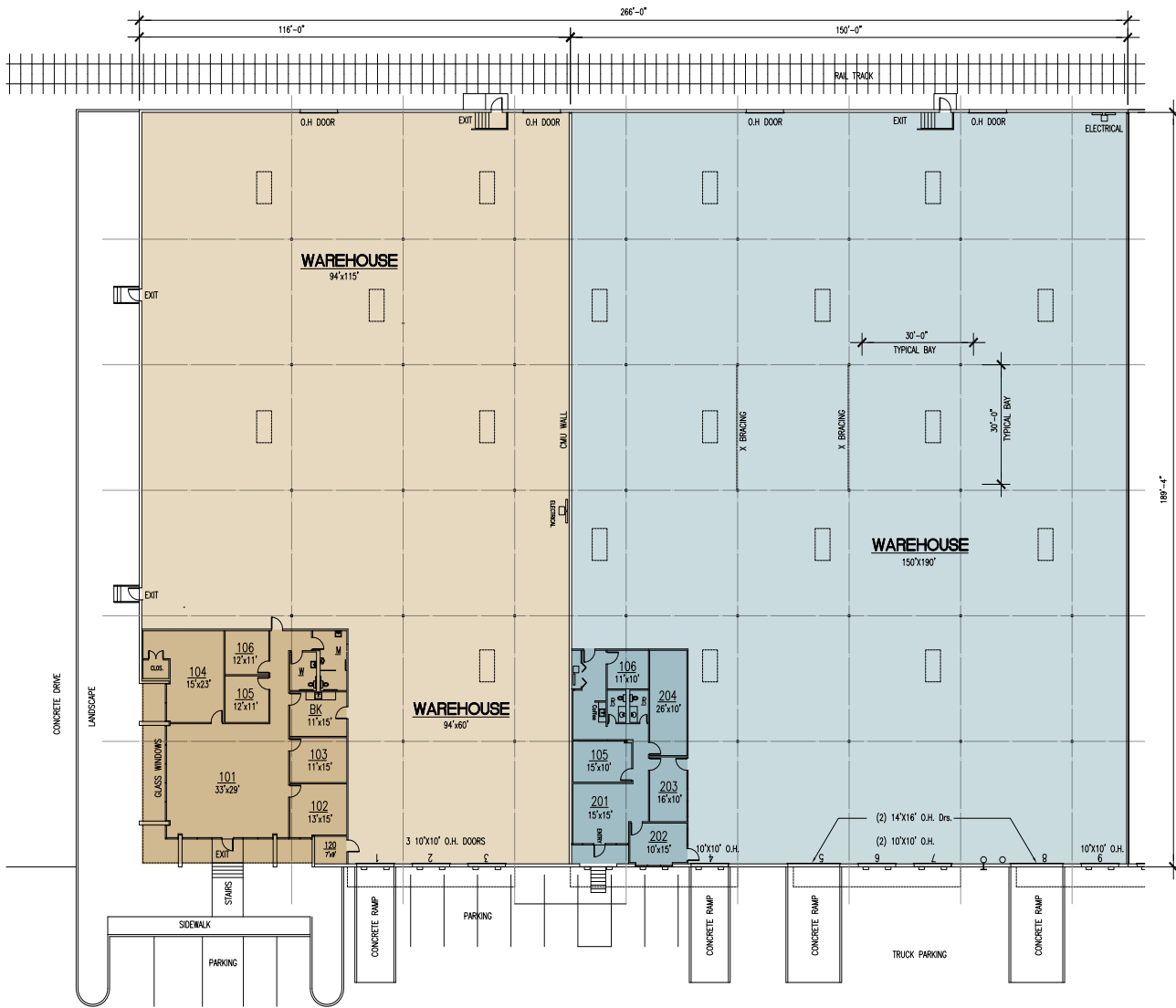

	Combined Area	Suite 8979	Suite 8985
Total Area:	± 50,540 SF	± 28,500 SF	± 28,500 SF
Office:	± 4,483 SF	± 1,730 SF	± 2,753 SF
Warehouse:	± 46,057 SF	± 26,770 SF	± 19,287 SF

CONTACT INFO

JOHN KRUSE | Managing Director | +1 713 304 4919 | john.kruse@cushwake.com
 KELLY A. LANDWERMEYER | Managing Director | +1 713 249 4295 | kelly.landwermeier@cushwake.com
 1330 Post Oak Boulevard | Suite 2700 | Houston, TX 77056 | PH: +1 713 877 1700 | cushmanwakefield.com



FOR LEASE

Eastport Industrial Park
8979-8985 MARKET STREET, BLDG 1
Houston, Texas 77029

Owned and Operated by



Aerial Map



©2026 CUSHMAN & WAKEFIELD. ALL RIGHTS RESERVED. THE INFORMATION CONTAINED IN THIS COMMUNICATION IS STRICTLY CONFIDENTIAL. THIS INFORMATION HAS BEEN OBTAINED FROM SOURCES BELIEVED TO BE RELIABLE BUT HAS NOT BEEN VERIFIED. NO WARRANTY OR REPRESENTATION, EXPRESS OR IMPLIED, IS MADE AS TO THE CONDITION OF THE PROPERTY (OR PROPERTIES) REFERENCED HEREIN OR AS TO THE ACCURACY OR COMPLETENESS OF THE INFORMATION CONTAINED HEREIN, AND SAME IS SUBMITTED SUBJECT TO ERRORS, OMISSIONS, CHANGE OF PRICE, RENTAL OR OTHER CONDITIONS, WITHDRAWAL WITHOUT NOTICE, AND TO ANY SPECIAL LISTING CONDITIONS IMPOSED BY THE PROPERTY OWNER(S). ANY PROJECTIONS, OPINIONS OR ESTIMATES ARE SUBJECT TO UNCERTAINTY AND DO NOT SIGNIFY CURRENT OR FUTURE PROPERTY PERFORMANCE.

FOR LEASE

Eastport Industrial Park
8979-8985 MARKET STREET, BLDG 1
Houston, Texas 77029

Owned and Operated by



Aerial Map

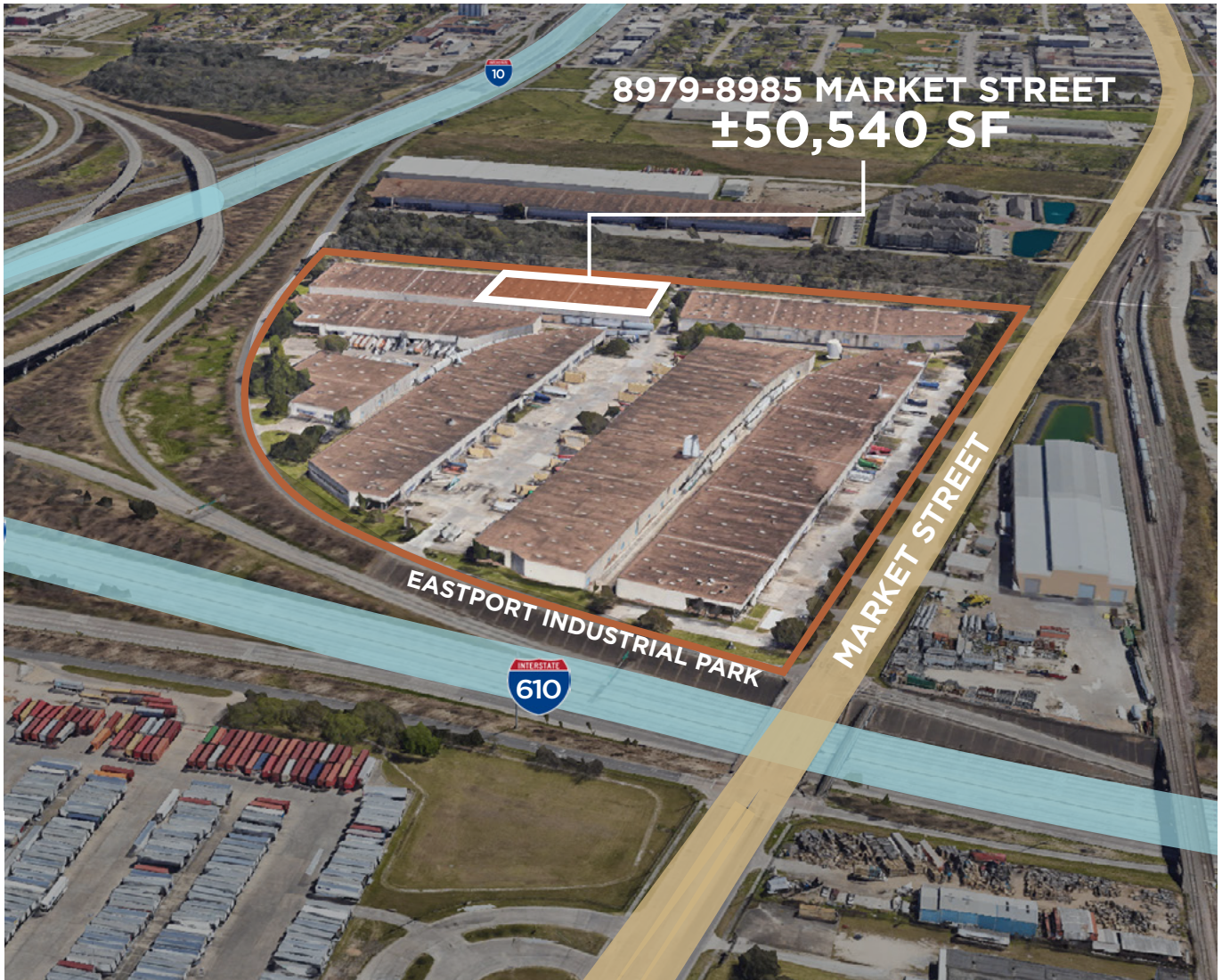

©2026 CUSHMAN & WAKEFIELD. ALL RIGHTS RESERVED. THE INFORMATION CONTAINED IN THIS COMMUNICATION IS STRICTLY CONFIDENTIAL. THIS INFORMATION HAS BEEN OBTAINED FROM SOURCES BELIEVED TO BE RELIABLE BUT HAS NOT BEEN VERIFIED. NO WARRANTY OR REPRESENTATION, EXPRESS OR IMPLIED, IS MADE AS TO THE CONDITION OF THE PROPERTY (OR PROPERTIES) REFERENCED HEREIN OR AS TO THE ACCURACY OR COMPLETENESS OF THE INFORMATION CONTAINED HEREIN, AND SAME IS SUBMITTED SUBJECT TO ERRORS, OMISSIONS, CHANGE OF PRICE, RENTAL OR OTHER CONDITIONS, WITHDRAWAL WITHOUT NOTICE, AND TO ANY SPECIAL LISTING CONDITIONS IMPOSED BY THE PROPERTY OWNER(S). ANY PROJECTIONS, OPINIONS OR ESTIMATES ARE SUBJECT TO UNCERTAINTY AND DO NOT SIGNIFY CURRENT OR FUTURE PROPERTY PERFORMANCE.