



**LOCAL EXPERTS.  
INDUSTRIAL STRENGTH.**

# OFFICE SPACE FOR LEASE

2305 S Syracuse Way  
Denver, CO 80231



Located on the south side of Evans Avenue just east of Quebec Street, 2305 S Syracuse Way is a functional, high-image, flex property that is only minutes from I-25 and I-225.

## PROPERTY FEATURES:

**Gross Building SF:** 21,327

**Available Units:** 487 - 1,165 SF

**Site Size:** 1.57 AC

**Year Built:** 1982

**Parking:** On-site and street

**Zoning:** B-4

**Rent:** CONTACT BROKER



© 2025 Ringsby Realty Corp. All rights reserved. This information has been obtained from sources believed reliable, but has not been verified for accuracy or completeness. You should conduct a careful, independent investigation of the property and verify all information. Any reliance on this information is solely at your own risk. Ringsby Realty Corp. and the Ringsby Realty Corp. logo are service marks of Ringsby Realty Corp. All other marks displayed on this document are the property of their respective owners, and the use of such logos does not imply any affiliation with or endorsement of Ringsby Realty Corp. Photos herein are the property of their respective owners. Use of these images without the express written consent of the owner is prohibited.



**LOCAL EXPERTS.  
INDUSTRIAL STRENGTH.**

# OFFICE SPACE FOR LEASE

2305 S Syracuse Way  
Denver, CO 80231

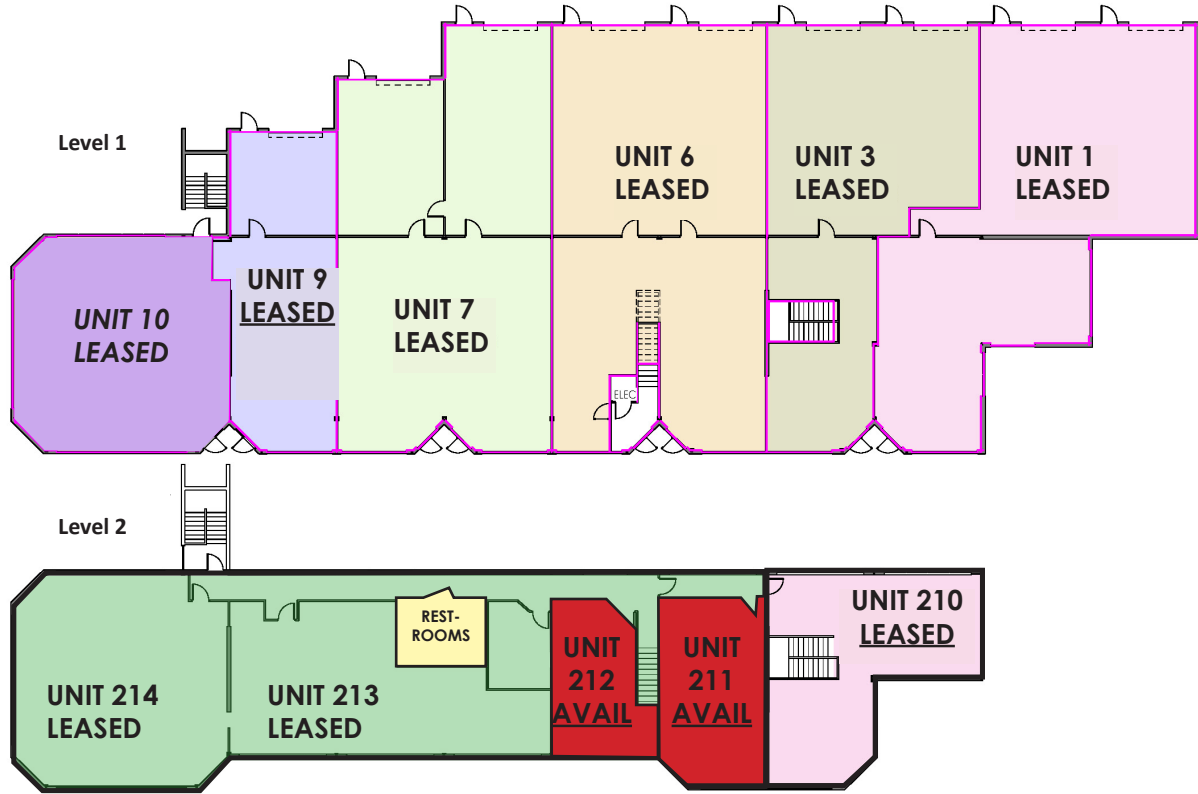

UNIT	TOTAL SF	APPROX. OFFICE SF	APPROX. WAREHOUSE SF	DRIVE-IN DOORS
211	678	678	0	0
212	487	487	0	0



**LOCAL EXPERTS. INDUSTRIAL STRENGTH.**

1801 W Colfax Ave.  
Denver, CO 80204  
www.ringsbyrealty.com

**Brian Wilkes**

brian@ringsbyrealty.com  
(303) 892-0112