

J. A. MAHLSTEDT

THIS IS TO CERTIFY THAT THE SURVEY OF THE PROPERTY SHOWN HEREON WAS PREPARED IN ACCORDANCE WITH THE EXISTING CODE OF PRACTICE FOR LAND SURVEYS ADOPTED BY THE NEW YORK STATE ASSOCIATION OF PROFESSIONAL LAND SURVEYORS.

THOMAS J. McEVY, L.S.

COPIES OF THIS SURVEY MAP NOT BEARING THE LAND SURVEYOR'S EMBOSSED SEAL SHALL NOT BE CONSIDERED TO BE A VALID TRUE COPY.

GUARANTEES OF CERTIFICATIONS INDICATED HEREON RUN ONLY TO THE PERSON FOR WHOM THE SURVEY IS PREPARED AND ON HIS BEHALF TO THE TITLE COMPANY GOVERNMENTAL AGENCY AND LENDING INSTITUTION LISTED HEREON. GUARANTEES OF CERTIFICATIONS ARE NOT TRANSFERABLE TO ADDITIONAL INSTITUTIONS OR SUBSEQUENT OWNERS.

UNAUTHORIZED ALTERATION OR ADDITION TO THIS SURVEY MAP IS A VIOLATION OF SECTION 7209, SUB-DIVISION 2 OF THE NEW YORK STATE EDUCATION LAW.

CERTIFIED TO TICOR TITLE GUARANTEE FOR TITLE NO. T61-84-0363D ONLY AND TO A. ADELE KIEVIL.

SURVEY OF LOTS 22 & 23 AS SHOWN ON "MAP OF COLUMBUS PARK" PROPERTY BELONGING TO MILLBROOK COMPANY FILED APRIL 12 1919 IN VOL. 49 PG. 41 TOGETHER WITH A PORTION OF PROPERTY BELONGING TO THE J. A. MAHLSTEDT LUMBER & COAL CO. TO THE WEST OF LOT 22 TOGETHER WITH A PARCEL OF LAND TO THE NORTH OF LOTS 22, 23 & 24 AS SHOWN ON "MAP OF COLUMBUS PARK" IN THE CITY OF NEW ROCHELLE WESTCHESTER COUNTY, N.Y.

SCALE: 1"=15'

DATE: DEC. 19, 1984

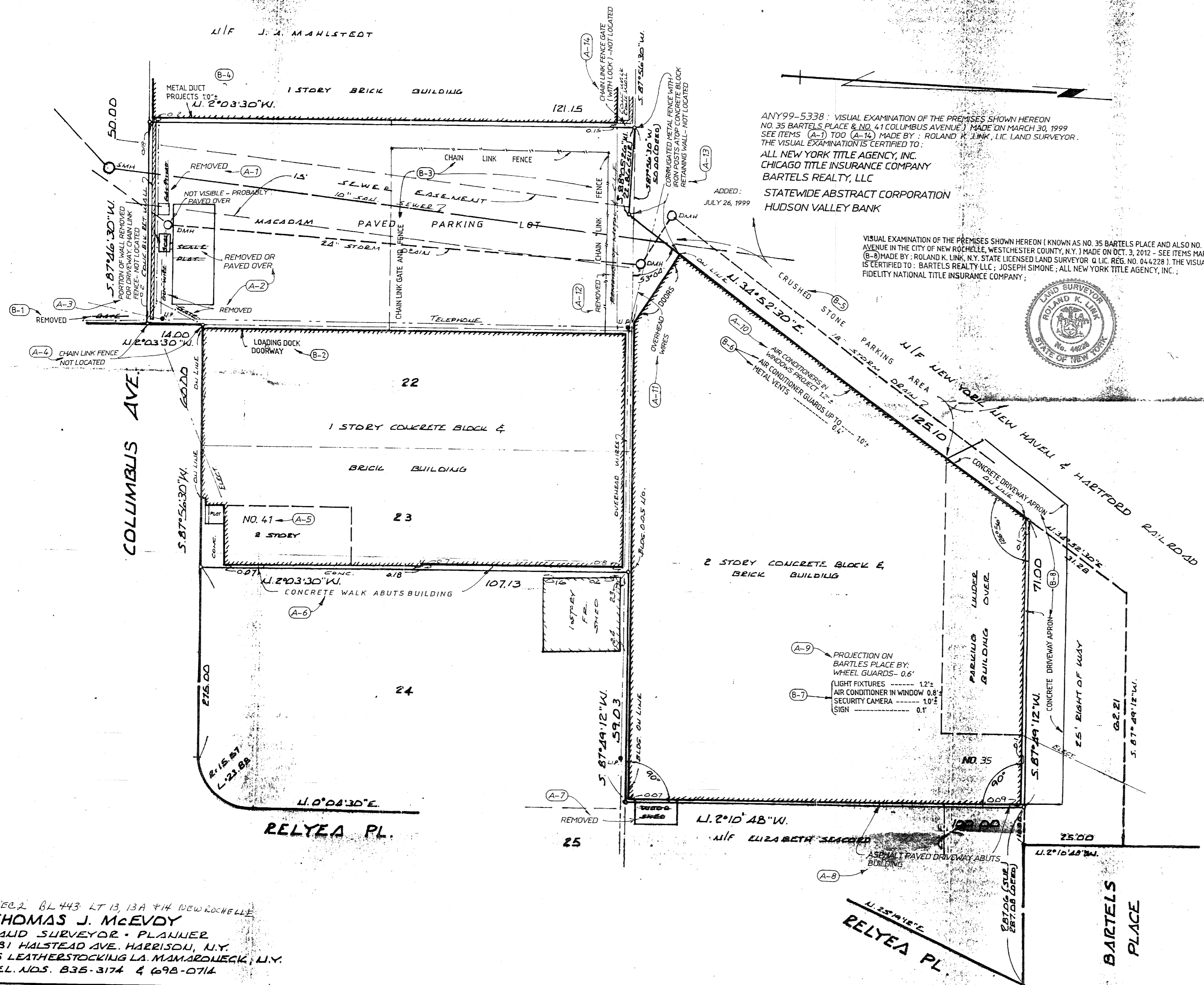

ANY99-5338: VISUAL EXAMINATION OF THE PREMISES SHOWN HEREON (NO. 35 BARTELS PLACE & NO. 41 COLUMBUS AVENUE) MADE ON MARCH 30, 1999. SEE ITEMS (A-7) TO (A-14) MADE BY: ROLAND K. LINK, LIC. LAND SURVEYOR. THE VISUAL EXAMINATION IS CERTIFIED TO: ALL NEW YORK TITLE AGENCY, INC. CHICAGO TITLE INSURANCE COMPANY BARTELS REALTY, LLC

ADDED: JULY 26, 1999
STATEWIDE ABSTRACT CORPORATION HUDSON VALLEY BANK

VISUAL EXAMINATION OF THE PREMISES SHOWN HEREON (KNOWN AS NO. 35 BARTELS PLACE AND ALSO NO. 41 COLUMBUS AVENUE IN THE CITY OF NEW ROCHELLE, WESTCHESTER COUNTY, N.Y.) MADE ON OCT. 3, 2012 - SEE ITEMS MARKED (B-1) TO (B-8) MADE BY: ROLAND K. LINK, N.Y. STATE LICENSED LAND SURVEYOR Q LIC. REG. NO. 044228. THE VISUAL EXAMINATION IS CERTIFIED TO: BARTELS REALTY LLC; JOSEPH SIMONE; ALL NEW YORK TITLE AGENCY, INC.; FIDELITY NATIONAL TITLE INSURANCE COMPANY;

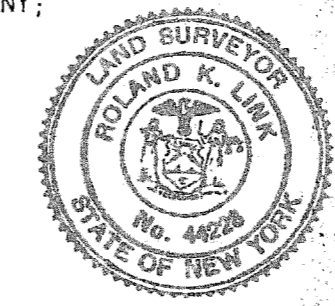

- (A-9) PROJECTION ON BARTELS PLACE BY: WHEEL GUARDS - 0.6'
- (B-7) LIGHT FIXTURES - 1.2'
- AIR CONDITIONER IN WINDOW - 0.8'
- SECURITY CAMERA - 1.0'
- SIGN - 0.1'

SEC. 2 BL 443 LT 13, 13A & 14 NEW ROCHELLE
THOMAS J. McEVY
 LAND SURVEYOR - PLANNER
 281 HALSTEAD AVE. HARRISON, N.Y.
 15 LEATHERSTOCKING LA. MAMARONECK, N.Y.
 TEL. NOS. 835-3174 & 698-0714