

# JANSEN CENTER

West of SWC Blue Diamond Rd & Decatur Blvd  
Las Vegas, NV 89139

**418,000**  
ANNUAL VISITS  
Placer.ai 2025



CALL US FOR  
**MORE INFO**

**DAN ADAMSON**

702.550.4934 | dan@roicre.com  
Lic # B.0026992.CORP

**CHRIS WALDBURGER, CCIM**

702.483.3683 | chris@roicre.com  
Lic # S.0190814



roicre.com

# PROPERTY HIGHLIGHTS

**JANSEN CENTER**  
Blue Diamond & Decatur W-SWC  
Las Vegas, NV 89139

**±2,600 SF**  
WITH DRIVE-THRU

**±4,000 SF**  
WITH NO DRIVE-THRU

- State of the art design at the popular Blue Diamond Retail/Restaurant Corridor
- Cross parking throughout this center and across access with adjacent center, anchored by EOS Fitness
- Direct access from Blue Diamond Rd
- Exposure to over 83,000 vehicles per day (combined)
- Close proximity to affluent neighborhoods and master planned communities

 **±0.43 AC**  
Parcel Size

 **General Commercial (C-2)**  
Zoning

 **176-13-801-050**  
Parcel Number



# SITE AERIAL

**JANSEN CENTER**  
Blue Diamond & Decatur W-SWC  
Las Vegas, NV 89139



# PROPERTY SITE PLAN

**JANSEN CENTER**  
Blue Diamond & Decatur W-SWC  
Las Vegas, NV 89139

**±2,600 SF**  
WITH DRIVE-THRU

**±4,000 SF**  
WITH NO DRIVE-THRU

**±0.43 AC**  
PARCEL SIZE

Suite	Tenant	Size (SF)
101-102	The Breakfast Spot	3,285
103	Beauty Factory MedSpa	1,460
104	Drop Sauna	1,680
105-106	Pullman Bread & UNO Katsu Sando	2,520
107-108	MJ Nails & Spa	2,800
109	Apricot Lane Boutique	1,460
110	Smoothie King	1,460
111	Tacotarian	1,825
<b>PAD</b>	<b>AVAILABLE</b>	<b>2,600</b>

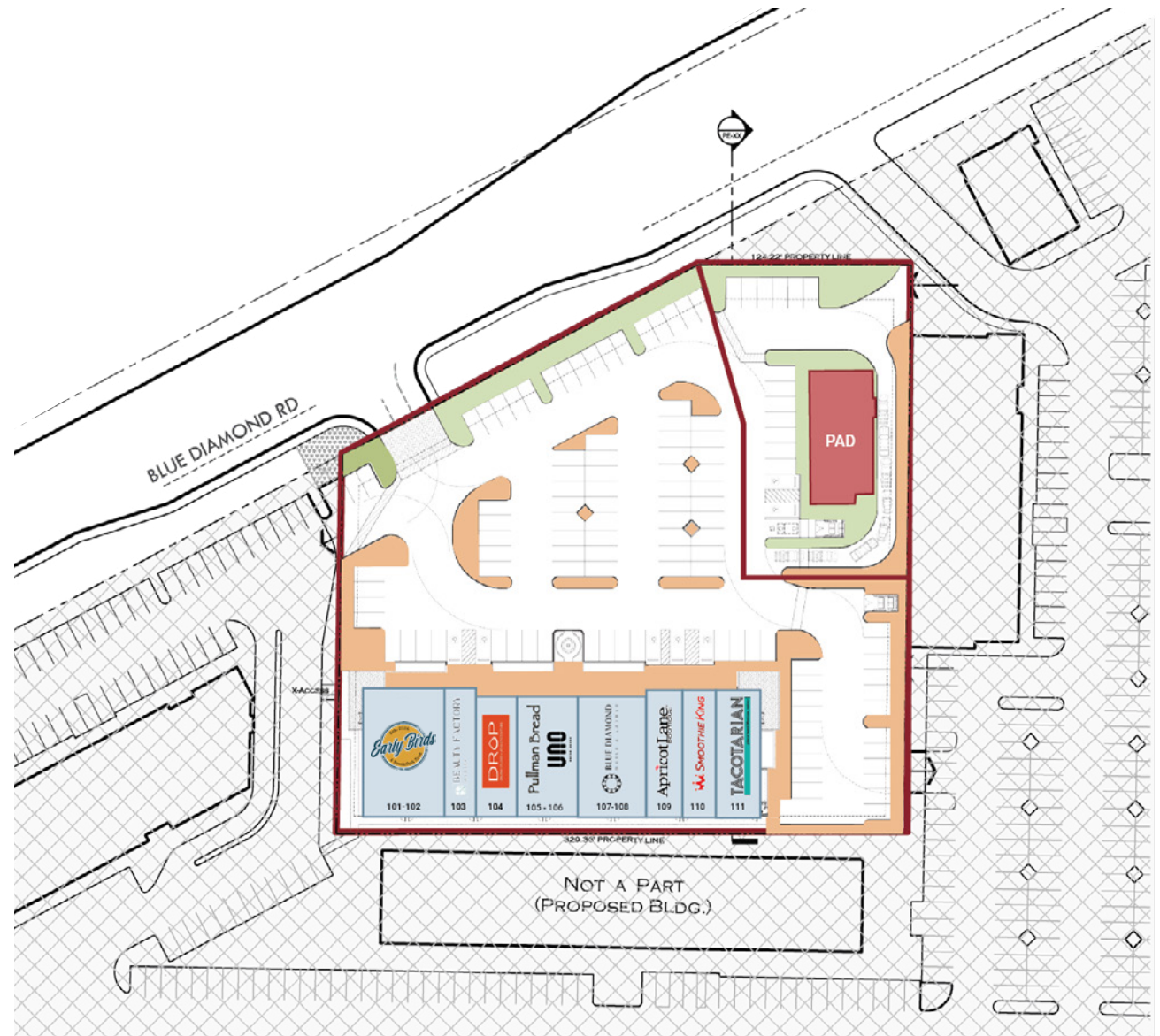

# AREA DEMOGRAPHICS



## POPULATION

1 Mile	3 Miles	5 Miles
9,449	121,565	340,706



## AVERAGE HOUSEHOLD INCOME

1 Mile	3 Miles	5 Miles
\$143,337	\$127,711	\$124,808



## TRAFFIC COUNTS

Blue Diamond Rd	Decatur Blvd
65,000 VPD	19,900 VPD

Sources:  
SitesUSA 2025  
TRINA, NV DOT 2024

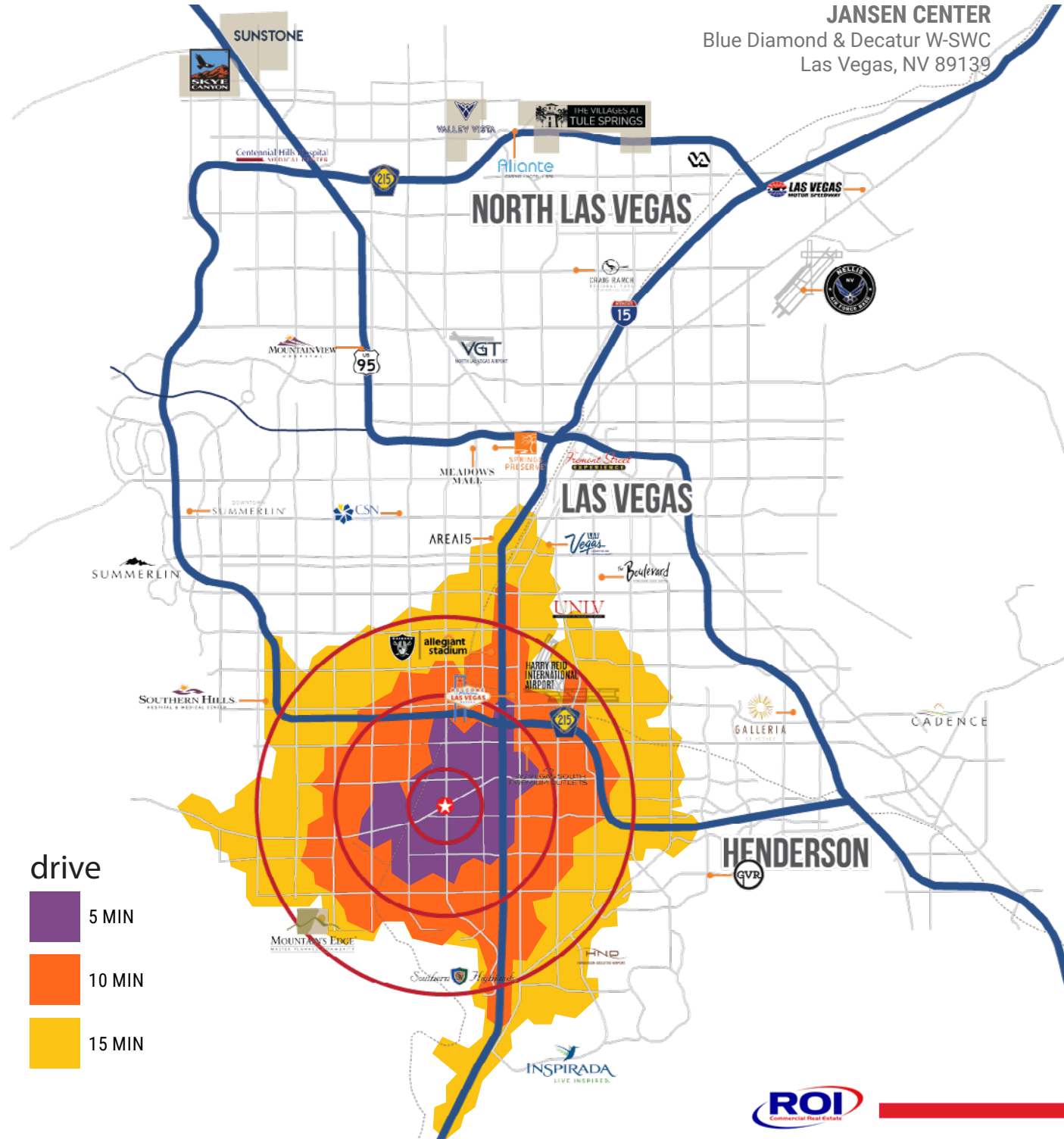

# JANSEN CENTER

WEST OF SWC BLUE DIAMOND RD & DECATUR BLVD  
LAS VEGAS, NV 89139



[www.roicre.com](http://www.roicre.com)



9121 W Russell Rd  
Suite 111  
Las Vegas, NV 89148

# CALL US FOR MORE INFO

## DAN ADAMSON



702.550.4934



[dan@roicre.com](mailto:dan@roicre.com)



NV Lic# B.0026992.CORP

## CHRIS WALDBURGER, CCIM



702.483.3683



[chris@roicre.com](mailto:chris@roicre.com)



NV Lic S.0190814

## Let's Stay Connected!



[roicre](https://www.facebook.com/roicre)



[@roicre](https://twitter.com/roicre)



[@roi.cre](https://www.instagram.com/roi.cre)



[roicre/](https://www.linkedin.com/company/roicre/)

### DISCLAIMER

All information contained herein is from sources we deem reliable, and we have no reason to doubt its accuracy; however, no guarantee or responsibility is assumed thereof, and it shall not form any part of future contracts. Properties are submitted subject to errors and omissions and all information should be carefully verified. All measurements quoted herein are approximate.

Demographics are provided by SitesUSA using data from private and government sources deemed to be reliable. The information herein is provided without representation or warranty.

Georeferenced data herein are provided by Placer Labs, Inc. and is provided without representation or warranty.

Photos contained herein are property of their respective owners. Photos do not guarantee the current condition of the property.

04/16/26