

FOR LEASE

REGENCY INDUSTRIAL PARK

10407 ROCKET BOULEVARD
ORLANDO, FLORIDA, 32824



ZONING: IND-4
Manufacturing



23,000 - 60,000 +/-
RSF INDUSTRIAL
SPACE AVAILABLE



HEAVY POWER
3-PHASE | 3,600AMP
240/480V

 FranklinStreet

LICENSED FLORIDA BROKER # CQ1048040
www.FranklinSt.com

SCOTT EDWARDS

Director
407.458.5404
Scott.Edwards@FranklinSt.com

PROPERTY OVERVIEW

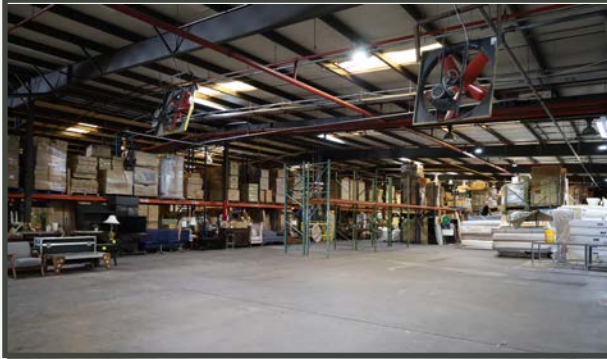

FULLY INSULATED CEILING

COMPRESSED AIR LINES THROUGHOUT

NATURAL GAS TO SITE



HEAVY POWER LINED WITH ELECTRICAL DROPS

FIRE SPRINKLER SYSTEM .3 GPM / 2000 SF

DOCK HIGH AND GRADE LEVEL LOADING



~18' CLEAR HEIGHT

METAL HALIDE AND FLOURESCENT LIGHTING

OVERSIZED BAY DOORS (24' WIDE & 20' WIDE)



Located in the heart of South Orlando's 450 Acre, Regency Industrial Park - host to the most dynamic industrial workforce in all of Central Florida, which has long been considered the most in-demand industrial submarket in all of the Orlando MSA. The Property is just minutes away from FL-528 (Beachline Expressway), Interstate-4 (I-4), Florida's Turnpike, and FL-417.

PROPERTY HIGHLIGHTS



3.7 MILES FROM FLORIDA'S TURNPIKE



6.6 MILES FROM FL-528 (Beachline Expressway)



6.1 MILES FROM I-4



4 MILES FROM FL-417



9 MILES TO O.I.A (MCO)



14 MILES FROM FL-408

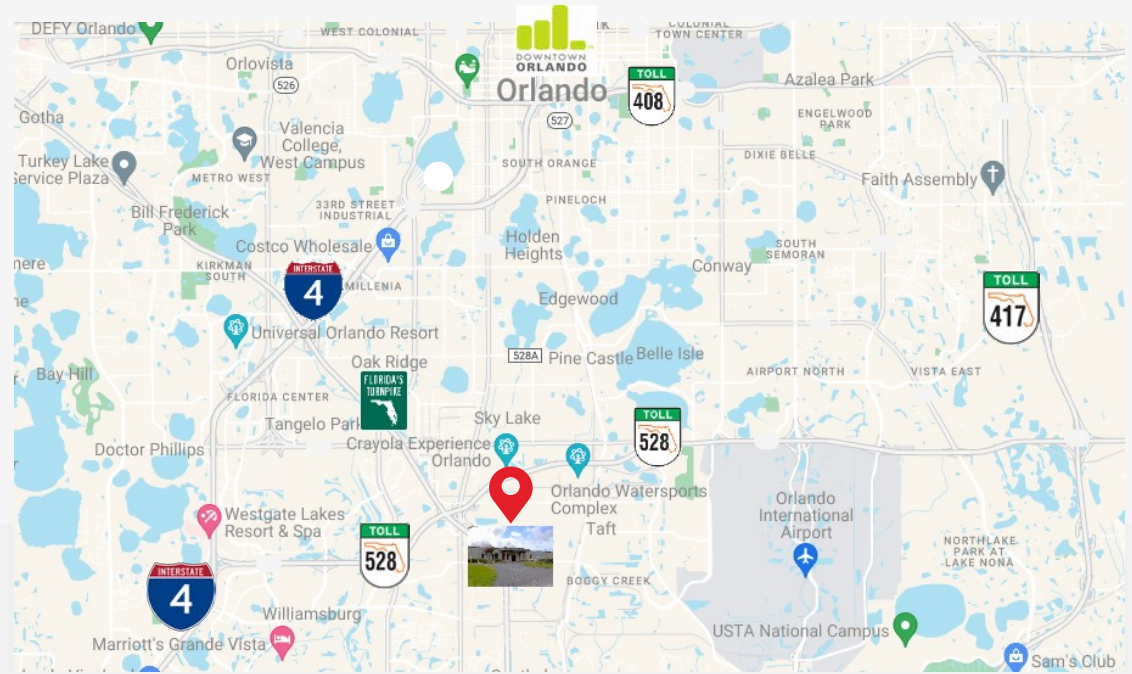

DEMOGRAPHICS

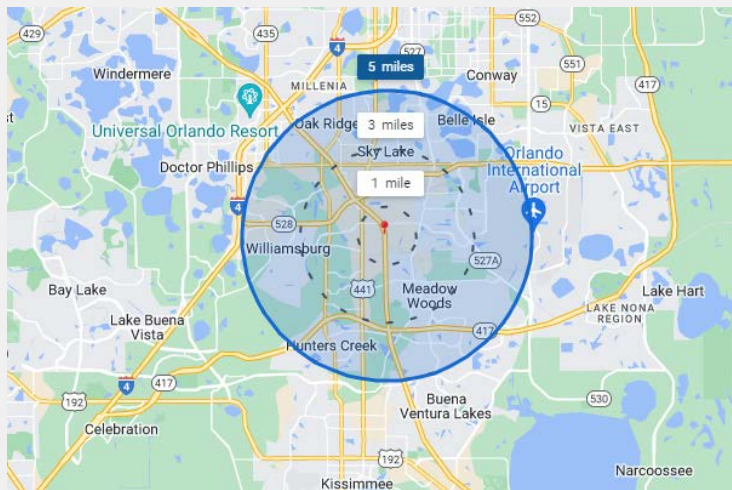

FLOOR PLAN

PROPERTY SPECS

- » 23,000 - 60,000 +/- RSF Available
- » 7,000 +/- SF Office (Two-Story)
- » Five (5) Dock High Bays
- » Four (4) Grade Level Bays
- » Base Rent: \$9.50/SF NNN
- » OPEX: \$1.53/SF
- » Occupancy: 10/1/2023
- » Contact broker for more details

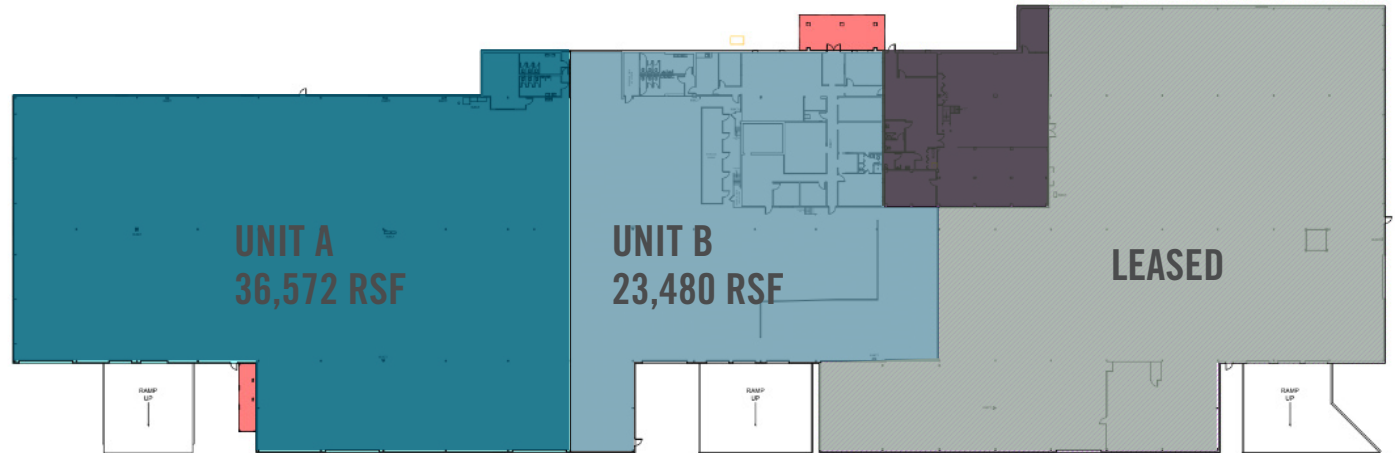

SCOTT EDWARDS (LEAD)
Director
407.458.5404
Scott.Edwards@FranklinSt.com

CHRIS BUTLER
Managing Director/Broker of Record
813.345.5892
Chris.Butler@FranklinSt.com