



425

475

Woodfield  
CORPORATE CENTER

A PLACE TO  
*thrive*

425/475 North Martingale Rd., Schaumburg, IL 60173



# THE WOODFIELD CORPORATE CENTER EXPERIENCE



**425 / 475 Woodfield  
Corporate Center is  
the Class A office  
destination  
where tenants**

*thrive.*

This two-building, 718,962 SF office complex, designed by acclaimed architectural firm Holabird & Root, is situated right at the full interchange of I-290 and Higgins Road, allowing for highly convenient access to O'Hare International Airport, Downtown Chicago, and the neighboring suburbs.

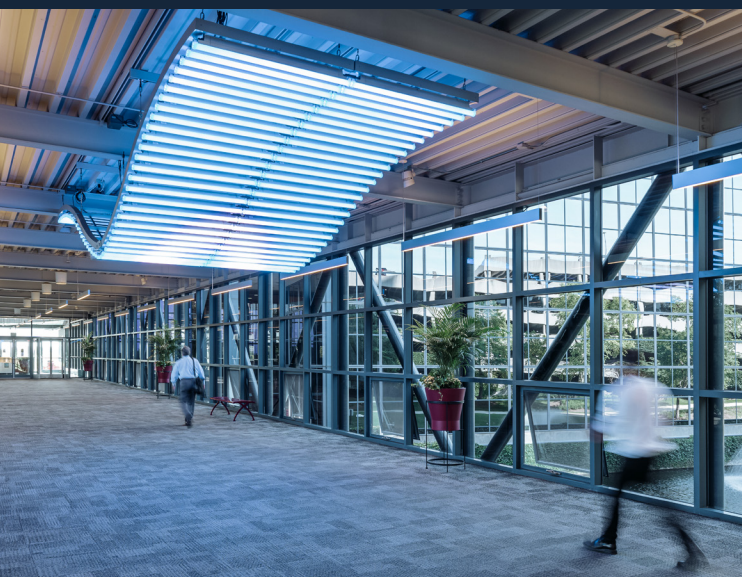

The efficient, rectangular 22,000 SF floor plates include 6' high windows that provide natural light and sweeping views of the 3,500 acre Busse Woods and the Chicago skyline. Recent investment into shared spaces and building amenities make Woodfield Corporate Center a top-of-the-market office experience.



# TOP-OF-THE-MARKET AMENITIES

- + **Furnished spec suites** ready for immediate occupancy
- + **Covered parking** for all employees and visitors
- + **Expansive outdoor space** with award-winning landscaping
- + Modernized **fitness center**
- + 24-hour on-site **security**
- + 100 seat **conference center** and 60 seat **training room**
- + **24/7 tenant lounge**
- + **EV charging stations**
- + Adjacent to **400-room Marriott Hotel**
- + Easy access to wide range of **nearby restaurants and hotels**
- + **Amenity improvements** including a new state-of-the-art cafeteria with adjacent outdoor seating, new elevators and improved common areas

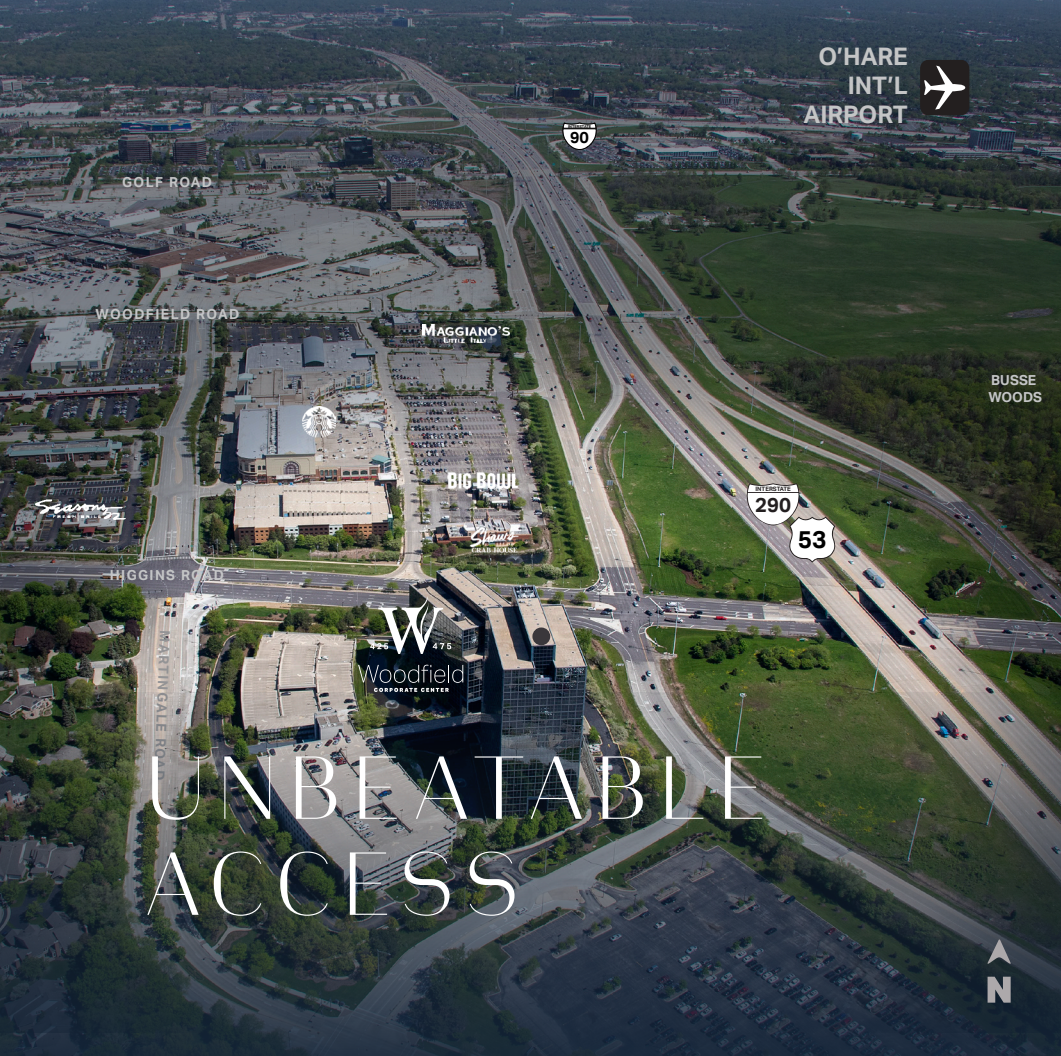

O'HARE  
INT'L  
AIRPORT 

**425 / 475 Woodfield  
Corporate Center  
has the best  
location in the  
northwest suburbs,  
sitting directly on  
the interchange  
of I-290 and  
Higgins Road.**

**2** minutes to  
Woodfield Mall

**15** minutes to  
O'Hare Int'l  
Airport

**30** minutes to  
Downtown  
Chicago

**UNBEATABLE  
ACCESS**

**A PLACE TO Thrive**

**CBRE**

**Leasing Information**

Daniel E. Graham  
847-706-4032  
dan.graham@cbre.

Michael R. Graham  
847-706-4033  
michael.graham@cbre.com

**Lincoln**

**Management**

Kristopher Entler  
General Manager  
847-585-5878  
kentler@lpc.com

<https://woodfieldcorporate.com>

©2024 CBRE, Inc. All rights reserved. This information has been obtained from sources believed reliable, but has not been verified for accuracy or completeness. You should conduct a careful, independent investigation of the property and verify all information. Any reliance on this information is solely at your own risk. CBRE and the CBRE logo are service marks of CBRE, Inc. All other marks displayed on this document are the property of their respective owners, and the use of such logos does not imply any affiliation with or endorsement of CBRE. Photos herein are the property of their respective owners. Use of these images without the express written consent of the owner is prohibited. PMStudio\_November2022