



**FOR LEASE** | **15,339 SF**  
**4200 N HOLTON ST** | **MILWAUKEE, WI**



**PHOENIX**  
**INVESTORS**  
*Opportunity. Execution. Value Creation.*

**PATRICK DEDERING | DIRECTOR, ACQUISITION & LEASING | 414-376-6933 | PATRICK@PHOENIXINVESTORS.COM**

This document has been prepared by Phoenix Investors for advertising and general information only. Phoenix Investors makes no guarantees, representations, or warranties of any kind, expressed or implied, regarding the information including, but not limited to, warranties of content, accuracy, and reliability.



## **PROPERTY HIGHLIGHTS**



**CAFETERIA  
WITH KITCHEN**



**FENCED OUTDOOR  
BASKETBALL COURT**



**AMPLE PARKING**



**SECURITY SYSTEM  
WITH CAMERAS**



# PROPERTY DETAILS

4200 N HOLTON ST | MILWAUKEE, WI

AVAILABLE SPACE	15,339 SF
-----------------	-----------

CLASSROOMS	10
------------	----

SMALL TESTING ROOMS	5
---------------------	---

RESTROOMS	9
-----------	---



# FLOOR PLAN

4200 N HOLTON ST | MILWAUKEE, WI

VIEW DAYCARE SPACE WALK-THROUGH

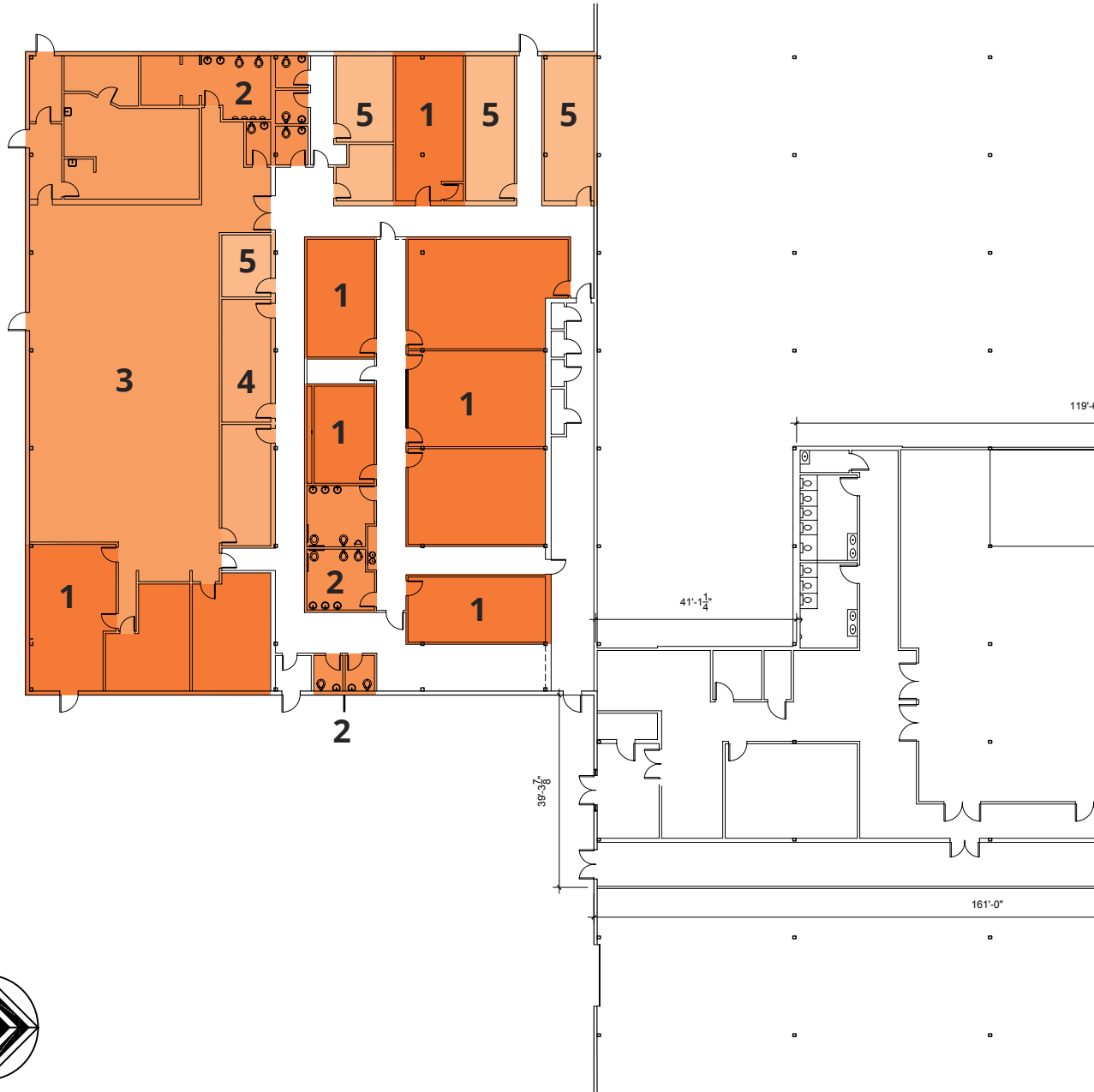

NUMBER	SPACE DESIGNATION
1	CLASSROOMS
2	RESTROOMS
3	CAFETERIA
4	CONFERENCE ROOMS
5	TESTING ROOMS
<b>TOTAL</b>	<b>15,339 SF</b>

# LOCATION MAP

4200 N HOLTON ST | MILWAUKEE, WI

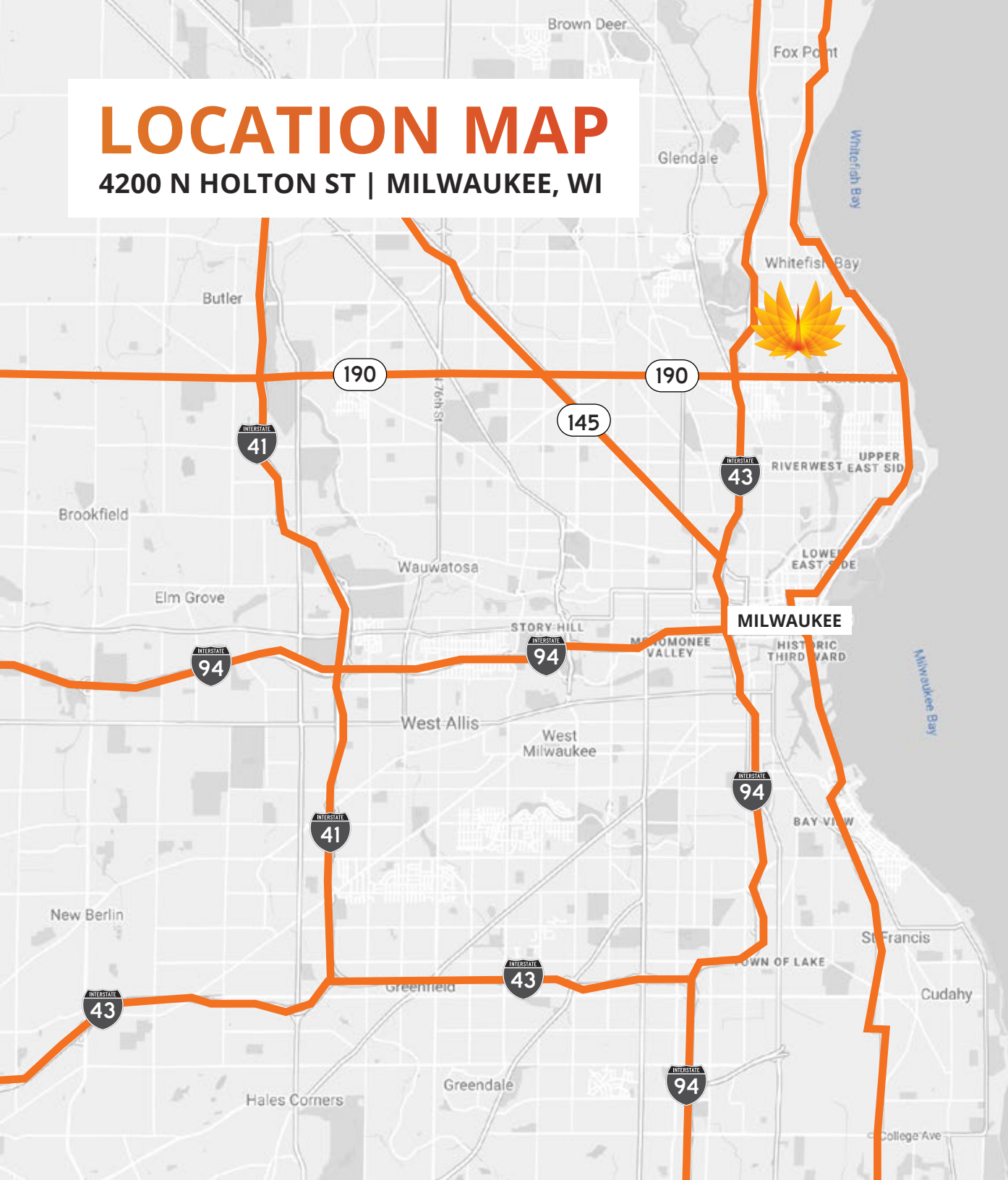

I-43	1 MILE
PORT OF MILWAUKEE	8 MILES
MITCHELL INT'L AIRPORT	14 MILES
CHICAGO	95 MILES
INDIANAPOLIS	283 MILES
MINNEAPOLIS	340 MILES