

**±26,967 UP TO ±81,569 SF**  
**R&D BUILDING - IMMEDIATELY AVAILABLE**  
**FULL-BUILDING HQ OPPORTUNITY**



**130-150 SHORELINE DRIVE**  
**REDWOOD CITY, CA**

**CBRE**

**GI PARTNERS**

---

# BUILDING SPECIFICATIONS



Total Availability: ±81,569 SF  
130 Shoreline: ±26,967 SF  
150 Shoreline: ±54,602 SF



Clear Height: 11' - 24'



Grade Level Doors: 2



Parking: 3.20 / 1,000 SF



Power: 2,800 amps w/ 60 KW emergency generator



Plug-and-play turnkey office/lab space available



# SITE PLAN

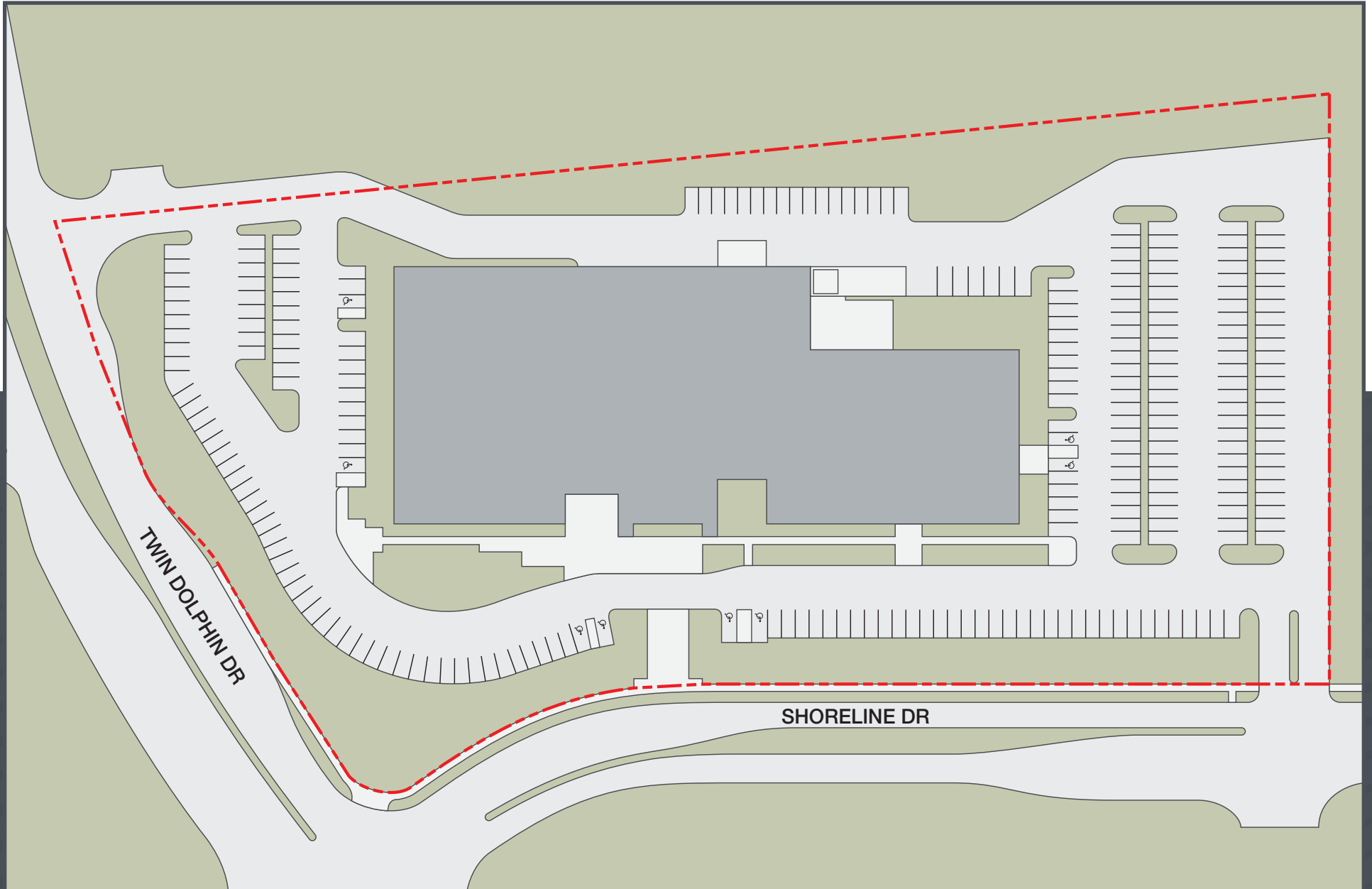

# FLOOR PLAN

## 1<sup>ST</sup> Floor

- » Open / Flexible Floorplate
- » 60 KW Backup Generator
- » All Hands / Break Room
- » 2 Grade-Level Doors

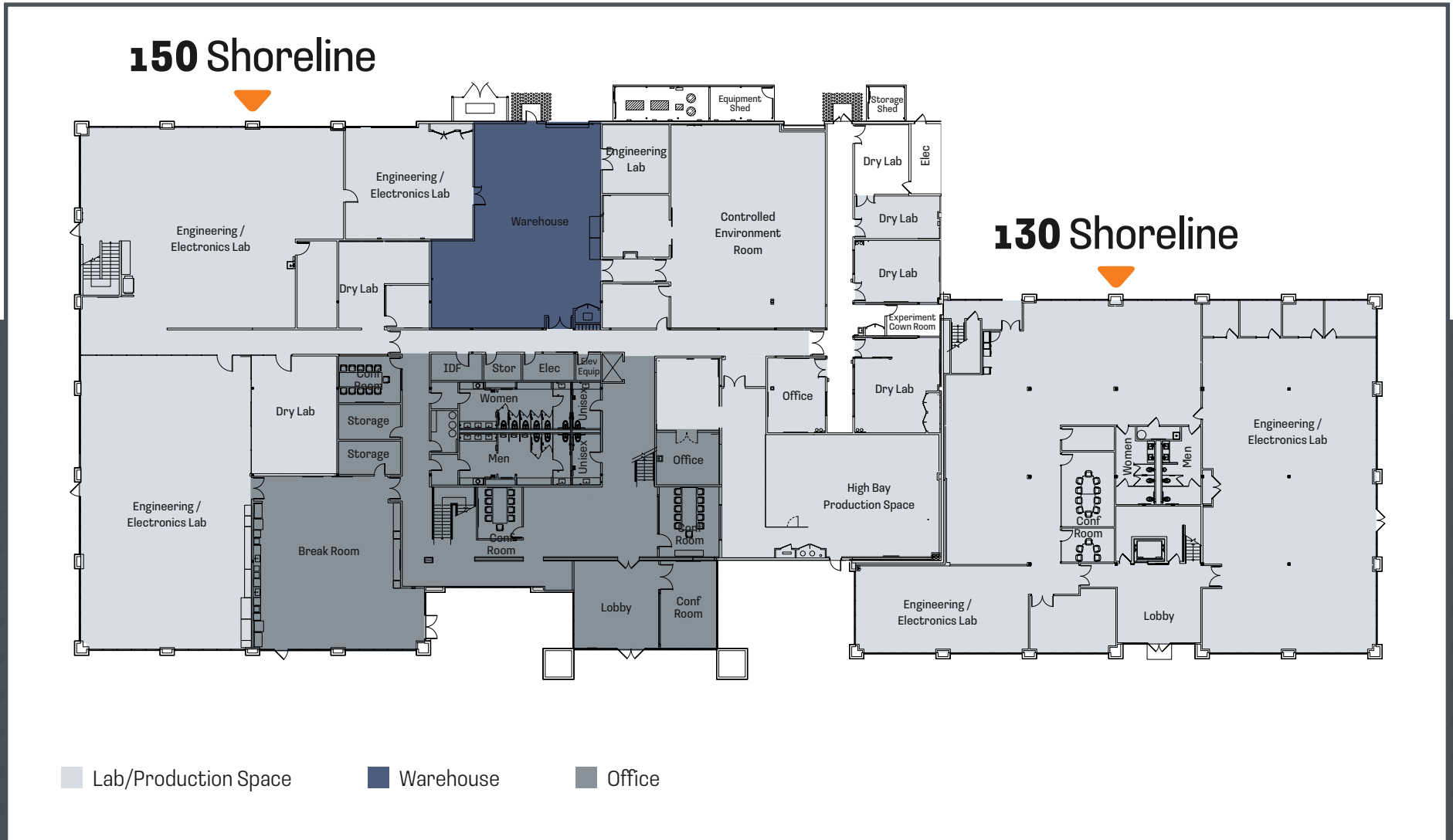

# FLOOR PLAN

## 2<sup>nd</sup> Floor

### 150 SHORELINE

- » 125 Workstations
- » 18 Meeting/Huddle Rooms
- » 6 Conference Rooms
- » Break Area

### 130 SHORELINE

- » 108 Workstations
- » 2 Meeting/Huddle Rooms
- » 7 Conference Rooms
- » Break Area

## 150 Shoreline

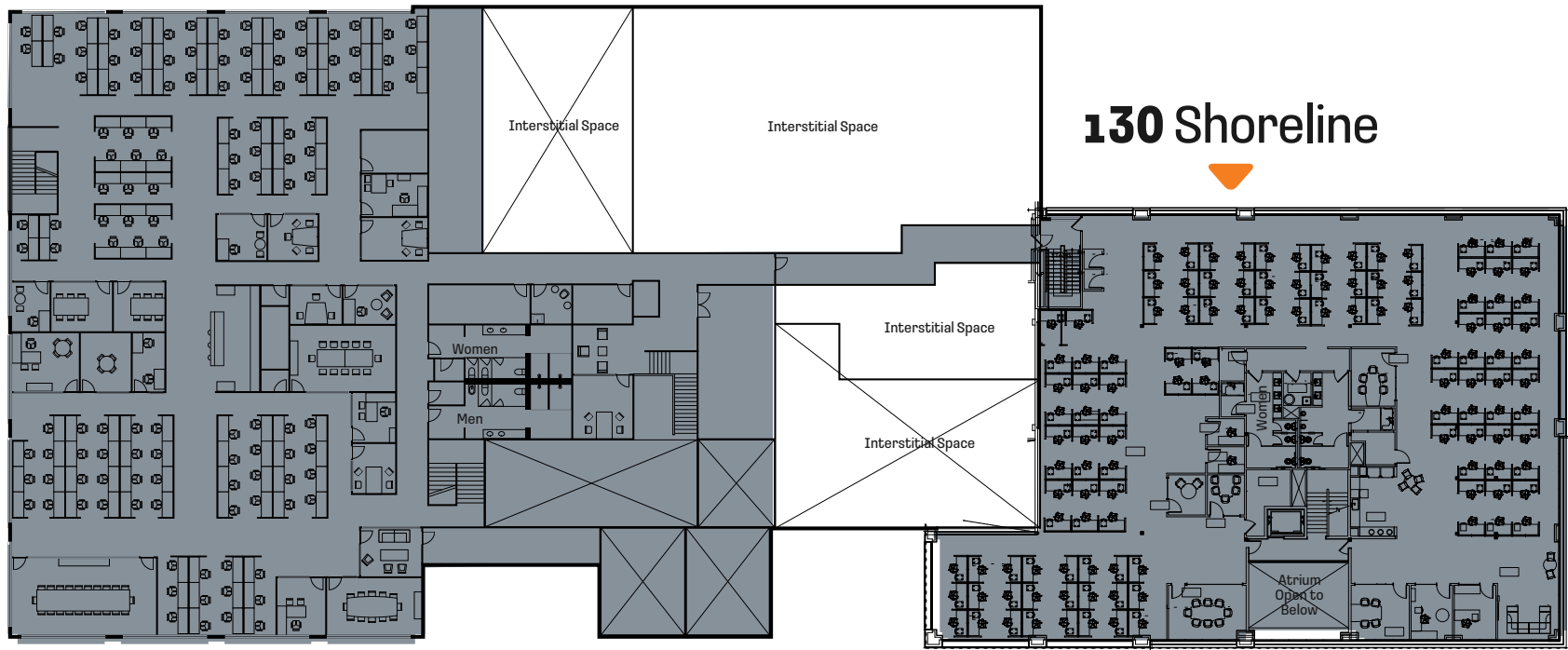

## 130 Shoreline

■ Office

# PROPERTY PHOTOS

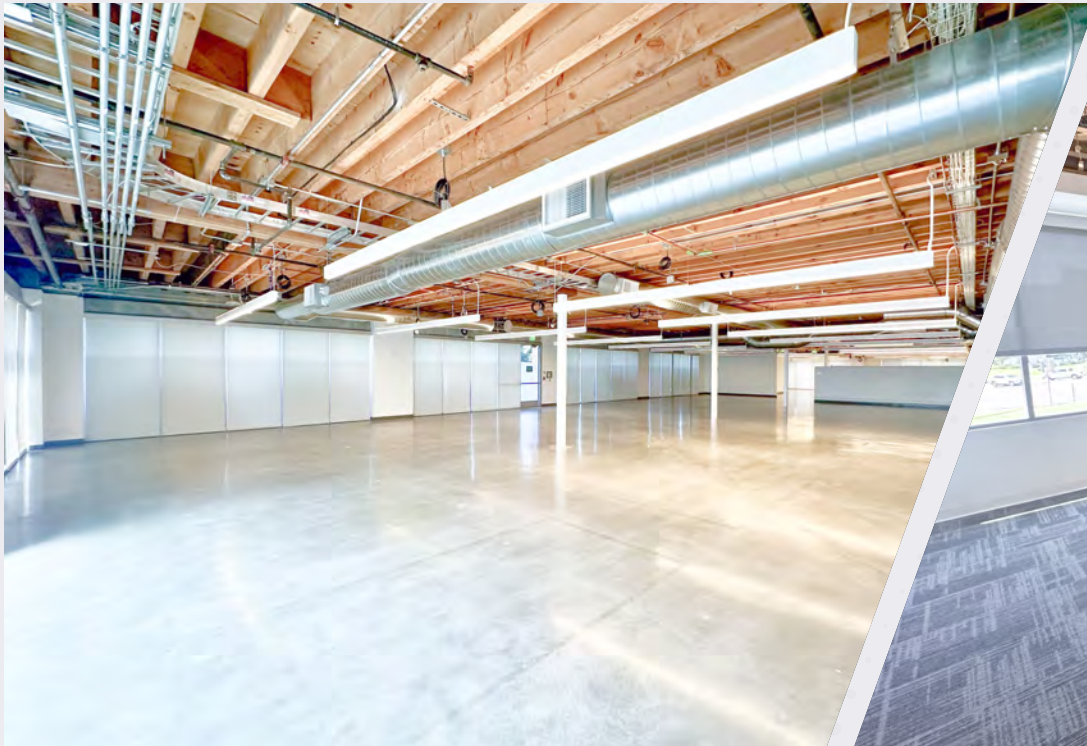

# AMENITIES MAP

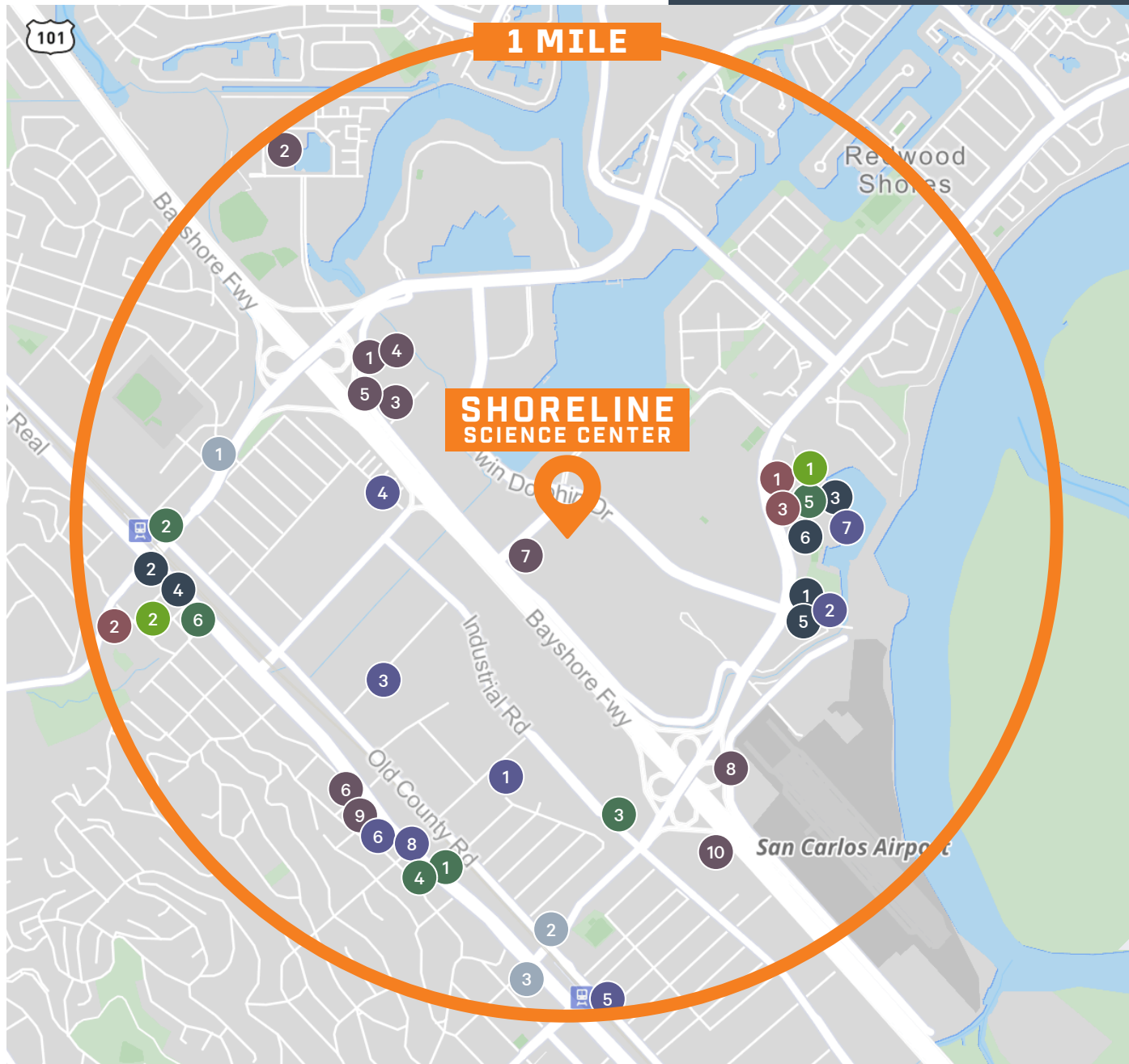

1 MILE

SHORELINE SCIENCE CENTER

- Restaurant - Fast Casual**
  - 1 Local Kitchens
  - 2 Doghaus
  - 3 Mendocino Farms
  - 4 Panda Express
  - 5 Proposition Chicken
  - 6 Chipotle Mexican Grill
- Hotels**
  - 1 Studio 6
  - 2 Hyatt House
  - 3 Extended Stay America
  - 4 Motel 6
  - 5 Homewood Suites by Hilton
  - 6 Holiday Inn Express
  - 7 SpringHill Suites by Marriott
  - 8 Fairfield Inn & Suites by Marriott
  - 9 Hyatt Place
  - 10 Residence Inn by Marriott
- Convenience Store**
  - 1 ampm
  - 2 7-Eleven US
  - 3 Circle K Stores
- Gyms + Fitness Facilities**
  - 1 CrossFit
  - 2 The Bay Club
  - 3 CrossFit
- Restaurant - QSR/Fast Food**
  - 1 Taco Bell
  - 2 Wendy's
  - 3 In-N-Out Burger
  - 4 McDonald's US
  - 5 Five Guys
  - 6 Sourdough & Co.
- Banks + Financial Services**
  - 1 Chase
  - 2 Wells Fargo
  - 3 Bank of America
- Grocery**
  - 1 Nob Hill Foods
  - 2 Safeway
- Reference Points**
  - 4 Shoot360
  - 5 barre3
  - 6 Club Pilates
  - 7 Orangetheory Fitness
  - 8 My Gym Children's Fitness Centers

# TRANSIT MAP

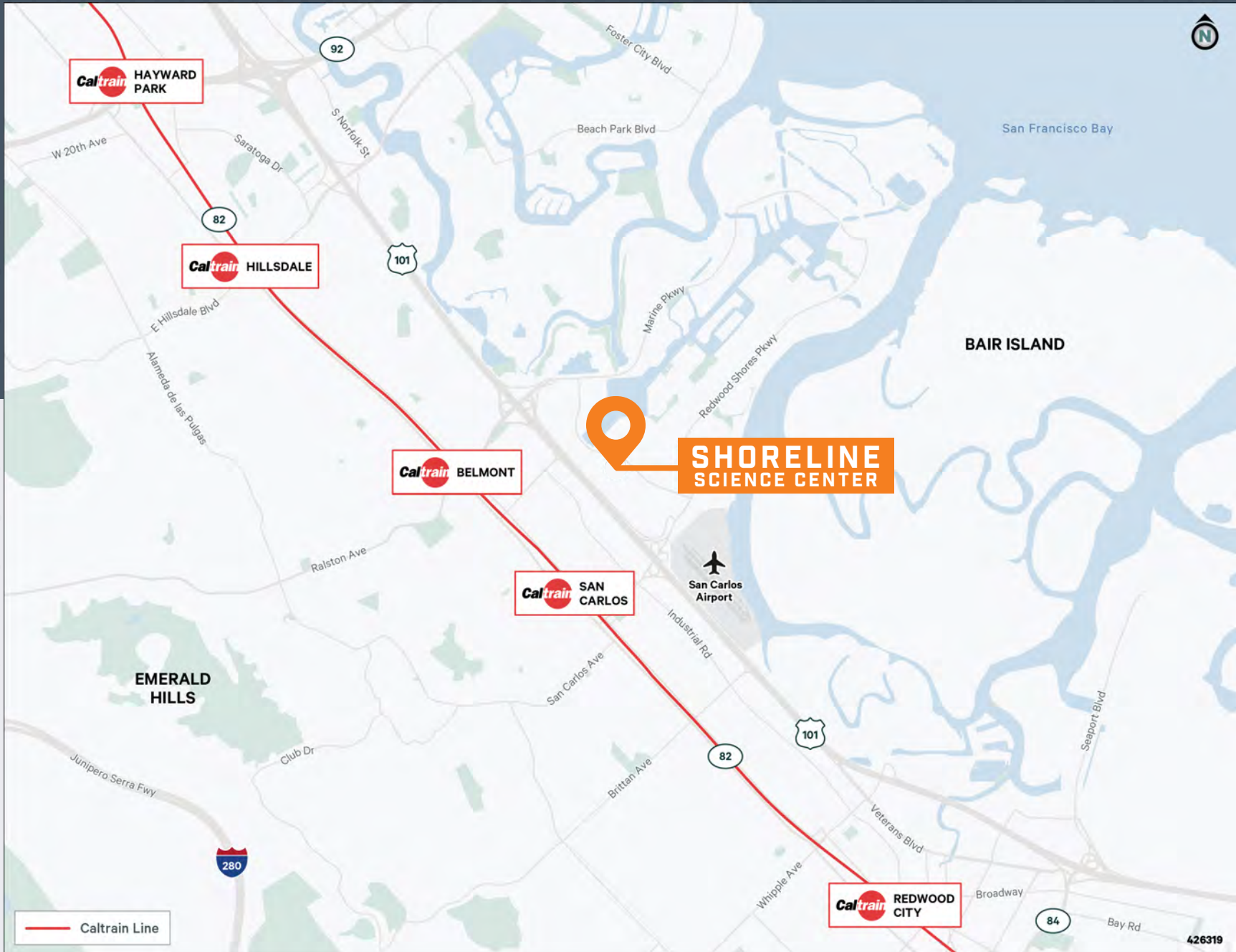

**130-150 SHORELINE DRIVE  
REDWOOD CITY, CA**



**GREGG DOMANICO**

Vice Chairman

+1 415 215 5218

[gregg.domanico@cbre.com](mailto:gregg.domanico@cbre.com)

Lic. 00996779

**MICHAEL DOMANICO**

Senior Vice President

+1 650 430 1464

[michael.domanico@cbre.com](mailto:michael.domanico@cbre.com)

Lic. 01944774

**GIO HAUGHTON**

Senior Associate

+1 650 387 1197

[gjo.haughton@cbre.com](mailto:gjo.haughton@cbre.com)

Lic. 02107010

**GI PARTNERS**

**CBRE**

© 2025 CBRE, Inc. All rights reserved. This information has been obtained from sources believed reliable but has not been verified for accuracy or completeness. CBRE, Inc. makes no guarantee, representation or warranty and accepts no responsibility or liability as to the accuracy, completeness, or reliability of the information contained herein. You should conduct a careful, independent investigation of the property and verify all information. Any reliance on this information is solely at your own risk. CBRE and the CBRE logo are service marks of CBRE, Inc. All other marks displayed on this document are the property of their respective owners, and the use of such marks does not imply any affiliation with or endorsement of CBRE. Photos herein are the property of their respective owners. Use of these images without the express written consent of the owner is prohibited.