

# 8929 Oso Ave.

Chatsworth, CA

±23,304 SF Free Standing Industrial Building Available



**For more information, please contact:**

**Bennett Robinson** +1 818 907 4608  
Vice Chairman [bennett.robinson@cbre.com](mailto:bennett.robinson@cbre.com)  
Lic. 00984312

**CBRE**

# Aerial Map

This location in Chatsworth provides a strategic base for businesses, benefiting from the area's robust infrastructure and accessibility within the broader Los Angeles region.

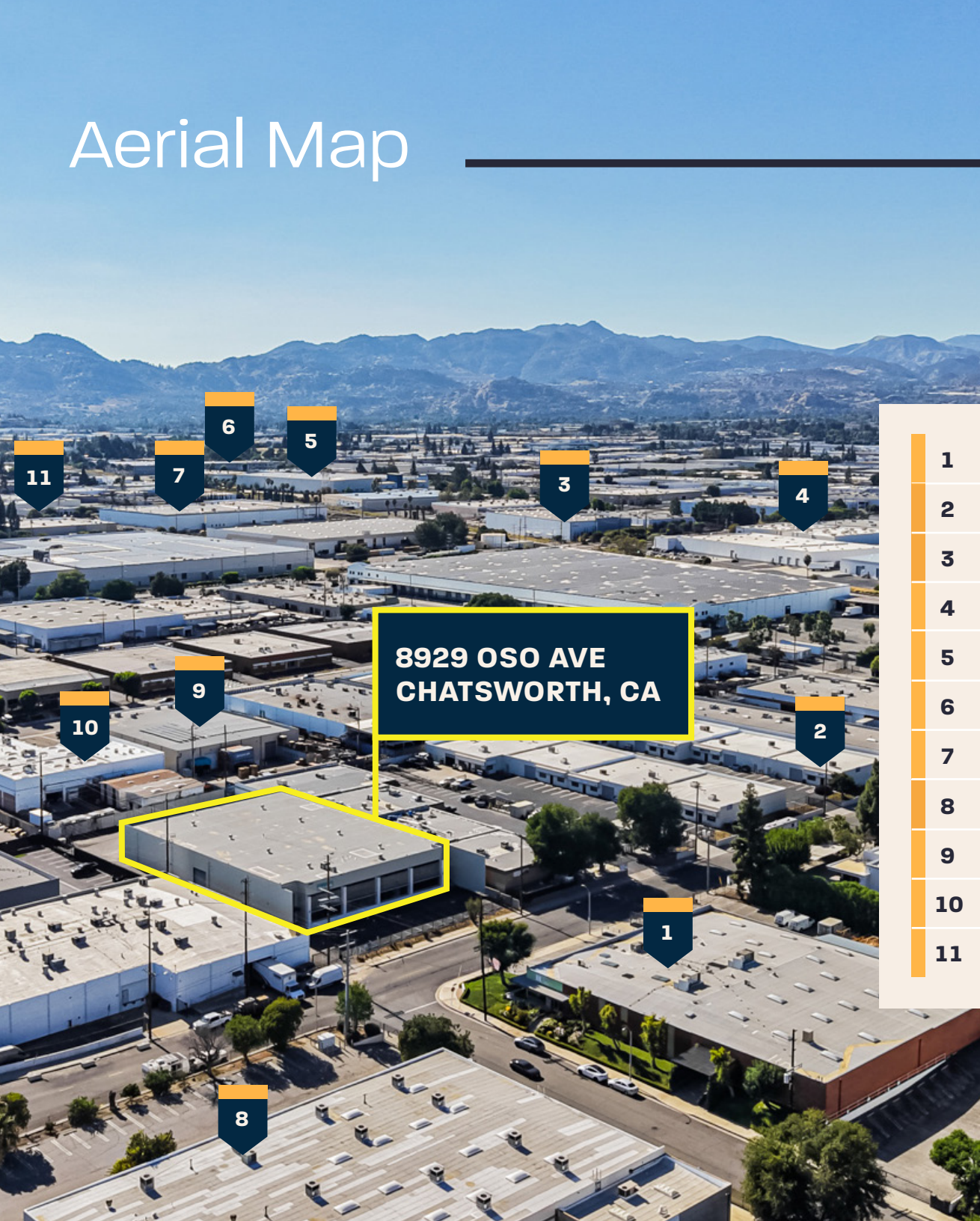

**8929 OSO AVE  
CHATSWORTH, CA**

- 1 Sliding Door Company
- 2 Waterjet Natural Cutting
- 3 Stratton & Sons Moving & Storage
- 4 Voyant Beauty
- 5 Amazon
- 6 Align Aerospace
- 7 Hubbell Incorporated
- 8 Cicon Engineering Inc
- 9 WeXpnd
- 10 First Class Uniform
- 11 Bank of America

# Floor Plan

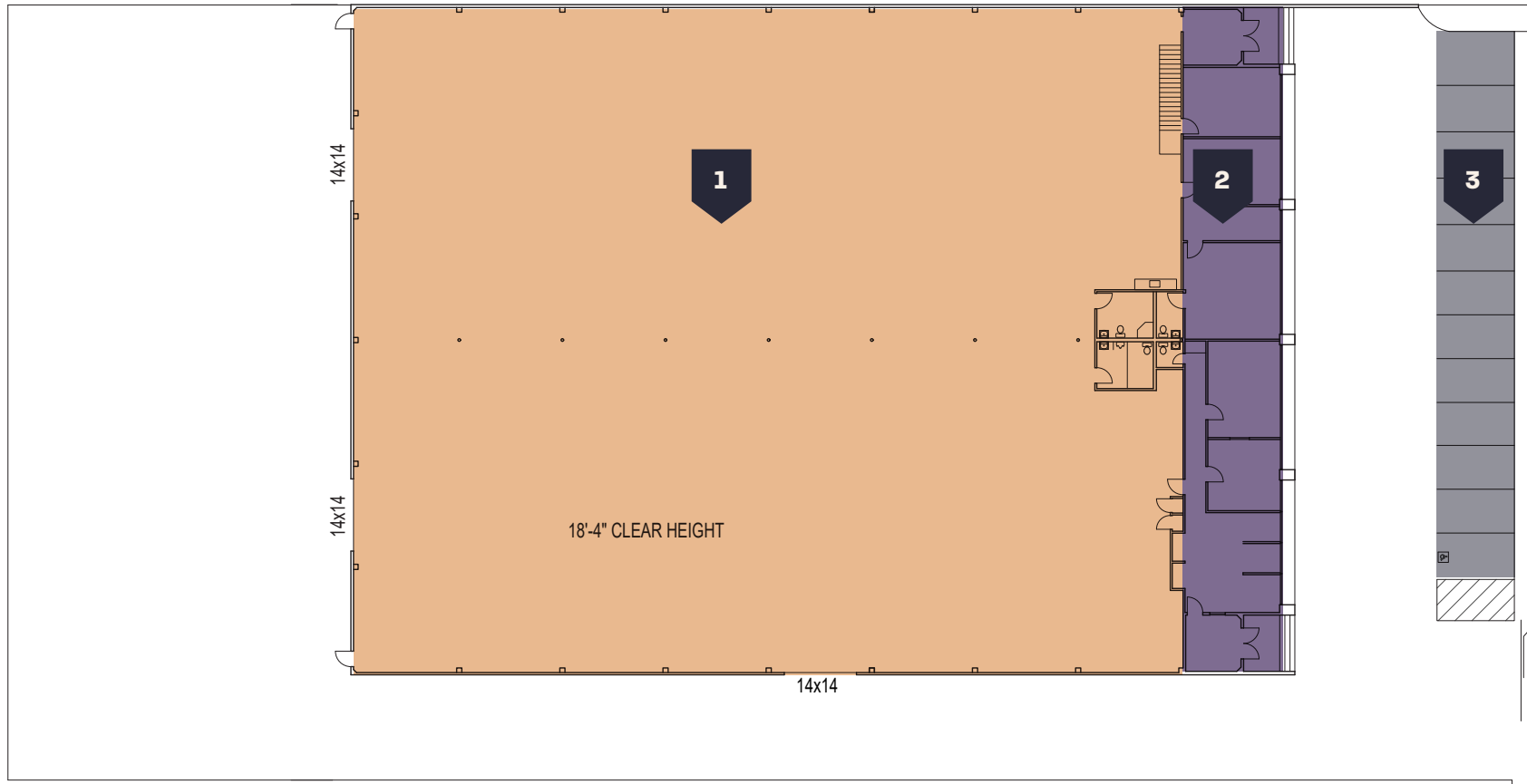

**1**  
Warehouse SF  
20,818 SF

**2**  
Office SF  
2,486 SF

**3**  
Parking  
12 Stalls



# Building Specifications

|              |                                |
|--------------|--------------------------------|
| Lease Rate   | \$1.11/PSF NNN +<br>\$0.19/PSF |
| Available SF | 23,304 SF                      |
| Office SF    | 2,486 SF                       |
| Warehouse SF | 20,818 SF                      |
| Clear Height | 18' 4"                         |
| GL Doors     | 3 - 14' x 14'                  |
| Power        | 800 Amps,<br>120/240 Volts, 3Ø |
| Parking      | 12 Stalls*                     |
| Zoning       | MR2-1                          |
| Built        | 1973                           |
| APN          | 2781-001-017                   |

\*12 parking stalls in front yard. Rear yard not currently striped.

# Property Highlights

---



0.20 GPM/SF  
over 1,500 SF  
Sprinkler System  
Density



800 Amps,  
120/240 Volts, 3Ø  
Power



Fenced  
Yard



18' 4"  
Min. Clear Height

# Demographics

## Transportation Map

### Population

|         |         |           |
|---------|---------|-----------|
| 99,076  | 480,779 | 1,240,322 |
| 2 Miles | 5 Miles | 10 Miles  |

### Avg. HH Income

|           |           |           |
|-----------|-----------|-----------|
| \$114,788 | \$126,683 | \$124,369 |
| 2 Miles   | 5 Miles   | 10 Miles  |

| Airport           | Distance (miles) |
|-------------------|------------------|
| Van Nuys          | ±7 miles         |
| Hollywood/Burbank | ±19 miles        |
| LAX               | ±28.2 miles      |





# Photo Gallery

## Exterior & Warehouse



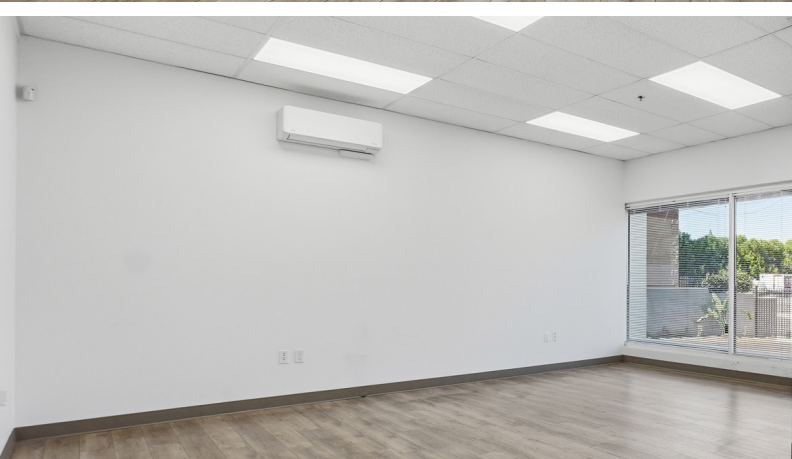

# Photo Gallery

## Offices

# 8929 Oso Ave.

Chatsworth, CA

±23,304 SF Free Standing Industrial Building Available



## CONTACTS

Bennett Robinson  
Vice Chairman  
+1 818 907 4608  
bennett.robinson@cbre.com  
Lic. 00984312

**CBRE**

© 2026 CBRE, Inc. All rights reserved. This information has been obtained from sources believed reliable but has not been verified for accuracy or completeness. CBRE, Inc. makes no guarantee, representation or warranty and accepts no responsibility or liability as to the accuracy, completeness, or reliability of the information contained herein. You should conduct a careful, independent investigation of the property and verify all information. Any reliance on this information is solely at your own risk. CBRE and the CBRE logo are service marks of CBRE, Inc. All other marks displayed on this document are the property of their respective owners, and the use of such marks does not imply any affiliation with or endorsement of CBRE. Photos herein are the property of their respective owners. Use of these images without the express written consent of the owner is prohibited.