

RETAIL COMMERCIAL SHOWROOM FOR LEASE OR SALE

1258 Saviers Road
Oxnard, CA 93033



FREESTANDING • PARKING IN REAR

HIGHLIGHTS

- ▶ 17,500 SF Freestanding Building
- ▶ Fenced Rear Parking/Loading
- ▶ 140 Foot Frontage on Major Street
- ▶ Street Parking Allowed
- ▶ Just South of Oxnard Blvd & Wooley Rd (Hwy 1)
- ▶ Rear Entry/Loading Door Ground Level
- ▶ Available July 1, 2026

DEMOGRAPHICS 2024	1-Mile	3-Miles	5-Miles
Total Population	28,148	193,241	233,904
Employees	10,147	46,044	69,033

Traffic Count: Saviers Rd @ Wolff St: **30,100 CPD**
S. Oxnard Blvd @ E. Wooley Rd: **19,344 CPD**

FOR LEASE

- ▶ \$.90 Per Square Foot Including NNN Flat For Two (2) Years.
- ▶ Later Years Rent Increases By 3% Annually + NNN Of \$.18 PSF
- ▶ Minimum Five (5) Year Lease Term With Approved Credit

FOR SALE

- ▶ \$2,950,000.00 (\$168.57 PSF)
- ▶ Seller Financing With 25% Down And Approved Credit.

REAR PARKING LOT



For further information contact:

BRUCE MILTON
Sr. Associate
O: 805.626.1281
C: 602.881.1166
E: bmilton@lee-re.com
DRE #01945652



LEE & ASSOCIATES
COMMERCIAL REAL ESTATE SERVICES
Lee & Associates®-LA North/Ventura, Inc. • ID #01191898
A Member of the Lee & Associates Group of Companies
2775 N. Ventura Rd., Suite 201, Oxnard, CA 93036
P 805.626.1200 F 805.413.7000 www.LeeVentura.com

All information furnished regarding the property is from sources deemed reliable, but no warranty or representation is made as to the accuracy thereof. This information is submitted subject to errors, omissions, change of price or terms, prior sale or lease, or withdrawal without notice. No liability of any kind is to be imposed on the broker herein.

RETAIL COMMERCIAL SHOWROOM FOR LEASE OR SALE

1258 Saviers Road
Oxnard, CA 93033

SITE PLAN

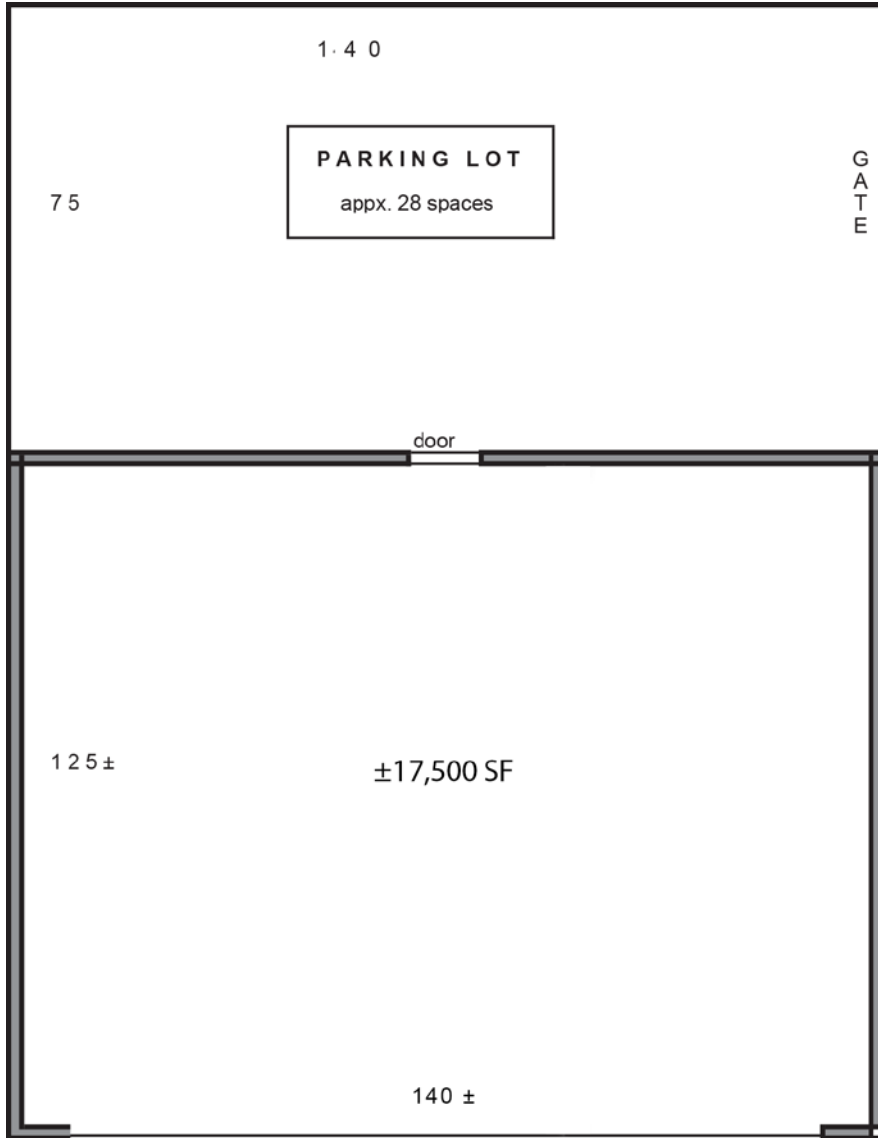

S A V I E R S R O A D



For further information contact:

BRUCE MILTON

Sr. Associate

O: 805.626.1281

C: 602.881.1166

E: bmilton@lee-re.com

DRE #01945652



RETAIL COMMERCIAL SHOWROOM FOR LEASE OR SALE

1258 Saviers Road Oxnard, CA 93033



AREA AMENITIES

For further information contact:

BRUCE MILTON

Sr. Associate

O: 805.626.1281

C: 602.881.1166

E: bmilton@lee-re.com

DRE #01945652

