



# INDUSTRIAL SPACE | FOR LEASE

4601 SW 36TH ST., SUITE 100, OKLAHOMA CITY, OK

**BRETT PRICE, CCIM, SIOR**  
bprice@newmarkrp.com  
C: 405.613.8380

**KARLEY HARPER, CCIM**  
kharper@newmarkrp.com  
C: 405.371.3498

**NEWMARK**  
ROBINSON PARK

# 4601 SW 36TH ST., SUITE 100 / FOR LEASE

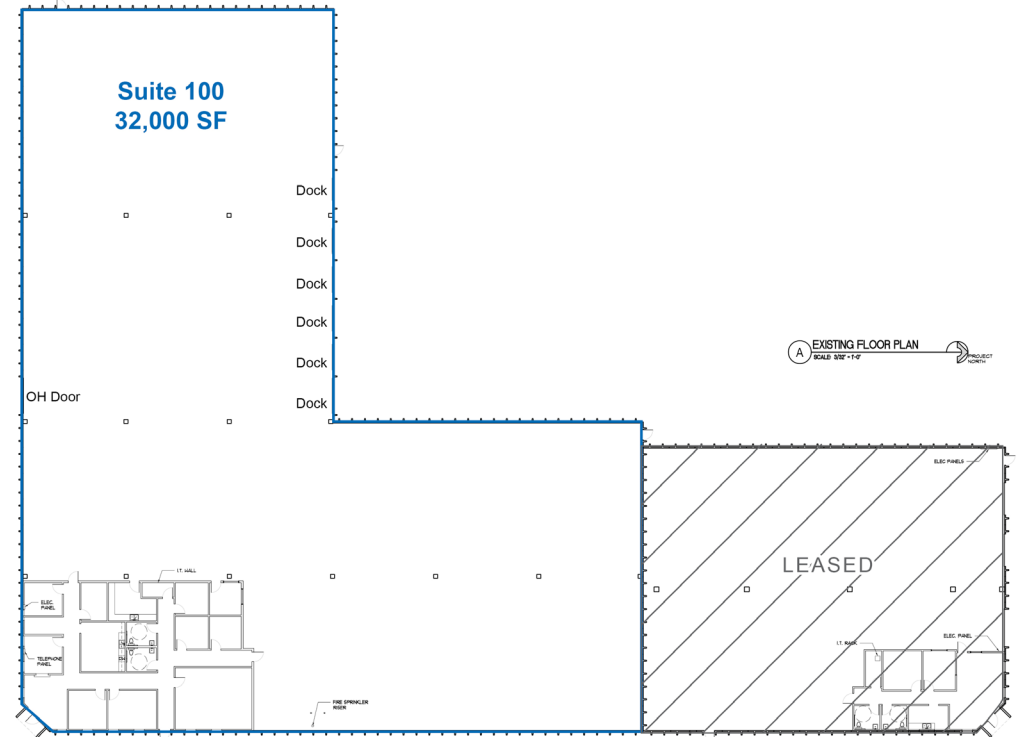

## DETAILS

Available SF	32,000 SF
Lease Rate	\$6.50/SF/YR (NNN)
Building Size	42,000 SF
Lot Size	2.5 Acres
Submarket	Southwest
Cross Streets	SW 36th & S Meridian

## HIGHLIGHTS

6 dock doors   1 grade level door
3,000 SF office space
T5 lighting
Radiant Heat
18' clear height
Available now

## PROPERTY OVERVIEW

Located in OKC's Southwest industrial submarket, the largest and fastest-growing industrial hub in the metro area with excellent connectivity. Located less than 1/2 mile north of I-240 (Airport Rd.), approximately 2 miles from Will Rogers International Airport, 2 miles south of I-40, and less than 2 miles west of I-44, offering immediate access to all key interstate corridors.