



For Sale

2500 Station Rd | Richmond, VA 23234

- Parcel Size: ±2.0 acres
- \$195,000 per acre
- Flexible zoning supports retail on lot per Chesterfield County
- Property is located at the on-ramp for Chippenham Pkwy/I-95
- Excellent ingress/egress with full median break for access

Contact Broker:
Jeff Doxey, CCIM
804.363.0332
jeffdoxey@naidominion.com



NAIDominion



Fast & Friendly

FALLING CREEK IRONWORKS



DEMOGRAPHICS

	<u>3 MILES</u>	<u>5 MILES</u>	<u>10 MILES</u>
2024 Population	40,443	127,587	510,095
2024 Households	14,688	46,884	209,980
Average HH Income	\$66,853	\$71,669	\$82,998



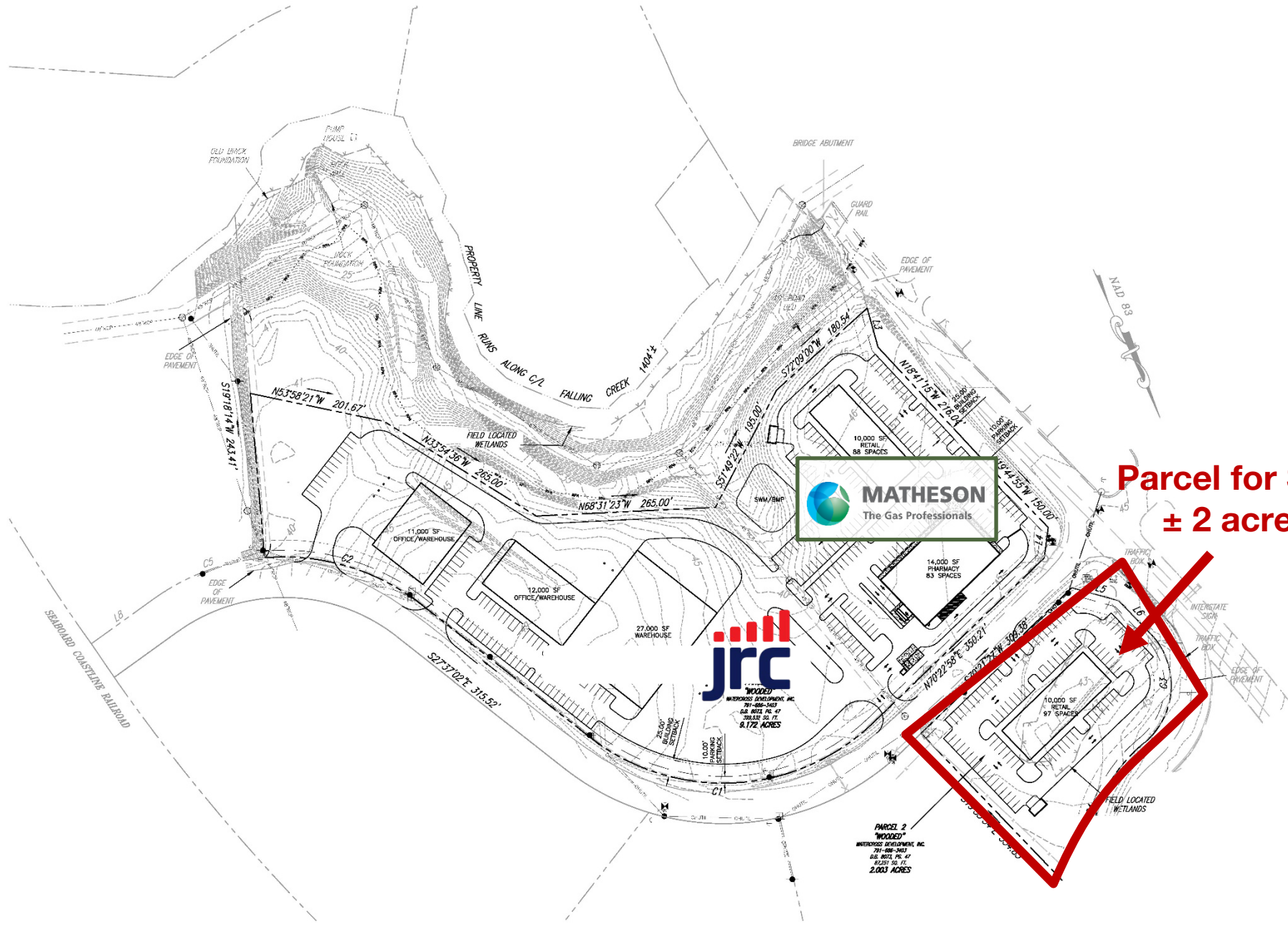

**Parcel for Sale
± 2 acres**

For Sale

2500 Station Rd | Richmond, VA 23234

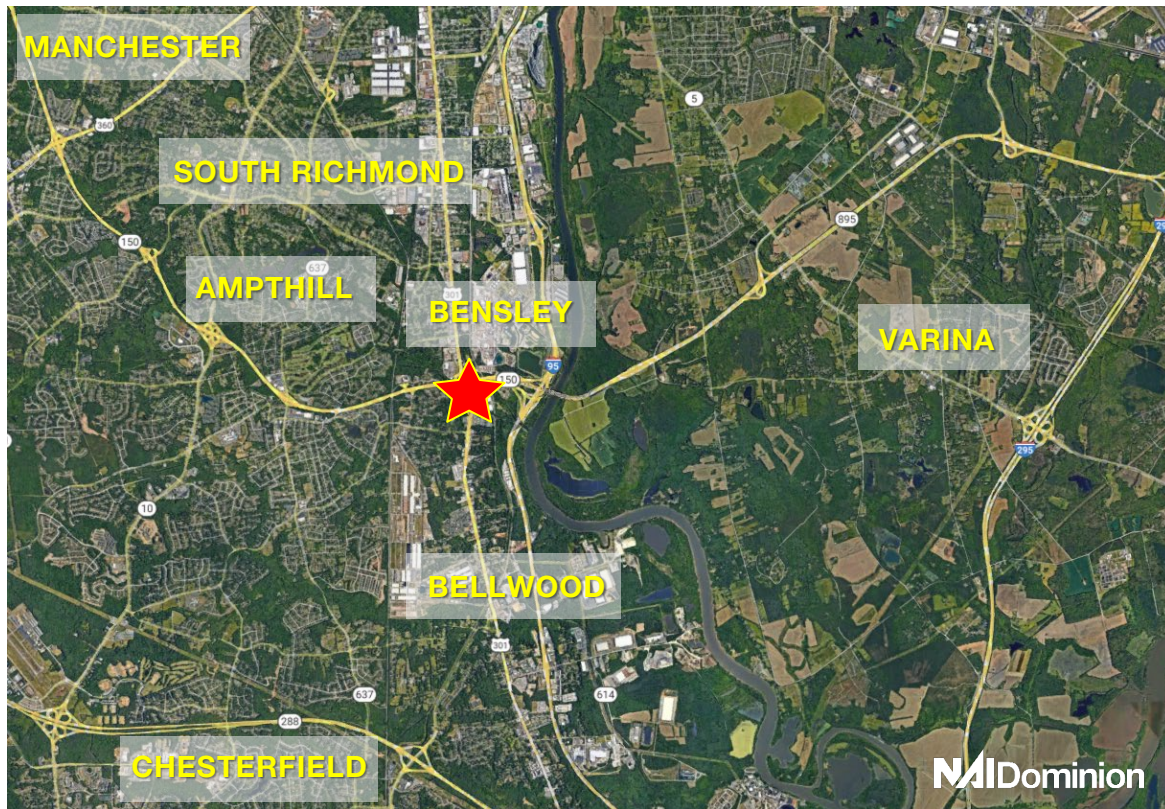

PROPERTY DETAILS

Type:	Land
Parcel Sizes:	± 2.0 Acres
Zoned:	I-2
Price:	Contact Broker for Pricing
Address:	2500 Station Rd, Richmond, VA
Cross Streets:	Station Road + US Route 1
County:	Chesterfield County

PROPERTY HIGHLIGHTS

- \$195,000 per acre
- Flexible zoning supports retail on lot per Chesterfield County
- Property is located at the on-ramp for Chippenham Pkwy/I-95
- Excellent ingress/egress with full median break for access

Contact Broker:

Jeff Doxey, CCIM

804.363.0332

jeffdoxey@naidominion.com

NO WARRANTY OR REPRESENTATION, EXPRESS OR IMPLIED, IS MADE AS TO THE ACCURACY OF THE INFORMATION CONTAINED HEREIN, AND THE SAME IS SUBMITTED SUBJECT TO ERRORS, OMISSIONS, CHANGE OF PRICE, RENTAL OR OTHER CONDITIONS, PRIOR SALE, LEASE OR FINANCING, OR WITHDRAWAL WITHOUT NOTICE, AND OF ANY SPECIAL LISTING CONDITIONS IMPOSED BY OUR PRINCIPALS NO WARRANTIES OR REPRESENTATIONS ARE MADE AS TO THE CONDITION OF THE PROPERTY OR ANY HAZARDS CONTAINED THEREIN ARE ANY TO BE IMPLIED. REV 4-8-20