

11924 W WASHINGTON BLVD
CULVER CITY, CA 90066

RETAIL FOR LEASE



CBRE

Greg Briest | Marisa Renfro | Houman Mahboubi



WELCOME TO CULVER CITY

11924 W Washington Blvd is located within one of the most sought-after retail corridors in Los Angeles, in the heart of Culver City. The area features a vibrant mix of upscale boutiques, art galleries, award-winning restaurants, and a dynamic nightlife scene that draws consistent foot traffic.

Culver City is also a major hub for tech and media, home to industry leaders such as Sony Pictures, Amazon Studios, Culver Studios, and Beats Electronics. This strong employment base, combined with the area's energy and demographics, makes the location a premier destination for both businesses and consumers

41,860 1 MILE	282,139 3 MILES	685,017 5 MILES
DAYTIME POPULATION		
\$84,913 1 MILE	\$113,122 3 MILES	\$112,818 5 MILES
AVG HOUSEHOLD INCOME		
\$1.268M 1 MILE	\$1.402M 3 MILES	\$1.344M 5 MILES
MEDIAN HOME VALUE		
\$1.9B 1 MILE	\$18.4B 3 MILES	\$40B 5 MILES
CONSUMER SPENDING		

W WASHINGTON BLVD

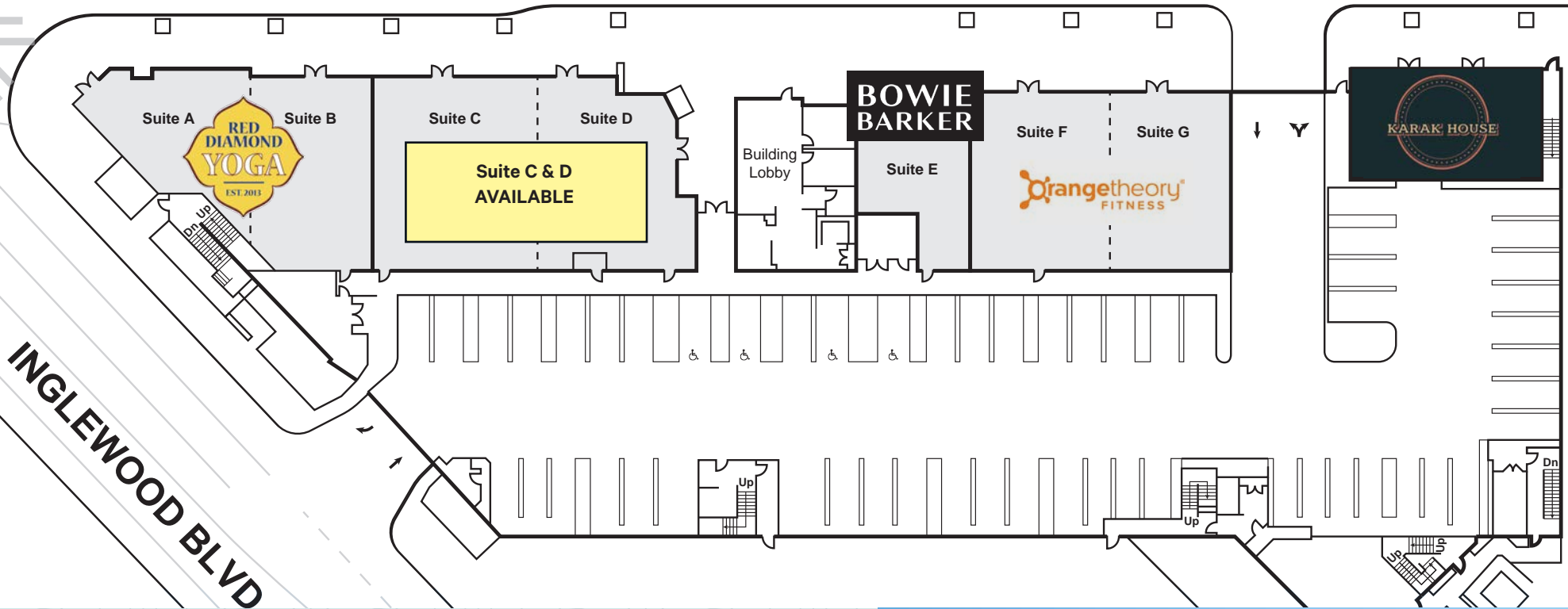

PROPERTY FEATURES



SUITE C & D
±4,198 SF



RENT
PRICE UPON REQUEST



AVAILABILITY
IMMEDIATE



PARKING
ON SITE SURFACE LEVEL GARAGE
AND NEARBY METER PARKING



INTERIOR









INTERIORS



EXTERIOR



NEARBY TENANTS

Fat+Flour



LODGE BREAD

MADE IN L.A.	USA	EST. 2015
LODGE BREAD.COM		



Menotti's
COFFEE STOP



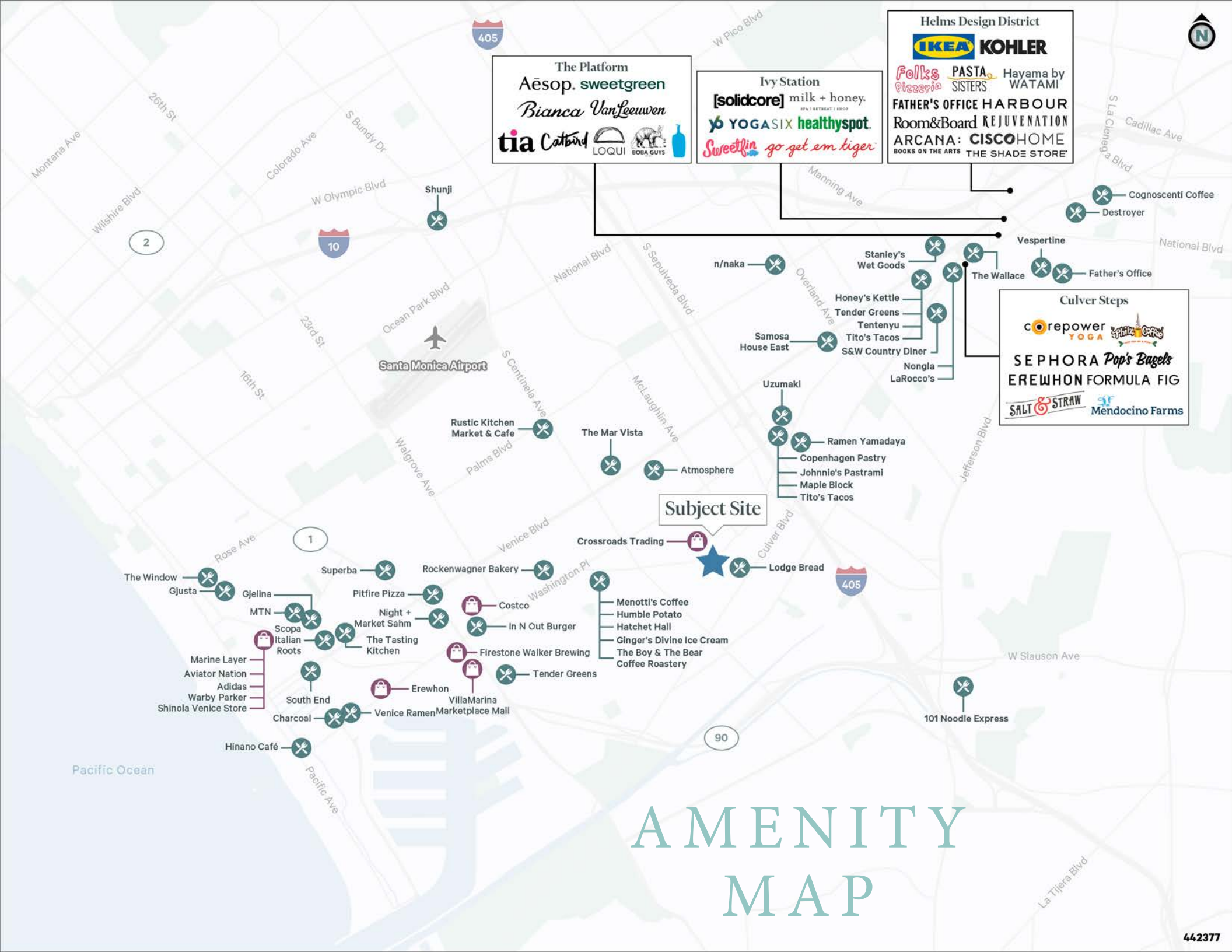

The Platform
 Aēsop. sweetgreen
 Bianca VanLeeuwen
 tia Catbird LOQUI BOBA GUYS

Ivy Station
 [solidcore] milk + honey.
 YOGASIX healthspot.
 Sweetfin go get em tiger

Helms Design District
 IKEA KOHLER
 Folks Pizzeria PASTA SISTERS Hayama by WATAMI
 FATHER'S OFFICE HARBOUR
 Room&Board REJUVENATION
 ARCANA: CISCOHOME
 BOOKS ON THE ARTS THE SHADE STORE

Culver Steps
 corepower YOGA
 SEPHORA Pop's Bagels
 EREWHON FORMULA FIG
 SALT & STRAW Mendocino Farms

Subject Site

AMENITY MAP

11924 W WASHINGTON BLVD
CULVER CITY, CA 90066

RETAIL FOR LEASE



CBRE

Greg Briest

First Vice President
Lic.#01949565
+1 310 550 2653
greg.briest@cbre.com

Houman Mahboubi

Senior Vice President
Lic #01450237
+1 310 550 2651
houman.mahboubi@cbre.com

Marisa Renfro

Vice President
Lic #02178774
+1 310 550 2651
marisa.renfro@cbre.com

© 2026 CBRE, Inc. All rights reserved. This information has been obtained from sources believed reliable, but has not been verified for accuracy or completeness. You should conduct a careful, independent investigation of the property and verify all information. Any reliance on this information is solely at your own risk. CBRE and the CBRE logo are service marks of CBRE, Inc. All other marks displayed on this document are the property of their respective owners. Photos herein are the property of their respective owners and use of these images without the express written consent of the owner is prohibited.