



FOR LEASE

36177 Mound Rd

Sterling Heights, MI



Property Highlights

- 6,036 square feet
- Main road exposure with signage rights
- Parking for 25+ vehicles
- Several private offices with open floor plan as well
- Motivated Landlord

For information, please contact:

Chris Dowell

Senior Managing Director
t 248-447-2717
chris.dowell@nmrk.com

Jack Coury

Senior Managing Director
t 248-372-2276
jack.coury@nmrk.com

27725 Stansbury Blvd., Suite 300
Farmington Hills, MI 48334



nmrk.com



Licensed in Michigan as Newmark Real Estate
The information contained herein has been obtained from sources deemed reliable but has not been verified and no guarantee, warranty or representation, either express or implied, is made with respect to such information. Terms of sale or lease and availability are subject to change or withdrawal without notice.

INDUSTRIAL – Lease

36177 Mound Road
Sterling Heights, MI



Total Building Size:	23,557
Total Available:	6,036
Age:	2003
Factory:	
Office:	6,036
Minimum Divisible:	6,036
Zoned:	C-3
Lease Rate:	\$8.45/sf NNN
Monthly Lease Rate:	\$4,250
Taxes:	\$1.43/sf

Property Details

Acreage:		Power:	
Frontage:		Buss:	
Depth:		Lights:	Fluorescent
Parking:	25+	Truckwell:	
Expandable:		Grade Door:	Possible
Storage:		Heating:	Roof top
Clearance:		A/C:	100%
Bay Size:		Sprinklered:	Yes
Lavatories:	2	Airlines:	
Crane:		Compressor:	
Underhook:		Floordrains:	

Additional Information:

Main road (Mound) exposure. Immediate occupancy. Convenient parking at front door for employees and guests. Signage available. Several private offices with open floor plan as well. Attached floor plan is not exact.

Contact Information:

Chris Dowell

248.447.2717

chris.dowell@nmrk.com

Jack Coury

248.372.2276

jack.coury@nmrk.com

NEWMARK

The information contained herein has been obtained from sources deemed reliable but has not been verified and no guarantee, warranty or representation, either express or implied, is made with respect to such information. Terms of sale or lease and availability are subject to change or withdrawal without notice.

36177 Mound Road

Sterling Heights, Michigan

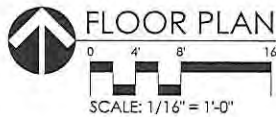
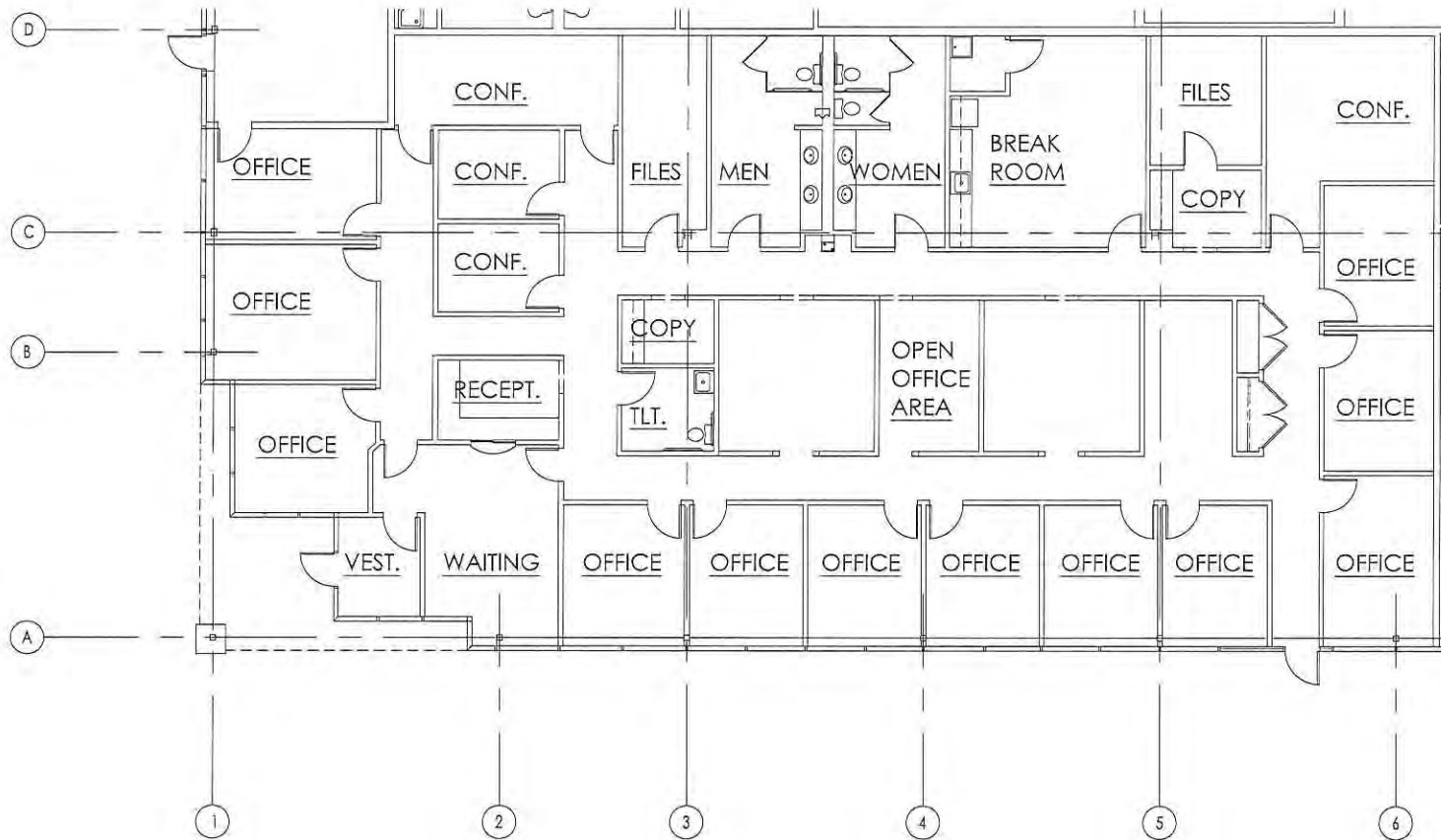

Sterling Properties, MI

6939 Nineteen Mile Road
Sterling Heights, MI 48314
(586) 726-2000

September 7, 2015

SQUIRES
ARCHITECTURAL
GROUP, PLLC

223 West Grand River Ave.
Suite 2
Howell, MI 48843
517-518-8843 voice
517-518-8956 facsimile

Mound Road Office Building

Sterling Heights, Michigan

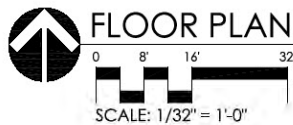
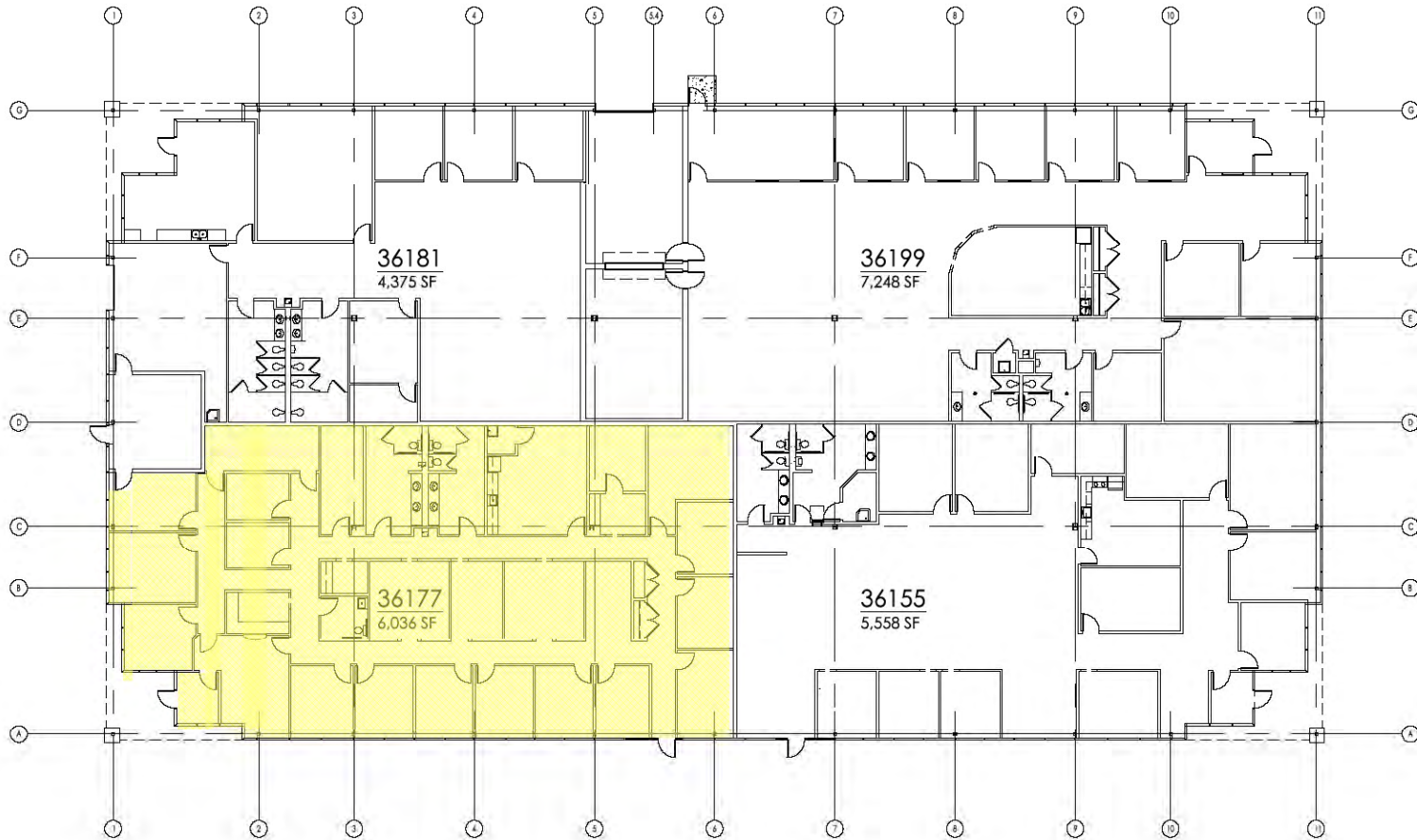

Sterling Properties, MI

6939 Nineteen Mile Road
Sterling Heights, MI 48314
(586) 726-2000

September 13, 2015

SQUIRES
ARCHITECTURAL
GROUP, PLLC

223 West Grand River Ave.
Suite 2
Howell, MI 48843
517-518-8843 voice
517-518-8956 facsimile

