

HIGH PARK VILLAGE - OFFICE FINISHOUT

2596 EAST ARKANSAS LANE, ARLINGTON, TEXAS 76014

PRELIMINARY
Approval pending
at construction

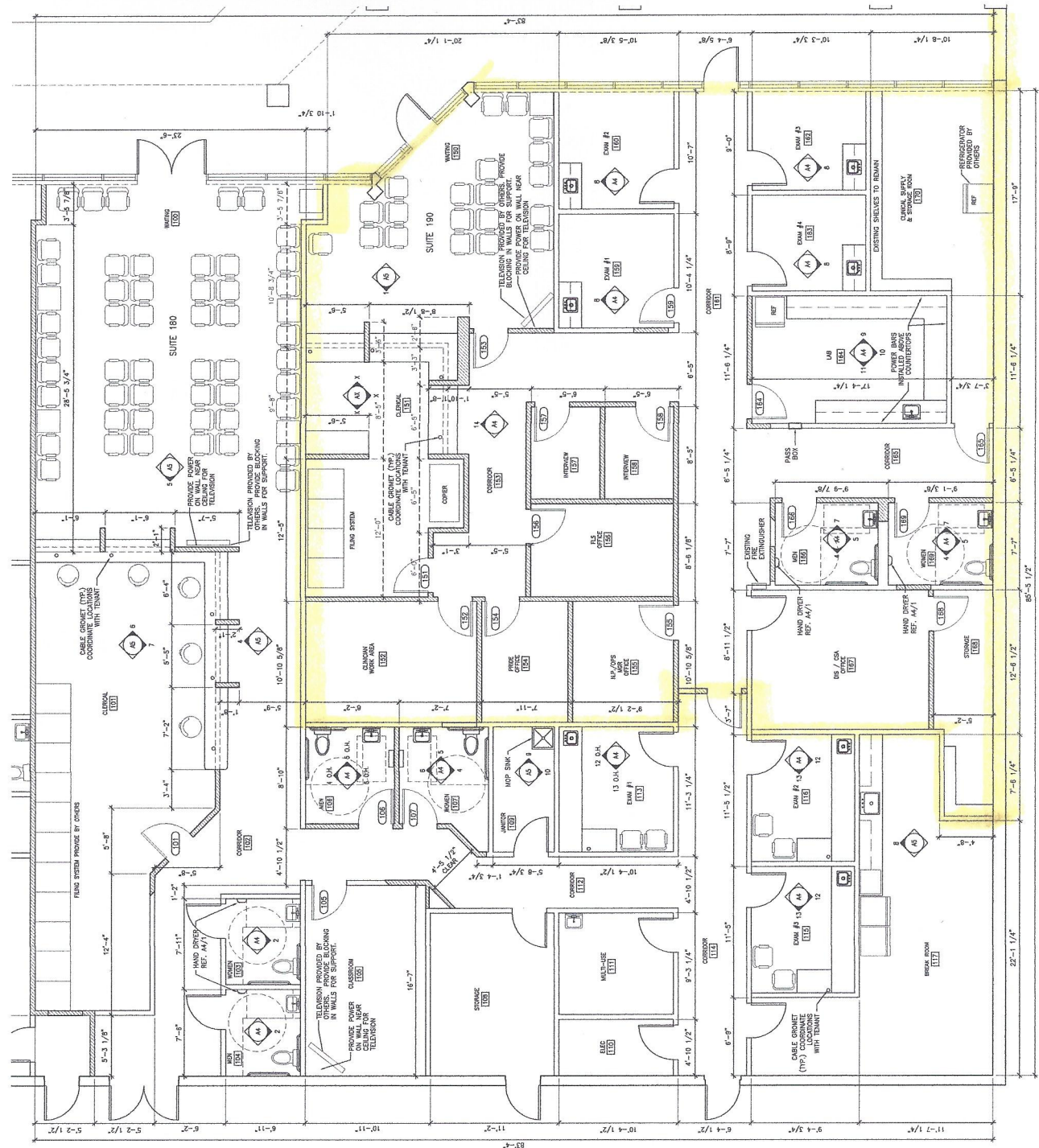

KEY LEGEND

	EXISTING PARTITION TO REMAIN
	NEW PARTITION, SEE PARTITION TYPES
	DOOR NUMBER
	PARTITION TYPE
	WINDOW ELEVATION, P.L.C.
	REFER EXTERIOR ELEVATION
	WINDOW NUMBER TO WINDOW SCHEDULE
	WINDOW NUMBER TO WINDOW SCHEDULE
	SECTION, WINDOW NUMBER IS SPECIFIC DRAWING
	BOTTOM NUMBER IS SHEET
	NEW DUPLEX ELECTRICAL OUTLET

PARTITION TYPES:

GENERAL PARTITION NOTES:

1. ALL OPTION BOARD TO BE 5/8" FIRE-RESISTANT TYPE "X" GAO.
2. STUDS TO BE 1 1/2" STUDS PERIOD IN PLACE TO BE APPLIED. REFER TO FINISH SCHEDULE, UNLESS OTHERWISE NOTED.
3. ALL PARTITION WALLS ARE TO BE TYPE "X" MILLWORK INSULATION.
4. INCLUDE BLOCKING IN WALLS AS REQUIRED FOR MILLWORK INSULATION.

ONE LAYER DRY WALL EACH SIDE OF 5/8" STUDS @ 16" O.C. w/ SOUND BATT INSULATION. EXTEND TO EXISTING CEILING.

GENERAL NOTES:

1. FINISH SCHEDULE AND DIMENSIONS SHALL BE TO CONSTRUCTION.
2. ALL DIMENSIONS SHOWN ARE TO FACE UNLESS OTHERWISE NOTED.
3. ALL DIMENSIONS AND SPACES OF TENANT SPACES PREVIOUSLY PROVIDED IN THIS SPACE.
4. ALL DIMENSIONS AND SPACES OF ANY MANUFACTURER OR SUPPLIER SHALL BE IN ACCORDANCE WITH THE MANUFACTURER'S OR SUPPLIER'S SPECIFICATIONS WITH FINISHES IN RELATION TO EXISTING FIELD CONDITIONS.
5. ALL DIMENSIONS AND SPACES SHALL BE TO FACE UNLESS OTHERWISE NOTED.
6. ALL DIMENSIONS AND SPACES SHALL BE TO FACE UNLESS OTHERWISE NOTED.
7. ALL DIMENSIONS AND SPACES SHALL BE TO FACE UNLESS OTHERWISE NOTED.
8. ALL DIMENSIONS AND SPACES SHALL BE TO FACE UNLESS OTHERWISE NOTED.
9. ALL DIMENSIONS AND SPACES SHALL BE TO FACE UNLESS OTHERWISE NOTED.
10. ALL DIMENSIONS AND SPACES SHALL BE TO FACE UNLESS OTHERWISE NOTED.
11. ALL DIMENSIONS AND SPACES SHALL BE TO FACE UNLESS OTHERWISE NOTED.
12. ALL DIMENSIONS AND SPACES SHALL BE TO FACE UNLESS OTHERWISE NOTED.
13. ALL DIMENSIONS AND SPACES SHALL BE TO FACE UNLESS OTHERWISE NOTED.
14. ALL DIMENSIONS AND SPACES SHALL BE TO FACE UNLESS OTHERWISE NOTED.
15. ALL DIMENSIONS AND SPACES SHALL BE TO FACE UNLESS OTHERWISE NOTED.
16. ALL DIMENSIONS AND SPACES SHALL BE TO FACE UNLESS OTHERWISE NOTED.
17. ALL DIMENSIONS AND SPACES SHALL BE TO FACE UNLESS OTHERWISE NOTED.
18. ALL DIMENSIONS AND SPACES SHALL BE TO FACE UNLESS OTHERWISE NOTED.
19. ALL DIMENSIONS AND SPACES SHALL BE TO FACE UNLESS OTHERWISE NOTED.
20. ALL DIMENSIONS AND SPACES SHALL BE TO FACE UNLESS OTHERWISE NOTED.