

# 17 NORTH

C O R P O R A T E   C E N T E R

I-17 & PINNACLE PEAK ROAD | PHOENIX, AZ

## BLDG D

2525 WEST CORPORATE  
CENTER DRIVE

<b>BUILDING SIZE</b>	±84,222 GSF
<b>POWER</b>	277/480v 3000-amp service
<b>COLUMN SPACING</b>	52' x 50'
<b>ROOF TYPE</b>	60 mil TPO
<b>DIVISIBILITY</b>	±15,600 SF
<b>DOCK HIGH DOOR</b>	Fifteen (15) 9'- 0" x 10'- 0" manually operated
<b>SPEED BAY</b>	60'

<b>WAREHOUSE AC</b>	84-degree setpoint
<b>OFFICE</b>	±3,650 SF spec suite
<b>GRADE LEVEL DOORS</b>	Three (3) 20'- 0" x 20' - 0" and one (1) 14'- 0" x 16'- 0"
<b>SPRINKLERS</b>	ESFR K-25 Heads
<b>LIGHTING</b>	30 FC
<b>TRUCK COURT DEPTH</b>	130'
<b>AUTO PARKING</b>	106 stalls

<b>CLEAR HEIGHTS</b>	32'-0" Clear
<b>BUILDING DIMENSIONS</b>	161.5' x 521.5'
<b>SLAB</b>	7' thick, 4000 psi reinforced concrete
<b>ZONING</b>	CP/GCP

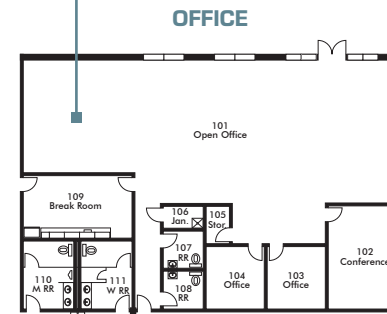
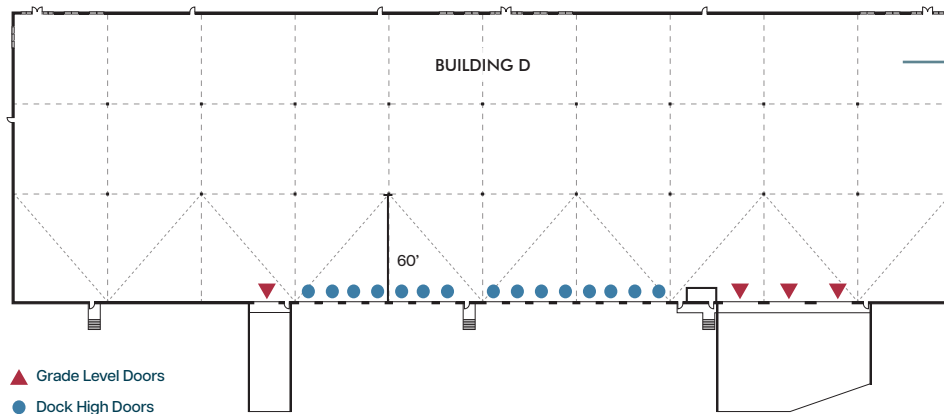

PRIMARY CONTACT

**COOPER FRATT, SIOR**  
+1 602 684 8770  
cooper.fratt@cbre.com

SECONDARY CONTACT

**TANNER FERRANDI**  
+1 602 625 1995  
tanner.ferrandi@cbre.com

TEAM MEMBERS

**JOHN WERSTLER, SIOR**  
+1 602 622 5504  
john.werstler@cbre.com

**CONNIE NELSON**  
+1 520 444 9732  
connie.nelson@cbre.com



A Development By:

