



CAMP NORTH END

MAKE
YOUR
MARK
AT CAMP
NORTH
END

201 CAMP ROAD



HISTORY IS MADE HERE.

**CAMP NORTH END IS A DIVERSE COMMUNITY
OF CREATORS AND INNOVATORS.**



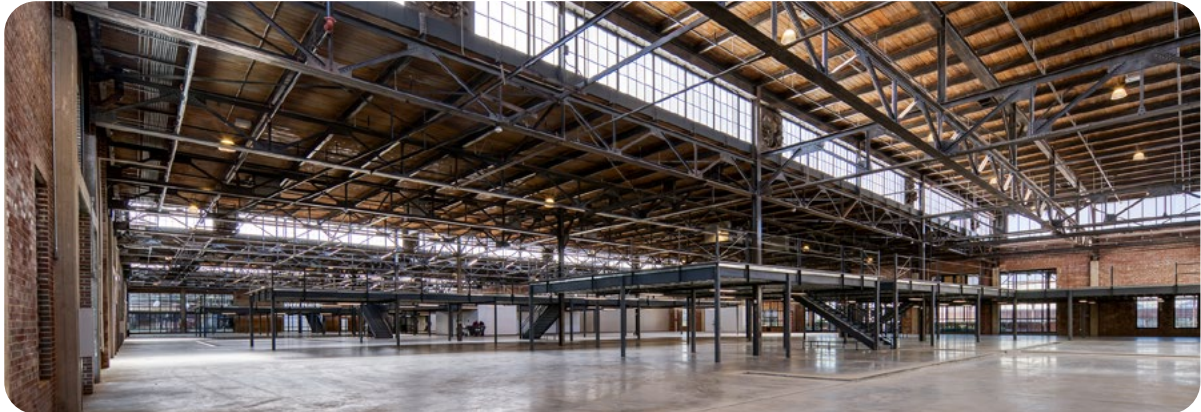
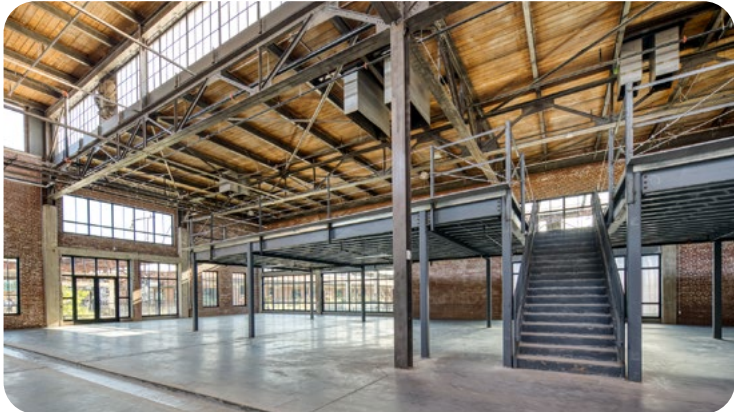
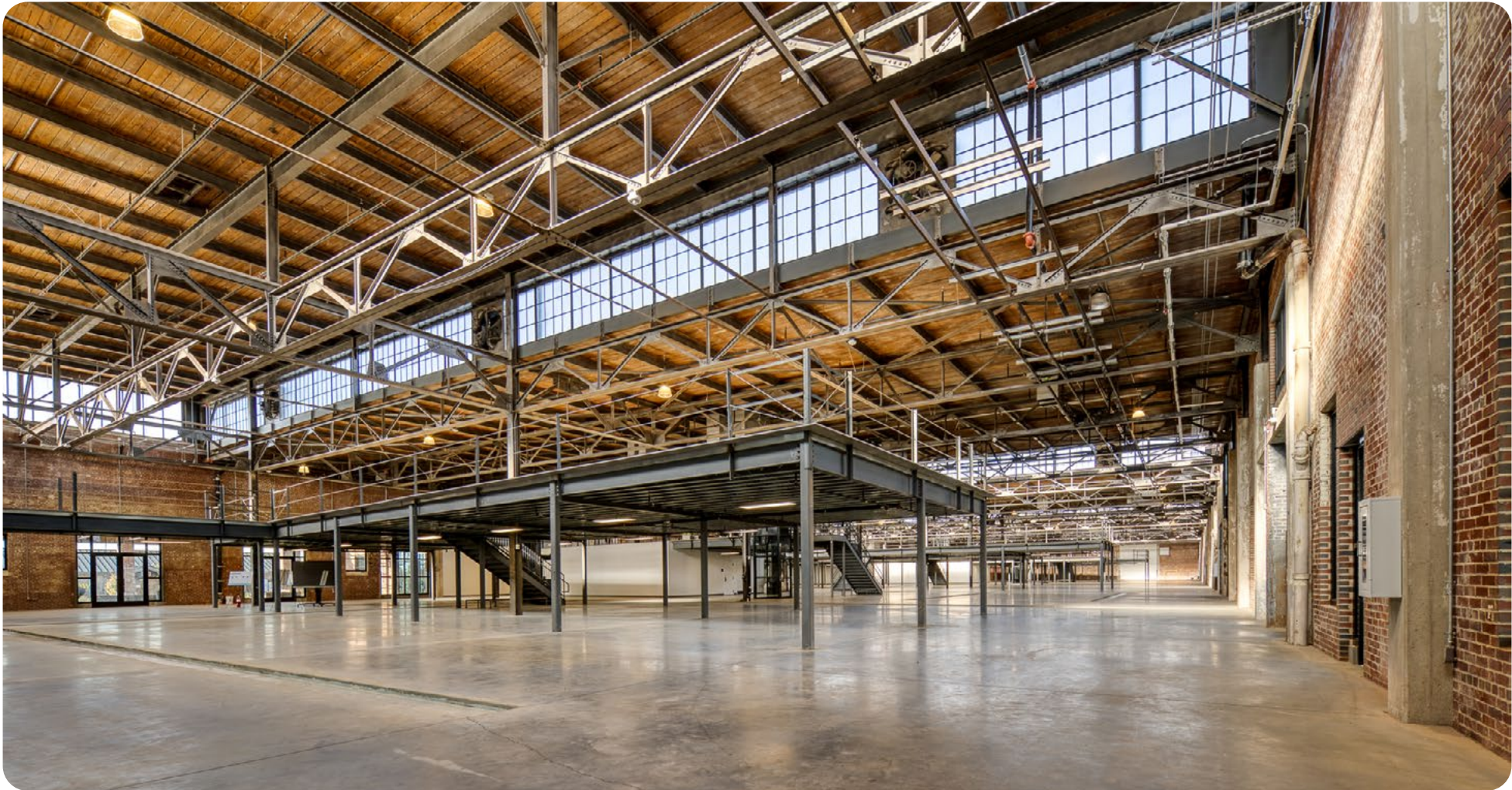

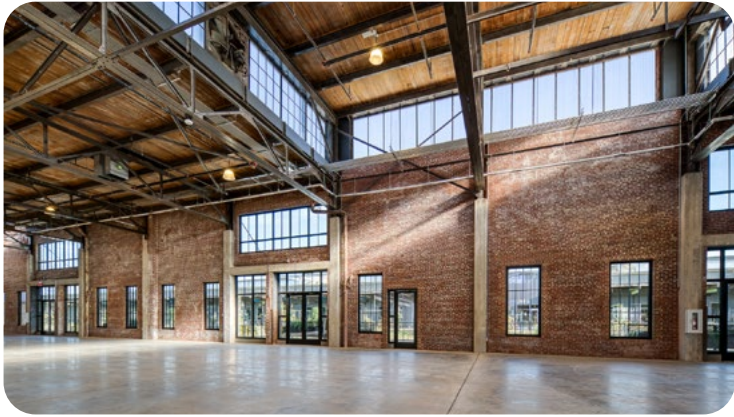

AS-BUILT

SUITE 100 | 201 CAMP ROAD

TOTAL: 113,860 RSF

LEVEL 1: 85,642 RSF | MEZZANINE: 28,218 RSF

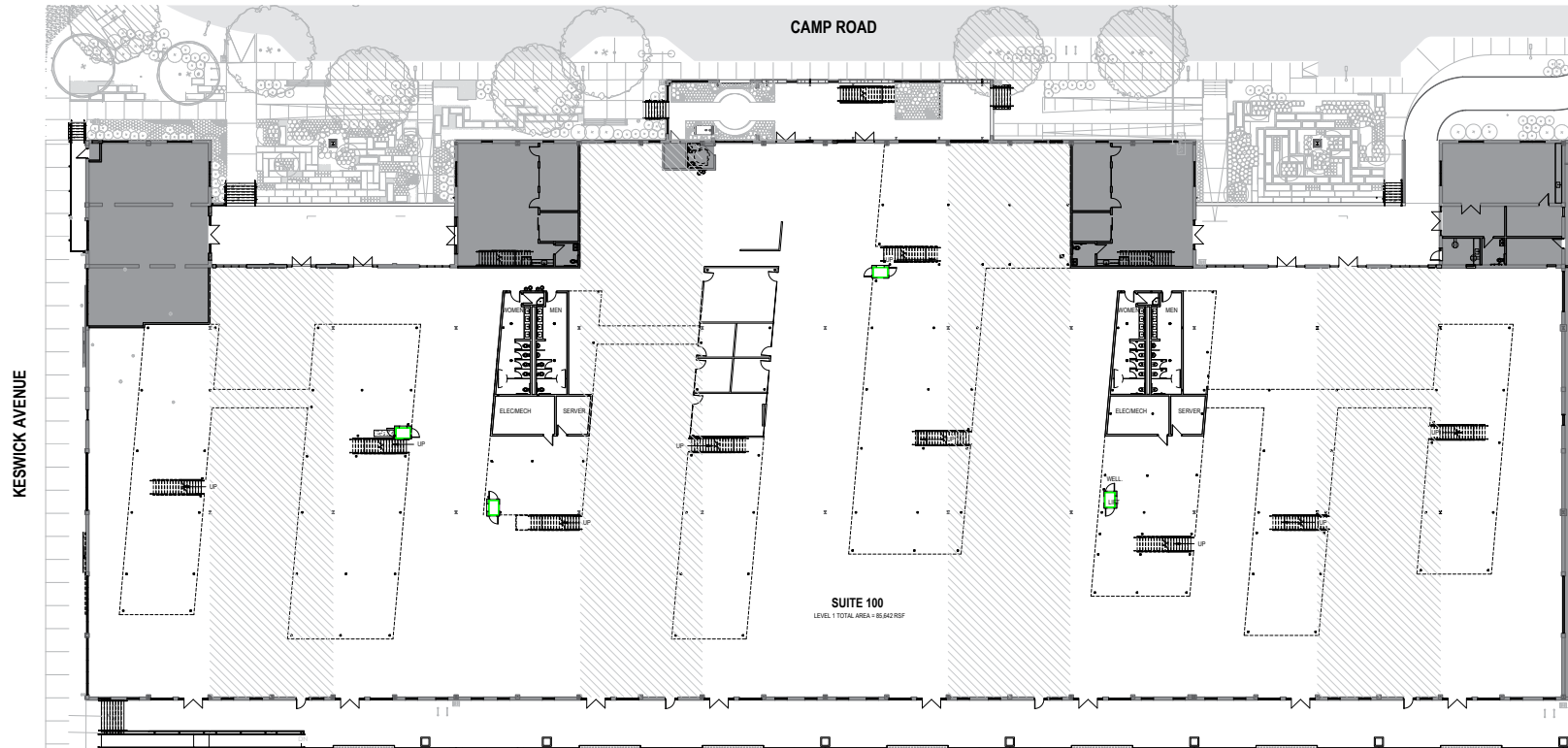
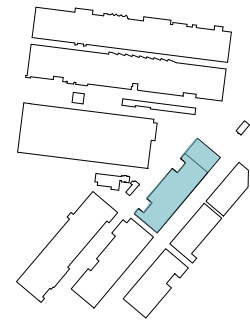

[CLICK FOR MATTERPORT TOUR](#)

AS-BUILT

SUITE 100 | 201 CAMP ROAD

TOTAL: 113,860 RSF

LEVEL 1: 85,642 RSF | MEZZANINE: 28,218 RSF

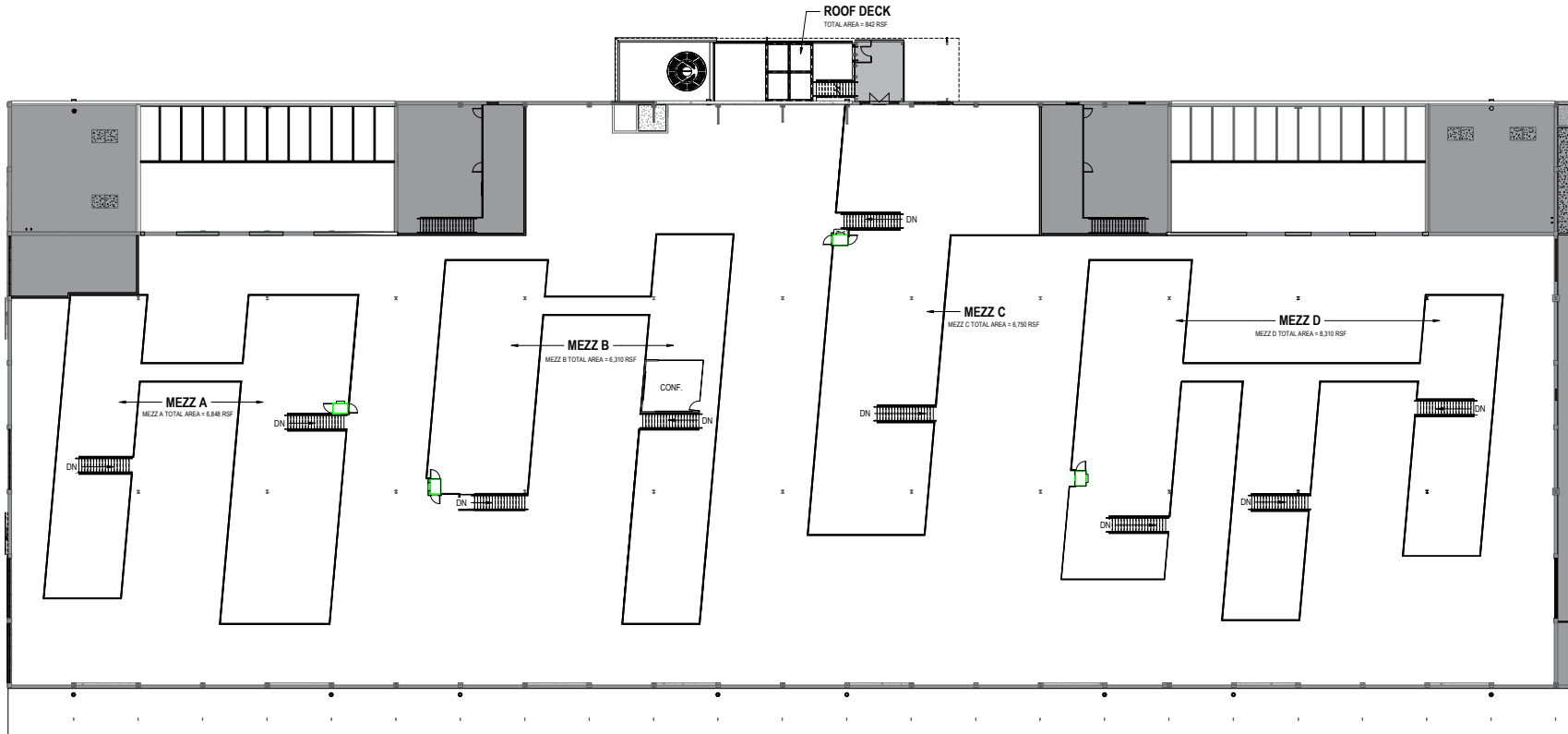
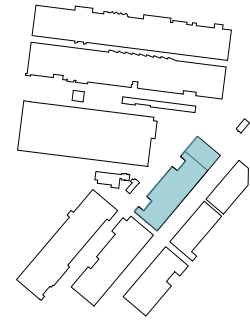

SINGLE-TENANT TEST FIT

SUITE 100 | 201 CAMP ROAD

TOTAL: 113,860 RSF

LEVEL 1: 85,642 RSF | MEZZANINE: 28,218 RSF

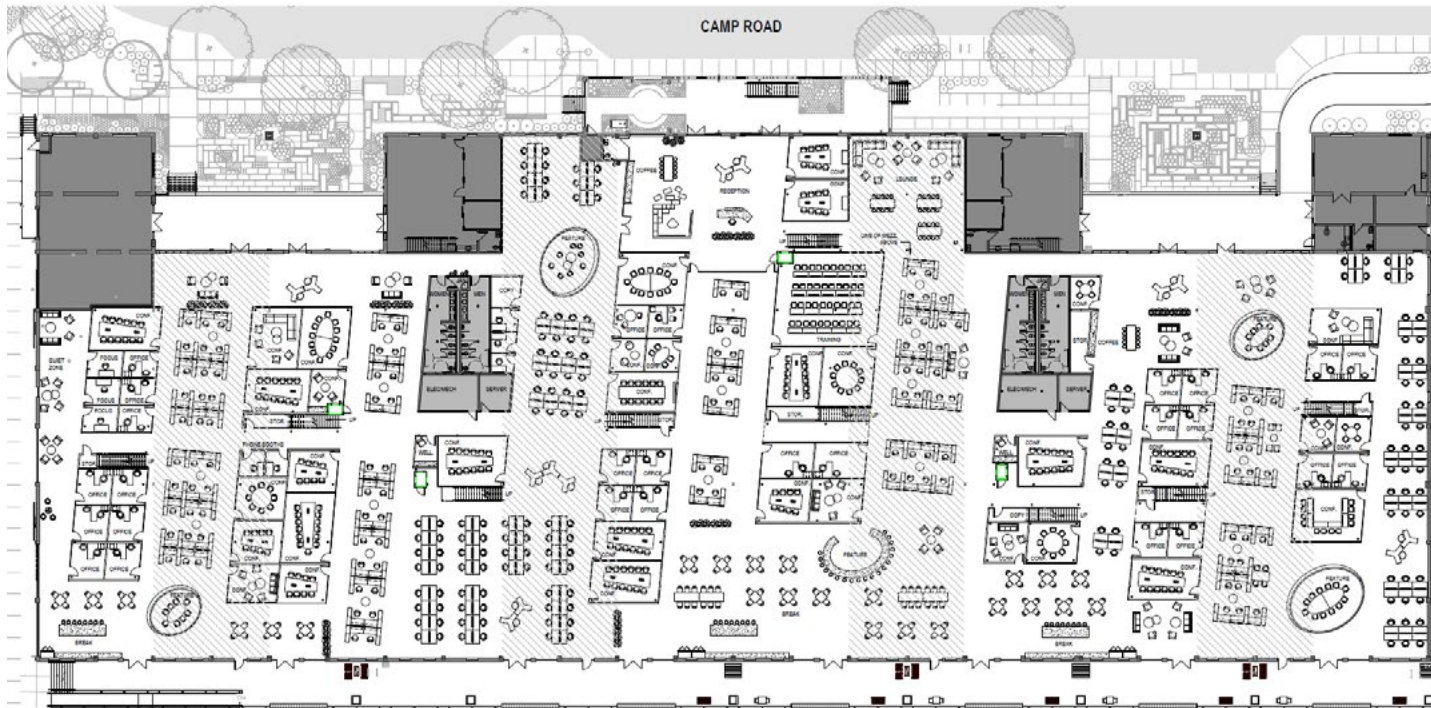
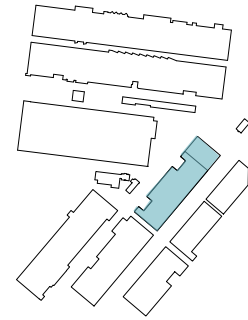

Total Area: 113,860 RSF Mezzanine Area: 28,218 RSF							
521 OCC = 1: 219 SF of 4.6: 1,000 RSF				65 Mtg Areas = 1: 8 OCC			
Room Type	Level 1 (85,642 RSF)	Mezzanine (28,218 RSF)	Total (113,860 RSF)	Room Type	Level 1 (85,642 RSF)	Mezzanine (28,218 RSF)	Total (113,860 RSF)
Office	27	0	27	Training	01	0	01
Workstation	258	200	458	Conferenc	82	11	48
Reception	01	0	01	Muddle	15	05	20
Total			571	Total			68

SUITE 100 DEMISING PLAN

SUITE 100 | 201 CAMP ROAD

TOTAL: 113,860 RSF

LEVEL 1: 85,642 RSF | MEZZANINE: 28,218 RSF

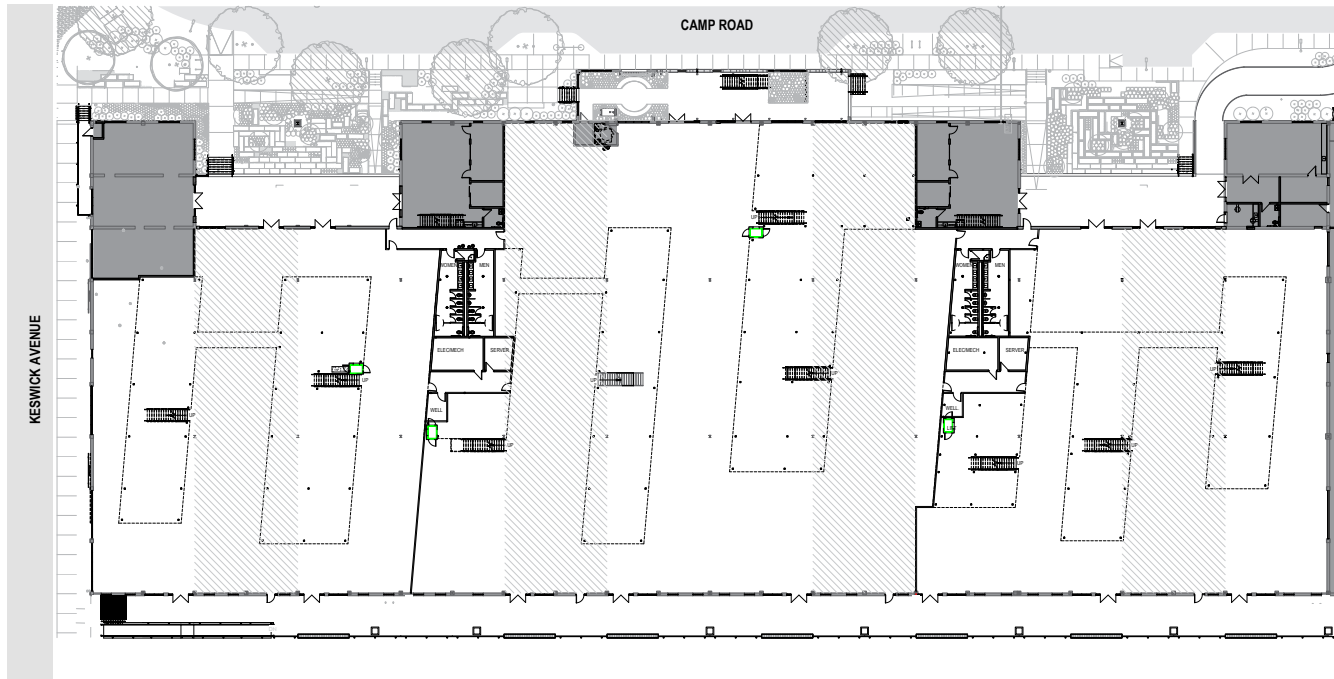
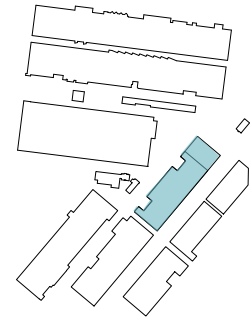

Tenant A

Total: 27,000 RSF

Level 1: 20,152 RSF | Mezzanine: 6,848 RSF

117 OCC = 1:231 SF or 4.3:1,000 RSF				18 Mtg Areas = 1:7 OCC			
Room Type	Level 1 (20,152 RSF)	Mezzanine (6,848 RSF)	Total (27,000 RSF)	Room Type	Level 1 (20,152 RSF)	Mezzanine (6,848 RSF)	Total (27,000 RSF)
Office	08	00	08	Training	00	00	01
Workstation	50	58	108	Conference	09	02	11
Reception	01	00	01	Huddle	05	01	06
Total			117	Total			18

Tenant B

Total: 51,280 RSF

Level 1: 38,220 RSF | Mezzanine: 13,060 RSF

210 OCC = 1:244 SF or 4.1:1,000 RSF				25 Mtg Areas = 1:9 OCC			
Room Type	Level 1 (38,220 RSF)	Mezzanine (13,060 RSF)	Total (51,280 RSF)	Room Type	Level 1 (38,220 RSF)	Mezzanine (13,060 RSF)	Total (51,280 RSF)
Office	08	0	08	Training	01	0	01
Workstation	121	80	201	Conference	132	06	138
Reception	01	0	01	Huddle	03	03	06
Total			210	Total			25

Tenant C

Total: 31,084 RSF

Level 1: 22,774 RSF | Mezzanine: 8,310 RSF

153 OCC = 1:203 SF or 4.9:1,000 RSF				21 Mtg Areas = 1:8 OCC			
Room Type	Level 1 (22,774 RSF)	Mezzanine (8,310 RSF)	Total (31,084 RSF)	Room Type	Level 1 (22,774 RSF)	Mezzanine (8,310 RSF)	Total (31,084 RSF)
Office	10	0	10	Training	0	0	0
Workstation	80	62	142	Conference	10	03	13
Reception	01	0	01	Huddle	07	01	08
Total			153	Total			21

SUITE 100 DEMISING PLAN

SUITE 100 | 201 CAMP ROAD

TOTAL: 113,860 RSF

LEVEL 1: 85,642 RSF | MEZZANINE: 28,218 RSF

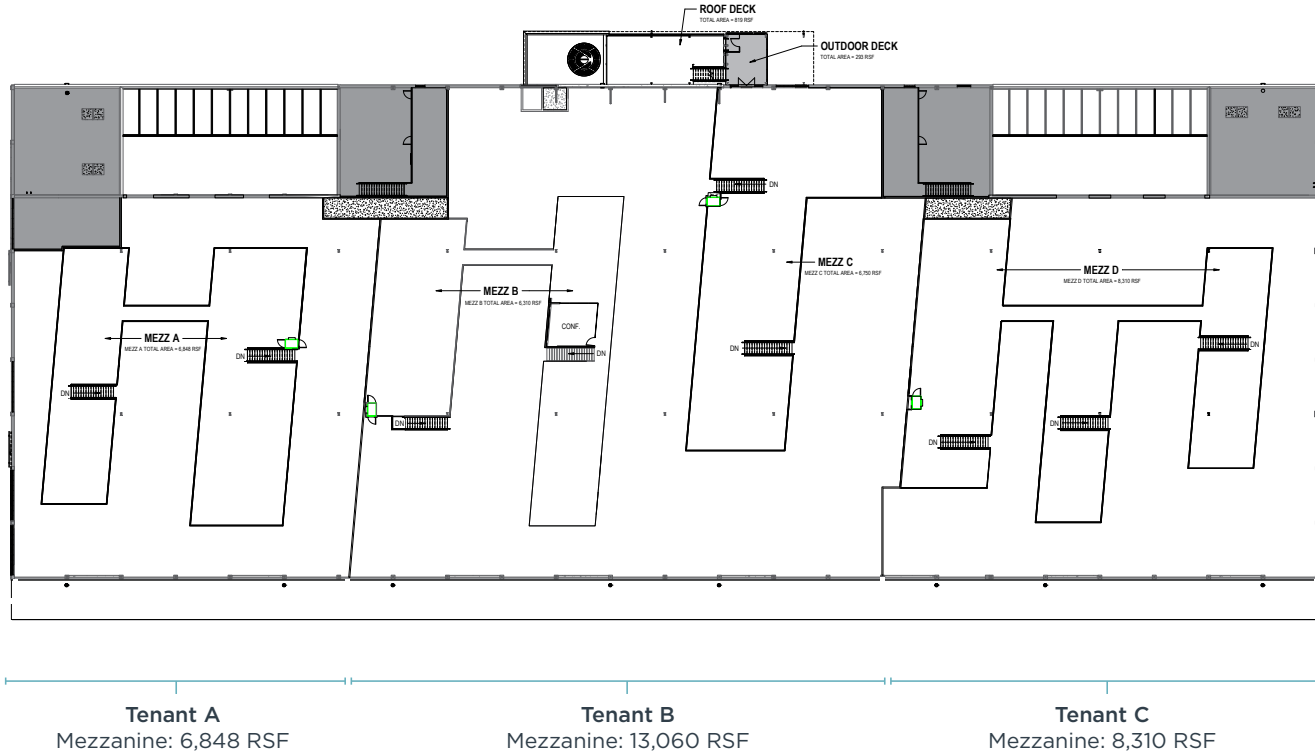
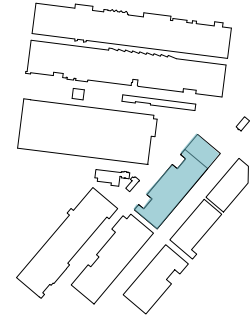

Mezzanine

MULTI TENANT TEST FIT

SUITE 100 | 201 CAMP ROAD

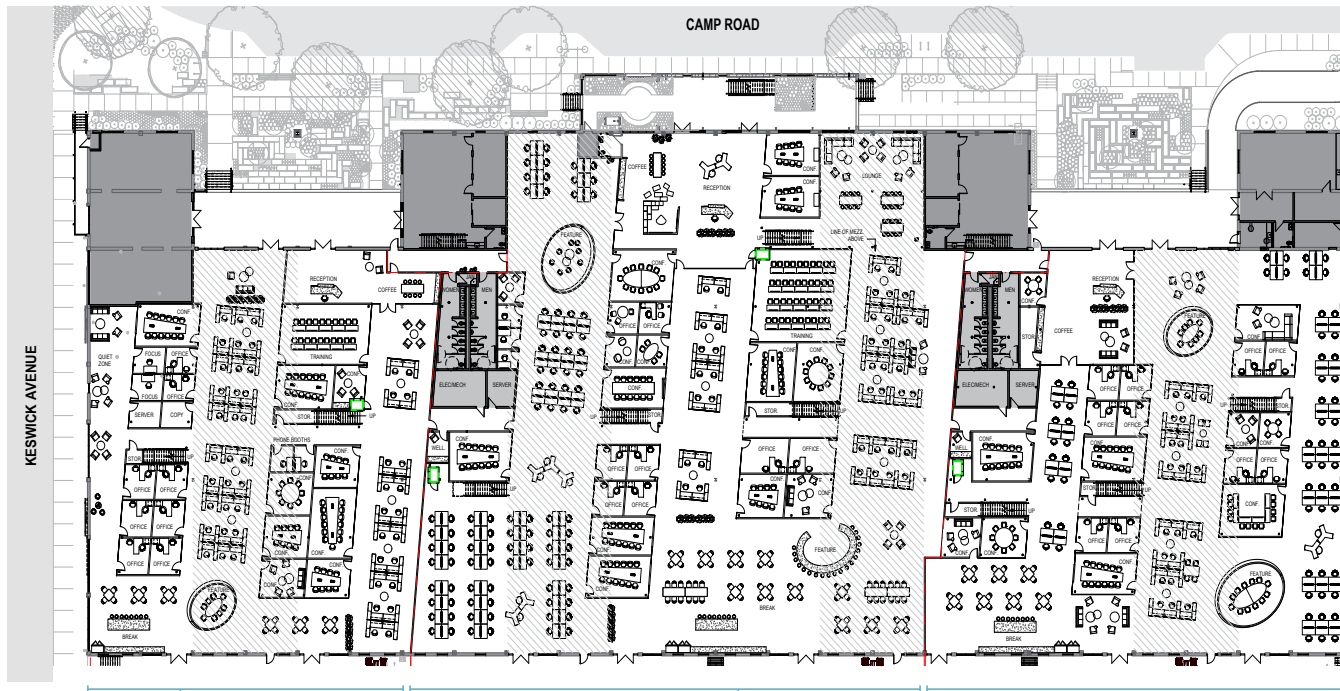
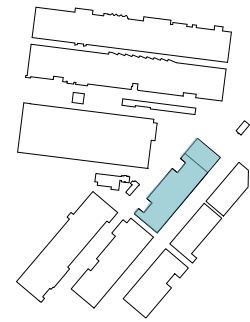

Tenant A

Total: 27,000 RSF

Level 1: 20,152 RSF | Mezzanine: 6,848 RSF

117 OCC = 1: 231 SF or 4.3: 1,000 RSF				18 Mtg Areas = 1: 7 OCC			
Room Type	Level 1 (20,152 RSF)	Mezzanine (6,848 RSF)	Total (27,000 RSF)	Room Type	Level 1 (20,152 RSF)	Mezzanine (6,848 RSF)	Total (27,000 RSF)
Office	08	00	08	Training	00	00	01
Workstation	50	58	108	Conference	09	02	11
Reception	01	00	01	Huddle	05	01	06
Total			117	Total			18

Tenant B

Total: 51,280 RSF

Level 1: 38,220 RSF | Mezzanine: 13,060 RSF

210 OCC = 1: 244 SF or 4.1: 1,000 RSF				25 Mtg Areas = 1: 9 OCC			
Room Type	Level 1 (38,220 RSF)	Mezzanine (13,060 RSF)	Total (51,280 RSF)	Room Type	Level 1 (38,220 RSF)	Mezzanine (13,060 RSF)	Total (51,280 RSF)
Office	08	0	08	Training	01	0	01
Workstation	121	80	201	Conference	132	06	138
Reception	01	0	01	Huddle	03	03	06
Total			210	Total			25

Tenant C

Total: 31,084 RSF

Level 1: 22,774 RSF | Mezzanine: 8,310 RSF

153 OCC = 1: 203 SF or 4.9: 1,000 RSF				21 Mtg Areas = 1: 8 OCC			
Room Type	Level 1 (22,774 RSF)	Mezzanine (8,310 RSF)	Total (31,084 RSF)	Room Type	Level 1 (22,774 RSF)	Mezzanine (8,310 RSF)	Total (31,084 RSF)
Office	10	0	10	Training	0	0	0
Workstation	80	62	142	Conference	10	03	13
Reception	01	0	01	Huddle	07	01	08
Total			153	Total			21

INNOVATION IS OUR IDENTITY, FORGED OVER A CENTURY

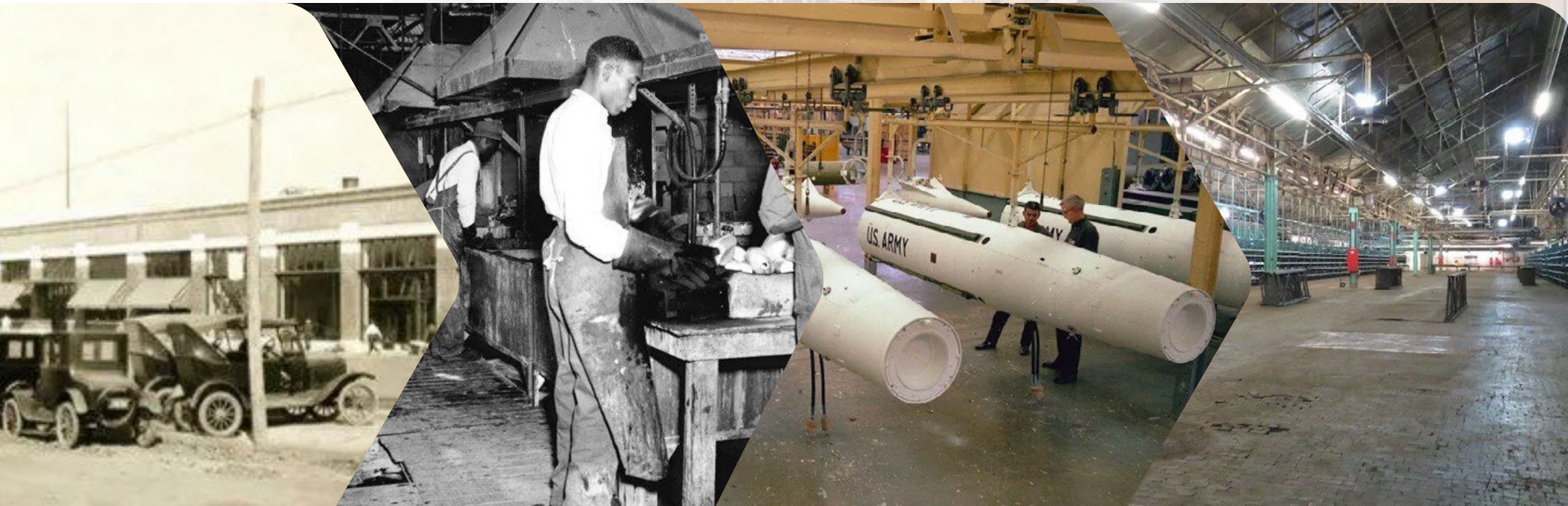

The grounds have been home to a Model-T factory that revolutionized assembly methods and a high-tech production facility for missiles and specialized vehicles for the U.S. Army.



CENTRALLY LOCATED AND EASILY ACCESSIBLE FROM ALL OVER CHARLOTTE.

PLENTY OF PARKING WITH NO TRAFFIC HASSLES.

There's nothing like our diverse community of some of the city's most notable restaurants, retailers, and experiences, a fantastic example of what makes Charlotte world-class.

Support your team with a campus of creators and innovators in the heart of Charlotte while standing out within Charlotte's business community.

EVERYTHING YOUR EMPLOYEES NEED IS RIGHT HERE.



Pick up flowers at the farmers' market.



Grab lunch at a food stall.

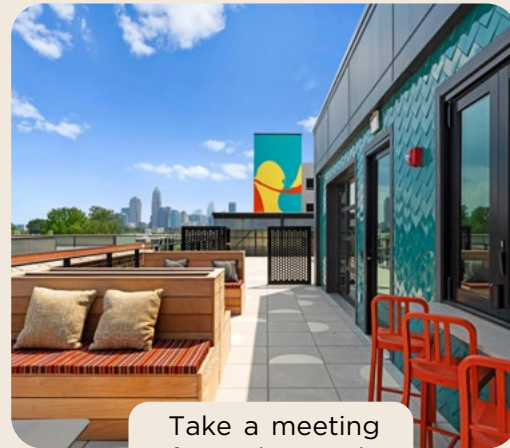

Take a meeting from The Perch.

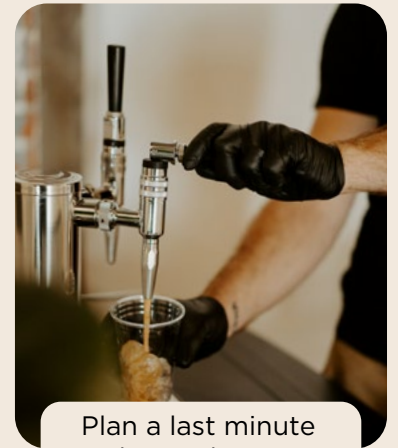

Plan a last minute happy hour.



Host a team gathering at Topsy Pickle, Charlotte's newest entertainment complex.

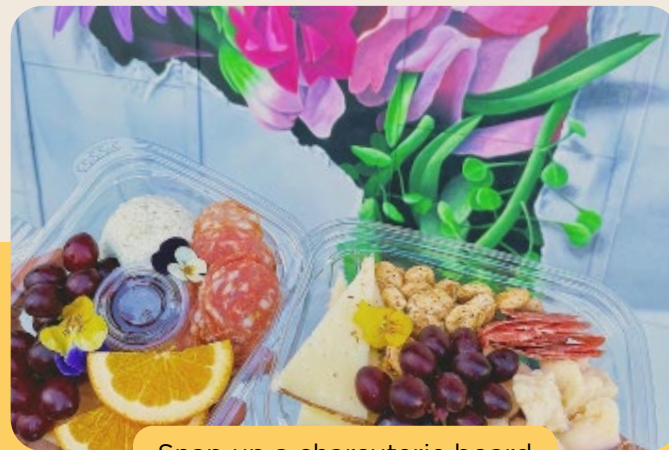

Snap up a charcuterie board after work on your way to a friends for drinks.



Impress clients at dinner at Room Service, Charlotte's premier spot for unique craft cocktails.



IT'S ALL HAPPENING HERE.

CAMP NORTH END IS CHARLOTTE'S
DESTINATION FOR DIVERSE
PROGRAMMING AND EVENTS.

Renowned chefs, trendsetting retail, and lively cultural, culinary, and arts festivals foster community and engagement across the campus for you and your entire team to enjoy.

Creative and engaged onsite community management team plans and executes over **20-30 events per week.**



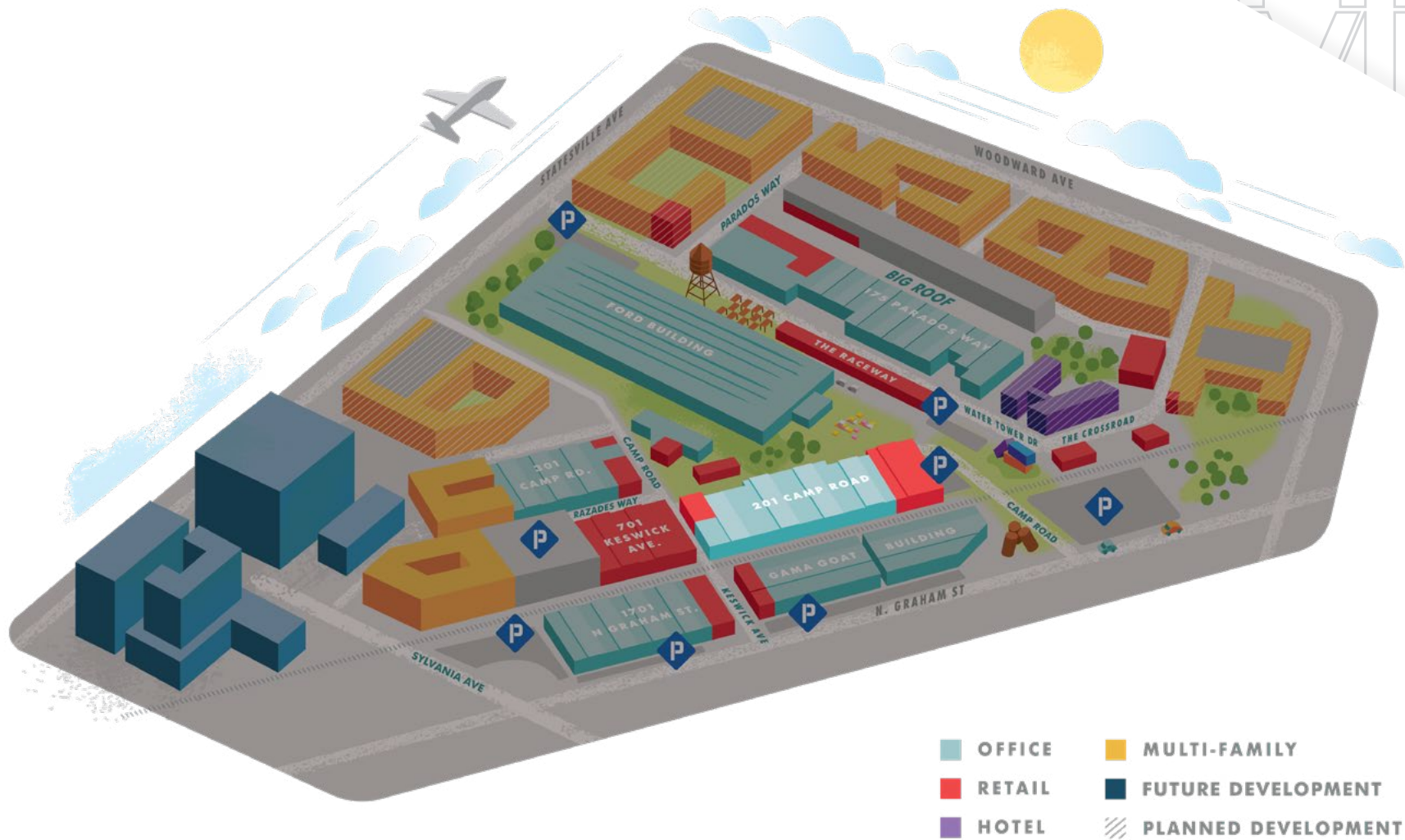

76 ACRES OF EVENT SPACE

TEAM GROWTH AND EXPANSION

IMMERSIVE, ON-SITE RETAIL EXPERIENCE

PRODUCT DEVELOPMENT AND TRAINING LABS

FOR LEASING INFORMATION CONTACT:

OFFICE SPACE

Rhea Greene
704.372.8822
rdg@trinity-partners.com

Natalie Clayton
704.975.4027
nclayton@trinity-partners.com

RETAIL SPACE

Chapman Chastain
980.266.9292
Chapman.Chastain@ascent.re

Aaron Ligon
980.254.2747
Aaron.Ligon@ascent.re



**CAMP
NORTH
END**

300 CAMP ROAD
CHARLOTTE, NORTH CAROLINA
CAMP.NC
@CAMPNORTHEND