

4300 South Padre Island Dr.

Suite 4-1



Cherylyn Boyd

361-585-0300

cherylyn@stonewaterproperties.com

www.stonewaterproperties.com

IDEAL SPACE FOR MEDICAL OR DENTAL
PRACTICE AVAILABLE NOW



The Unit

Office space just off South Padre Island Drive, offering strong exposure in a high-traffic Corpus Christi corridor.

Well-suited for dental or medical use, the unit features a bright reception area, lab, patient rooms, private offices, file storage, and staff breakroom.

Scan to Learn More



Total Square Footage	2,280 SF (approx.)
Base Rent	\$14.01 NNN
Availability	Immediate

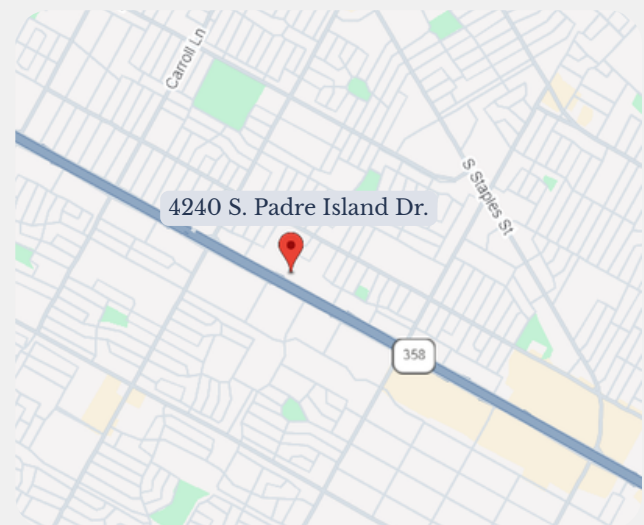

4300 South Padre Island Dr.

Suite 4-1



FLOOR PLAN

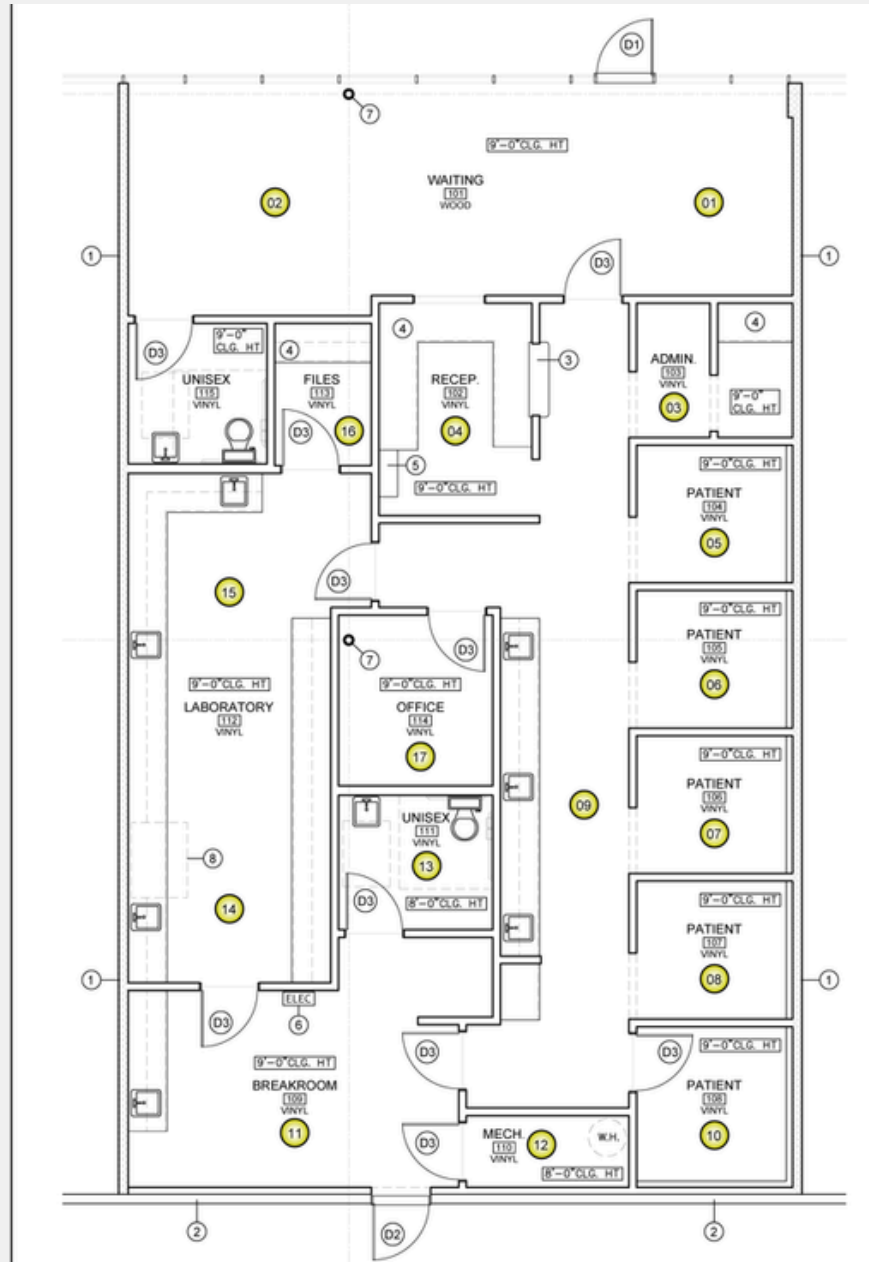

Scan to Learn More



Cherylyn Boyd

361-585-0300
cherylyn@stonewaterproperties.com

www.stonewaterproperties.com