

▶ PRICING

Size: 1,600 SF
 Base Rent: \$35.00 PSF/yr.
 Triple Nets: \$12.03 PSF/yr.
 Total: \$6,270/mo.

▶ COMMENTS

- Move in Ready
- 3% annual base rent escalations

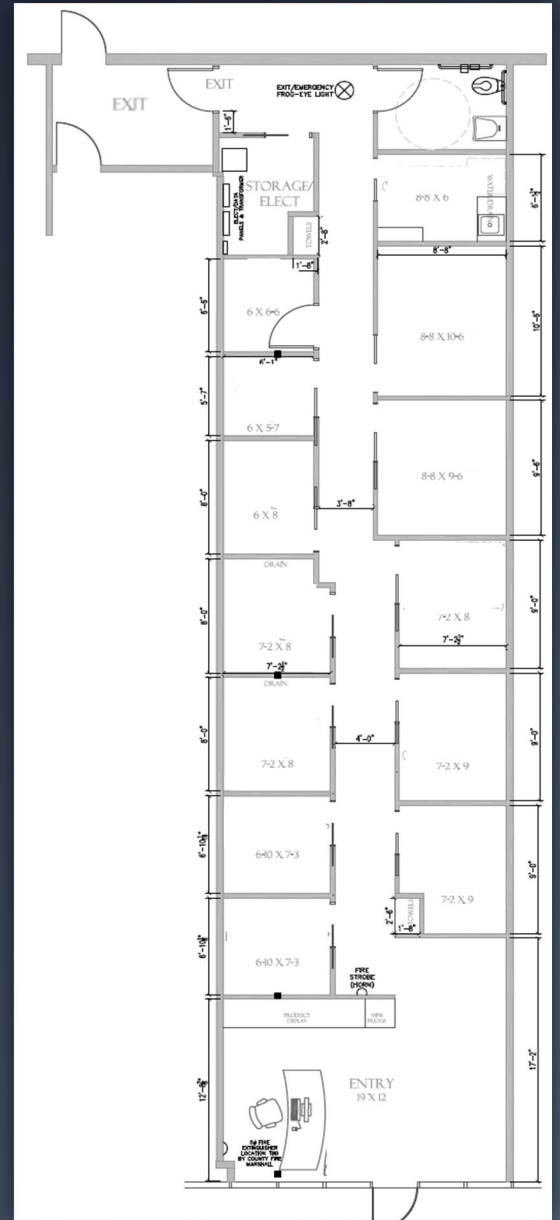

Phillip Carameros | (832) 937-5900 | phillip@gordonpartners.com
 Jenny Nguyen | (409)900-2060 | jenny@gordonpartners.com