



# PIONEER BUILDING

600 1ST AVENUE  
SEATTLE, WA



# EXPANSIVE<sup>®</sup>

workspace

## TEAM SUITE 200B

ACCOMODATES HEADCOUNT OF UP TO 24

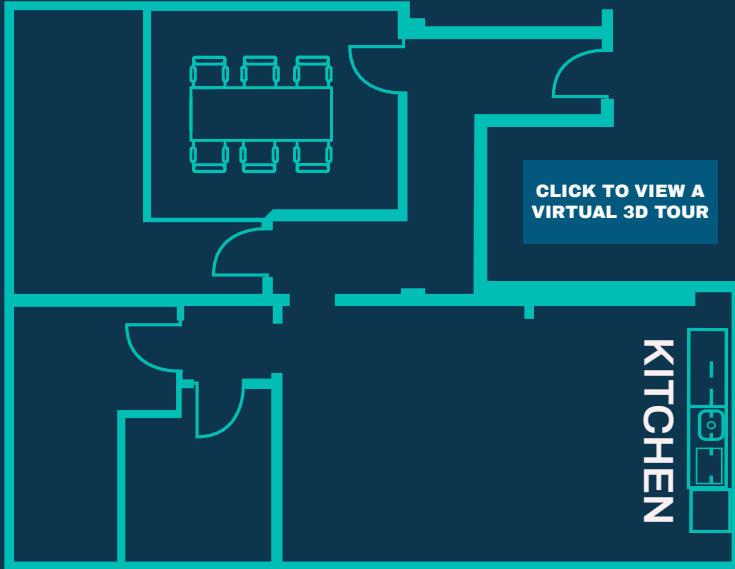

1650 SQUARE FEET OF PRIVATE SPACE PLUS 3000+SF OF SHARED WORKSPACE, COWORKING LOUNGE, KITCHEN, PHONE BOOTHS & MORE

### SOLUTION INCLUDES:



FULLY FURNISHED



DIRECT FIBER INTERNET & WIFI ACCESS



EXPANSIVE LOUNGE



COFFEE & TEA



24/7 ACCESS



ON-SITE MGMT



HIGH SPEED PRINTERS



UTILITIES



MOTHERS' ROOM



COMMUNITY APP



BIKE ROOM



NETWORK ACCESS



EXPLORE OUR AVAILABLE TEAM SUITE OPTIONS TODAY!

CONTACT EXPANSIVE

877.301.6217 | sales@expansive.com