

RESTAURANT PROPERTY FOR LEASE

4162 Herschel Street Jacksonville, FL 32210



Lease Rate

**\$4,500/MONTH,
NNN**

DO NOT CONTACT EXISTING TENANT-THEY ARE CURRENTLY OPEN FOR BUSINESS

Currently operating restaurant- Falafel Bar

OFFERING SUMMARY

Building Size: Main Bldg:1374 SF
Patio:976 SF
Total Size:2350 SF

Zoning: CCG-1

Features Free standing restaurant with nice covered patio

Est. Seating Approximately 70 (22 inside + 48 outside)

Location: Located in the Avondale/Ortega Trade Area

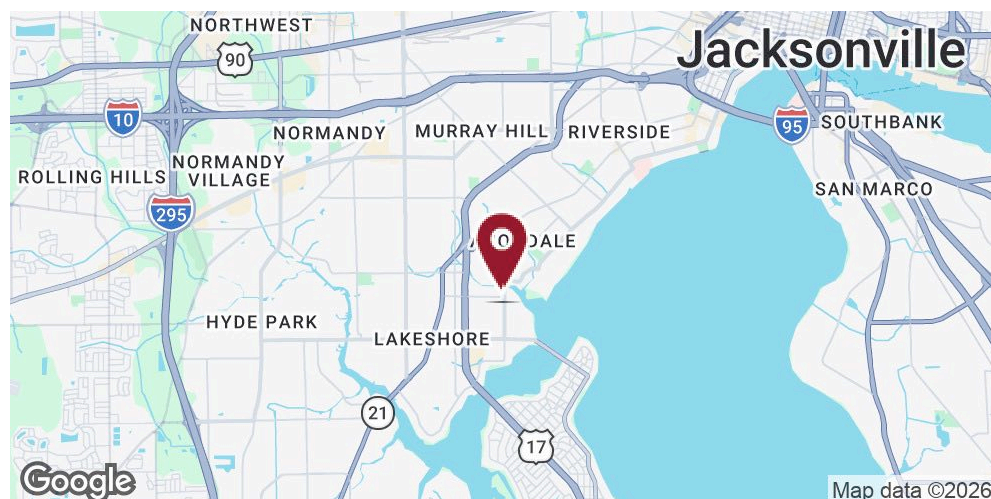

Stanton Hudmon, CCIM

904.398.1044 / stanton@psrps.com

Pine Street/RPS / 904.398.1044 / 2650-2 Rosselle Street, Jacksonville, FL 32204 / pinestreetrps.com

Information provided is deemed accurate, but subject to errors and/or omissions.



Pine Street / RPS

RESTAURANT PROPERTY FOR LEASE

4162 Herschel Street Jacksonville, FL 32210

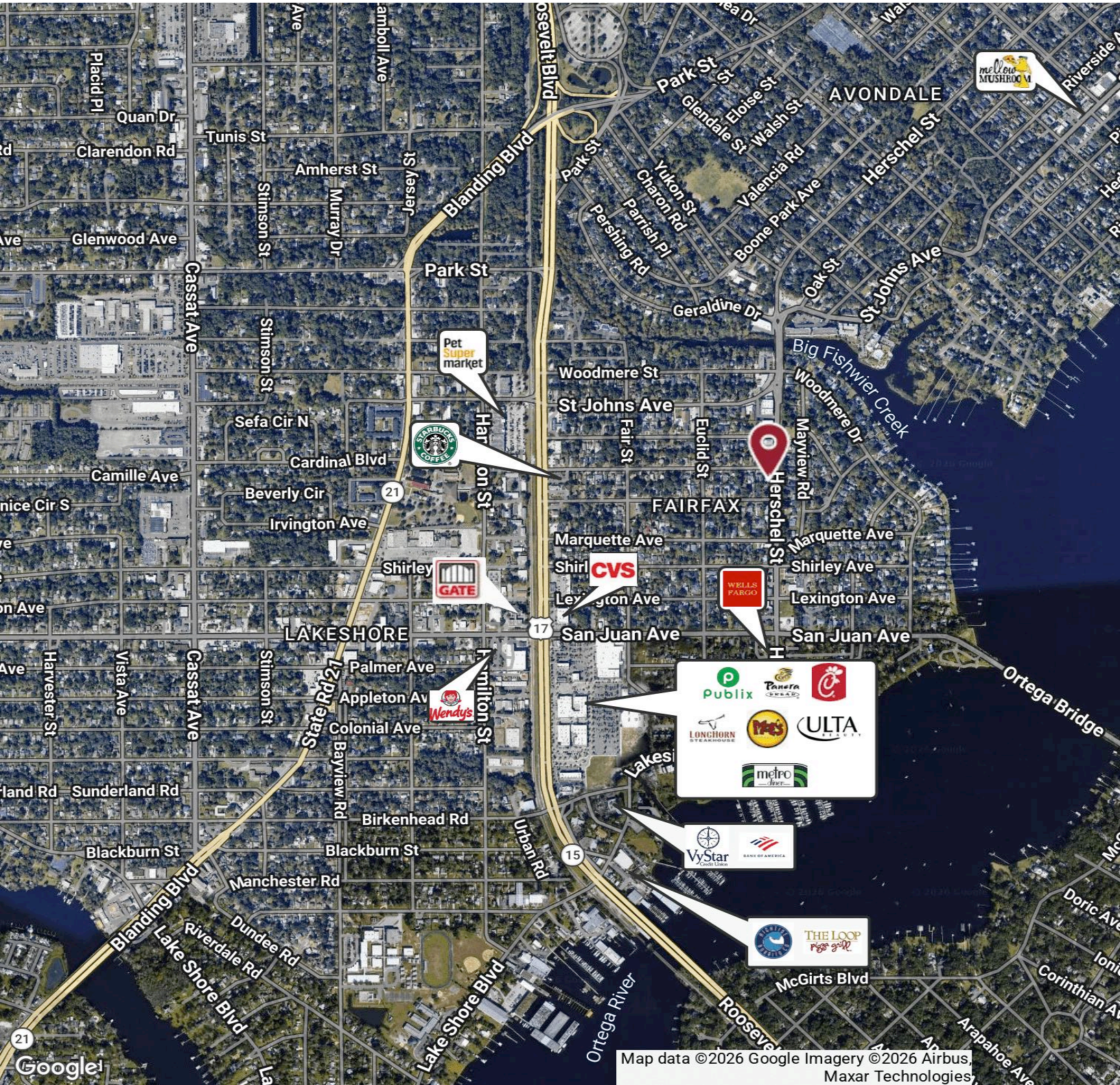

Stanton Hudmon, CCIM
904.398.1044 / stanton@psrps.com

Pine Street/RPS / 904.398.1044 / 2650-2 Rosselle Street, Jacksonville, FL 32204 / pinestreetrps.com
Information provided is deemed accurate, but subject to errors and/or omissions.



Pine Street / RPS

RESTAURANT PROPERTY FOR LEASE

4162 Herschel Street Jacksonville, FL 32210

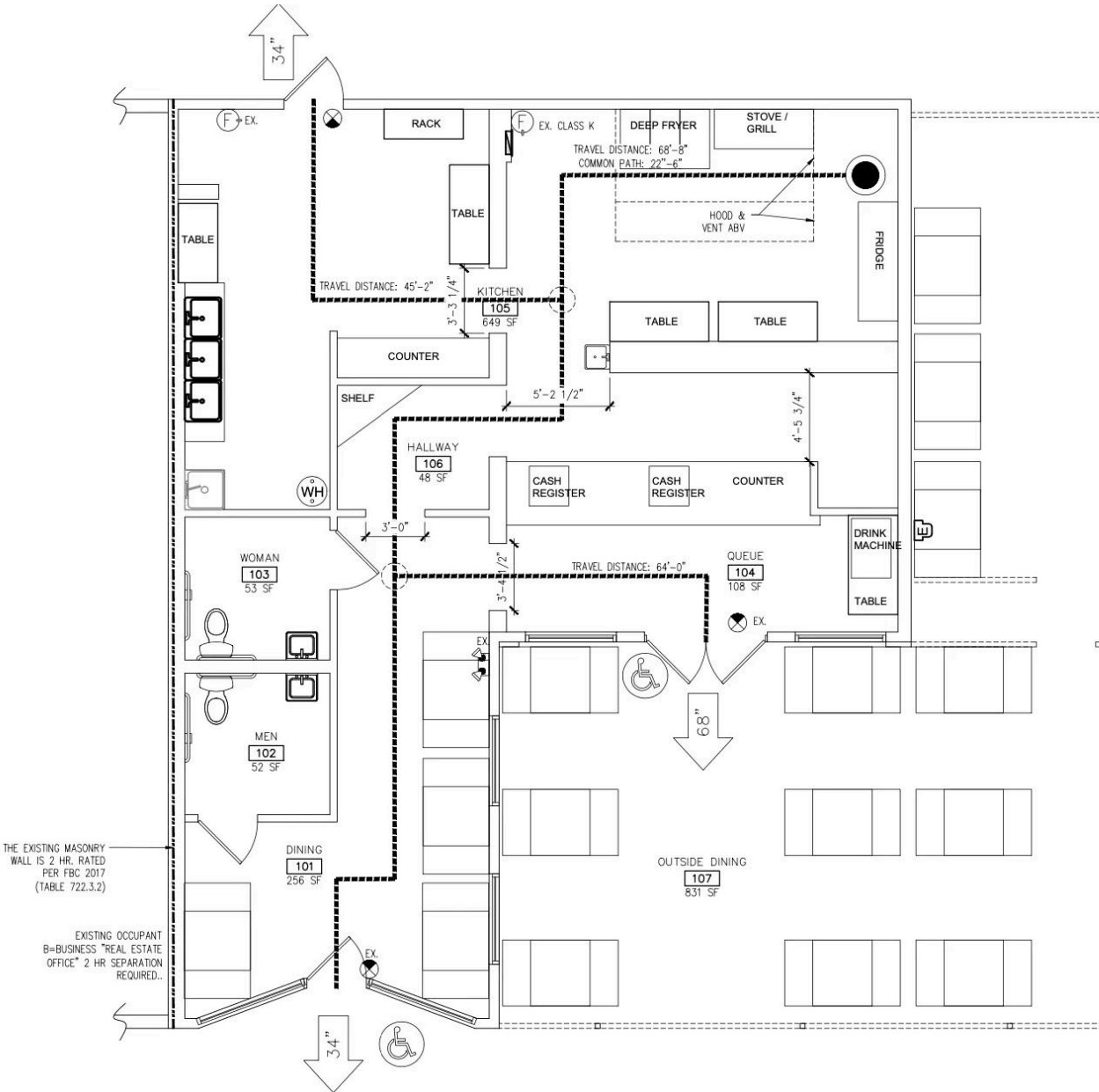

JAA ARCHITECTURE INC.
2716 ST. JOHNS AVE.
JACKSONVILLE FL 32205
P: (904) 379-5108
E: JOHN@JAAARCHITECTURE.COM
LIC. AR92748

THIS DOCUMENT, ALONG WITH ASSOCIATED DOCUMENTS, IS AN INSTRUMENT OF DESIGNER'S SERVICE FOR THE EXCLUSIVE USE AT THE PROJECT TITLED HEREIN. INFORMATION DERIVED FROM THIS DOCUMENT, AND/OR ASSOCIATED DOCUMENTS, MAY NOT BE USED FOR OTHER WORK(S) OR PROJECT(S) WITHOUT THE EXPRESS WRITTEN PERMISSION OF THE DESIGNER.

LIFE SAFETY PLAN
4162 HERSCHEL ST
4162 HERSCHEL ST
JACKSONVILLE, FL 32210

Stanton Hudmon, CCIM
904.398.1044 / stanton@psrps.com

Pine Street/RPS / 904.398.1044 / 2650-2 Rosselle Street, Jacksonville, FL 32204 / pinestreetrps.com

Information provided is deemed accurate, but subject to errors and/or omissions.



Pine Street / RPS

RESTAURANT PROPERTY FOR LEASE

4162 Herschel Street Jacksonville, FL 32210

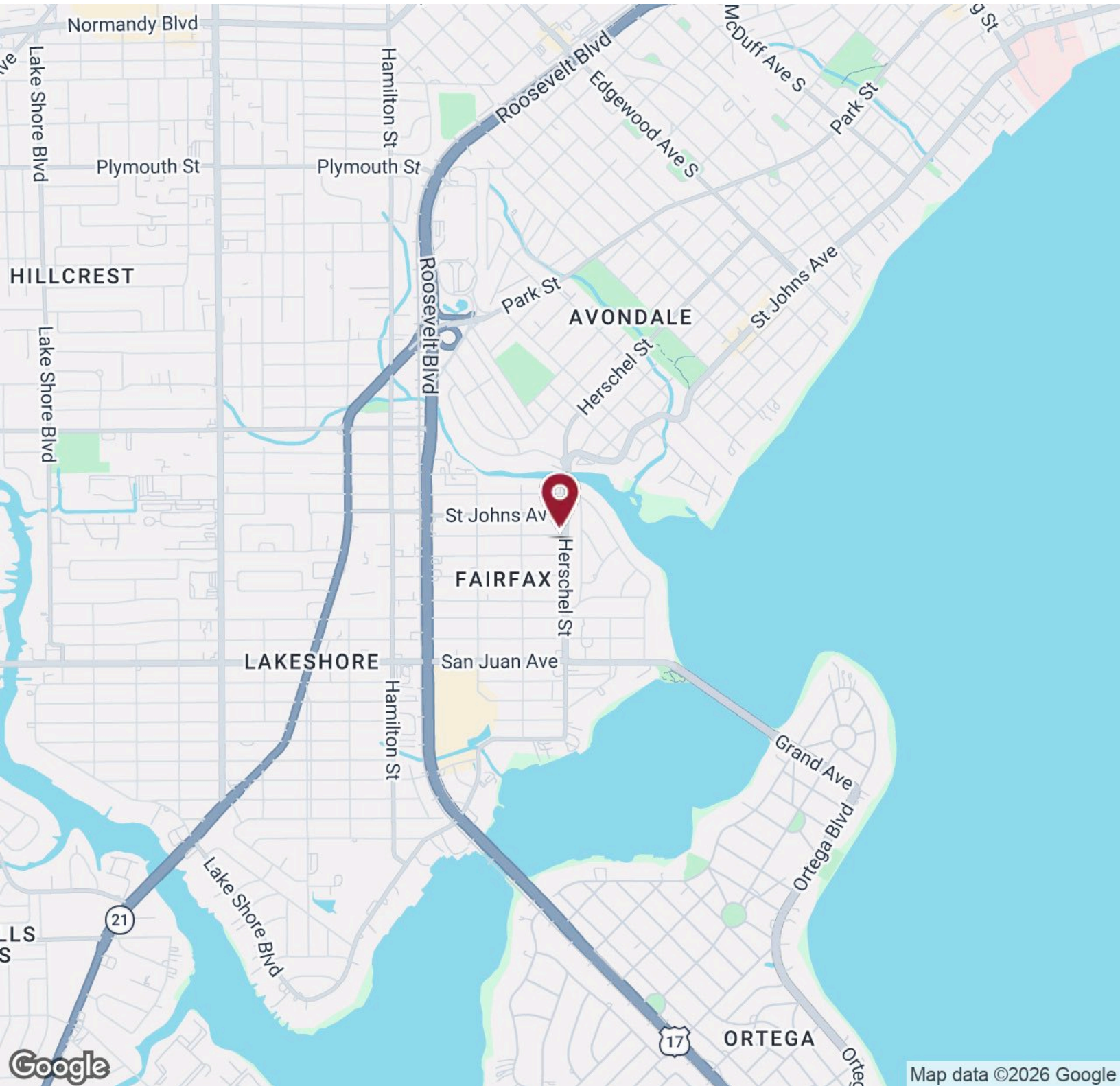

Stanton Hudmon, CCIM

904.398.1044 / stanton@psrps.com

Pine Street/RPS / 904.398.1044 / 2650-2 Rosselle Street, Jacksonville, FL 32204 / pinestreetrps.com

Information provided is deemed accurate, but subject to errors and/or omissions.



Pine Street / RPS

RESTAURANT PROPERTY FOR LEASE

4162 Herschel Street Jacksonville, FL 32210

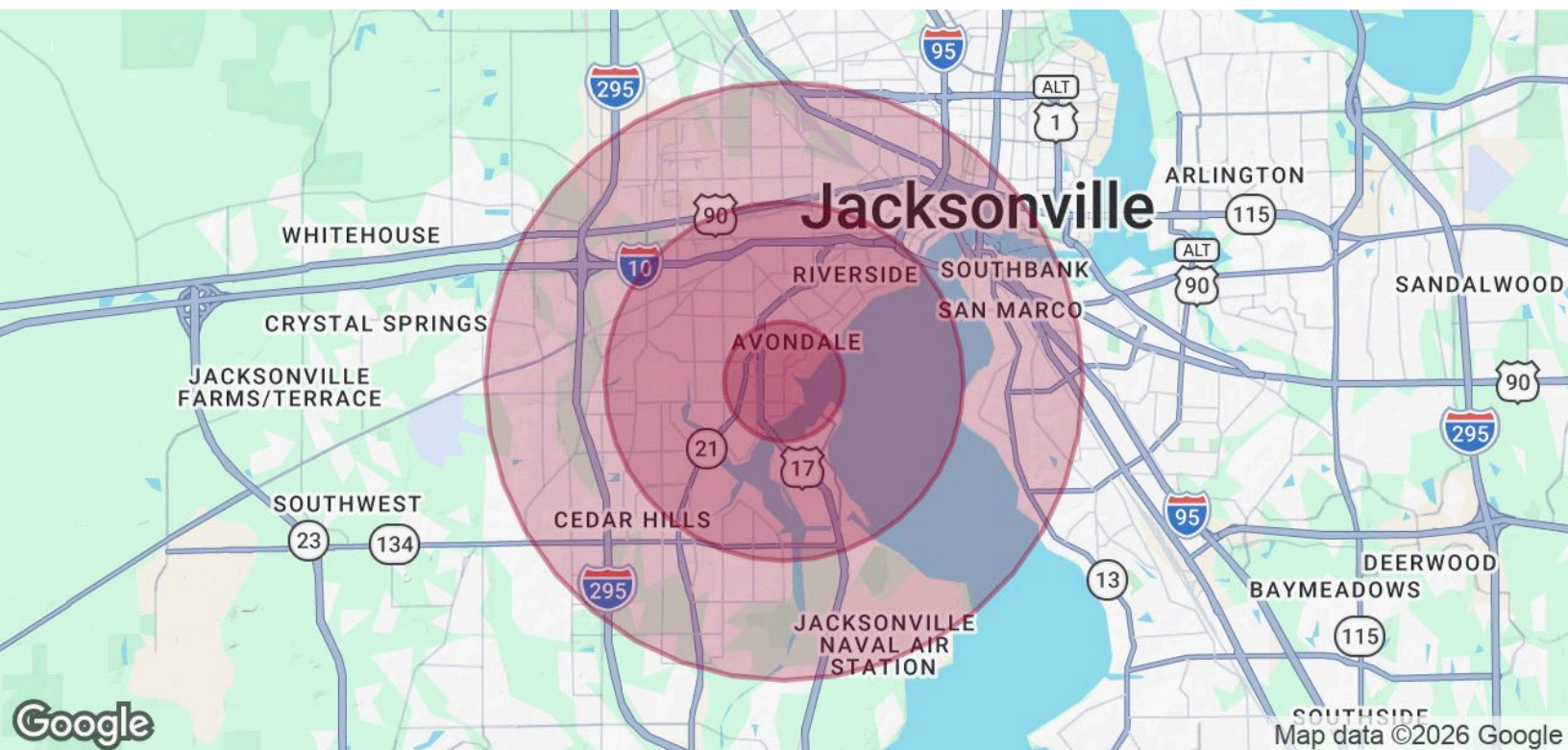

POPULATION	1 MILE	3 MILES	5 MILES
Total Population	7,257	65,657	163,470
Average Age	41.6	38.0	36.4
Average Age (Male)	41.6	37.6	35.8
Average Age (Female)	40.8	38.1	36.8

HOUSEHOLDS & INCOME	1 MILE	3 MILES	5 MILES
Total Households	3,243	28,542	67,212
# of Persons per HH	2.2	2.3	2.4
Average HH Income	\$75,211	\$62,722	\$56,568
Average House Value	\$290,275	\$275,623	\$227,586

2020 American Community Survey (ACS)

Stanton Hudmon, CCIM
904.398.1044 / stanton@psrps.com

Pine Street/RPS / 904.398.1044 / 2650-2 Rosselle Street, Jacksonville, FL 32204 / pinestreetrps.com

Information provided is deemed accurate, but subject to errors and/or omissions.



Pine Street / RPS