

# DENHAM BUSINESS PARK

Brunel Drive, Newark, NG24 2EG



## Key Highlights

- Brand new industrial / trade counter units ranging from 3,000 - 6,000 sq ft. Mezzanine can be installed at 3,000 sq ft per unit
- Fully concrete surfaced dedicated yards with allocated parking
- Internal clear height is approximately 6m
- Due for completion in Q3 2025

SAVILLS NOTTINGHAM  
Cubo, Standard Court, Park Row  
Nottingham NG1 6GN

**+44 (0) 115 934 8050**

[savills.co.uk](https://www.savills.co.uk)

HARLAXTON ESTATES  
Windsor House, Long Bennington Business  
Park, Long Bennington, Newark, NG23 5JR

**+44 (0) 800 999 2222**

[harlaxtonestates.co.uk](https://www.harlaxtonestates.co.uk)





## Location

The property is situated in the Nottinghamshire market town of Newark which lies almost equal distance (20 miles) between Nottingham (to the south west) and Lincoln (to the north east), with Mansfield being a similar distance to the west.

Newark town centre, A46 by pass and the A1 are within close proximity and there are excellent direct rail links into London Kings Cross with a travel time of approximately 1 hour 20 minutes.

## Situation

The property occupies a prominent position on Brunel Drive, the principal spine road running through the Northern Road Industrial Estate.

This is an established trade counter location, with neighbouring occupiers including Howdens, Magnet, Screwfix, ATS and Travis Perkins, to name but a few.

## Description

The units will comprise newly built industrial / trade counter units of steel portal frame construction with trapezoidal wall and roof cladding, finished with plastic coated metal trims and flashings.

Each unit will benefit from its own level access electric roller shutter door with a height of 4m.

In addition each unit will be provided with a dedicated loading / parking area.

## Accommodation

The property has been measured on a gross internal basis. All figures are provided for guidance purposes only.

FLOOR	SQ FT	SQ M
Unit 7	3,000	278.71
Unit 8	3,000	278.71
<b>Total</b>	<b>6,000</b>	<b>557.42</b>

*Mezzanine can be installed at 3,000 sq ft per unit*

## Services

The site is connected to gas, 3 phase electrics, water and drainage.

Each unit will be provided with separate metering.

SAVILLS NOTTINGHAM  
Cubo, Standard Court, Park Row  
Nottingham NG1 6GN

**+44 (0) 115 934 8050**

[savills.co.uk](http://savills.co.uk)

HARLAXTON ESTATES  
Windsor House, Long Bennington Business  
Park, Long Bennington, Newark, NG23 5JR

**+44 (0) 800 999 2222**

[harlaxtonestates.co.uk](http://harlaxtonestates.co.uk)



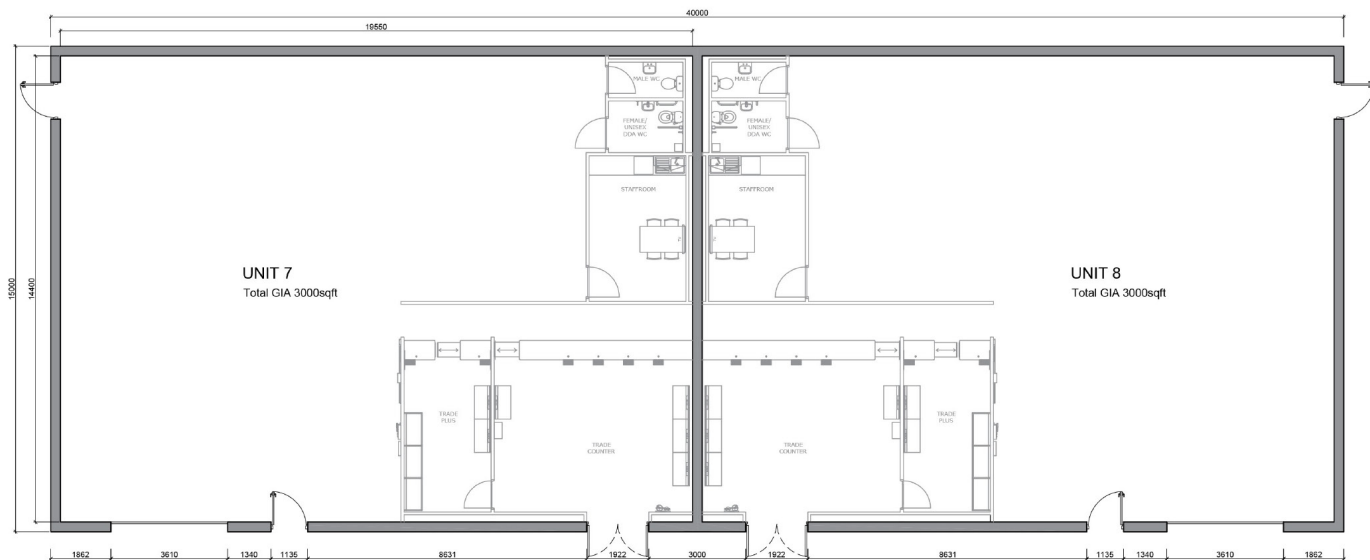

## Tenure

The units are available in part or as a whole on flexible lease terms, or alternatively the whole site is available on a freehold basis.

## Price

Price on application.

## Rent

£15.00 psf per annum exclusive.

## Rateable Value

TBC

## EPC

TBC

## VAT

VAT is applicable.

## Legal Costs

Each party to bear their own legal costs incurred in this transaction.

## Money Laundering Regulations

In accordance with the Money Laundering Regulations, the purchaser will be required to provide full proof of identity, address and funding prior to an offer being accepted and solicitors being instructed.

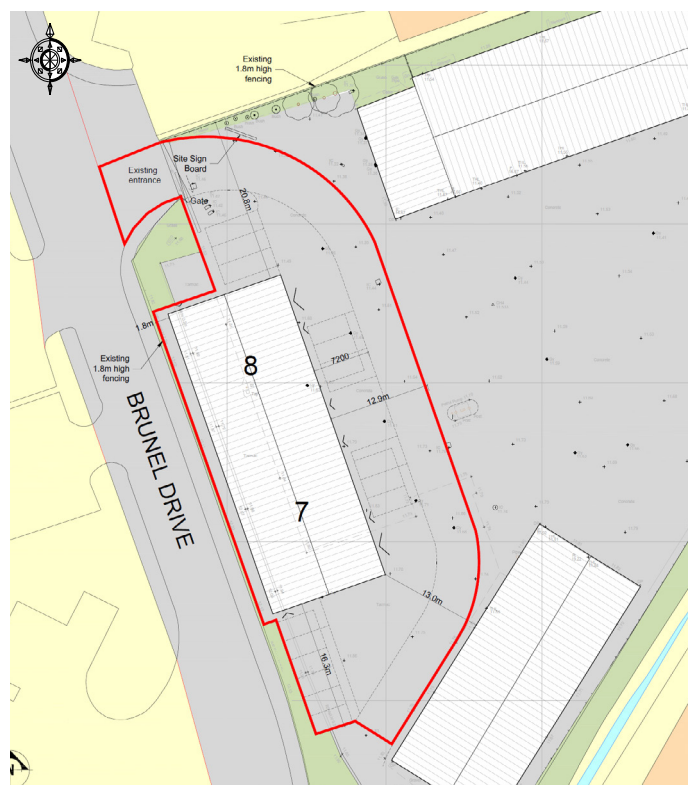

## Viewing and Further Information

Strictly by prior appointment only with the Sole Agent, Savills.

## Contact

**Victor Ktori MRICS BSc (Hons)**  
+44 (0) 7870 999 467  
vktori@savills.com

**Luke Epps BSc (Hons)**  
+44 (0) 7811 073 302  
luke.epps@savills.com

### IMPORTANT NOTICE

Maps are reproduced from the Ordnance Survey Map with the permission of the Controller of H.M. Stationery Office. © Crown copyright licence number 100022432 Savills (UK) Ltd, published for the purposes of identification only and although believed to be correct accuracy is not guaranteed. Savills, their clients and any joint agents give notice that: 1. They are not authorised to make or give any representations or warranties in relation to the property either here or elsewhere, either on their own behalf or on behalf of their client or otherwise. They assume no responsibility for any statement that may be made in these particulars. These particulars do not form part of any offer or contract and must not be relied upon as statements or representations of fact. 2. Any areas, measurements or distances are approximate. The text, photographs and plans are for guidance only and are not necessarily comprehensive. It should not be assumed that the property has all necessary planning, building regulation or other consents and Savills have not tested any services, equipment or facilities. Purchasers must satisfy themselves by inspection or otherwise. Designed and Produced by Savills Marketing: 020 7499 8644 | 09.12.24 | VK

**savills**