

One M *street*

Gateway to Washington's Fastest Growing Neighborhood



One M^{street}

Premier corner
location with **3** sides
of glass for maximum
natural light

1 block to the
Navy Yard-Ballpark
Metro Station

LEED Gold Core
& Shell

AVAILABLE SUITES:

- Entire 3rd Fl 13,251 RSF (divisible)
- Partial 6th Fl 3,780 RSF

BUILDING STATS:

- 118,000 sq. ft., 10-story building
- Delivered in Q1 2020
- Parking ratio of 1/1,500 RSF
- Owner occupied building

BUILDING AMENITIES:

- On-site retail includes Scissors & Scotch and Llamabar Cafe
- Tenant only rooftop terrace with exceptional views of Capitol Hill and the Capitol Riverfront
- Large conference room
- Fitness center
- 4 high-speed elevators
- 24/7 lobby attendant
- Car charging stations
- Bike storage

LOCATION:

- 1 block to the Navy Yard-Ballpark Metro Station
- Convenient access to Capitol Hill
- Immediate access to I-395 and I-295
- 1 block from Washington Nationals Ballpark
- 4 miles from Reagan National Airport

Tenant Rooftop Terrace



Tenant Fitness Center



Tenant Conference Center



Facing M Street



Full Video Conferencing Capabilities

Existing Conditions Third Floor: 13,251 SF

M Street

South Capitol Street

Van Street



SUITE 300 - 13,251 RSF

- (1) RECEPTION
- (1) WAITING AREA
- (1) CONFERENCE ROOM - 8 SEATS
- (1) CONFERENCE ROOM - 10 SEATS
- (2) CONFERENCE ROOM - 16 SEATS
- (1) PANTRY
- (6) PERIMETER OFFICES
- (4) INTERIOR OFFICES
- (2) OPEN WORK AREA - 5 SEATS
- (2) HUDDLE ROOMS
- OPEN WORK - (36) 6'X6' WORKSTATIONS
 - (7) 6'X8' WORKSTATIONS
 - (2) 2'6"X6' WORKSTATIONS
- (2) PHONE ROOMS
- (1) COFFEE
- (1) WELLNESS
- (4) STORAGE ROOM
- (1) LAN ROOM
- (3) CLOSET

TOTAL STAFF: 61

Two Tenant Test Fit: 13,251 SF

M Street

South Capitol Street

Van Street



SUITE 300 - 7,264 RSF

- (1) RECEPTION - 1 SEAT
- (1) WAITING AREA
- (1) CONFERENCE ROOM - 8 SEATS
- (1) PANTRY
- (7) PERIMETER OFFICE
- (2) INTERIOR OFFICE
- (2) WORK AREA - 5 SEATS
- (1) HUDDLE ROOM - 4 SEATS
- (2) OPEN WORK - (14) 6'X6' WORKSTATIONS
- (3) 6'X8' WORKSTATIONS
- (1) WELLNESS
- (3) STORAGE ROOM
- (1) IT/WORKROOM
- (1) CLOSET

TOTAL STAFF: 32

SUITE 305 - 5,987 RSF

- (1) RECEPTION
- (1) CONFERENCE ROOM - 10 SEATS
- (1) PANTRY
- (10) PERIMETER OFFICE
- (2) INTERIOR OFFICE
- (2) HUDDLE ROOM - 4 SEATS
- (2) OPEN WORK - (8) 6'X6' WORKSTATIONS
- (2) 6'X8' WORKSTATIONS
- (2) PHONE ROOM
- (1) STORAGE ROOM
- (1) LAN ROOM
- (2) CLOSET

TOTAL STAFF: 22

Sixth Floor Spec Suite: 3,780 SF

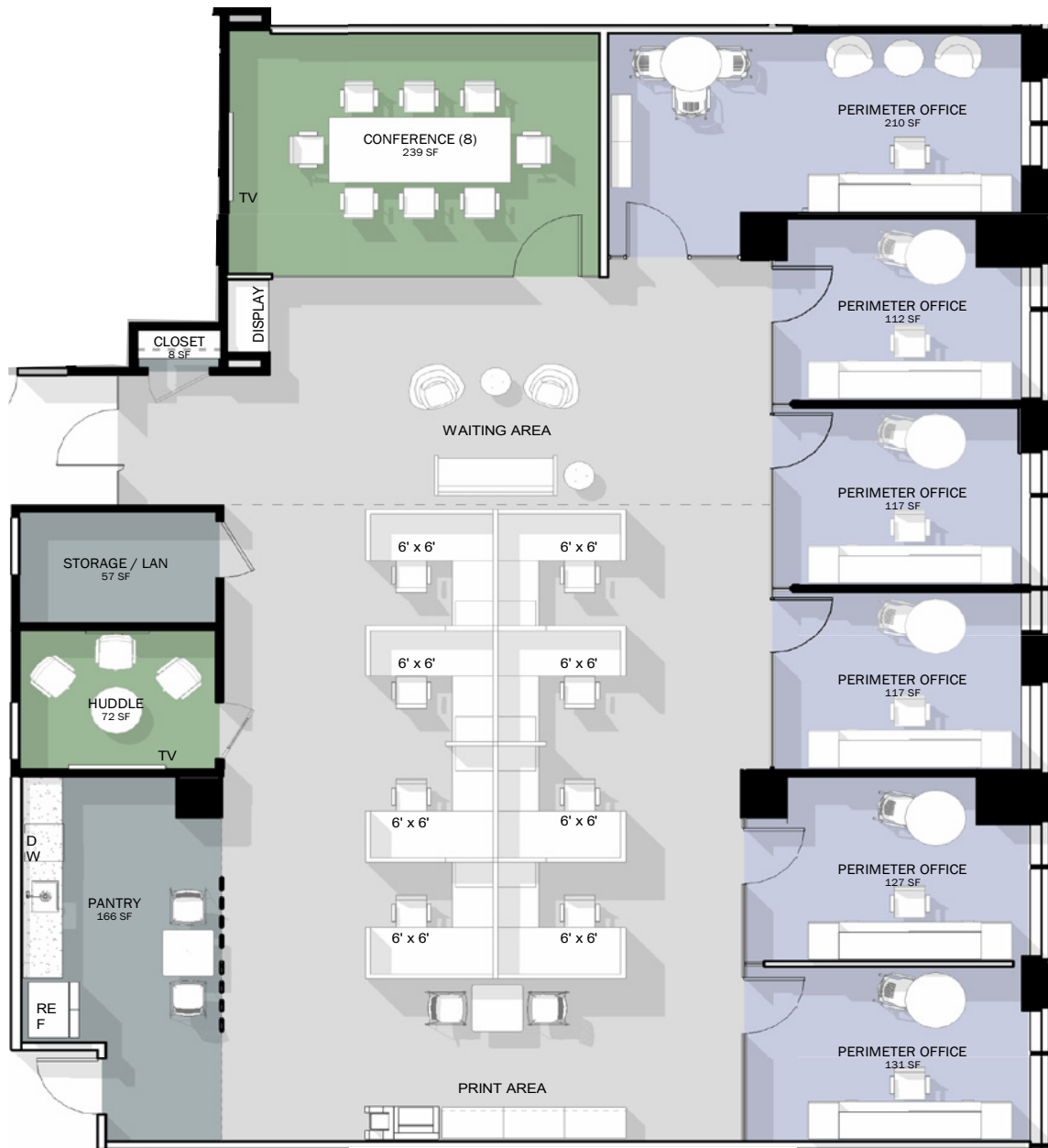

Van Street

SUITE 610 - 3,780 RSF

- (1) RECEPTION
- (1) CONFERENCE ROOM - 12 SEATS
- (1) OPEN PANTRY
- (1) OPEN COPY
- (6) PERIMETER OFFICES
- OPEN WORK - (6) 6X8 WORKSTATIONS
- (1) STORAGE / LAN ROOM
- (1) STORAGE ROOM
- (1) COAT CLOSET
- (1) HUDDLE ROOM

TOTAL STAFF: 12



Capital Riverfront AMENITIES



● *conveniences & retail*

● *dining*

- 1. Aura Spa
- 2. Bang Salon
- 3. Bank of America
- 4. Barre3
- 5. Boombox Boxing
- 6. Chase Bank
- 7. Chelsea Cleaners
- 8. CVS
- 9. Dry
- 10. F45 Training
- 11. Harris Teeter
- 12. Lululemon
- 13. Orangetheory
- 14. Scissors & Scotch
- 15. Solidcore
- 16. Truist Bank
- 17. T-Mobile
- 18. UPS Store
- 19. Vida Fitness
- 20. Wells Cleaners
- 21. Wells Fargo
- 22. Whole Foods

- 1. Agua 301
- 2. Albi
- 3. All-Purpose Pizzeria
- 4. Al's Delicatessen
- 5. Atlas Brew Works
- 6. Base Bowl
- 7. Bethesda Bagels
- 8. Bluejacket Brewery
- 9. Bluestone Lane
- 10. Bonchon Chicken
- 11. Cava
- 12. Chipotle
- 13. Chloe
- 14. Chopt
- 15. Circa Bistro
- 16. Compass Coffee
- 17. Dacha Beer Garden
- 18. District Winery
- 19. Due South
- 20. El Bebe
- 21. Emmy Squared Pizza
- 22. Five Guys
- 23. Gatsby
- 24. Hatoba
- 25. HipCityVeg
- 26. Jackie
- 27. Jeni's Ice Cream
- 28. La Famosa
- 29. Lot 38 Espresso
- 30. Mah Ze Dahr
- 31. Mission
- 32. Nando's
- 33. Osteria Morini
- 34. Potbelly
- 35. Rasa
- 36. Scarlet Oak
- 37. Shake Shack
- 38. Shilling Canning Co.
- 39. Side Door Pizza
- 40. Slipstream
- 41. Smoke & Mirrors
- 42. Solace Outpost
- 43. Starbucks
- 44. Subway Cafe
- 45. Sukuta
- 46. Sweetgreen
- 47. TaKorean
- 48. Tap99
- 49. The Big Stick
- 50. The Brig
- 51. The Salt Line
- 52. Toastique
- 53. Walter's Sports Bar
- 54. Yellow

● *hotels*

- 1. Courtyard by Marriott
- 2. Hampton Inn & Suites
- 3. Homewood Suites
- 4. Residence Inn by Marriott
- 5. Thompson



One M street

For More Information

Office Inquiries:

Manny Fitzgerald
Executive Vice President
+1 202 585 5540
manny.fitzgerald@cbre.com

Andrew Felber
Senior Vice President
+1 202 585 5604
andrew.felber@cbre.com

© 2023 CBRE, Inc. All rights reserved. This information has been obtained from sources believed reliable, but has not been verified for accuracy or completeness. Any projections, opinions, or estimates are subject to uncertainty. The information may not represent the current or future performance of the property. You and your advisors should conduct a careful, independent investigation of the property and verify all information. Any reliance on this information is solely at your own risk. CBRE and the CBRE logo are service marks of CBRE, Inc. and/or its affiliated or related companies in the United States and other countries. All other marks displayed on this document are the property of their respective owners. Photos herein are the property of their respective owners and use of these images without the express written consent of the owner is prohibited. PMStudio_October2024

CBRE