

FOR LEASE

# Powder Mill Square

RETAIL/OFFICE | 3828-3858 KENNETT PIKE | GREENVILLE, DE 19807



## OFFERING SUMMARY

Available SF: 183 - 3,017 SF  
Property Size: 56,686 SF

## PROPERTY OVERVIEW

Powder Mill Square is a 56,686 SF lifestyle center which includes various boutique retail spaces along with 2nd floor office suites. Major tenants include Starbucks, Chico's, A.R. Morris Jewelers, and Whimsy

## LOCATION OVERVIEW

Located in the heart of highly affluent Greenville, DE, Powder Mill Square is a short drive to the city of Wilmington and Pennsylvania/Delaware border on Kennett Pike (route 52). Powder Mill Square is also located across the street from Pettinaro's Greenville Center which includes additional national retailers and high end shopping.

## DEMOGRAPHICS

	1 MILE	5 MILES	10 MILES
Total Households	516	71,175	196,854
Total Population	1,326	177,172	506,070
Average HH Income	\$247,208	\$81,066	\$87,646



### PETTINARO.COM

f PettinaroCRE/  
company/pettinaro/  
in  
PettinaroCRE/  
PettinaroCRE/

### CORPORATE OFFICES

234 North James Street  
Newport, DE 19804  
302.999.0708

### LEASING INQUIRIES

Matt Guers  
Director of Office Leasing  
609.605.1843  
mguers@pettinaro.com

Timothy "TJ" Spencer, CCIM  
Director of Retail Leasing  
302.999.0708  
tjspencer@pettinaro.com

**FOR LEASE**

# Powder Mill Square

**RETAIL/OFFICE | 3828-3858 KENNETT PIKE | GREENVILLE, DE 19807**



**LEGEND**

Available

Unavailable

**LEASE INFORMATION**

Lease Type:	MG; NNN
Available Space:	183 - 3,017 SF

Lease Term:	Negotiable
Lease Rate:	Negotiable

**AVAILABLE SPACES**

SUITE	TENANT	SIZE	TYPE	RATE
Pennyfeather Building: Suite 204	Available	527 SF	Modified Gross	Negotiable



**PETTINARO.COM**  
 f PettinaroCRE/  
 in company/pettinaro/  
 t PettinaroCRE/

**CORPORATE OFFICES**  
 234 North James Street  
 Newport, DE 19804  
 302.999.0708

**LEASING INQUIRIES**  
 Matt Guers  
 Director of Office Leasing  
 609.605.1843  
 mguers@pettinaro.com  
 Timothy "TJ" Spencer, CCIM  
 Director of Retail Leasing  
 302.999.0708  
 tjspencer@pettinaro.com

FOR LEASE

# Powder Mill Square

RETAIL/OFFICE | 3828-3858 KENNETT PIKE | GREENVILLE, DE 19807

SUITE	TENANT	SIZE	TYPE	RATE
Pennyfeather Building: Suite 206	Available	183 SF	Modified Gross	Negotiable
Mall Building: Suite 3856	Available	952 SF	NNN	Negotiable
Mall Building: Suite 3858	Available	3,017 SF	Modified Gross	Negotiable
Mall Building: Suite 200A	Available	896 SF	Modified Gross	Negotiable
Mall Building: Suite 202-4	Available	1,543 SF	Modified Gross	Negotiable
Mall Building: Suite 204-4	Available	1,304 SF	Modified Gross	Negotiable



**PETTINARO.COM**

 PettinaroCRE/  
 company/pettinaro/  
 PettinaroCRE/

**CORPORATE OFFICES**

234 North James Street  
Newport, DE 19804  
302.999.0708

**LEASING INQUIRIES**

Matt Guers  
Director of Office Leasing  
609.605.1843  
mguers@pettinaro.com

Timothy "TJ" Spencer, CCIM  
Director of Retail Leasing  
302.999.0708  
tjspencer@pettinaro.com

FOR LEASE

# Powder Mill Square

RETAIL/OFFICE | 3828-3858 KENNETT PIKE | GREENVILLE, DE 19807

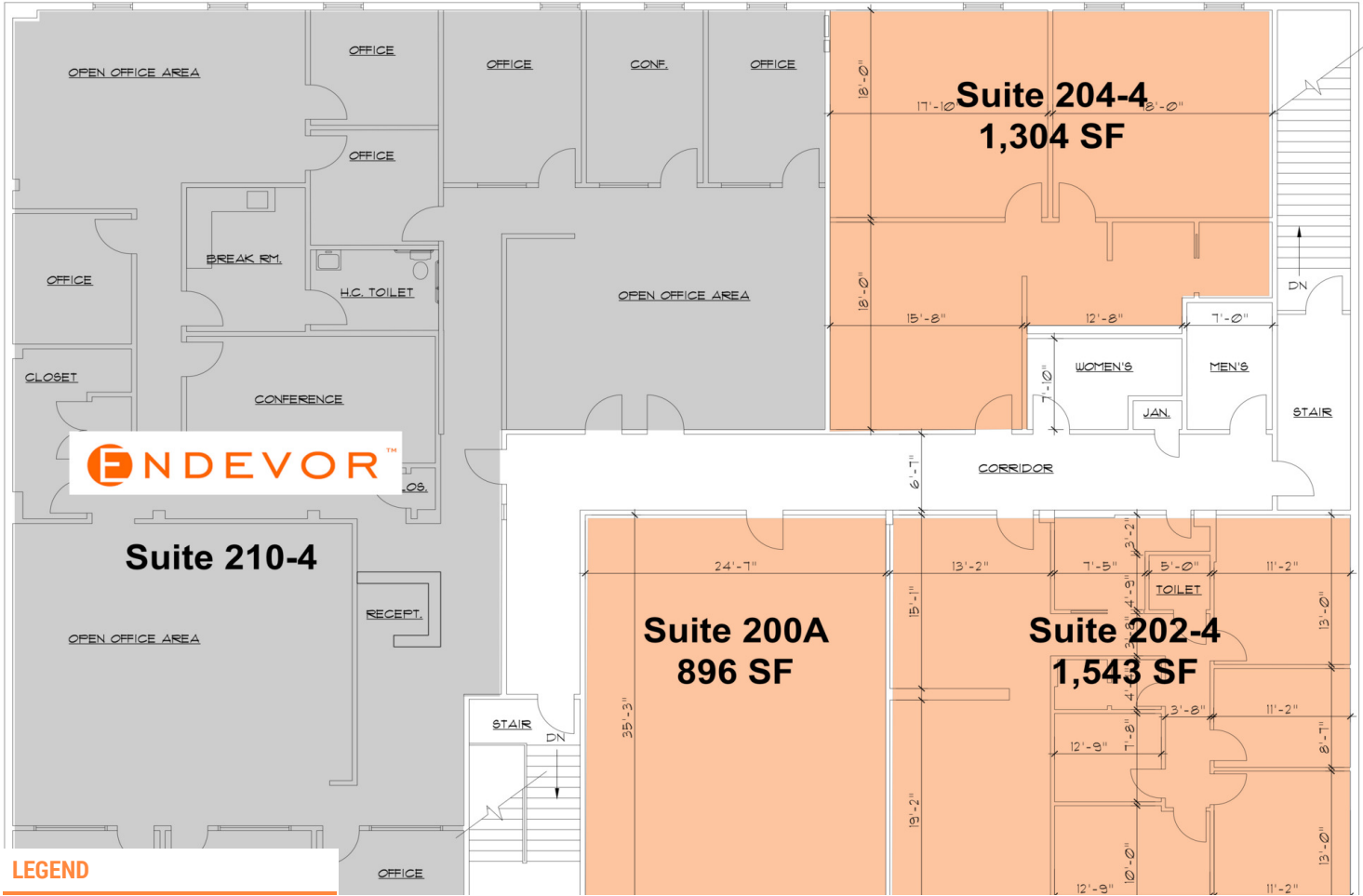

### LEGEND

### LEASE INFORMATION

Lease Type:	MG; NNN
Available Space This Floor:	896 - 2,847 SF

Lease Term:	Negotiable
Lease Rate:	Negotiable

### AVAILABLE SPACES

SUITE	TENANT	SIZE	TYPE	RATE
-------	--------	------	------	------



**PETTINARO.COM**  
 f PettinaroCRE/  
 company/pettinaro/  
 in  
 t PettinaroCRE/

**CORPORATE OFFICES**  
 234 North James Street  
 Newport, DE 19804  
 302.999.0708

**LEASING INQUIRIES**  
 Matt Guers  
 Director of Office Leasing  
 609.605.1843  
 mguers@pettinaro.com  
 Timothy "TJ" Spencer, CCIM  
 Director of Retail Leasing  
 302.999.0708  
 tjspencer@pettinaro.com

FOR LEASE

# Powder Mill Square

RETAIL/OFFICE | 3828-3858 KENNETT PIKE | GREENVILLE, DE 19807



#### PETTINARO.COM

[f](#) PettinaroCRE/  
[in](#) company/pettinaro/  
[t](#) PettinaroCRE/

#### CORPORATE OFFICES

234 North James Street  
Newport, DE 19804  
302.999.0708

#### LEASING INQUIRIES

Matt Guers  
Director of Office Leasing  
609.605.1843  
mguers@pettinaro.com

Timothy "TJ" Spencer, CCIM  
Director of Retail Leasing  
302.999.0708  
tjspencer@pettinaro.com

FOR LEASE

# Powder Mill Square

RETAIL/OFFICE | 3828-3858 KENNETT PIKE | GREENVILLE, DE 19807



Google

Westover Hills  
Map data ©2025 Imagery ©2025 Airbus,  
Maxar Technologies



**PETTINARO.COM**

f PettinaroCRE/  
company/pettinaro/  
in  
PettinaroCRE/  
PettinaroCRE/

**CORPORATE OFFICES**

234 North James Street  
Newport, DE 19804  
302.999.0708

**LEASING INQUIRIES**

Matt Guers Director of Office Leasing 609.605.1843 mguers@pettinaro.com	Timothy "TJ" Spencer, CCIM Director of Retail Leasing 302.999.0708 tjspencer@pettinaro.com
--	---