



MACK

INNOVATION  
PARK  
DEER VALLEY

PHASE 2



**BRAND NEW INDUSTRIAL SPACE**  
Ready for Immediate Occupancy

MACK | REAL ESTATE GROUP

CBRE



# SITE FEATURES

- ◆ **Rare A-2 Zoning** in the City of Phoenix
- ◆ **Located ±8 miles from the \$165 billion Taiwan Semiconductor Manufacturing Corporation (TSMC)** multi-phase project which completed its first building in 2024 with a plan to be operational in 2025
- ◆ **Located adjacent to Deer Valley Airport**
- ◆ **Deer Valley is home to corporations** such as USAA, W. L. Gore, Cigna, TSMC, Honeywell, Amazon, FedEx, DHL, Knight/Swift Transportation, Blue Cross Blue Shield of Arizona, American Express and Farmers Insurance
- ◆ **±20 Minute drive to Phoenix Sky Harbor International Airport**
- ◆ **Close proximity to thirteen retail centers** which include, fast-food and sit-down restaurants, shopping, hardware and multiple hospitality options
- ◆ **Situated at Pinnacle Peak Road and 7th Avenue**, with two (2) direct arterials to major freeways providing great access to all metropolitan Phoenix

# PHASE 2

23355 N 7th Avenue  
555 & 333 W Pinnacle Peak Road

## BUILDING B1: 23355 N 7TH AVENUE

- ◆ Total Size: ±150,752 SF (*Divisible*)
  - Available SF: ±37,346 SF
- ◆ Building Depth: 241' 8"
- ◆ Clear Height: 32'
- ◆ Power: 3000A 277/480V 3 Phase (*Entire Building*)
  - Potential to expand up to 6000 Amps 277/480V 3 Phase
- ◆ Grade Level Doors: 1 (16'x20')
- ◆ Dock High Doors: 7 (9'x10')
- ◆ Truck Court Depth: 195' (*Shared*)
- ◆ Car Parking: 192 (*Entire Building*)
- ◆ Parking Ratio: 1.27/1,000

## BUILDING B2: 555 W PINNACLE PEAK ROAD

- ◆ Fully Leased
- ◆ Total Size: ±138,669 SF (*Divisible*)
- ◆ Building Depth: 221' 8"
- ◆ Clear Height: 32'
- ◆ Power: 3000A 277/480V 3 Phase
  - Potential to expand up to 6000 Amps 277/480V 3 Phase
- ◆ Grade Level Doors: 5 (16'x20')
- ◆ Dock High Doors: 28 (9'x10')
- ◆ Truck Court Depth: 195' (*Shared*)
- ◆ Car Parking: 162 (*Entire Building*)
- ◆ Parking Ratio: 1.17/1,000

## BUILDING B3: 333 W PINNACLE PEAK ROAD

- ◆ Total Size: ±126,106 SF (*Divisible*)
  - Available SF: ±126,106 SF
- ◆ Building Depth: 201' 8"
- ◆ Clear Height: 32'
- ◆ Power: 3000A 277/480V 3 Phase
  - Potential to expand up to 6000 Amps 277/480V 3 Phase
- ◆ Grade Level Doors: 5 (16'x20')
- ◆ Dock High Doors: 27 (12'x14')
- ◆ Truck Court Depth: 135' (*Not Shared / Fully Fenced & Secured*)
- ◆ Car Parking: 150 (*Entire Building*)
- ◆ Parking Ratio: 1.20/1,000



# SPEC SUITE

333 W Pinnacle Peak Road

## BUILDING B3: SPEC SUITE 100

- ◆ Total Building Size: ±126,106 SF
- ◆ Suite #100 Office Size: ±2,757 SF
  - 3 Private Offices
  - 1 Large Open Office / Showroom Area
  - 1 Large Conference Room
  - 1 Large Break Room
  - 4 Restrooms
  - IT Room & Janitorial Closet

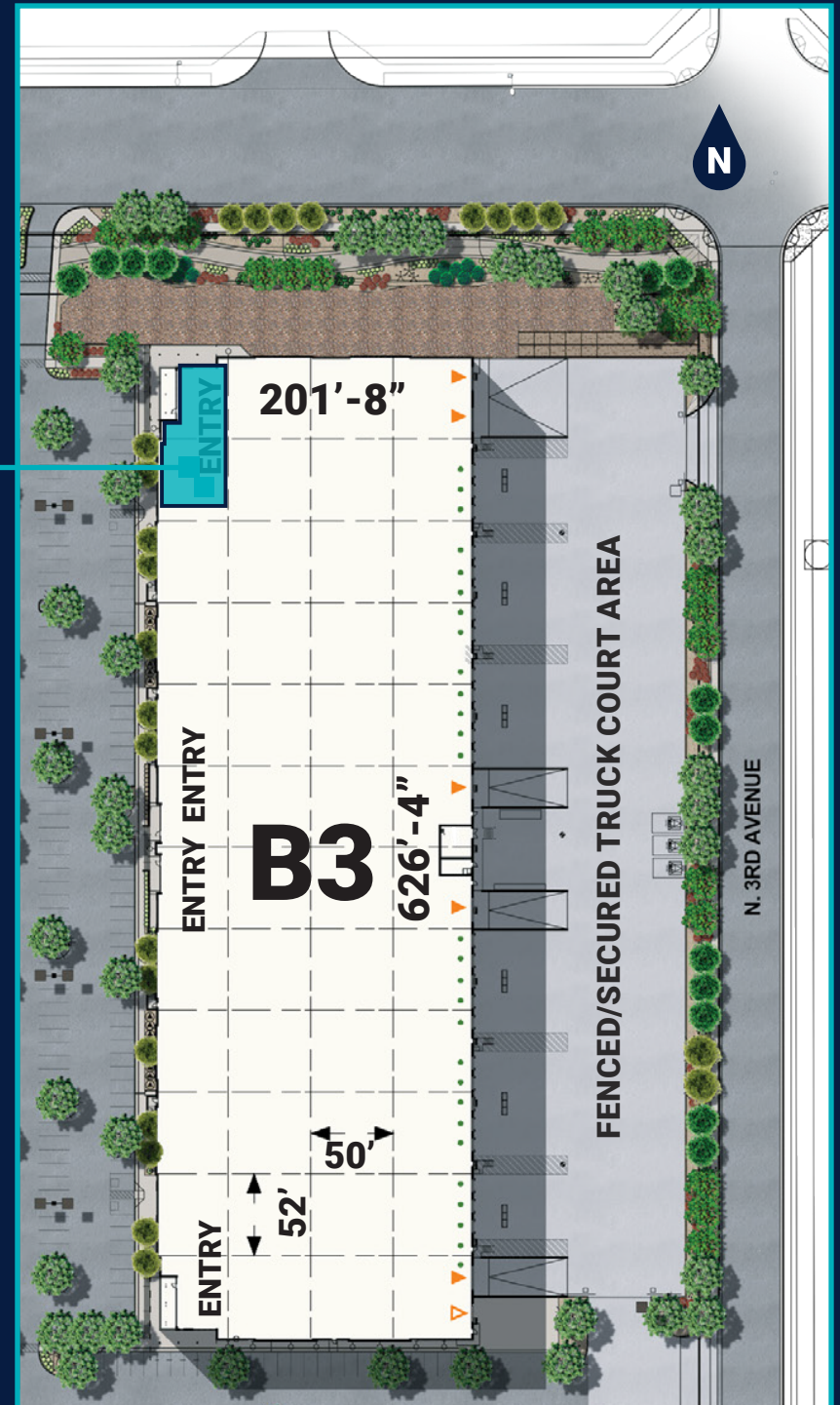
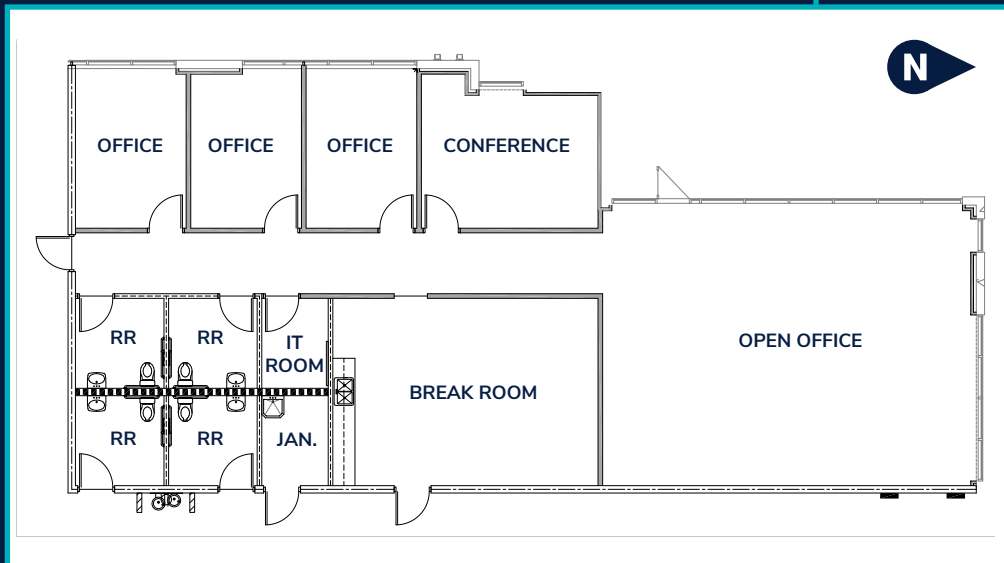

# PROPERTY FEATURES



Energy Efficient Clerestory Windows in Lieu of Skylights



100% Air Conditioned Warehouses



Full Moment Frame Design



Castellated Steel Beam Roof Structure



All Concrete Truck Courts



Rear Loaded Dock High Buildings



Frontage on Pinnacle Peak Road

## PHASE 2: Construction Complete & Ready for Immediate Occupancy



# LOCATION ADVANTAGE



**138,517**  
POPULATION (2025)



**55,546**  
NUMBER OF HOUSEHOLDS



**78,325**  
DAYTIME EMPLOYEES



**6,729**  
NEARBY GOODS & SERVICE  
PRODUCING INDUSTRIES



**\$115,456**  
AVG HOUSEHOLD INCOME



**\$2,361,100,254**  
CONSUMER SPENDING



**±15 MINUTE DRIVE  
TO TSMC (ALL SITES)**





# MACK

INNOVATION  
PARK  
DEER VALLEY

FOR MORE INFORMATION:

## CBRE

**James Cohn**

SENIOR VICE PRESIDENT  
+1 602 635 0624  
james.cohn@cbre.com

**Rusty Kennedy**

EXECUTIVE VICE PRESIDENT  
+1 602 696 8616  
rusty.kennedy@cbre.com



SCAN OR CLICK  
FOR MORE MIP

© 2026 CBRE, Inc. All rights reserved. This information has been obtained from sources believed reliable but has not been verified for accuracy or completeness. CBRE, Inc. makes no guarantee, representation or warranty and accepts no responsibility or liability as to the accuracy, completeness, or reliability of the information contained herein. You should conduct a careful, independent investigation of the property and verify all information. Any reliance on this information is solely at your own risk, property is submitted subject to errors, change of price, or conditions, prior sale or lease, or withdrawal without notice.

**CBRE** | **MACK** REAL ESTATE GROUP

