

INDUSTRIAL SPACE FOR LEASE



# 25,608 – 77,424 SF

**8680 Greenwood Place  
Savage, MD 20763**

Prologis Corridor Industrial Park

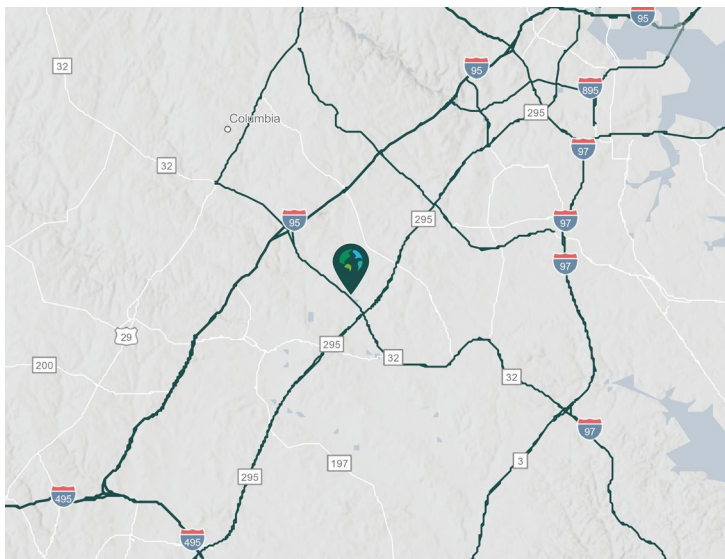

- Immediate access to I-95 and Route 1
- Multi-market accessibility including Washington, DC, Baltimore and Philadelphia
- Convenient access to the Baltimore Washington Corridor including the BWI Thurgood Marshall Airport

## Property Features

<b>Available Space</b>	25,608 – 77,424 SF divisible to 25,608 SF, 26,032 SF, and 25,784 SF
<b>Office Space</b>	7,485 SF
<b>Dock Doors</b>	11 dock doors; 10 with pit levelers and 1 drive-in with a leveler
<b>Clear Height</b>	24'
<b>Column Spacing</b>	32' x 49'
<b>Car Parking Spaces</b>	Ample parking
<b>Electrical Service</b>	600 amps
<b>Sprinkler</b>	Calculated system
<b>Lighting</b>	LED



Unlock the full potential of your warehouse with one strategic, single-source partner.

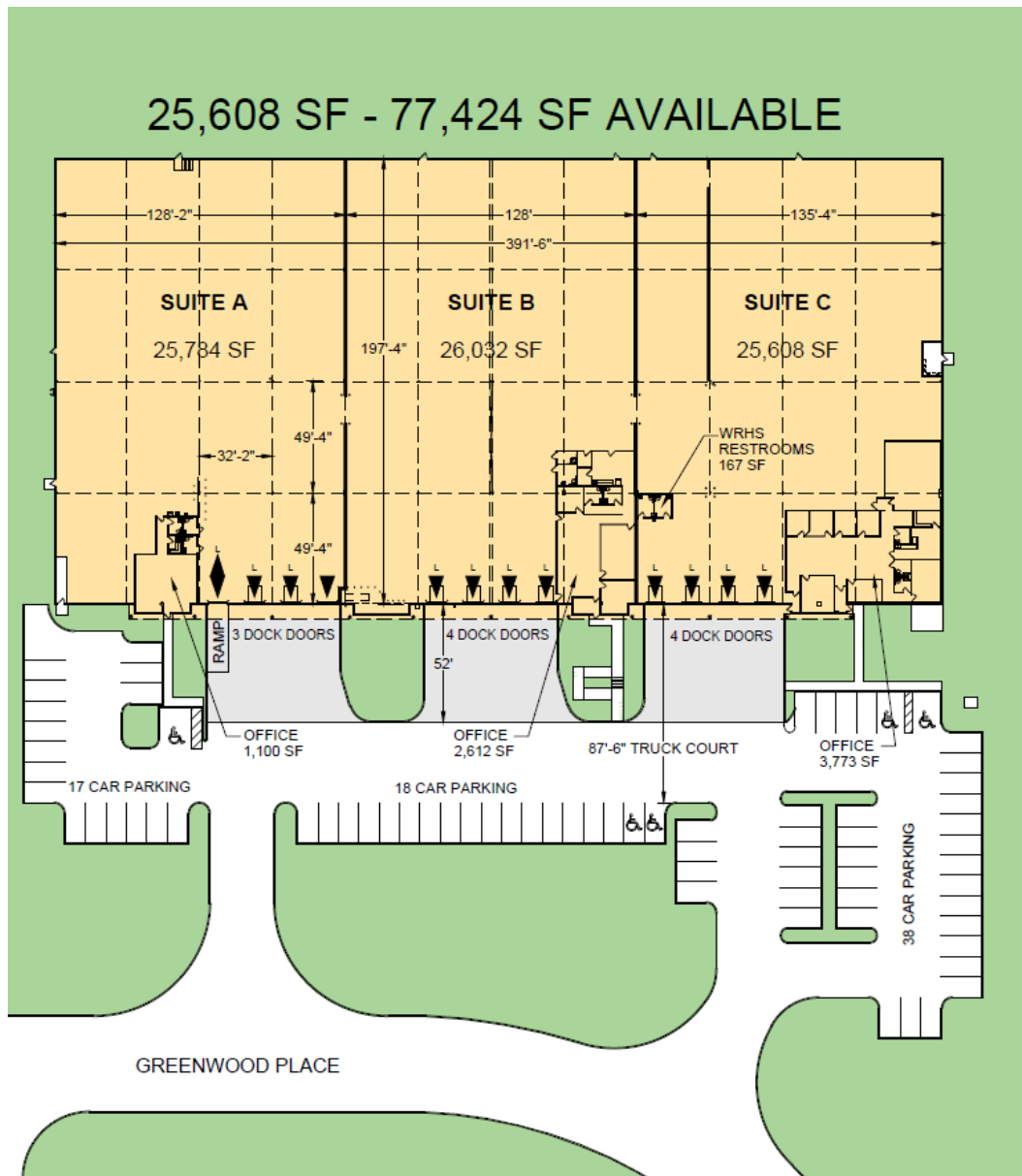

**LEGEND:**

- ▲ DOCK POSITION
- ▲ DOCK POSITION W/ LEVELER
- ◆ DRIVE-IN DOOR
- LAND
- LEASED AREA
- AVAILABLE AREA

# NEWMARK

**Newmark**  
**Brian Kruger**

brian.kruger@nrmk.com  
ph +1 410 625 4211

**Newmark**  
**Thomas Hinder**

thomas.hinder@nrmk.com  
ph +1 410 844 4010

**Newmark**  
**Erik Evans**

erik.evans@nrmk.com  
ph +1 410 844 4003

**Prologis**  
**Karen Cherry**

kcherry@prologis.com  
ph +1 410 872 4560  
prologis.com